

F.A. RTE.	SECTION	COUNTY	TOTAL SHEETS	SHEET NO.
2508	09-00041-00-RS	KANE/KENDALL	17	13
CONTRACT NO. 63299				

CONTRACT NO.				
F.A. RTE.	SECTION	COUNTY	TOTAL SHEETS	SHEET NO.
STA.		TO STA.		
FED. ROAD DIST. NO.	ILLINOIS	FED. AID PROJECT		

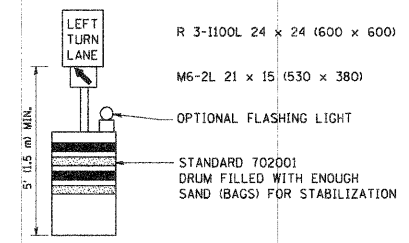
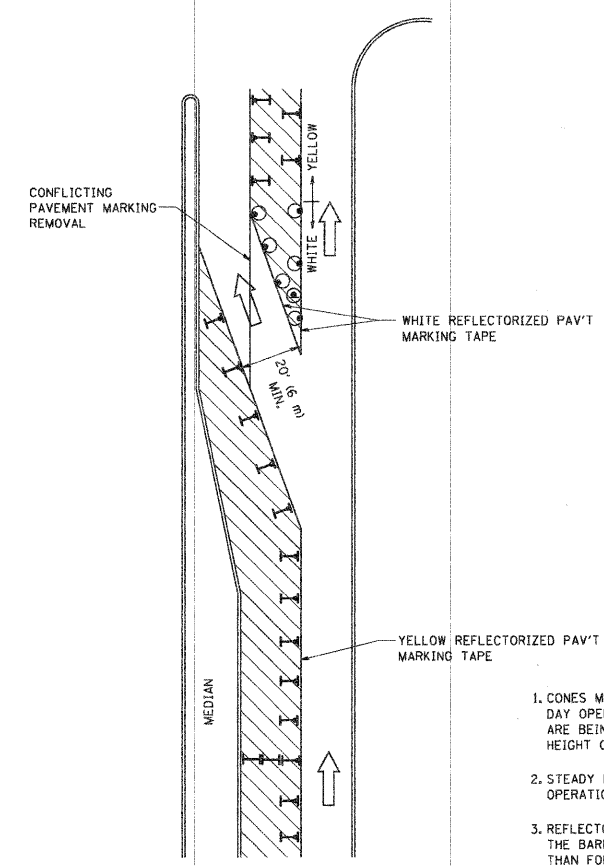

GENERAL NOTES

- CONES MAY BE SUBSTITUTED FOR BARRICADES OR DRUMS AT HALF THE SPACING DURING DAY OPERATIONS. CONES SHALL BE A MINIMUM OF 28 (710) IN HEIGHT. WHEN CONES ARE BEING USED, THE "LEFT TURN LANE" SIGN MAY BE SKID MOUNTED AT A MINIMUM HEIGHT OF 5' (1.5 m).
- STEADY BURNING LIGHTS WILL NOT BE REQUIRED ON BARRICADES OR DRUMS FOR DAY OPERATIONS. ALL LIGHTS SHALL BE MONODIRECTIONAL.
- REFLECTORIZED TEMPORARY PAVEMENT MARKING TAPE SHALL BE PLACED THROUGHOUT THE BARRICADED AREA OF EACH TURN BAY WHERE THE CLOSURE TIME IS GREATER THAN FOURTEEN DAYS.
- THIS APPLICATION ALSO APPLIES WHEN WORK IS BEING PERFORMED IN THE RIGHT LANE(S) AND THE RIGHT TURN BAY IS TO REMAIN OPEN. UNDER THIS CONDITION, "RIGHT TURN LANE" R3-100 24 x 24 (600 x 600) AND M6-2R 21 x 15 (530 x 380) SHALL BE USED.
- THESE CONTROLS SHALL SUPPLEMENT MAINLINE TRAFFIC CONTROL FOR LANE CLOSURES.
- LONGITUDINAL DIMENSIONS MAY BE ADJUSTED TO FIT FIELD CONDITIONS.
- FORM BT 725 IS REQUIRED.
- TRAFFIC CONTROL AND PROTECTION AT TURN BAYS (TO REMAIN OPEN TO TRAFFIC) SHALL BE INCLUDED IN THE COST SPECIFIED TRAFFIC CONTROL STANDARDS OR ITEMS.

All dimensions are in inches (millimeters) unless otherwise shown.

- LEGEND**
- WORK AREA
 - LANE OPEN TO TRAFFIC
 - TYPE I OR II BARRICADE WITH STEADY BURN LIGHT
 - DRUM WITH STEADY BURN LIGHT
 - DRUM WITH SIGN (WITH OPTIONAL FLASHING LIGHT) SEE DETAIL
 - TYPE I OR II CHECK BARRICADE WITH FLASHING LIGHT

REVISIONS	
NAME	DATE
T. RAMMACHER	09/08/94
A. HOUSEH	11/07/96
A. HOUSEH	10/12/96
T. RAMMACHER	01/06/00

ILLINOIS DEPARTMENT OF TRANSPORTATION
TRAFFIC CONTROL AND PROTECTION AT TURN BAYS (TO REMAIN OPEN TO TRAFFIC)

SCALE: NONE
 DRAWN BY
 CHECKED BY LHA
 TC-14

PLT DATE: 8/16/09
 FILE NAME: K:\Projects\090809\TC-14.dwg
 USER NAME: KRAMMACH
 PLOT DATE: 8/16/09

Plotted: August 13, 2009 @ 7:07 AM By: Kris Pung - Job: 13 TC-14 22x34
 Path: H:\S:\SKPROJ\M00762\DWG\FINAL ENG\M00762-CVR

Engineering Enterprises, Inc.
 CONSULTING ENGINEERS
 52 Wheeler Road
 Sugar Grove, Illinois 60554
 630.466.6700 / www.eeiweb.com

VILLAGE OF MONTGOMERY
 Kane & Kendall Counties, Illinois

NO.	DATE	REVISIONS

DOUGLAS ROAD
LAPP IMPROVEMENTS

TRAFFIC CONTROL AND PROTECTION AT TURN BAYS
TC-14

DATE:	AUGUST 2009
PROJECT NO:	M00762
FILE:	M00762-CVR
SHEET	13 OF 17