

FOR INDEX OF SHEETS, SEE SHEET NO.2

# STATE OF ILLINOIS DEPARTMENT OF TRANSPORTATION DIVISION OF HIGHWAYS PLANS FOR PROPOSED FEDERAL AID PROJECT LAPP RESURFACING

**DOUGLAS ROAD (FAU 2508)  
FROM MONTGOMERY ROAD (FAU 3579)  
TO US ROUTE 30 (FAP 349)  
PROJECT NO. ARA-9003(320)  
SECTION NO. 09-00041-00-RS  
VILLAGE OF MONTGOMERY  
KANE AND KENDALL COUNTIES  
JOB NO. C-91-627-09**

F.A.P. RTE.	SECTION	COUNTY	TOTAL SHEETS	SHEET NO.
2508	09-00041-00-RS	KANE/KENDALL	17	1
FED. ROAD DIST. NO.		ILLINOIS	FED. AID PROJECT - LAPP	
CONTRACT NO. 63299				

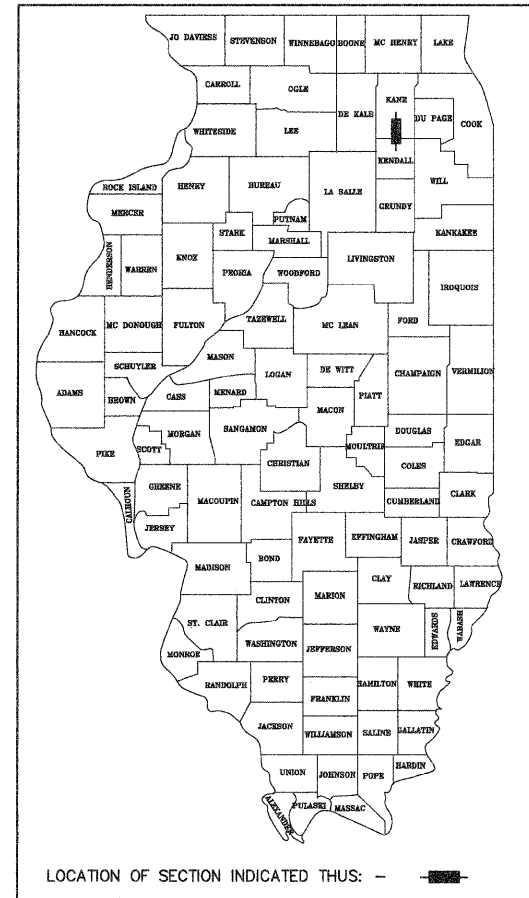

PROJECT LOCATED IN THE VILLAGE OF MONTGOMERY

**DESIGN DESIGNATION**

DOUGLAS ROAD: URBAN COLLECTOR  
DESIGN SPEED = 35 M.P.H.  
POSTED SPEED = 35 M.P.H.  
ADT(2006) = 22100 VPD

FIELD ENGINEER: MARLIN SOLOMON (847) 705-4407  
CONSULTING ENGINEER: ENGINEERING ENTERPRISES, INC.  
CONTACT: TIMOTHY V. WEIDNER (630)-466-6700

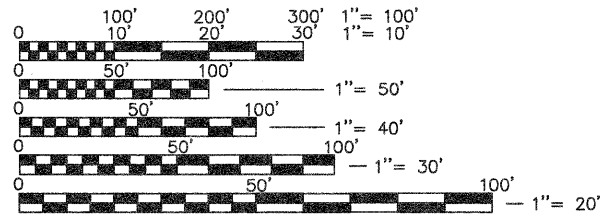

FULL SIZE PLANS HAVE BEEN PREPARED USING STANDARD ENGINEERING SCALES, REDUCED SIZED PLANS WILL NOT CONFORM TO STANDARD SCALES, IN MAKING MEASUREMENTS ON REDUCED PLANS, THE ABOVE SCALES MAY BE USED.

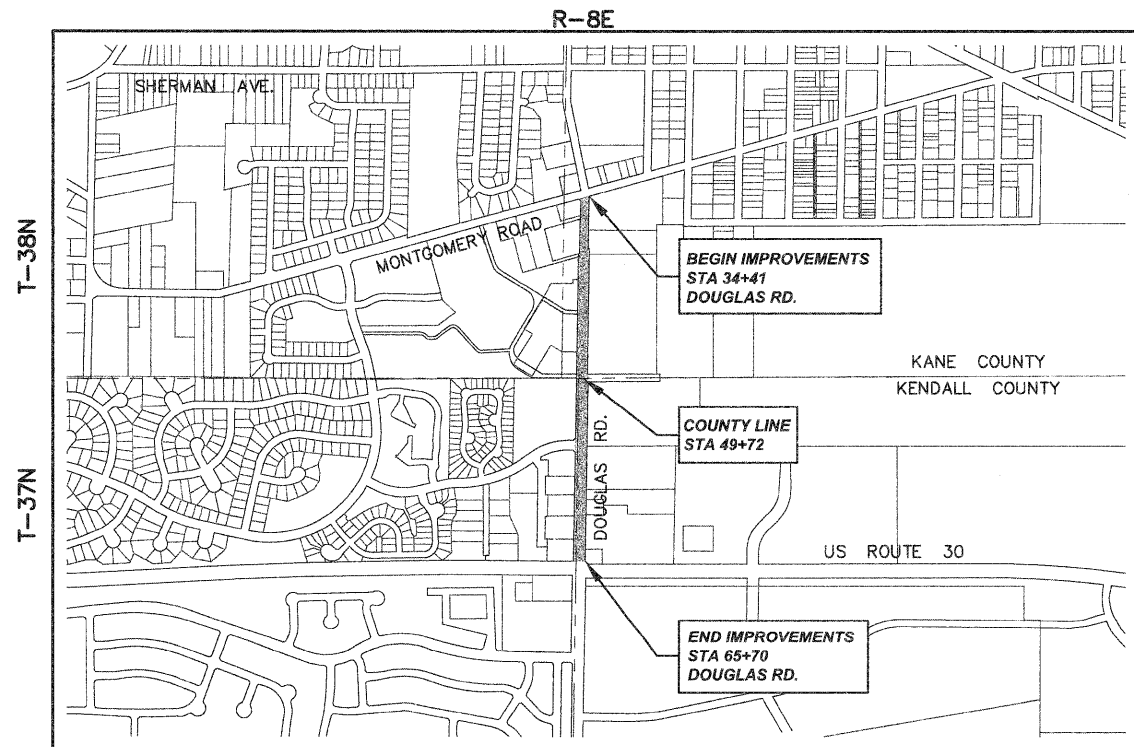

SW 1/4 SEC. 34, T-38N, R-8E, AND NW 1/4 SEC. 3, T-37N, R-8E, 3RD P.M.

**LOCATION MAP**  
N.T.S.

GROSS LENGTH OF PROJECT = 3,129 FEET (0.59 MILES)  
NET LENGTH OF PROJECT = 3,129 FEET (0.59 MILES)

**JULIE**  
JOINT  
UTILITY  
LOCATION  
INFORMATION FOR  
EXCAVATION  
CALL 811

Know what's below.  
Call before you dig.

CONTRACT NO. 63299

STATE OF ILLINOIS DEPARTMENT OF TRANSPORTATION DIVISION OF HIGHWAYS	
APPROVED	August 13, 2009 <i>[Signature]</i> VILLAGE OF MONTGOMERY, DIRECTOR OF PUBLIC WORKS
PASSED	August 31, 2009 <i>[Signature]</i> DISTRICT 1 ENGINEER OF LOCAL ROADS & STREETS
RELEASING FOR BID BASED ON LIMITED REVIEW	August 26, 2009 <i>[Signature]</i> DEPUTY DIRECTOR OF HIGHWAYS, REGION 1 ENGINEER

DATE: August 13, 2009

BY: *[Signature]*  
TIMOTHY V. WEIDNER

LICENSE EXPIRES: NOVEMBER 30, 2009

SEAL

**Engineering Enterprises, Inc.**  
CONSULTING ENGINEERS  
52 Wheeler Road  
Sugar Grove, Illinois 60554  
P: 630.466.6700 - W: www.eeiweb.com

PRINTED BY THE AUTHORITY OF THE STATE OF ILLINOIS

Plot: August 13, 2009 10:35 AM By: Kris Pung - Tab: 01 Cover (22x34) Pat: H:\SDSKPROJ\MO0762\DWG\DWG\_FINAL\_ENG\M00762-CV

F.A.P. RTE.	SECTION	COUNTY	TOTAL SHEETS	SHEET NO.
2508	09-00041-00-RS	KANE/KENDALL	17	2
CONTRACT NO. 63299				

**GENERAL NOTES AND CONSTRUCTION SPECIFICATIONS**

- THE CONTRACTOR SHALL OBTAIN, ERECT, MAINTAIN AND REMOVE ALL SIGNS, BARRICADES, FLAGGERS AND OTHER TRAFFIC CONTROL DEVICES AS MAY BE NECESSARY FOR THE PURPOSE OF REGULATING, WARNING OR GUIDING TRAFFIC. PLACEMENT AND MAINTENANCE OF ALL TRAFFIC CONTROL DEVICES SHALL BE IN ACCORDANCE WITH THE APPLICABLE PARTS OF ARTICLE 107.14 OF THE STANDARD SPECIFICATIONS AND THE ILLINOIS MANUAL ON UNIFORM TRAFFIC CONTROL DEVICES FOR STREETS AND HIGHWAYS.
- LOCATION OF UTILITIES SHOWN ON PLANS ARE APPROXIMATE ONLY, AND ARE NOT NECESSARILY COMPLETE. CONTRACTOR SHALL MAKE HIS OWN INVESTIGATIONS AS TO LOCATION OF ALL EXISTING UNDERGROUND STRUCTURES, CABLES AND PIPE LINES.
- ALL ELEVATIONS ARE BASED ON U.S.G.S. DATUM.
- ALL ROAD SIGNS, STREET SIGNS AND TRAFFIC SIGNS THAT NEED TO BE RELOCATED OR MOVED DUE TO CONSTRUCTION SHALL BE TAKEN DOWN AND STORED BY THE CONTRACTOR EXCEPT THOSE THAT ARE NECESSARY FOR PROPER TRAFFIC CONTROL SHALL BE TEMPORARILY RESET UNTIL COMPLETION OF CONSTRUCTION OPERATIONS. AFTER COMPLETION OF THE WORK, THE CONTRACTOR SHALL RESET ALL SAID SIGNS. THE WORK SHALL BE INCLUDED IN THE COST OF TRAFFIC CONTROL PAY ITEMS, AND SHALL NOT BE PAID FOR SEPARATELY.
- ARTICLE 105.06 OF THE STANDARD SPECIFICATIONS REQUIRES THE CONTRACTOR TO HAVE A COMPETENT SUPERINTENDENT ON THE PROJECT SITE AT ALL TIMES, IRRESPECTIVE OF THE AMOUNT OF WORK SUBLET. THE SUPERINTENDENT SHALL BE CAPABLE OF READING AND UNDERSTANDING THE PLANS AND SPECIFICATIONS, SHALL HAVE FULL AUTHORITY TO EXECUTE ORDERS TO EXPEDITE THE PROJECT, SHALL BE RESPONSIBLE FOR SCHEDULING AND HAVE CONTROL OF ALL WORK AS THE AGENT OF THE CONTRACTOR. FAILURE TO COMPLY WITH THIS PROVISION WILL RESULT IN A SUSPENSION OF WORK AS PROVIDED IN ARTICLE 108.08.
- ALL REFERENCES TO STANDARDS IN THE PLANS OR SPECIAL PROVISIONS SHALL BE INTERPRETED AS THE LATEST STANDARD OF THE DEPARTMENT AS SHOWN ON THE PLANS.
- THE CONTRACTOR SHALL PROTECT AND PRESERVE ALL SECTION OR SUBSECTION SURVEY MONUMENTS OR PROPERTY OR REFERENCE MARKERS UNTIL THE OWNER, HIS OR HER AGENT OR AN AUTHORIZED SURVEYOR HAS WITNESSED OR OTHERWISE REFERENCED THEIR LOCATIONS.
- THE UNIT PRICE FOR ALL REMOVAL PAY ITEMS AND TEMPORARY RAMPS SHALL INCLUDE ALL REQUIRED SAW CUTS.
- ALL WORK PERFORMED RELATIVE TO THIS IMPROVEMENT SHALL COMPLY WITH ALL APPLICABLE RULES AND REGULATIONS OF O.S.H.A.
- CONTRACTOR SHALL PROVIDE AND INSTALL TWO WEIGHTED SAND BAGS ON EACH TYPE I OR TYPE II BARRICADE USED. (ONE WEIGHTED SAND BAG ACROSS EACH BOTTOM RAIL.) THIS WORK WILL NOT BE PAID FOR SEPARATELY, BUT SHALL BE CONSIDERED AS INCLUDED IN THE CONTRACT UNIT PRICE FOR THE CONSTRUCTION ITEMS INVOLVED AND NO ADDITIONAL COMPENSATION WILL BE ALLOWED.
- BEFORE STARTING ALL EXCAVATION, THE CONTRACTOR SHALL CALL "JULIE" AT 800-892-0123 OR 811 FOR FIELD LOCATIONS OF BURIED ELECTRIC, TELEPHONE AND GAS FACILITIES. (48 HOUR NOTIFICATION IS REQUIRED)
- THE CONTRACTOR SHALL COORDINATE CONSTRUCTION ACTIVITIES WITH UTILITY COMPANIES AND THE VILLAGE OF MONTGOMERY.
- WHEN MILLED PAVEMENT IS OPEN TO TRAFFIC THE MAXIMUM GRADE DIFFERENTIAL BETWEEN PASSES OF THE MILLING MACHINE SHALL NOT EXCEED 1 1/2 INCHES (40 MM) WHERE THE SPEED LIMIT IS 45 MPH (80 KM/H) OR LESS AND 1 INCH (25 MM) WHERE THE SPEED LIMIT IS GREATER THAN 45 MPH (80 KM/H). WITH WRITTEN APPROVAL FROM THE ENGINEER, A MAXIMUM GRADE DIFFERENTIAL OF 3 INCHES (75 MM) MAY BE ALLOWED IF THE EDGE OF THE MILLING IS SLOPED A MINIMUM 1:3 (V:H).
- TEMPORARY RAMPS WILL BE INSTALLED AT THE ENDS OF ALL RESURFACING (WHERE THE RESURFACING MEETS EXISTING PAVEMENT) IN ACCORDANCE WITH THE "BUTT JOINT AND HMA TAPER DETAILS" SHEET INCLUDED IN THE PLANS, UNLESS OTHERWISE SPECIFIED.

- WHENEVER, DURING CONSTRUCTION OPERATIONS LOOSE MATERIAL IS DEPOSITED IN THE FLOW LINE OF DRAINAGE STRUCTURES SUCH THAT THE NATURAL FLOW OF WATER IS OBSTRUCTED, IT SHALL BE REMOVED AT THE CLOSE OF EACH WORKING DAY. AT THE CONCLUSION OF CONSTRUCTION OPERATIONS, ALL DRAINAGE STRUCTURES SHALL BE FREE FROM DIRT AND DEBRIS. EXISTING LOOSE MATERIAL CURRENTLY DEPOSITED IN THE FLOW LINE SHALL BE REMOVED BEFORE CONCRETE CURB AND GUTTER REMOVAL AND REPLACEMENT BEGINS. THE WORK SPECIFIED ABOVE WILL NOT BE PAID FOR SEPARATELY, BUT SHALL BE CONSIDERED AS INCLUDED IN THE COST OF CONTRACT PAY ITEMS.
- EXISTING PUBLIC AND PRIVATE UTILITIES ARE SHOWN ON THE PLANS ACCORDING TO INFORMATION OBTAINED FROM UTILITY COMPANIES, MUNICIPALITIES, AND SURVEYS. THE CONTRACTOR SHALL FAMILIARIZE HIMSELF WITH THE LOCATION OF ALL UTILITIES AND STRUCTURES THAT MAY BE FOUND IN THE VICINITY OF THE CONSTRUCTION. THE CONTRACTOR WILL ALSO ASSUME RESPONSIBILITY FOR ALL UTILITIES WHETHER SHOWN OR NOT, AND MUST REALIZE THAT THE ACTUAL LOCATIONS AND/OR ELEVATIONS OF THE UTILITIES MAY BE DIFFERENT THAN INDICATED.  
  
SHOULD ANY DAMAGES OCCUR DUE TO THE CONTRACTOR'S NEGLIGENCE, THE CONTRACTOR, AT HIS OR HER OWN EXPENSE, SHALL MAKE REPAIRS IN A MANNER ACCEPTABLE TO THE ENGINEER. THE CONTRACTOR SHALL NOTIFY ALL UTILITY COMPANIES OF HIS OR HER CONSTRUCTION SCHEDULE AND COORDINATE CONSTRUCTION OPERATIONS WITH THE UTILITY COMPANIES SO THAT RELOCATION OF UTILITY LINES AND STRUCTURES MAY PROCEED IN AN ORDERLY MANNER.
- DURING CONSTRUCTION, IF THE CONTRACTOR ENCOUNTERS OR OTHERWISE BECOMES AWARE OF ANY SEWER, UNDERDRAINS OR FIELD DRAINS WITHIN THE RIGHT-OF-WAY OTHER THAN THOSE SHOWN ON THE PLANS, HE OR SHE SHALL SO INFORM THE ENGINEER WHO SHALL DIRECT THE WORK NECESSARY TO MAINTAIN OR TO REPLACE THE FACILITIES IN SERVICE AND TO PROTECT THEM FROM DAMAGE DURING CONSTRUCTION IF TO BE MAINTAINED. EXISTING FACILITIES TO BE MAINTAINED THAT ARE DAMAGED BECAUSE OF NON-COMPLIANCE WITH THIS PROVISION SHALL BE REPLACED AT THE CONTRACTOR'S OWN EXPENSE.
- DOUGLAS ROAD SHALL REMAIN OPEN TO TRAFFIC AT ALL TIMES. WHEN NECESSARY TO CLOSE ONE LANE OF DOUGLAS ROAD DUE TO CONSTRUCTION, THE CONTRACTOR SHALL MAINTAIN A MINIMUM OF ONE-WAY TRAFFIC DURING CONSTRUCTION HOURS WITH THE USE OF SIGNS AND FLAGMEN AS SHOWN ON THE TRAFFIC CONTROL STANDARDS. TWO LANES OF TRAFFIC SHALL BE MAINTAINED AT ALL OTHER TIMES WHEN NO CONSTRUCTION ACTIVITIES ARE BEING CARRIED ON. ACCESS TO ALL ADJOINING PROPERTIES SHALL BE MAINTAINED AT ALL TIMES.

**INDEX OF SHEETS**

SHEET NO.	SHEET DESCRIPTION
1.	COVER SHEET AND LOCATION MAP
2.	GENERAL NOTES, STATE STANDARDS, AND INDEX OF SHEETS
3.	SUMMARY OF QUANTITIES
4.	TYPICAL EXISTING AND PROPOSED CROSS SECTIONS AND HOT-MIX ASPHALT MIXTURE REQUIREMENT TABLE
5.	TYPICAL EXISTING AND PROPOSED CROSS SECTIONS
6.	GENERAL PLAN
7.	TERMINI DETAILS / DETECTOR LOOP DETAILS
8.	SCHEDULE OF QUANTITIES
9.	SCHEDULE OF QUANTITIES
<b>DISTRICT ONE DETAILS</b>	
10.	(TC-10) TRAFFIC CONTROL AND PROTECTION FOR SIDE ROADS, INTERSECTIONS, AND DRIVEWAYS
11.	(TC-11) RAISED REFLECTIVE PAVEMENT MARKERS
12.	(TC-13) TYPICAL PAVEMENT MARKINGS
13.	(TC-14) TRAFFIC CONTROL AND PROTECTION AT TURN BAYS (TO REMAIN OPEN TO TRAFFIC)
14.	(BD-22) PAVEMENT PATCHING FOR HMA SURFACED PAVEMENT
15.	(BD-24) CURB OR CURB AND GUTTER REMOVAL AND REPLACEMENT
16.	(BD-32) BUTT JOINT AND HMA TAPER DETAILS
17.	(TS-07) DISTRICT 1 - DETECTOR LOOP INSTALLATION DETAILS FOR ROADWAY RESURFACING

**STATE STANDARDS**

STD. NO.	DESCRIPTION
000001-05	STANDARD SYMBOLS, ABBREVIATIONS, AND PATTERNS
424001-05	CURB RAMPS FOR SIDEWALKS
442201-05	CLASS C AND D PATCHES
606001-04	CONCRETE CURB TYPE B AND COMBINATION CONCRETE CURB AND GUTTER
701426-03	LANE CLOSURE, MULTILANE, INTERMITTENT OR MOVING OPERATION FOR SPEEDS > 45 MPH
701602-04	URBAN LANE CLOSURE, MULTILANE, 2W WITH BIDIRECTIONAL LEFT TURN LANE
701701-06	URBAN LANE CLOSURE, MULTILANE INTERSECTION
701801-04	LANE CLOSURE MULTILANE 1W OR 2W CROSSWALK OR SIDEWALK CLOSURE
701901-01	TRAFFIC CONTROL DEVICES
780001-02	TYPICAL PAVEMENT MARKINGS
781001-03	TYPICAL APPLICATIONS RAISED REFLECTIVE PAVEMENT MARKERS
886001-01	DETECTOR LOOP INSTALLATIONS

**LEGEND**

EXISTING	DESCRIPTION	PROPOSED
	SANITARY SEWER	
	STORM SEWER	
	END SECTION	
	WATER MAIN & SIZE	
	WATER SERVICE & BOX	
	CONTOUR	
	GAS MAIN	
	TELEPHONE CABLE	
	MANHOLE	
	CATCH BASIN	
	INLET	
	HYDRANT	
	VALVE VAULT	
	TREE	
	ELEVATION	
	STREET LIGHT	
	SIGNS	
	FOUND IRON PIPE	
	GUY WIRE	
	FLAG POLE	
	UTILITY POLE	
	UTILITY PEDESTAL	
	HANDHOLE	

Plotted: August 14, 2009 @ 8:10 AM By: Kris Pung - Tab: 02 Notes 22x34  
 COPYRIGHT © 2009 ENGINEERING ENTERPRISES, INC.

**Engineering Enterprises, Inc.**  
 CONSULTING ENGINEERS  
 52 Wheeler Road  
 Sugar Grove, Illinois 60554  
 630.466.6700 / www.eeiweb.com

**VILLAGE OF MONTGOMERY**  
 Kane & Kendall Counties, Illinois

NO.	DATE	REVISIONS

**DOUGLAS ROAD**  
**LAPP IMPROVEMENTS**

**GENERAL NOTES,**  
**STATE STANDARDS,**  
**AND INDEX OF SHEETS**

DATE:	AUGUST 2009
PROJECT NO:	MO0762
FILE:	MO0762-CVR
SHEET	<b>2</b> OF <b>17</b>

Path: H:\SRK\PROJ\MO0762\DWG\ENG\FINAL\ENG\MO0762-CVR

**SUMMARY OF QUANTITIES**

F.A.P. RTE.	SECTION	COUNTY	TOTAL SHEETS	SHEET NO.
2508	09-00041-00-RS	KANE/KENDALL	17	3
CONTRACT NO. 63299				

CODE NO.	PAY ITEM	UNIT	CONST. CODE	KANE COUNTY	KENDALL COUNTY
			1000 TOTAL QUANTITY		
40600100	BITUMINOUS MATERIALS (PRIME COAT)	GALLON	4,195	1,883	2,312
40600300	AGGREGATE (PRIME COAT)	TON	84	38	46
40600635	LEVELING BINDER (MACHINE METHOD), N70	TON	1,175	528	647
40600895	CONSTRUCTING TEST STRIP	EACH	1	0.5	0.5
40600982	HOT-MIX ASPHALT SURFACE REMOVAL - BUTT JOINT	SQ YD	189	43	146
40600990	TEMPORARY RAMP	SQ YD	253	147	106
40603340	HOT-MIX ASPHALT SURFACE COURSE, MIX "D", N70	TON	2,350	1,055	1,295
Δ 42400800	DETECTABLE WARNINGS	SQ FT	314	154	160
44000161	HOT-MIX ASPHALT SURFACE REMOVAL, 3"	SQ YD	20,975	9,413	11,562
Δ 44001700	COMBINATION CONCRETE CURB AND GUTTER REMOVAL AND REPLACEMENT	FOOT	1,510	768	742
Δ 44002400	CURB REMOVAL (SPECIAL)	FOOT	110	55	55
Δ 44004610	SIDEWALK REMOVAL AND REPLACEMENT (SPECIAL)	SQ FT	2,885	1,093	1,792
Δ 44201771	CLASS D PATCHES, TYPE IV, 10 INCH	SQ YD	471	227	244
44300200	STRIP REFLECTIVE CRACK CONTROL TREATMENT	FOOT	3,140	2,168	972
60255500	MANHOLES TO BE ADJUSTED	EACH	1	1	0
67100100	MOBILIZATION	L SUM	1	0.5	0.5
Δ 70101700	TRAFFIC CONTROL AND PROTECTION	L SUM	1	0.5	0.5
70106800	CHANGEABLE MESSAGE SIGN	CAL MO	6	3	3
70300100	SHORT-TERM PAVEMENT MARKING	FOOT	2,504	1,225	1,279
70300210	TEMPORARY PAVEMENT MARKING - LETTERS AND SYMBOLS	SQ FT	541	78	463
70300220	TEMPORARY PAVEMENT MARKING - LINE 4"	FOOT	9,466	4,569	4,897
70300240	TEMPORARY PAVEMENT MARKING - LINE 6"	FOOT	1,105	100	1,005
70300260	TEMPORARY PAVEMENT MARKING - LINE 12"	FOOT	803	18	785
70300280	TEMPORARY PAVEMENT MARKING - LINE 24"	FOOT	203	32	171
70301000	WORK ZONE PAVEMENT MARKING REMOVAL	SQ FT	835	408	427
* 78000100	THERMOPLASTIC PAVEMENT MARKING - LETTERS AND SYMBOLS	SQ FT	541	78	463
* 78000200	THERMOPLASTIC PAVEMENT MARKING - LINE 4"	FOOT	9,466	4,569	4,897
* 78000400	THERMOPLASTIC PAVEMENT MARKING - LINE 6"	FOOT	1,105	100	1,005
* 78000600	THERMOPLASTIC PAVEMENT MARKING - LINE 12"	FOOT	803	18	785
* 78000650	THERMOPLASTIC PAVEMENT MARKING - LINE 24"	FOOT	203	32	171
* 78100100	RAISED REFLECTIVE PAVEMENT MARKER	EACH	245	116	129
* 78300200	RAISED REFLECTIVE PAVEMENT MARKER REMOVAL	EACH	245	116	129
Δ * 81400115	HANDHOLE TO BE ADJUSTED	EACH	3	0	3
Δ * 88600600	DETECTOR LOOP REPLACEMENT	FOOT	1,434	171	1,263
Δ X0321556	SANITARY MANHOLES TO BE ADJUSTED	EACH	2	2	0
Δ XX006425	RESTORATION	SQ YD	468	223	245
Δ XX006947	HOT-MIX ASPHALT DRIVEWAY REMOVAL AND REPLACEMENT	SQ YD	19	19	0

Δ SEE SPECIAL PROVISIONS  
\* SPECIALTY ITEMS

Plotted: August 14, 2009 @ 10:48 AM By: Kris Ping - Tab: 03\_Sum of Quant 22x34

COPYRIGHT © 2009 ENGINEERING ENTERPRISES, INC.

**Engineering Enterprises, Inc.**  
CONSULTING ENGINEERS  
52 Wheeler Road  
Sugar Grove, Illinois 60554  
630.466.6700 / www.eeiweb.com

**VILLAGE OF MONTGOMERY**  
Kane & Kendall Counties, Illinois

NO.	DATE	REVISIONS

**DOUGLAS ROAD  
LAPP IMPROVEMENTS**

**SUMMARY OF QUANTITIES**

DATE:	AUGUST 2009
PROJECT NO:	M00762
FILE:	M00762-CVR
SHEET	<b>3</b> OF <b>17</b>

Path: H:\5858\PROJ\M00762\DWG\DWG\_FINAL\_ENG\M00762-CVR

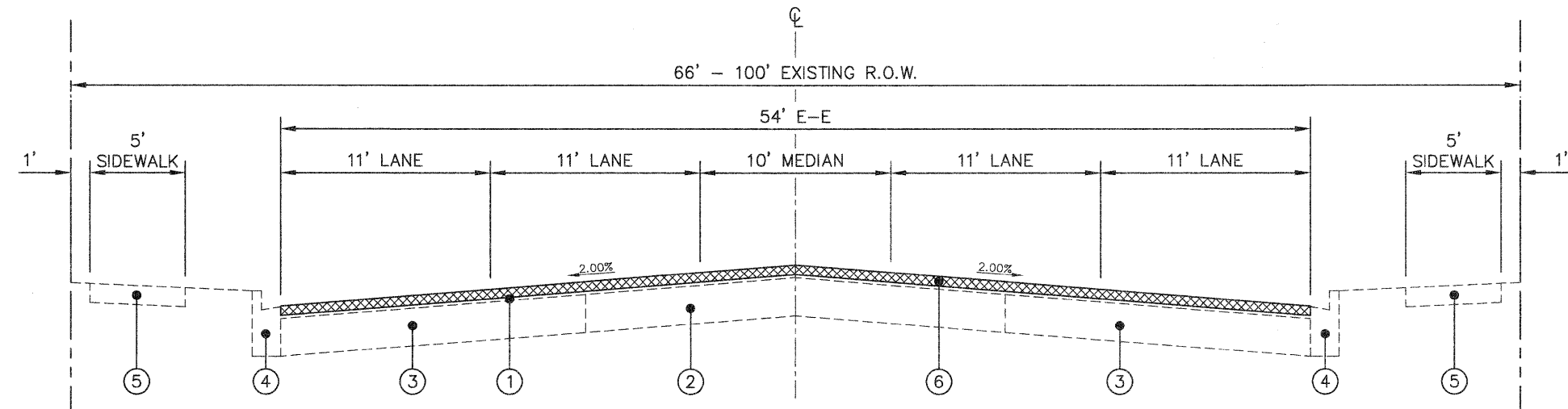

**EXISTING TYPICAL SECTION**  
FROM STA 34+41 TO STA 51+00, DOUGLAS ROAD  
N.T.S.

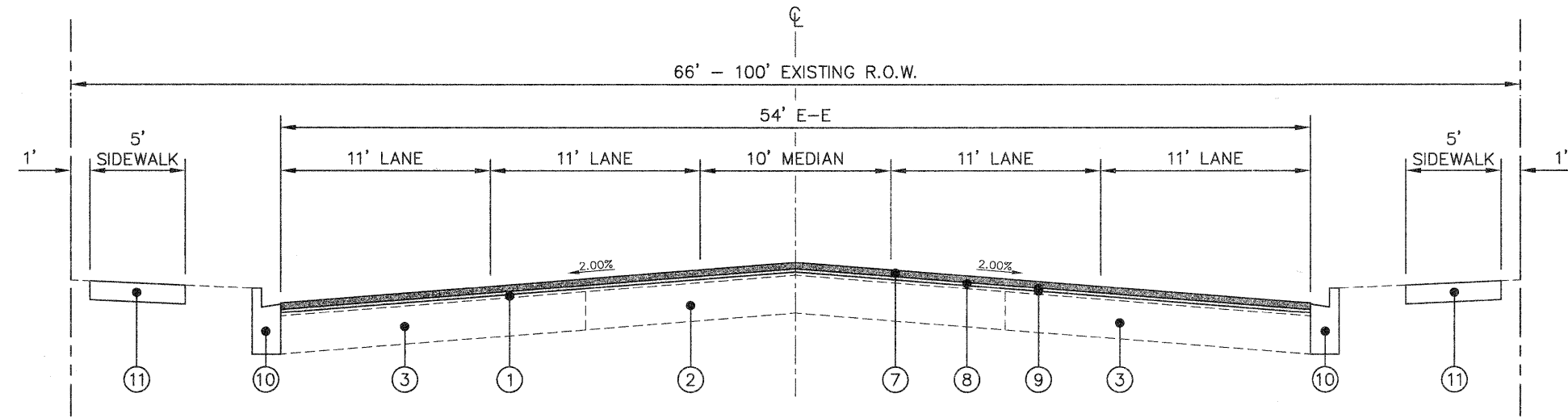

**PROPOSED TYPICAL SECTION**  
FROM STA 34+41 TO STA 51+00, DOUGLAS ROAD  
N.T.S.

LEGEND	
① EXISTING 2.75" TO 5.75" ASPHALT SURFACE COURSE**	⑦ HOT-MIX ASPHALT SURFACE COURSE, MIX "D", N70, 2.0"
② EXISTING 8" TO 12" AGGREGATE BASE COURSE	⑧ LEVELING BINDER (MACHINE METHOD), N70, 1.0"
③ EXISTING 7" TO 9" ASPHALT BASE COURSE	⑨ BITUMINOUS MATERIALS (PRIME COAT) AND AGGREGATE (PRIME COAT)
④ EXISTING B-6.12 COMBINATION CONCRETE CURB AND GUTTER	⑩ COMBINATION CONCRETE CURB AND GUTTER REMOVAL AND REPLACEMENT (AT VARIOUS LOCATIONS)
⑤ EXISTING PORTLAND CEMENT CONCRETE SIDEWALK, 5"	⑪ PORTLAND CEMENT CONCRETE SIDEWALK REMOVAL AND REPLACEMENT (AT VARIOUS LOCATIONS)
⑥ HOT-MIX ASPHALT SURFACE REMOVAL, 3"	

\*\* ASPHALT SURFACE COURSE THICKNESS IS 5.75" OVER AREAS OF AGGREGATE BASE COURSE AND 2.75" OVER AREAS OF ASPHALT BASE COURSE.

HOT-MIX ASPHALT MIXTURE REQUIREMENTS	
MIXTURE TYPE	AIR VOIDS @ Ndes
LEVELING BINDER (MACHINE METHOD), N70, (IL-9.5mm)	4% @ 70 Gyr.
HOT-MIX ASPHALT SURFACE COURSE, MIX "D", N70, (IL-9.5mm)	4% @ 70 Gyr.
HOT-MIX ASPHALT DRIVEWAY REMOVAL AND REPLACEMENT HMA SURFACE COURSE, MIX "C", N50, (IL-9.5mm); 2" HMA BASE COURSE (HMA BINDER IL-19mm); 3"	4% @ 50 Gyr. 4% @ 50 Gyr.
CLASS D PATCHES (HMA BINDER IL-19mm)	4% @ 70 Gyr.

THE UNIT WEIGHT USED TO CALCULATE ALL HMA SURFACE MIXTURE QUANTITIES IS 112 LBS/SQ YD/IN. FOR "AC TYPE" AND "PERCENT RAP" SEE DISTRICT ONE SPECIAL PROVISIONS. PATCHING SHALL BE PERFORMED AFTER MILLING OPERATIONS.

Plotted: August 13, 2009 @ 11:08 AM By: Kris Ping - Tab: 04\_X-Sections 22x34

**Engineering Enterprises, Inc.**  
CONSULTING ENGINEERS  
52 Wheeler Road  
Sugar Grove, Illinois 60554  
630.466.6700 / www.eeiweb.com

**VILLAGE OF MONTGOMERY**  
Kane & Kendall Counties, Illinois

NO.	DATE	REVISIONS

**DOUGLAS ROAD**  
LAPP IMPROVEMENTS

**TYPICAL EXISTING AND PROPOSED**  
CROSS SECTIONS AND HOT-MIX ASPHALT  
MIXTURE REQUIREMENT TABLE

DATE: AUGUST 2009  
PROJECT NO: M00762  
FILE: M00762-CVR  
SHEET **4** OF **17**

Path: H:\S\K\K\09\00041\00-RS\DOUGLAS\DWG\FINAL\ENG\M00762-CVR

F.A.P. RTE.	SECTION	COUNTY	TOTAL SHEETS	SHEET NO.
2508	09-00041-00-RS	KANE/KENDALL	17	5
CONTRACT NO. 63299				

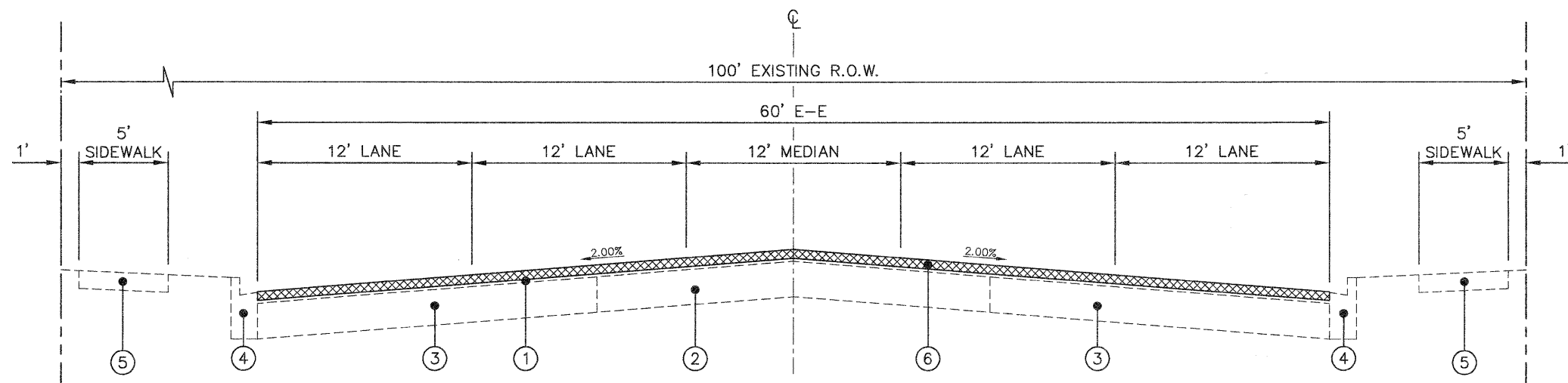

**EXISTING TYPICAL SECTION**  
FROM STA 51+00 TO STA 65+70, DOUGLAS ROAD  
N.T.S.

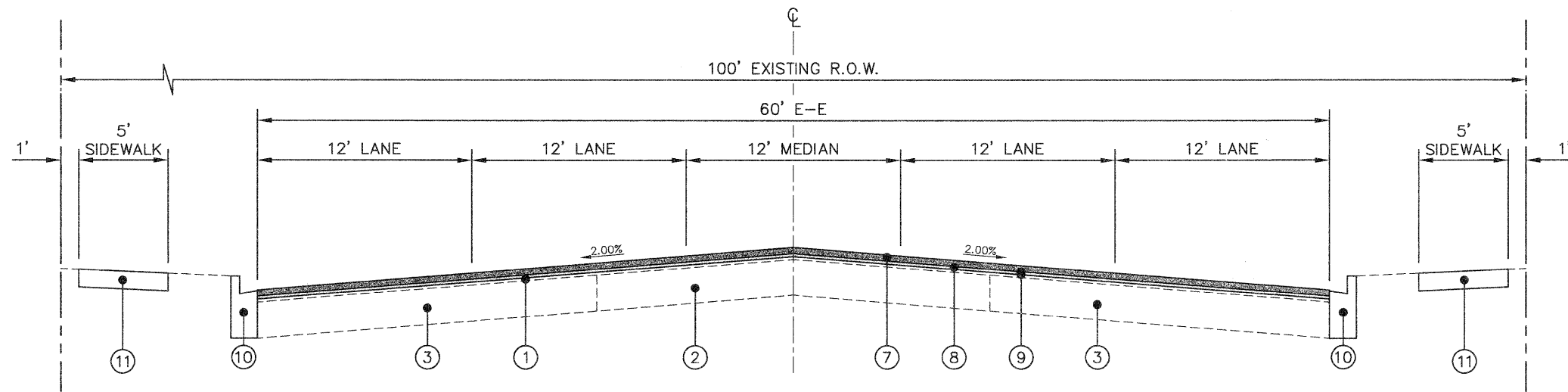

**PROPOSED TYPICAL SECTION**  
FROM STA 51+00 TO STA 65+70, DOUGLAS ROAD  
N.T.S.

LEGEND	
①	EXISTING 2.75" TO 5.75" ASPHALT SURFACE COURSE**
②	EXISTING 8" TO 12" AGGREGATE BASE COURSE
③	EXISTING 7" TO 9" ASPHALT BASE COURSE
④	EXISTING B-6.12 COMBINATION CONCRETE CURB AND GUTTER
⑤	EXISTING PORTLAND CEMENT CONCRETE SIDEWALK, 5"
⑥	HOT-MIX ASPHALT SURFACE REMOVAL, 3"
⑦	HOT-MIX ASPHALT SURFACE COURSE, MIX "D", N70, 2.0"
⑧	LEVELING BINDER (MACHINE METHOD), N70, 1.0"
⑨	BITUMINOUS MATERIALS (PRIME COAT) AND AGGREGATE (PRIME COAT)
⑩	COMBINATION CONCRETE CURB AND GUTTER REMOVAL AND REPLACEMENT (AT VARIOUS LOCATIONS)
⑪	PORTLAND CEMENT CONCRETE SIDEWALK REMOVAL AND REPLACEMENT (AT VARIOUS LOCATIONS)

\*\* ASPHALT SURFACE COURSE THICKNESS IS 5.75" OVER AREAS OF AGGREGATE BASE COURSE AND 2.75" OVER AREAS OF ASPHALT BASE COURSE.

Plotted: August 13, 2009 @ 7:08 AM By: Kris Pung - Tab: 05 X-Sections 22,34

COPYRIGHT © 2009 ENGINEERING ENTERPRISES, INC.

**Engineering Enterprises, Inc.**  
CONSULTING ENGINEERS  
52 Wheeler Road  
Sugar Grove, Illinois 60554  
630.466.6700 / www.eeiweb.com

**VILLAGE OF MONTGOMERY**  
Kane & Kendall Counties, Illinois

NO.	DATE	REVISIONS

**DOUGLAS ROAD**  
LAPP IMPROVEMENTS

**TYPICAL EXISTING AND PROPOSED CROSS SECTIONS**

DATE:	AUGUST 2009
PROJECT NO:	M00762
FILE:	M00762-CVR
SHEET	<b>5</b> OF <b>17</b>

Path: \\S:\KRC\00\M00762\DWG\DWG\_FINAL\ENG\M00762-CVR

F.A.P. RTE.	SECTION	COUNTY	TOTAL SHEETS	SHEET NO.
2508	09-00041-00-RS	KANE/KENDALL	17	6
CONTRACT NO. 63299				

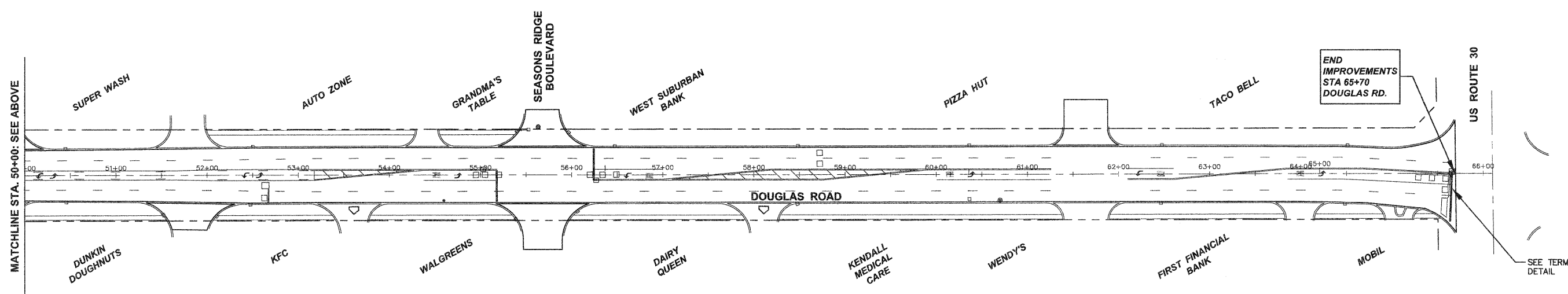
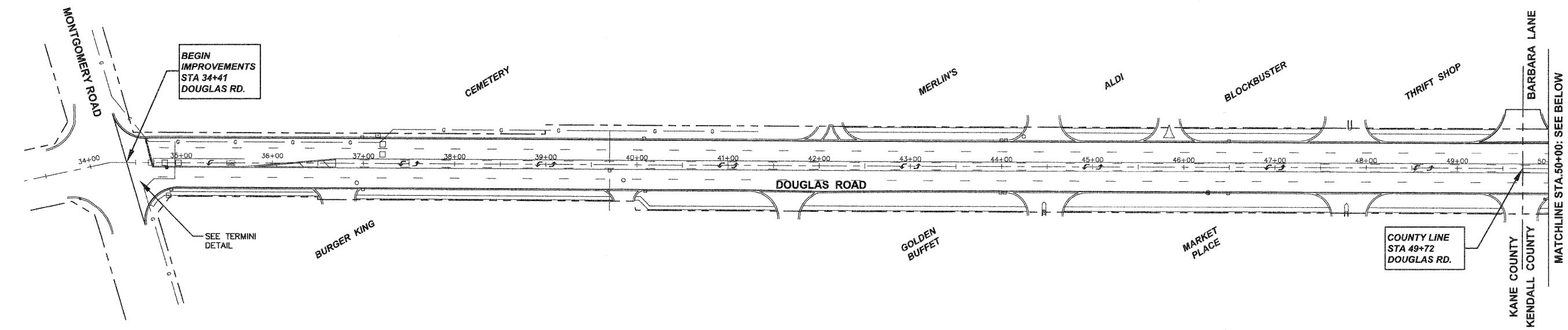
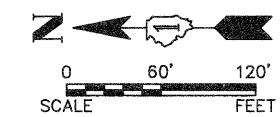

Plotted: August 13, 2009 @ 7:47 AM By: Kris Ping - Job: 06 General 22x34  
 COPYRIGHT © 2009 ENGINEERING ENTERPRISES, INC.

**Engineering Enterprises, Inc.**  
 CONSULTING ENGINEERS  
 52 Wheeler Road  
 Sugar Grove, Illinois 60554  
 630.466.6700 / www.eeiweb.com

**VILLAGE OF MONTGOMERY**  
 Kane & Kendall Counties, Illinois

NO.	DATE	REVISIONS

**DOUGLAS ROAD**  
**LAPP IMPROVEMENTS**

**GENERAL PLAN**

DATE:	AUGUST 2009
PROJECT NO:	M00762
FILE:	M00762-GENERAL
SHEET	<b>6</b> OF <b>17</b>

Path: H:\SP\KRC03\M00762\DWG\FINAL\_ENG\M00762-GENERAL



STA	ADDRESS/LOCATION	PAVEMENT WIDTH (FT)	PAVEMENT LENGTH (FT)	PAVEMENT AREA (SQ FT)	PAVEMENT AREA (SQ YD)	LEVEL BIND (MM, N70)	40600635 HMA SURF. (TONS)	40600100 CSE, MIX D, N70 (GALLON)	40600300 PRIME COAT (TONS)	40600300 AGGREGATE PR. COAT (TONS)	44000161 HMA SURFACE REMOVAL, 3" (SQ YD)
34+41 to 51+00	MAINLINE	54.7	1,659	90,747	10,083.0	564.6	1,129.3	2,016.6	40.3	10,083.0	
51+00 to 65+70	MAINLINE	60	1,470	88,200	9,800.0	548.8	1,097.6	1,960.0	39.2	9,800.0	
49+75	BARBARA LANE INTERSECTION	55	35	1,925	213.9	12.0	24.0	42.8	0.9	213.9	
51+80	DRIVEWAY	55	29	1,595	177.2	9.9	19.8	35.4	0.7	177.2	
55+60	SEASONS RIDGE INTER. - LT	55	40	2,200	244.4	13.7	27.4	48.9	1.0	244.4	
55+60	SEASONS RIDGE INTER. - RT	60	50	3,000	333.3	18.7	37.3	66.7	1.3	333.3	
61+70	DRIVEWAY	50	22	1,100	122.2	6.8	13.7	24.4	0.5	122.2	
						<b>1174.6</b>	<b>2349.1</b>	<b>4194.8</b>	<b>83.9</b>	<b>20974.1</b>	
						TONS	TONS	GALLON	TONS	SY	

STA	DIRECTION	ADDRESS/LOCATION	SW REM. & REPL. (SPL) WIDTH (FT)	SW REM. & REPL. (SPL) LENGTH (FT)	44004610 SW REM. & REPL. (SPL) (SQ FT)	DETECTABLE WARNINGS WIDTH (FT)	DETECTABLE WARNINGS LENGTH (FT)	42400800 DETECTABLE WARNINGS (SQ FT)
34+70	RT	BURGER KING	4.1	9	36.9	4	2	8.0
34+80	RT	BURGER KING	5	2.2	11.0			
36+00	RT	BURGER KING	4.1	5.6	23.0			
35+50	RT	BURGER KING	4	6	24.0	3	2	6.0
37+00	RT	EMPTY LOT	4	5	20.0	3	2	6.0
39+60	RT	EMPTY LOT	4	6.5	26.0	3	2	6.0
40+00	RT	EMPTY LOT	5	5	25.0	4	2	8.0
40+30	RT	EMPTY LOT	5	9	45.0			
41+50	RT	EMPTY LOT	5	8	40.0	4	2	8.0
41+80	RT	GOLDEN BUFFET	5	7.5	37.5	4	2	8.0
43+70	RT	GOLDEN BUFFET	5	16.5	82.5			0.0
44+10	RT	GOLDEN BUFFET	5	6.5	32.5	4	2	8.0
44+70	RT	MARKET PLACE	5	7	35.0	4	2	8.0
46+50	RT	MARKET PLACE	5	5	25.0			
47+50	RT	MARKET PLACE	5	4	20.0	4	2	8.0
48+00	RT	MARKET PLACE	5	6	30.0	4	2	8.0
49+40	RT	MARKET PLACE	4.6	7.2	33.1	4	2	8.0
50+00	RT	DUNKIN DONUTS	6	4	24.0	4	2	8.0
51+00	RT	DUNKIN DONUTS	5	5	25.0			
51+50	RT	DUNKIN DONUTS	5	24	120.0	4	2	8.0
52+10	RT	KFC	5	3	15.0	4	2	8.0
53+20	RT	KFC	5	10	50.0	4	2	8.0
53+35	RT	KFC	5.5	7	38.5	4	2	8.0
53+50	RT	WALGREENS	6.5	6.5	42.3	4	2	8.0
53+65	RT	WALGREENS	5.5	5.5	30.3	4	2	8.0
55+20	RT	WALGREENS	5	13	65.0			
55+25	RT	WALGREENS	5.5	8	44.0	4	2	8.0
56+00	RT	DAIRY QUEEN	7	9	63.0	4	2	8.0
57+00	RT	DAIRY QUEEN	5	160	800.0			0.0
57+70	RT	DAIRY QUEEN	5	7.5	37.5	4	2	8.0
58+30	RT	KENDALL MEDICAL CARE	5	6	30.0	4	2	8.0
60+00	RT	KENDALL MEDICAL CARE	5	5	25.0			
60+50	RT	KENDALL MEDICAL CARE	5	5	25.0			
61+40	RT	KENDALL MEDICAL CARE	5	5	25.0	4	2	8.0
62+00	RT	FIRST FINANCIAL BANK	5	3.5	17.5	4	2	8.0
63+70	RT	FIRST FINANCIAL BANK	5	6	30.0	4	2	8.0
64+30	RT	MOBIL	5	6	30.0	4	2	8.0
64+80	RT	MOBIL	5	5	25.0	4	2	8.0
65+40	RT	MOBILE	5	8	40.0	4	2	8.0
56+00	LT	WEST SUBURBAN BANK	6	4.5	27.0	4	2	8.0
55+20	LT	GRANDMA'S TABLE	6	3	18.0	4	2	8.0
54+50	LT	GRANDMA'S TABLE	6	7.5	45.0	4	2	8.0
53+50	LT	AUTO ZONE	5	20	100.0			
49+30	LT	THRIFT SHOP	5.5	20	110.0	4	2	8.0
48+10	LT	THRIFT SHOP	5.5	8	44.0	4	2	8.0
47+40	LT	BLOCKBUSTER	6	8.5	51.0	4	2	8.0
46+00	LT	BLOCKBUSTER	5.5	11.5	63.3	4	2	8.0
45+50	LT	ALDI	6	8	48.0	4	2	8.0
44+70	LT	ALDI	5	6.5	32.5	4	2	8.0
44+10	LT	MERLINS	5	7	35.0	4	2	8.0
43+00	LT	MERLINS	5	25	125.0			
42+50	LT	MERLINS	5	7.5	37.5	4	2	8.0
				565.0	<b>2884.7</b>			<b>314.0</b>
					SF			SF

STA	SIDE	LENGTH (FT)	WIDTH (FT)	40600982 HMA SURF. REM. BUTT JOINT (SQ YD)	SIDE ROAD BUTT JOINT LOCATION - AS MEASURED FROM FROM MAINLINE (FT)	40600990 TEMPORARY RAMP (SQ YD)
34+41	BUTT	65	4.5	33		
36+70	RT	54	2			12
39+85	RT	45	2			10
41+70	RT	70	2			16
42+15	LT	60	2			14
44+50	RT	80	2			18
44+50	LT	80	2			18
45+85	LT	60	2			14
47+75	LT	80	2			18
48+75	RT	80	2			18
49+75	RT	80	2			18
49+75	LT/BUTT	40	4.5	20	35	
51+75	RT/BUTT	40	4.5	20	29	
51+75	LT	60	2			14
53+30	RT	60	2			14
54+40	LT	50	2			12
55+65	RT/BUTT	45	4.5	23	40	
55+65	LT/BUTT	60	4.5	30	50	
58+10	RT	70	2			16
61+65	RT	80	2			18
61+65	LT/BUTT	60	4.5	30	22	
64+00	RT	60	2			14
65+10	RT	40	2			9
65+70	BUTT	65	4.5	33		
				<b>189.0</b>		<b>253.0</b>
				SY		SY

\*DRIVEWAY TEMPORARY RAMPS SHALL BE 2' WIDE

STA	PAVEMENT PATCH WIDTH (FT)	PAVEMENT PATCH LENGTH (FT)	REPAIR AREA (SQ FT)	44201771 REPAIR AREA - TY IV (SQ YD)
42+00	12	50	600	67.0
43+10	7	35	245	28.0
45+50	12	30	360	40.0
47+00	12	50	600	67.0
49+75	2	110	220	25.0
49+75	7	50	350	39.0
52+50	7	35	245	28.0
55+50	12	50	600	67.0
55+50	12	50	600	67.0
64+00	7	55	385	43.0
				<b>471.0</b>
				SY

STA	OFFSET	X0321556 SANITARY M.H. TO BE ADJ. (EACH)	60255500 MANHOLES TO BE ADJ. (EACH)	81400115 HANDHOLE TO BE ADJ. (EACH)
34+75	5' RT		1	
36+85	17' RT	1		
39+85	11' RT	1		
55+02	6' RT			1
56+24	6' RT			1
65+65	0' RT			1
		<b>2</b>	<b>1</b>	<b>3</b>
		EACH	EACH	EACH

STA	DIRECTION	ADDRESS/LOCATION	44001700 CURB & GUTTER REM. & REPL. LENGTH (FT)	44002400 CURB REMOVAL (SPECIAL) LENGTH (FT)	XX006947 HMA DRIVEWAY REM. & REPLACE. AREA (SQ YD)
39+00	RT	EMPTY LOT	80.0		
42+00	RT	GOLDEN BUFFET	65.0		
46+60	RT	MARKET PLACE	20.0		
48+00	RT	MARKET PLACE	50.0		12.0
51+50	RT	DUNKIN DONUTS	30.0		
52+00	RT	KFC	20.0		
53+70	RT	WALGREENS	20.0		
54+60	RT	WALGREENS	30.0		
57+00	RT	DAIRY QUEEN	135.0		
58+30	RT	KENDALL MEDICAL CARE	35.0		
61+10	RT	KENDALL MEDICAL CARE	20.0		
63+00	RT	FIRST FINANCIAL BANK	100.0		
64+50	RT	MOBIL	30.0		
63+00	LT	TACO BELL	100.0		
60+00	LT	PIZZA HUT	30.0		
57+00	LT	PIZZA HUT	100.0		
55+40	LT	GRANDMA'S TABLE	35.0		
54+50	LT	GRANDMA'S TABLE	7.0		
53+00	LT	AUTO ZONE	40.0		
50+00	LT	BARBARA LANE	10.0		
49+75	LT	BARBARA LANE		110.0	
47+00	LT	BLOCKBUSTER	60.0		
45+50	LT	ALDI	35.0		
45+20	LT	ALDI	15.0		
44+70	LT	ALDI	10.0		
44+30	LT	MERLINS	30.0		7.0
44+20	LT	MERLINS	10.0		
43+00	LT	MERLINS	83.0		
39+50	LT	CEMETERY	110.0		
36+00	LT	CEMETERY	200.0		
			<b>1510.0</b>	<b>110.0</b>	<b>19.0</b>
			FT	FT	SQ YD

STA	OFFSET	44300200 STRIP REFLC. CRACK CONTROL TREAT. (FOOT)
40+23 to 53+23	13' RT	1300
40+23 to 53+23	13' LT	1300
TRANSVERSE CRACKING (AS NEEDED)		540
		<b>3140</b>
		FOOT

STA/LOCATION	RESTORATION WIDTH (FT)	RESTORATION LENGTH (FT)	RESTORATION AREA (SQ FT)	XX006425 RESTORATION AREA (SQ YD)
BEHIND CURB AND GUTTER REMOVAL	2	1510	3020	335.6
ADJACENT TO SIDEWALK REMOVAL	2	565	1130	125.6
STA 37+00 - FILL IN LOW SPOT BEHIND CURB	4	8	32	3.6
STA 60+00 - FILL IN DEPRESSION	5	6	30	3.3
				<b>468.0</b>
				SY

NOTE:  
ALL QUANTITIES SHOWN IN THE SCHEDULES ARE APPROXIMATE. THE ENGINEER WILL LOCATE ALL IMPROVEMENTS IN THE FIELD PRIOR TO CONSTRUCTION. PAYMENT SHALL BE BASED ON ACTUAL FIELD MEASUREMENTS.

Printed: August 14, 2009 @ 10:21 AM By: Kris Pung - Tab: 08\_Schedule 22x34

**Engineering Enterprises, Inc.**  
CONSULTING ENGINEERS  
52 Wheeler Road  
Sugar Grove, Illinois 60554  
630.466.6700 / www.eeiweb.com

**VILLAGE OF MONTGOMERY**  
Kane & Kendall Counties, Illinois

NO.	DATE	REVISIONS

**DOUGLAS ROAD**  
**LAPP IMPROVEMENTS**

**SCHEDULE OF QUANTITIES**

DATE: AUGUST 2009  
PROJECT NO: MO0762  
FILE: MO0762-CVR  
SHEET **8** OF **17**

Path: H:\SR\SR\PROJECTS\MO0762\DWG\DWG\_FINAL\_ENG\M00762-CVR



PAVEMENT MARKINGS SCHEDULE																																				
		THERMOPLASTIC PAVEMENT MARKINGS										TEMPORARY PAVEMENT MARKINGS					SHORT TERM PAVEMENT MARKING	WORKZONE PAVEMENT MARKING REMOVAL																		
		4"										6"					12"					24"					LETTERS & SYMBOLS					LETTERS & SYMBOLS				
TYPE	STA / DESCRIPTION	LOCATION	YEL.- SKIP DASH	YEL.- SOLID	YEL.- DOUBLE	WHITE	WHITE	DIAGONAL YELLOW	DIAGONAL WHITE	STOP BAR WHITE	LETTERS & SYMBOLS	4"	6"	12"	24"	LETTERS & SYMBOLS	4"	6"	12"	24"	LETTERS & SYMBOLS	LF	LF	LF	LF	SQ FT	LF	SQ FT								
CENTER TURN LANES	NB	B/W MONT. RD. & SEAS. RIDGE	410	1648													2058																			
	SB	B/W MONT. RD. & SEAS. RIDGE	410	1648													2058																			
LANE LINES	10' EVERY 40'	NORTHBOUND LANES				780											780																			
	10' EVERY 40'	SOUTHBOUND LANES				780											780																			
TURN LANES	FOR 100' STORAGE	NB AT MONTGOMERY RD.			200		100										200	100																		
	FOR 100' STORAGE	SB AT SEASONS RIDGE BLVD.			200		100										200	100																		
	FOR 100' STORAGE	NB AT SEASONS RIDGE BLVD.			200		100										200	100																		
	FOR 125' STORAGE	SB AT PIZZA HUT			250		125										250	125																		
	FOR 50' STORAGE	NB AT PIZZA HUT			100		50										100	50																		
	FOR 180' STORAGE	SB AT US ROUTE 30			360		180										360	180																		
DIAGONAL AREAS	IN 120' TAPER	NB AT MONTGOMERY RD.		10	480			18									490		18																	
	IN 120' TAPER	SB AT SEASONS RIDGE BLVD.		10	480			37									490		37																	
	IN 120' TAPER	NB AT SEASONS RIDGE BLVD.		10	480			37									490		37																	
	IN 160' TAPER	SB AT PIZZA HUT			640			65									640		65																	
	IN 125' TAPER	B/W PIZZA HUT & US 30			250			65									250		65																	
STOP BARS	34+69	NB AT MONTGOMERY RD.																																		
	55+17	SB AT SEASONS RIDGE BLVD.																																		
	56+23	NB AT SEASONS RIDGE BLVD.																																		
	65+65	SB AT US ROUTE 30																																		
WHITE ARROW & ONLY	35+30 & 35+56	NB AT MONTGOMERY RD.																																		
	54+52 & 54+77	SB AT SEASONS RIDGE BLVD.																																		
	56+00 & 56+85	NB AT SEASONS RIDGE BLVD.																																		
	60+10 & 60+30	SB AT PIZZA HUT																																		
	62+10 & 62+20	NB AT PIZZA HUT																																		
	64+79 & 65+04	SB AT US ROUTE 30																																		
WHITE ARROWS	37+41 TO 52+59	B/W MONT. RD. & SEAS. RIDGE																																		
CROSSWALK	SEASONS RIDGE INTERSECTION - WEST LEG				120		162	21	176	25	41.6	120	162	197	25	41.6																				
	SEASONS RIDGE INTERSECTION - SOUTH LEG						168		224				168	224																						
	SEASONS RIDGE INTERSECTION - EAST LEG						120		160	24			120	160	24																					
SHORT TERM MARKINGS	34+41 TO 65+70																																			
			820	3326	3760	1560	1105	243	560	203	540.8	9466	1105	803	203	540.8	2504	835																		
							9466		803																											
							FOOT		FOOT																											
							78000400		78000600																											
							78000200		78000600																											

RAISED REFLECTIVE PAVEMENT MARKER SCHEDULE						
STA	DIRECTION	ONE-WAY CRYSTAL MARKERS (EACH)	ONE-WAY AMBER MARKERS (EACH)	TWO-WAY AMBER MARKERS (EACH)	78100100 RAISED REFL. PAVE. MARK. (EACH)	78300200 RAISED REFL. PAVE. MARK. REMOV. (EACH)
35+00 TO 65+40 *	RT	39			39	39
35+00 TO 65+40 *	LT	39			39	39
34+70 TO 35+70 *	LT	4			4	4
54+38 TO 55+18 *	RT	4			4	4
56+24 TO 57+00 *	LT	3			3	3
64+65 TO 65+65 *	RT	4			4	4
36+20			1		1	1
53+40			1		1	1
53+80			1		1	1
57+40			1		1	1
57+80			1		1	1
63+80			1		1	1
64+20			1		1	1
34+69				2	2	2
35+00 TO 55+00 **				97	97	97
55+18				2	2	2
56+25				2	2	2
56+60 TO 65+40 **				40	40	40
65+65				2	2	2
		93	7	145	245	245
					EACH	EACH

\* - SEE DETAILS - 80' O.C. BETWEEN SKIP DASH  
 \*\* - SEE DETAILS - 40' O.C., QUANTITY ADJUSTED FOR PLACEMENT OF ON-WAY AMBER MARKERS PER DETAIL

DETECTOR LOOP REPLACEMENT SCHEDULE		
STA	LOCATION / DIRECTION	88600600 DETECTOR LOOP REPL. (FOOT)
34+55	LEFT TURN LANE	39.0
34+64	LEFT TURN LANE	29.0
34+73	LEFT TURN LANE	34.0
37+18	NB OUTBOARD	40.0
37+18	NB OUTBOARD	29.0
52+60	SB OUTBOARD	29.0
52+60	SB OUTBOARD	40.0
54+91	LEFT TURN LANE	29.0
55+03	LEFT TURN LANE	29.0
55+18	LEFT TURN LANE	39.0
SEASONS RIDGE - WEST LEG	LEFT TURN LANE	207.0
SEASONS RIDGE - WEST LEG	THROUGH LANE	147.0
SEASONS RIDGE - EAST LEG	LEFT TURN LANE	207.0
SEASONS RIDGE - EAST LEG	THROUGH LANE	147.0
56+17	LEFT TURN LANE	29.0
56+31	LEFT TURN LANE	29.0
56+46	LEFT TURN LANE	39.0
58+59	NB OUTBOARD	29.0
58+59	NB OUTBOARD	39.0
65+25	LEFT TURN LANE	54.0
65+41	LEFT TURN LANE	39.0
65+56	LEFT TURN LANE	29.0
65+56	CENTER LANE	39.0
65+56	RIGHT LANE	63.0
		1434.0
		FOOT

NOTE:  
 ALL QUANTITIES SHOWN IN THE SCHEDULES ARE APPROXIMATE. THE ENGINEER WILL LOCATE ALL IMPROVEMENTS IN THE FIELD PRIOR TO CONSTRUCTION. PAYMENT SHALL BE BASED ON ACTUAL FIELD MEASUREMENTS.

Plotted: August 14, 2009 @ 10:21 AM By: Kris Pung - Tab: 09 Schedule 22-34  
 Copyright © 2009 ENGINEERING ENTERPRISES, INC.

**Engineering Enterprises, Inc.**  
 CONSULTING ENGINEERS  
 52 Wheeler Road  
 Sugar Grove, Illinois 60554  
 630.456.6700 / www.eeiweb.com

<b>VILLAGE OF MONTGOMERY</b>			
Kane & Kendall Counties, Illinois			
NO.	DATE	REVISIONS	

**DOUGLAS ROAD**  
**LAPP IMPROVEMENTS**

**SCHEDULE OF QUANTITIES**

DATE:	AUGUST 2009
PROJECT NO:	M00762
FILE:	M00762-CVR
SHEET	<b>9</b> OF <b>17</b>

Path: H:\SISKIPROJ\M00762\DWG\FINAL\ENG\M00762-CVR





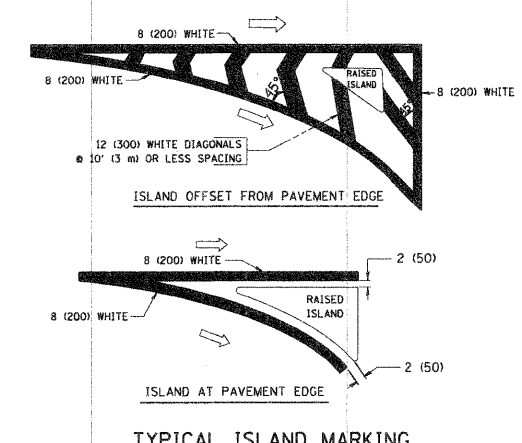
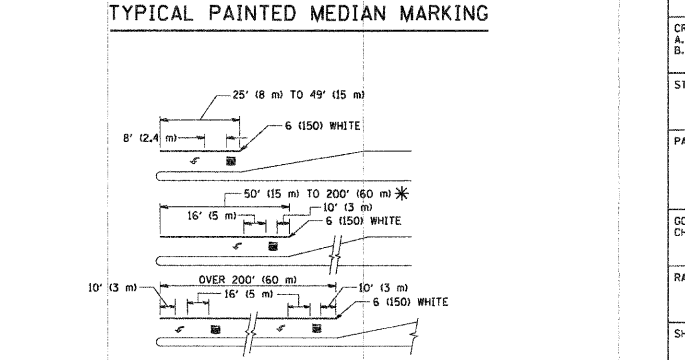
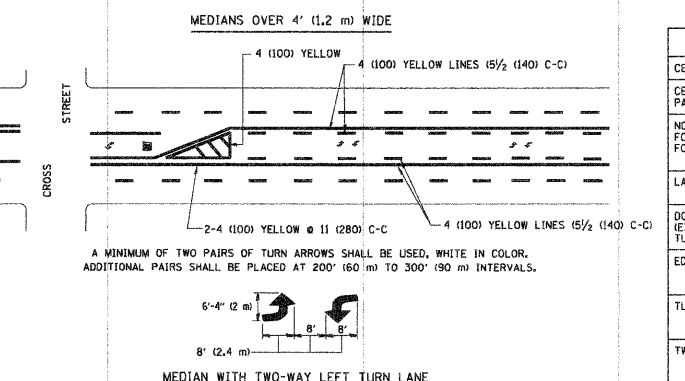
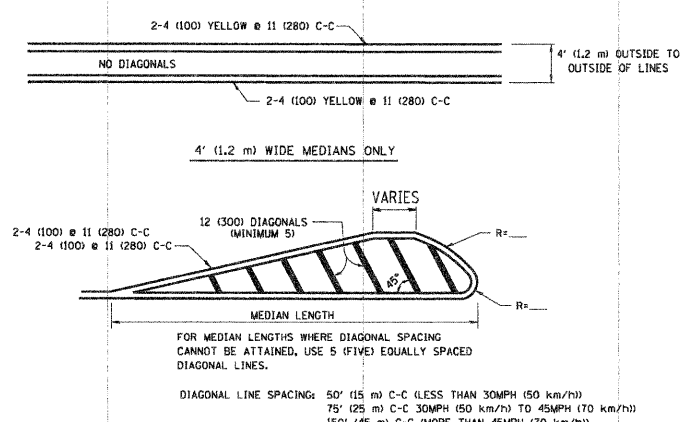
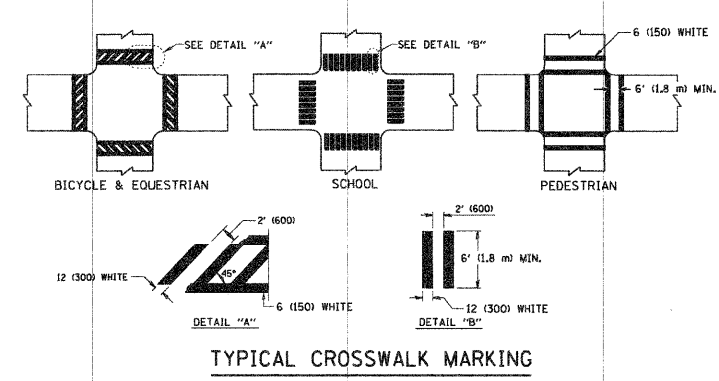
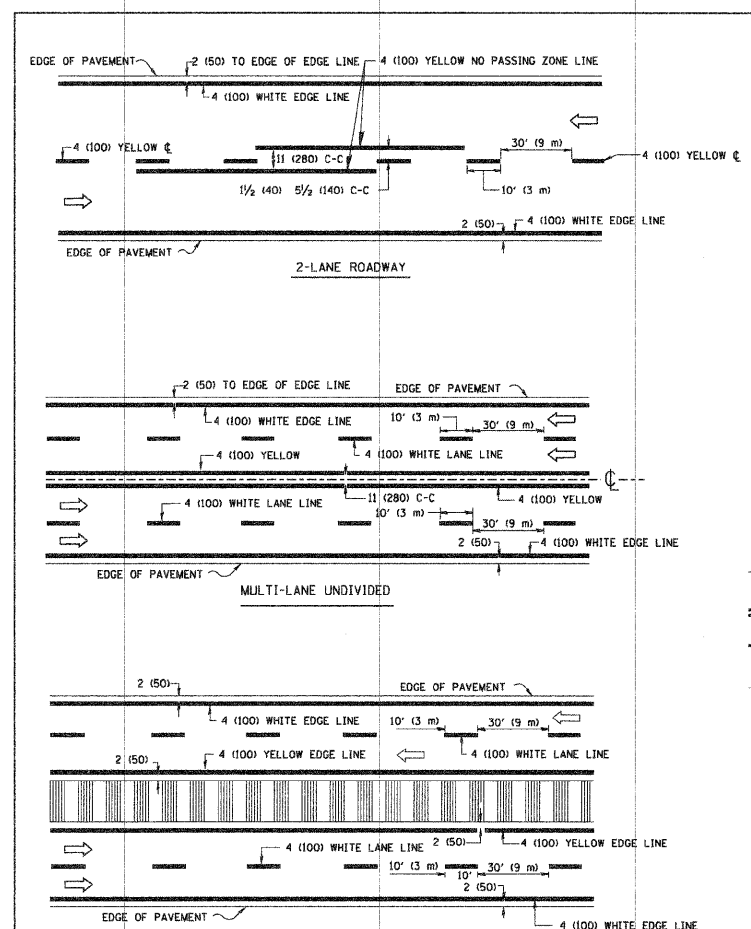

TYPE OF MARKING	WIDTH OF LINE	PATTERN	COLOR	SPACING / REMARKS
CENTERLINE ON 2 LANE PAVEMENT	4 (100)	SKIP-DASH	YELLOW	10' (3 m) LINE WITH 30' (9 m) SPACE
CENTERLINE ON MULTI-LANE UNDIVIDED PAVEMENT	2 @ 4 (100)	SOLID	YELLOW	11 (280) C-C
NO PASSING ZONE LINES FOR ONE DIRECTION FOR BOTH DIRECTIONS	4 (100) 2 @ 4 (100)	SOLID SOLID	YELLOW YELLOW	5/2 (140) C-C FROM SKIP-DASH CENTERLINE 11 (280) C-C OMIT SKIP-DASH CENTERLINE BETWEEN
LANE LINES	4 (100) 5 (125) ON FREEWAYS	SKIP-DASH SKIP-DASH	WHITE WHITE	10' (3 m) LINE WITH 30' (9 m) SPACE
DOTTED LINES (EXTENSIONS OF CENTER, LANE OR TURN LANE MARKINGS)	4 (100)	SKIP-DASH	SAME AS LINE BEING EXTENDED	2' (600) LINE WITH 6' (1.8 m) SPACE
EDGE LINES	4 (100)	SOLID	YELLOW-LEFT WHITE-RIGHT	OUTLINE MOUNTABLE MEDIANS IN YELLOW; EDGE LINES ARE NOT USED NEXT TO BARRIER CURB
TURN LANE MARKINGS	6 (150) LINE; FULL SIZE LETTERS & SYMBOLS 18" (457mm)	SOLID	WHITE	SEE TYPICAL TURN LANE MARKING DETAIL
TWO WAY LEFT TURN MARKING	2 @ 4 (100) EACH DIRECTION 8' (2.4m) LEFT ARROW	SKIP-DASH AND SOLID IN PAIRS	YELLOW WHITE	10' (3 m) LINE WITH 30' (9 m) SPACE FOR SKIP-DASH; 5/2 (140) C-C BETWEEN SOLID LINE AND SKIP-DASH LINE SEE TYPICAL TWO-WAY LEFT TURN MARKING DETAIL
CROSSWALK LINES (PEDESTRIAN A. DIAGONALS (BIKE & EQUESTRIAN) B. LONGITUDINAL BARS (SCHOOL))	2 @ 6 (150) 12 (300) @ 45° 12 (300) @ 90°	SOLID SOLID SOLID	WHITE WHITE WHITE	NOT LESS THAN 6' (1.8 m) APART 2' (600) APART SEE TYPICAL CROSSWALK MARKING DETAILS.
STOP LINES	24 (600)	SOLID	WHITE	PLACE 4' (1.2 m) IN ADVANCE OF AND PARALLEL TO CROSSWALK, IF PRESENT. OTHERWISE, PLACE AT DESIRED STOPPING POINT. PARALLEL TO CROSSROAD CENTERLINE, WHERE POSSIBLE
PAINTED MEDIANS	2 @ 4 (100) WITH 12 (300) DIAGONALS @ 45° NO DIAGONALS USED FOR 4' (1.2 m) WIDE MEDIANS	SOLID	YELLOW; TWO WAY TRAFFIC WHITE; ONE WAY TRAFFIC	11 (280) C-C FOR THE DOUBLE LINE SEE TYPICAL PAINTED MEDIAN MARKING.
CORE MARKING AND CHANNELIZING LINES	8 (200) WITH 12 (300) DIAGONALS @ 45°	SOLID	WHITE	DIAGONALS: 15' (4.5 m) C-C (LESS THAN 30MPH (50 km/h)) 20' (6 m) C-C 30MPH (50 km/h) TO 45MPH (70 km/h) 30' (9 m) C-C (OVER 45MPH (70 km/h))
RAILROAD CROSSING	24 (600) TRANSVERSE LINES; "RR" 15 6" (1.8 m) LETTERS; 16 (400) LINE FOR "X"	SOLID	WHITE	SEE STATE STANDARD 780001 AREA OF: "RR"=3.6 SQ. FT. (0.33 m <sup>2</sup> ) EACH "X"=54.0 SQ. FT. (5.0 m <sup>2</sup> )
SHOULDER DIAGONALS	12 (300) @ 45°	SOLID	WHITE - RIGHT YELLOW - LEFT	50' (15 m) C-C (LESS THAN 30MPH (50 km/h)) 75' (25 m) C-C (30 MPH (50 km/h) TO 45MPH (70 km/h)) 150' (45 m) C-C (OVER 45MPH (70 km/h))

FOR FURTHER DETAILS ON PAVEMENT MARKING REFER TO STANDARD SPECIFICATIONS FOR ROAD AND BRIDGE CONSTRUCTION AND STATE STANDARD 780001.

All dimensions are in inches (millimeters) unless otherwise shown.

REVISIONS		ILLINOIS DEPARTMENT OF TRANSPORTATION	
NAME	DATE		
EVERS	03-19-90		
T. RAMMACHER	10-27-94		
ALEX HOUSEH	10-09-96		
ALEX HOUSEH	10-17-96		
T. RAMMACHER	01-06-00		

SCALE: NONE

DRAWN BY CADD  
CHECKED BY  
TC-13

Plotted: August 13, 2009 @ 7:07 AM By: Kris Pung - Job: 12 TC-13 22x34  
 Copyright © 2009 ENGINEERING ENTERPRISES, INC.

**Engineering Enterprises, Inc.**  
 CONSULTING ENGINEERS  
 52 Wheeler Road  
 Sugar Grove, Illinois 60554  
 630.466.6700 / www.eelweb.com

**VILLAGE OF MONTGOMERY**  
 Kane & Kendall Counties, Illinois

NO.	DATE	REVISIONS

**DOUGLAS ROAD**  
**LAPP IMPROVEMENTS**

**DISTRICT ONE**  
**TYPICAL PAVEMENT MARKINGS**  
**TC-13**

DATE: AUGUST 2009  
 PROJECT NO: MO0762  
 FILE: MO0762-CVR  
 SHEET 12 OF 17

F.A. RTE.	SECTION	COUNTY	TOTAL SHEETS	SHEET NO.
2508	09-00041-00-RS	KANE/KENDALL	17	13
CONTRACT NO. 63299				

CONTRACT NO.				
F.A. RTE.	SECTION	COUNTY	TOTAL SHEETS	SHEET NO.
STA.	TO STA.			
FED. ROAD DIST. NO.	ILLINOIS	FED. AID PROJECT		

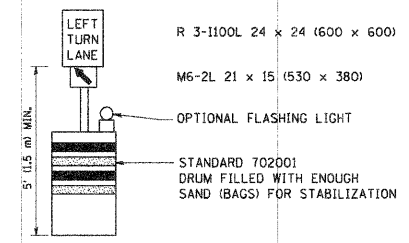
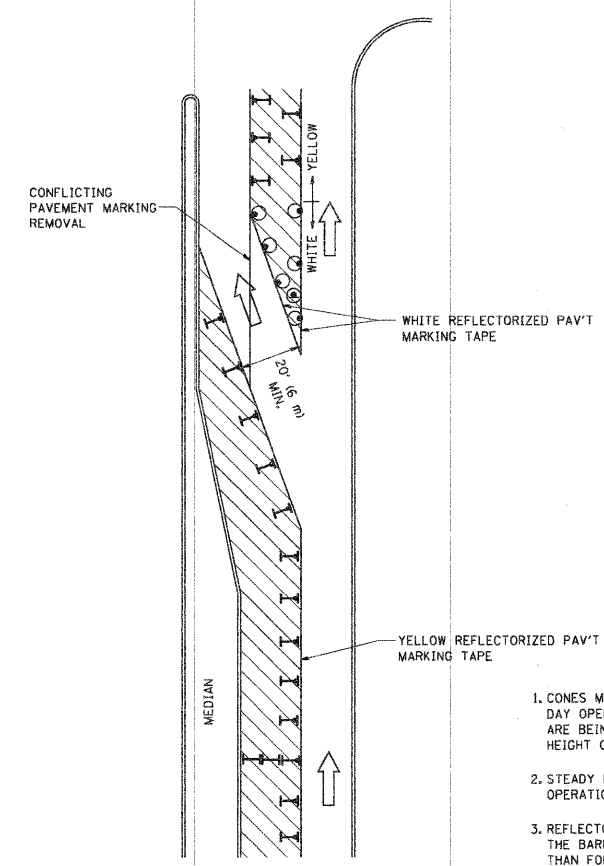

**GENERAL NOTES**

1. CONES MAY BE SUBSTITUTED FOR BARRICADES OR DRUMS AT HALF THE SPACING DURING DAY OPERATIONS. CONES SHALL BE A MINIMUM OF 28 (710) IN HEIGHT. WHEN CONES ARE BEING USED, THE "LEFT TURN LANE" SIGN MAY BE SKID MOUNTED AT A MINIMUM HEIGHT OF 5' (1.5 m).
2. STEADY BURNING LIGHTS WILL NOT BE REQUIRED ON BARRICADES OR DRUMS FOR DAY OPERATIONS. ALL LIGHTS SHALL BE MONODIRECTIONAL.
3. REFLECTORIZED TEMPORARY PAVEMENT MARKING TAPE SHALL BE PLACED THROUGHOUT THE BARRICADED AREA OF EACH TURN BAY WHERE THE CLOSURE TIME IS GREATER THAN FOURTEEN DAYS.
4. THIS APPLICATION ALSO APPLIES WHEN WORK IS BEING PERFORMED IN THE RIGHT LANE(S) AND THE RIGHT TURN BAY IS TO REMAIN OPEN. UNDER THIS CONDITION, "RIGHT TURN LANE" R3-100 24 x 24 (600 x 600) AND M6-2R 21 x 15 (530 x 380) SHALL BE USED.
5. THESE CONTROLS SHALL SUPPLEMENT MAINLINE TRAFFIC CONTROL FOR LANE CLOSURES.
6. LONGITUDINAL DIMENSIONS MAY BE ADJUSTED TO FIT FIELD CONDITIONS.
7. FORM BT 725 IS REQUIRED.
8. TRAFFIC CONTROL AND PROTECTION AT TURN BAYS (TO REMAIN OPEN TO TRAFFIC) SHALL BE INCLUDED IN THE COST SPECIFIED TRAFFIC CONTROL STANDARDS OR ITEMS.

- LEGEND**
- WORK AREA
  - LANE OPEN TO TRAFFIC
  - TYPE I OR II BARRICADE WITH STEADY BURN LIGHT
  - DRUM WITH STEADY BURN LIGHT
  - DRUM WITH SIGN (WITH OPTIONAL FLASHING LIGHT) SEE DETAIL
  - TYPE I OR II CHECK BARRICADE WITH FLASHING LIGHT

All dimensions are in inches (millimeters) unless otherwise shown.

REVISIONS	
NAME	DATE
T. RAMMACHER	09/08/94
A. HOUSEH	11/07/98
A. HOUSEH	10/12/96
T. RAMMACHER	01/06/00

ILLINOIS DEPARTMENT OF TRANSPORTATION  
**TRAFFIC CONTROL AND PROTECTION AT TURN BAYS (TO REMAIN OPEN TO TRAFFIC)**

SCALE: NONE  
 DRAWN BY  
 CHECKED BY LHA  
 TC-14

PLT DATE: 8/16/09  
 FILE NAME: K:\Projects\090809\TC-14.dwg  
 USER NAME: KRAMMACH  
 PLOT DATE: 8/16/09

Plotted: August 13, 2009 @ 7:07 AM By: Kris Pung - Job: 13 TC-14 22x34

**Engineering Enterprises, Inc.**  
 CONSULTING ENGINEERS  
 52 Wheeler Road  
 Sugar Grove, Illinois 60554  
 630.466.6700 / www.eeiweb.com

**VILLAGE OF MONTGOMERY**  
 Kane & Kendall Counties, Illinois

NO.	DATE	REVISIONS

**DOUGLAS ROAD**  
**LAPP IMPROVEMENTS**

**TRAFFIC CONTROL AND PROTECTION AT TURN BAYS**  
**TC-14**

DATE: AUGUST 2009  
 PROJECT NO: M00762  
 FILE: M00762-CVR  
 SHEET **13** OF **17**

Path: H:\S\SKR\PROJ\M00762\DWG\FINAL\_ENG\M00762-CVR

F.A.P. RTE.	SECTION	COUNTY	TOTAL SHEETS	SHEET NO.
2508	09-00041-00-RS	KANE/KENDALL	17	14
CONTRACT NO. 63299				

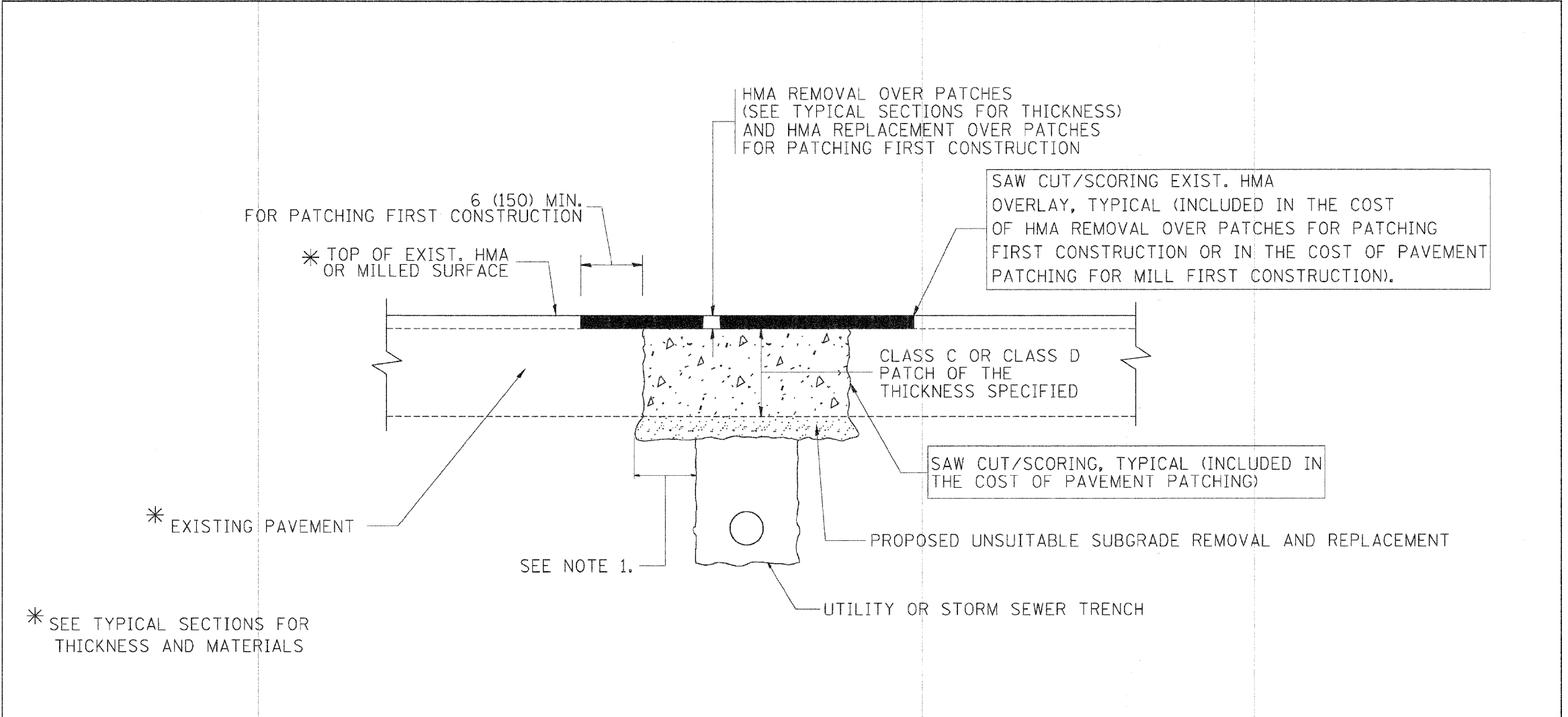

\*SEE TYPICAL SECTIONS FOR THICKNESS AND MATERIALS

**NOTES:**

1. THE WIDTH OF THE FULL DEPTH PATCH OVER A TRENCH SHALL BE 12 (300) WIDER ON EACH SIDE OF THE TRENCH.
2. FOR METHOD OF MEASUREMENT AND BASIS OF PAYMENT, SEE RECURRING SPECIAL PROVISION "PATCHING WITH HOT-MIX ASPHALT OVERLAY REMOVAL".

**SEQUENCE OF CONSTRUCTION (PATCHING FIRST)**

1. REMOVE THE EXISTING HMA MATERIAL OVER THE AREA TO BE PATCHED.
2. REMOVE AND REPLACE WITH CLASS C OR D PATCH.
3. REPLACE HMA MATERIAL OVER THE AREA TO BE PATCHED.

**SEQUENCE OF CONSTRUCTION (MILLING FIRST)**

1. MILL HMA FIRST IF THERE IS AT LEAST 4 1/2 INCHES OR MORE OF HMA MATERIAL ON TOP OF THE EXISTING PAVEMENT OR IF THE PAVEMENT IS FULL DEPTH HMA. A MINIMUM OF 2 INCHES OF HMA MATERIAL SHALL BE IN PLACE AFTER MILLING.
2. REMOVE AND REPLACE WITH FULL DEPTH CLASS D PATCHES TO TOP OF MILLED SURFACE.

ALL DIMENSIONS ARE IN INCHES (MILLIMETERS) UNLESS OTHERWISE SHOWN.

FILE NAME = c:\p\proj\m\td\statd22x34\bd22.dgn	USER NAME = baward1	DESIGNED - R. SHAH	REVISED - A. ABBAS 04-27-98	<b>STATE OF ILLINOIS DEPARTMENT OF TRANSPORTATION</b>	<b>PAVEMENT PATCHING FOR HMA SURFACED PAVEMENT</b>	F.A. RTE.	SECTION	COUNTY	TOTAL SHEETS	SHEET NO.		
		DRAWN -	REVISED - R. BORO 01-01-07			BD400-04 (BD-22)						
		CHECKED -	REVISED - R. BORO 09-04-07			SCALE: NONE	SHEET NO. 1 OF 1 SHEETS	STA.	TO STA.	CONTRACT NO.		
		DATE - 10-25-94	REVISED - K. ENG 10-27-08			FED. ROAD DIST. NO. 1   ILLINOIS FED. AID PROJECT						

**Engineering Enterprises, Inc.**  
CONSULTING ENGINEERS  
52 Wheeler Road  
Sugar Grove, Illinois 60554  
630.466.6700 / www.eeiweb.com

**VILLAGE OF MONTGOMERY**  
Kane & Kendall Counties, Illinois

NO.	DATE	REVISIONS

**DOUGLAS ROAD  
LAPP IMPROVEMENTS**

**PAVEMENT PATCHING FOR  
HMA SURFACED PAVEMENT  
BD-22**

DATE: AUGUST 2009  
PROJECT NO: M00762  
FILE: M00762-CVR  
SHEET **14** OF **17**

Printed: August 25, 2009 @ 3:14 PM By: Kelsi Durgan - Tab: 14, BD-22, 22x34

Path: H:\5858\PROJ\MO0762\DWG\FINAL\ENG\M00762-CVR

F.A.P. RTE.	SECTION	COUNTY	TOTAL SHEETS	SHEET NO.
2508	09-00041-00-RS	KANE/KENDALL	17	15
CONTRACT NO. 63299				

CONTRACT NO.				
F.A. RTE.	SECTION	COUNTY	TOTAL SHEETS	SHEET NO.
STA.		TO STA.		
FED. ROAD DIST. NO. 1 ILLINOIS FED. AID PROJECT				

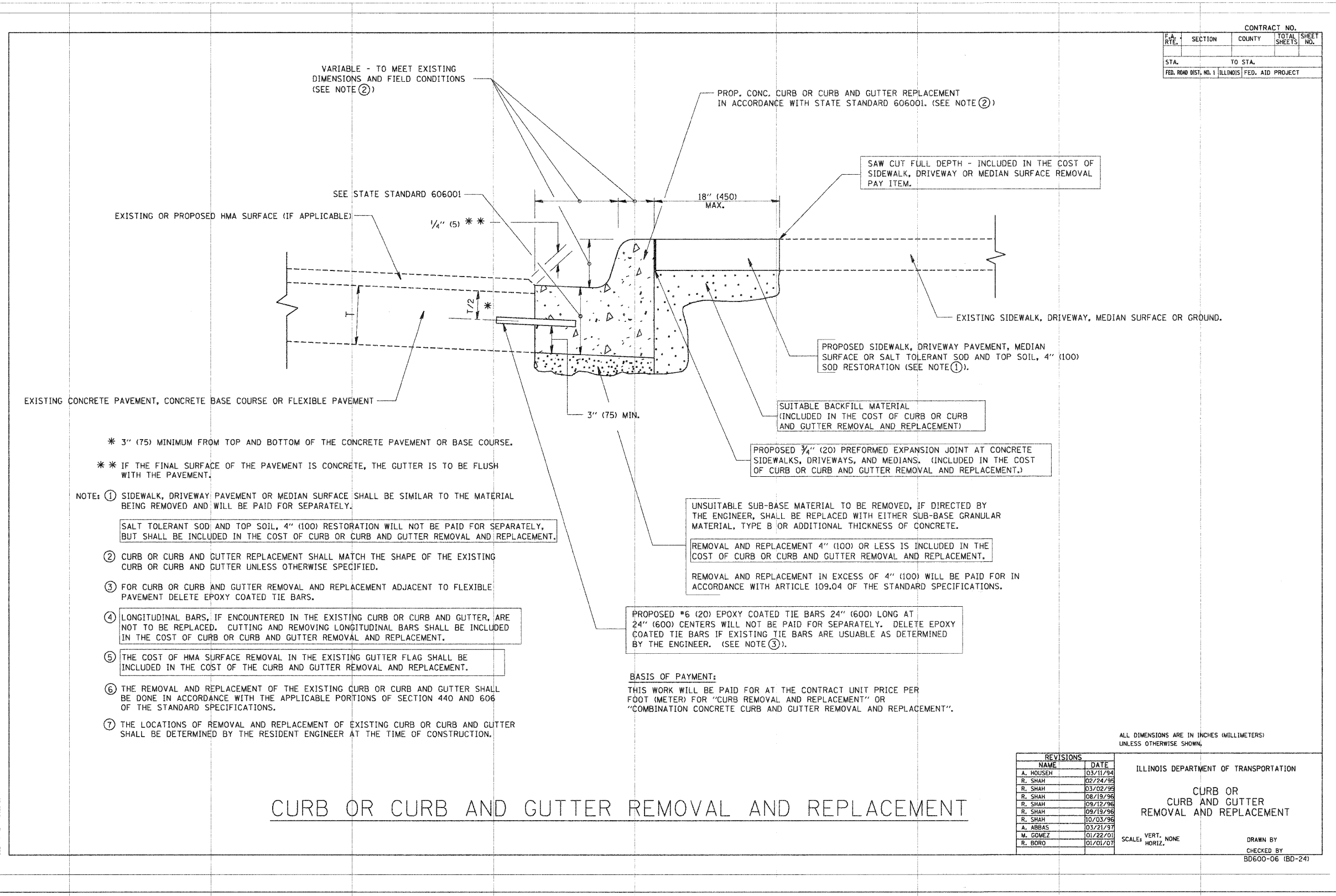

VARIABLE - TO MEET EXISTING DIMENSIONS AND FIELD CONDITIONS (SEE NOTE ②)

SEE STATE STANDARD 606001

EXISTING OR PROPOSED HMA SURFACE (IF APPLICABLE)

1/4" (5) \*\*

EXISTING CONCRETE PAVEMENT, CONCRETE BASE COURSE OR FLEXIBLE PAVEMENT

3" (75) MIN.

PROP. CONC. CURB OR CURB AND GUTTER REPLACEMENT IN ACCORDANCE WITH STATE STANDARD 606001. (SEE NOTE ②)

SAW CUT FULL DEPTH - INCLUDED IN THE COST OF SIDEWALK, DRIVEWAY OR MEDIAN SURFACE REMOVAL PAY ITEM.

EXISTING SIDEWALK, DRIVEWAY, MEDIAN SURFACE OR GROUND.

PROPOSED SIDEWALK, DRIVEWAY PAVEMENT, MEDIAN SURFACE OR SALT TOLERANT SOD AND TOP SOIL, 4" (100) SOD RESTORATION (SEE NOTE ①).

SUITABLE BACKFILL MATERIAL (INCLUDED IN THE COST OF CURB OR CURB AND GUTTER REMOVAL AND REPLACEMENT)

PROPOSED 3/4" (20) PREFORMED EXPANSION JOINT AT CONCRETE SIDEWALKS, DRIVEWAYS, AND MEDIANS. (INCLUDED IN THE COST OF CURB OR CURB AND GUTTER REMOVAL AND REPLACEMENT.)

UNSUITABLE SUB-BASE MATERIAL TO BE REMOVED, IF DIRECTED BY THE ENGINEER, SHALL BE REPLACED WITH EITHER SUB-BASE GRANULAR MATERIAL, TYPE B OR ADDITIONAL THICKNESS OF CONCRETE.

REMOVAL AND REPLACEMENT 4" (100) OR LESS IS INCLUDED IN THE COST OF CURB OR CURB AND GUTTER REMOVAL AND REPLACEMENT.

REMOVAL AND REPLACEMENT IN EXCESS OF 4" (100) WILL BE PAID FOR IN ACCORDANCE WITH ARTICLE 109.04 OF THE STANDARD SPECIFICATIONS.

PROPOSED #6 (20) EPOXY COATED TIE BARS 24" (600) LONG AT 24" (600) CENTERS WILL NOT BE PAID FOR SEPARATELY. DELETE EPOXY COATED TIE BARS IF EXISTING TIE BARS ARE USABLE AS DETERMINED BY THE ENGINEER. (SEE NOTE ③).

**BASIS OF PAYMENT:**  
THIS WORK WILL BE PAID FOR AT THE CONTRACT UNIT PRICE PER FOOT (METER) FOR "CURB REMOVAL AND REPLACEMENT" OR "COMBINATION CONCRETE CURB AND GUTTER REMOVAL AND REPLACEMENT".

- \* 3" (75) MINIMUM FROM TOP AND BOTTOM OF THE CONCRETE PAVEMENT OR BASE COURSE.
- \*\* IF THE FINAL SURFACE OF THE PAVEMENT IS CONCRETE, THE GUTTER IS TO BE FLUSH WITH THE PAVEMENT.
- NOTE: ① SIDEWALK, DRIVEWAY PAVEMENT OR MEDIAN SURFACE SHALL BE SIMILAR TO THE MATERIAL BEING REMOVED AND WILL BE PAID FOR SEPARATELY.  
SALT TOLERANT SOD AND TOP SOIL, 4" (100) RESTORATION WILL NOT BE PAID FOR SEPARATELY, BUT SHALL BE INCLUDED IN THE COST OF CURB OR CURB AND GUTTER REMOVAL AND REPLACEMENT.
- ② CURB OR CURB AND GUTTER REPLACEMENT SHALL MATCH THE SHAPE OF THE EXISTING CURB OR CURB AND GUTTER UNLESS OTHERWISE SPECIFIED.
- ③ FOR CURB OR CURB AND GUTTER REMOVAL AND REPLACEMENT ADJACENT TO FLEXIBLE PAVEMENT DELETE EPOXY COATED TIE BARS.
- ④ LONGITUDINAL BARS, IF ENCOUNTERED IN THE EXISTING CURB OR CURB AND GUTTER, ARE NOT TO BE REPLACED. CUTTING AND REMOVING LONGITUDINAL BARS SHALL BE INCLUDED IN THE COST OF CURB OR CURB AND GUTTER REMOVAL AND REPLACEMENT.
- ⑤ THE COST OF HMA SURFACE REMOVAL IN THE EXISTING GUTTER FLAG SHALL BE INCLUDED IN THE COST OF THE CURB AND GUTTER REMOVAL AND REPLACEMENT.
- ⑥ THE REMOVAL AND REPLACEMENT OF THE EXISTING CURB OR CURB AND GUTTER SHALL BE DONE IN ACCORDANCE WITH THE APPLICABLE PORTIONS OF SECTION 440 AND 606 OF THE STANDARD SPECIFICATIONS.
- ⑦ THE LOCATIONS OF REMOVAL AND REPLACEMENT OF EXISTING CURB OR CURB AND GUTTER SHALL BE DETERMINED BY THE RESIDENT ENGINEER AT THE TIME OF CONSTRUCTION.

ALL DIMENSIONS ARE IN INCHES (MILLIMETERS) UNLESS OTHERWISE SHOWN.

REVISIONS	
NAME	DATE
A. HOUSER	03/11/94
R. SHAH	02/24/96
R. SHAH	03/02/96
R. SHAH	08/19/96
R. SHAH	09/12/96
R. SHAH	09/19/96
R. SHAH	10/03/96
A. ABBAS	03/21/97
M. GOMEZ	01/22/01
R. BORO	01/01/07

ILLINOIS DEPARTMENT OF TRANSPORTATION

CURB OR CURB AND GUTTER REMOVAL AND REPLACEMENT

SCALE: VERT. NONE  
HORIZ.

DRAWN BY  
CHECKED BY  
BD600-06 (BD-24)

## CURB OR CURB AND GUTTER REMOVAL AND REPLACEMENT

Printed: August 13, 2009 @ 11:08 AM By: Kris Pung - Tab: 15 BD-24 22x34

Engineering Enterprises, Inc.  
CONSULTING ENGINEERS  
52 Wheeler Road  
Sugar Grove, Illinois 60554  
630.466.6700 / www.eelweb.com

VILLAGE OF MONTGOMERY  
Kane & Kendall Counties, Illinois

NO.	DATE	REVISIONS

DOUGLAS ROAD  
LAPP IMPROVEMENTS

CURB OR CURB AND GUTTER REMOVAL AND REPLACEMENT - BD-24

DATE: AUGUST 2009  
PROJECT NO: M00762  
FILE: M00762-CVR  
SHEET 15 OF 17

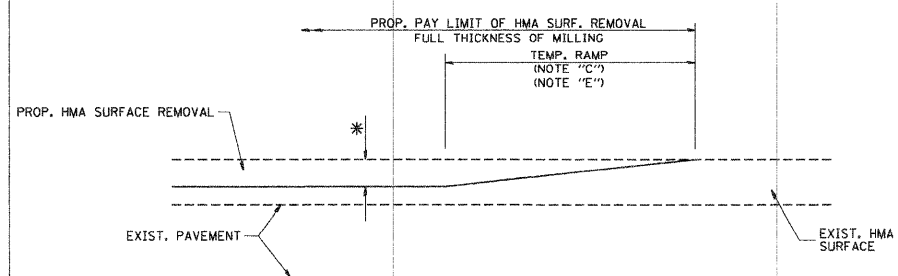

**OPTION 1**  
MILLED TEMPORARY RAMP  
(FOR BUTT JOINT AND HMA TAPER SEE DETAIL BELOW)

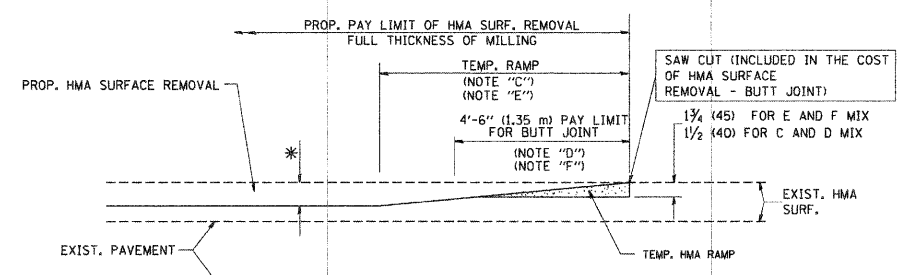

**OPTION 2**  
HMA CONSTRUCTED TEMPORARY RAMP  
(FOR BUTT JOINT AND HMA TAPER SEE DETAIL BELOW)

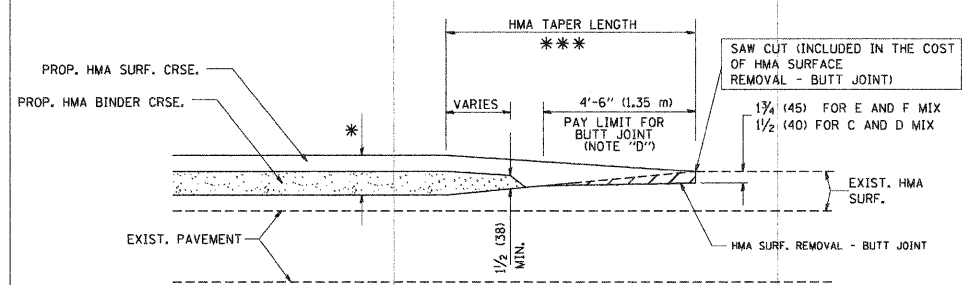

**TYPICAL BUTT JOINT AND HMA TAPER FOR MILLING AND RESURFACING**

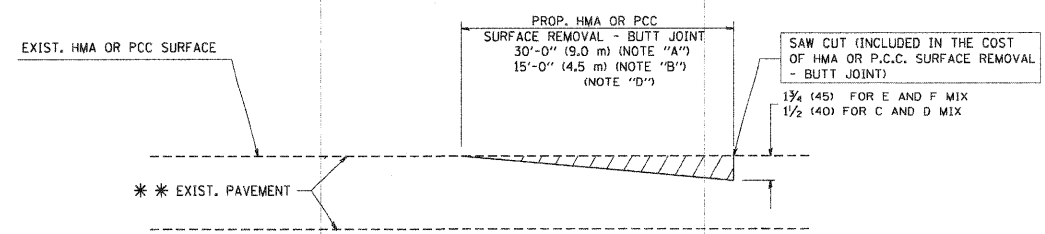

**BUTT JOINT DETAIL**

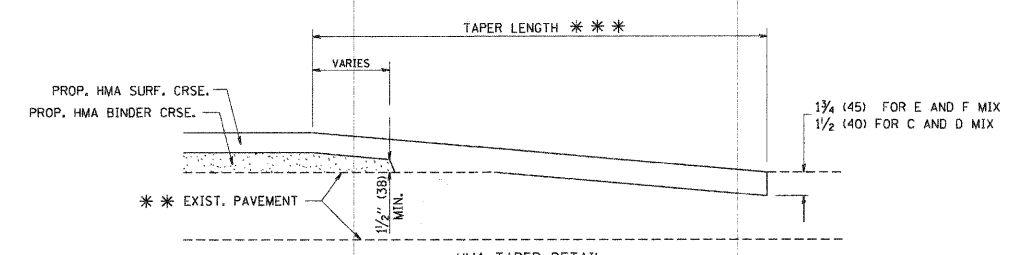

**TYPICAL BUTT JOINT AND HMA TAPER FOR RESURFACING ONLY**

\*\* PC CONCRETE, HMA OR HMA RESURFACED PAVEMENT.

**NOTES**

- A: MAINLINE ROADWAYS AND MAJOR SIDE ROADS.
- B: MINOR SIDE ROADS.
- C: THE TEMP. RAMP SHALL BE CONSTRUCTED IMMEDIATELY UPON REMOVAL OF THE EXISTING HMA SURFACE.
- D: THE BUTT JOINT SHALL BE CONSTRUCTED IMMEDIATELY PRIOR TO PLACING THE PROPOSED HMA COURSES.
- E: TAPER THE TEMP. RAMP AT A RATE OF 3'-0" (900 mm) PER 1 INCH (25 mm) OF MILLING THICKNESS.
- F: INSTALLATION AND REMOVAL OF THE 4'-6" (1.35 m) TEMP. RAMP IS INCLUDED IN COST OF HMA SURFACE REMOVAL - BUTT JOINT
- G: SEE ARTICLE 406.08 AND 406.14 OF THE STANDARD SPECIFICATIONS FOR "HMA AND/OR PCC SURFACE REMOVAL, BUTT JOINT".
- \* SEE TYPICAL SECTIONS FOR MILLING THICKNESS.
- \*\* 20'-0" (6.1 m) PER 1 (25) RESURFACING (NOTE "A")
- \*\* 10'-0" (3.0 m) PER 1 (25) RESURFACING (NOTE "B")

ALL DIMENSIONS ARE IN INCHES (MILLIMETERS) UNLESS OTHERWISE SHOWN.

**BASIS OF PAYMENT:**

THE BUTT JOINT WILL BE PAID FOR AT THE CONTRACT UNIT PRICE PER SQUARE YARD (SQ. YARD) FOR "HOT-MIX ASPHALT SURFACE REMOVAL - BUTT JOINT" OR FOR "PORTLAND CEMENT CONCRETE SURFACE REMOVAL - BUTT JOINT".

REVISIONS	
NAME	DATE
M. DE YONG	6-13-90
M. DE YONG	7-3-90
M. DE YONG	3-27-92
R. SHAH	09/09/94
R. SHAH	10/25/94
A. ABBAS	03/21/97
M. GOMEZ	04/06/01
R. BORD	01/01/07

ILLINOIS DEPARTMENT OF TRANSPORTATION

**BUTT JOINT AND HMA TAPER DETAILS**

SCALE: VERT. NONE

DRAWN BY

CHECKED BY

BD400-05 (VI-BD32)

Plotted: August 13, 2009 10:47 AM By: Kris Pung - Tab: 16 BD-32 22X34  
 PLOT DATE: 8/13/09  
 FILE NAME: I:\Users\kris\My Documents\2009\08\13\22X34.dwg  
 USER NAME: kris

**Engineering Enterprises, Inc.**  
 CONSULTING ENGINEERS  
 52 Wheeler Road  
 Sugar Grove, Illinois 60554  
 630.466.6700 / www.eeiweb.com

**VILLAGE OF MONTGOMERY**  
 Kane & Kendall Counties, Illinois

NO.	DATE	REVISIONS

**DOUGLAS ROAD**  
**LAPP IMPROVEMENTS**

**BUTT JOINT AND HMA TAPER DETAILS**  
**BD-32**

DATE: AUGUST 2009  
 PROJECT NO: M00762  
 FILE: M00762-CVR  
 SHEET **16** OF **17**

Path: I:\Users\kris\My Documents\2009\08\13\22X34.dwg FINAL ENG M00762-CVR



