

HORIZONTAL & VERTICAL CONTROL

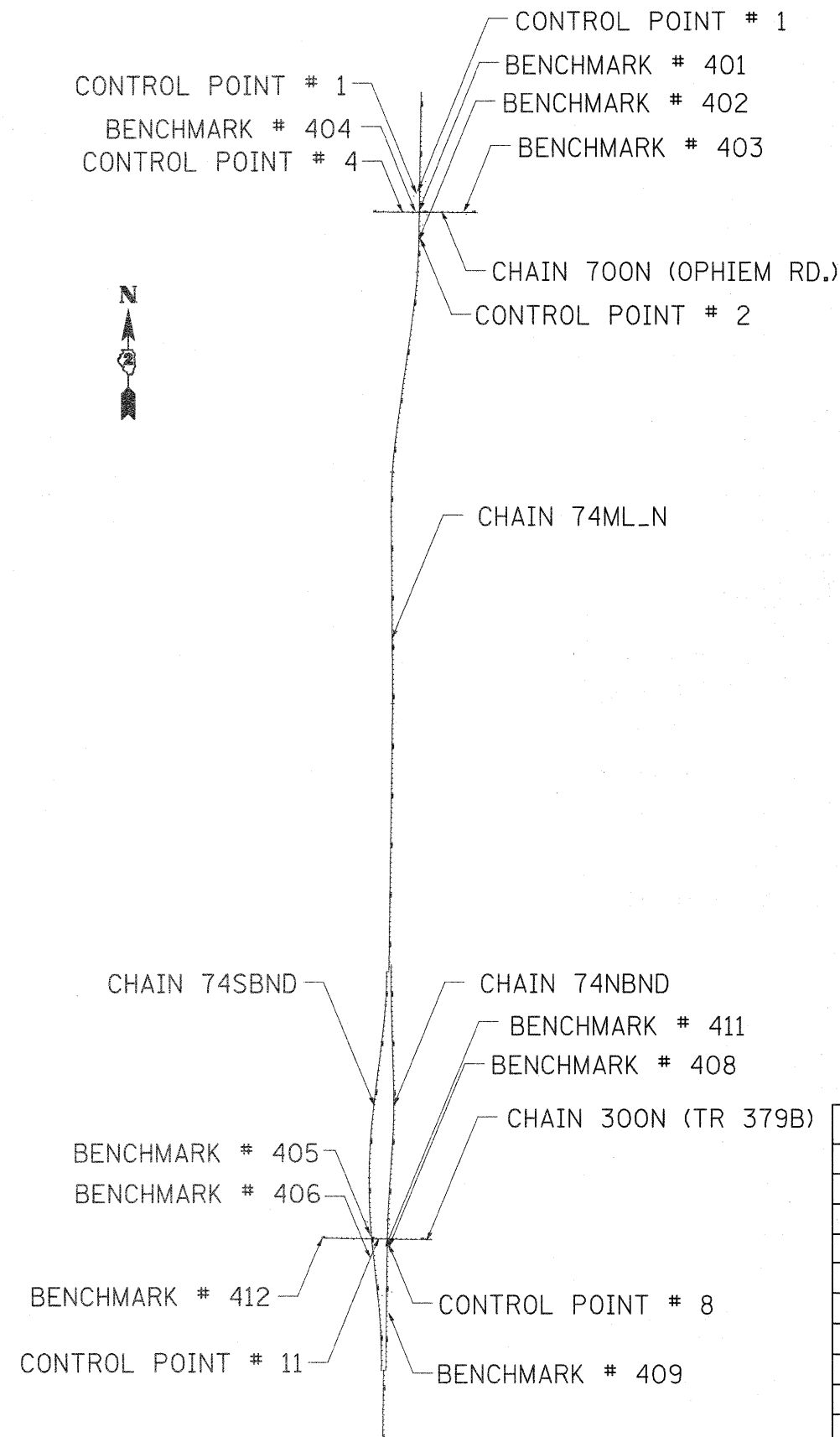

Chain 700N contains:
91 89

Beginning chain 700N description
=====

Point 91 N 1,669,951.39 E 2,250,786.83 Sta 10+00.00

Course from 91 to 89 S 89° 38' 32.65" E Dist 2,098.48'

Point 89 N 1,669,938.29 E 2,252,885.26 Sta 30+98.48

Ending chain 700N description
=====

Chain 74ML_S contains:
59 60

Beginning chain 74ML_S description
=====

Point 59 N 1,646,529.39 E 2,250,998.92 Sta 1656+96.49

Course from 59 to 60 S 0° 45' 04.38" W Dist 1,323.04'

Point 60 N 1,645,206.46 E 2,250,981.57 Sta 1670+19.53

Ending chain 74ML_S description
=====

Chain 300N contains:
98 99

Beginning chain 300N description
=====

Point 98 N 1,649,205.78 E 2,249,753.21 Sta 50+00.00

Course from 98 to 99 S 89° 03' 45.09" E Dist 2,216.82'

Point 99 N 1,649,169.51 E 2,251,969.74 Sta 72+16.82

Ending chain 300N description
=====

Chain 74ML_N contains:
20 CUR 200 CUR 210 CUR 220 37

Beginning chain 74ML_N description
=====

Point 20 N 1,672,342.4931 E 2,251,748.7425 Sta 1398+19.63

Course from 20 to PC 200 S 0° 53' 17.96" W Dist 2,949.5615'

Curve Data

Curve 200

P.I. Station 1435+30.34 N 1,668,632.2352 E 2,251,691.2137

Delta = 7° 05' 41.63" (RT)

Degree = 0° 28' 00.00"

Tangent = 761.1423'

Length = 1,520.3390'

Radius = 12,277.7000'

External = 23.5705'

Long Chord = 1,519.3678'

Mid. Ord. = 23.5253'

P.C. Station 1427+69.20 N 1,669,393.2861 E 2,251,703.0139

P.T. Station 1442+89.53 N 1,667,878.4692 E 2,251,585.5041

C.C. N 1,669,583.6314 E 2,239,426.7895

Course from PT 200 to PC 210 S 7° 58' 59.55" W Dist 2,306.8573'

Curve Data

Curve 210

P.I. Station 1475+10.73 N 1,664,688.4923 E 2,251,138.1354

Delta = 8° 31' 05.03" (LT)

Degree = 0° 28' 00.00"

Tangent = 914.3368'

Length = 1,825.3043'

Radius = 12,277.7000'

External = 33.9989'

Long Chord = 1,823.6237'

Mid. Ord. = 33.9050'

P.C. Station 1465+96.39 N 1,665,593.9681 E 2,251,265.1211

P.T. Station 1484+21.70 N 1,663,774.1953 E 2,251,146.6706

C.C. N 1,663,888.8060 E 2,263,423.8357

Course from PT 210 to PC 220 S 0° 32' 05.48" E Dist 3,134.8674'

Curve Data

Curve 220

P.I. Station 1520+39.13 N 1,660,156.9143 E 2,251,180.4389

Delta = 1° 17' 12.49" (RT)

Degree = 0° 08' 00.00"

Tangent = 482.5713'

Length = 965.1019'

Radius = 42,971.8400'

External = 2.7095'

Long Chord = 965.0817'

Mid. Ord. = 2.7094'

P.C. Station 1515+56.56 N 1,660,639.4645 E 2,251,175.9342

P.T. Station 1525+21.67 N 1,659,674.3846 E 2,251,174.1058

C.C. N 1,660,238.3283 E 2,208,205.9665

Course from PT 220 to 37 S 0° 45' 06.99" W Dist 5,075.8952'

Point 37 N 1,654,598.9265 E 2,251,107.4925 Sta 1575+97.56

Ending chain 74ML_N description
=====

CURVE POINT NUMBERS					
CHAIN	CURVE	PI	CC	PC	PT
74ML_N	200	200	201	202	203
74ML_N	210	210	211	212	213
74ML_N	220	220	221	222	223
74SBND	230	230	231	232	233
74SBND	240	240	241	242	243
74SBND	250	250	251	252	253
74NBND	260	260	261	262	263
74NBND	270	270	271	272	273
74NBND	280	280	281	282	283