

STAGE I

SN 037-0016

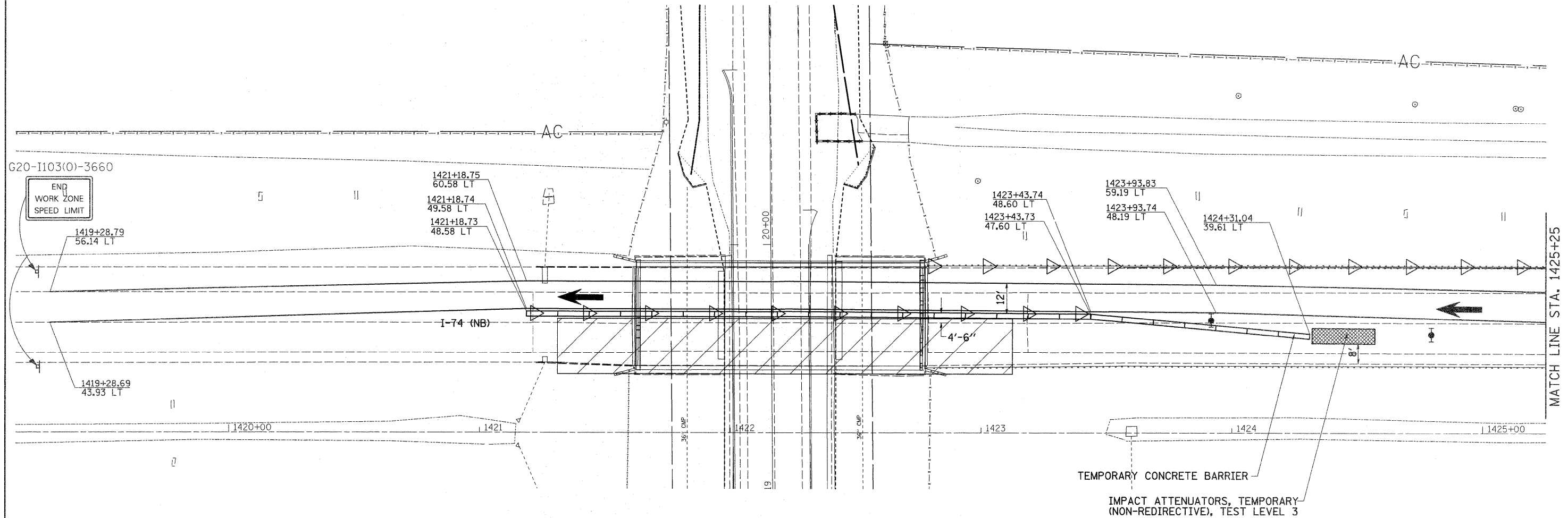

1. USE STANDARD 701402 FOR LANE CLOSURE. SEE STANDARD 701400 FOR APPROACH SIGNING AND DEVICES NOT SHOWN IN PLANS.
2. REMOVAL AND REPLACEMENT OF THE SUPERSTRUCTURE ON THE WEST SIDE OF BRIDGE (SN 037-0016)

SYMBOLS	
	= ARROW BOARD
	= WORK AREA
	= SIGN
	= DIRECTION INDICATOR BARRICADE WITH STEADY BURN MONODIRECTIONAL LIGHT
	= TYPE II BARRICADE, DRUM, OR VERTICAL BARRICADE WITH STEADY BURN MONODIRECTIONAL LIGHT
	= MONODIRECTIONAL BARRIER WALL/GUARDRAIL MARKER
	= IMPACT ATTENUATOR

FILE NAME =	USER NAME = cushmanbw	DESIGNED -	REVISED -	STATE OF ILLINOIS DEPARTMENT OF TRANSPORTATION	STAGE 1 (SN 037-0016) STAGING PLAN SHEETS	F.A.I. RTE.	SECTION	COUNTY	TOTAL SHEETS	SHEET NO.
ci:\pw_work\p\sd\cushmanbw\dns36777\0220298-sh1-staging.dgn	DRAWN -	REVISED -	74			37-14HB,4HB-1,4HB-2ID	HENRY	148	25	
PLOT SCALE = 20.0000' / IN.	CHECKED -	REVISED -	CONTRACT NO. 64264							
PLOT DATE = Wed Aug 05 13:11:46 2009	DATE -	REVISED -	ILLINOIS FED. AID PROJECT							
				SCALE:	SHEET NO. OF SHEETS	STA.	TO STA.			