

Existing Structure: S.N. 037-0015 and 037-0016 Built as F.A.I. 74 in 1967 section 37-4HB. 3 span concrete slab bridges 117'-6" Back to Back Abuts. 43'-8" out to out width. Superstructures and abutments are to be removed and replaced. Traffic is to be maintained using stage construction.

No salvage.

STATE OF ILLINOIS
DEPARTMENT OF TRANSPORTATION

INDEX OF SHEETS

- 1 General Plan & Elevation
- 2 General Data
- 3 Stage Construction Details
- 4 Temporary Concrete Barrier for Stage Construction
- 5-7 Top of Slab Elevations (S.B. & N.B.)
- 8 Top of North Approach Slab Elevation (S.B.)
- 9 Top of South Approach Slab Elevation (S.B.)
- 10 Top of North Approach Slab Elevation (N.B.)
- 11 Top of South Approach Slab Elevation (N.B.)
- 12 Superstructure (S.B.)
- 13 Superstructure (N.B.)
- 14 Superstructure Details
- 15 Bearing Details
- 16 North Abutment (S.B.)
- 17 South Abutment (S.B.)
- 18 North Abutment (N.B.)
- 19 South Abutment (N.B.)
- 20 Piers (S.B.)
- 21 Piers (N.B.)
- 22-23 Bridge Approach Slab Details (S.B.)
- 24-25 Bridge Approach Slab Details (N.B.)
- 26 Bar Splicer Assembly Details
- 27 HP Pile Details
- 28-30 Soil Boring Logs

STATION 1422+16.80
RE-BUILT 20 BY
STATE OF ILLINOIS
F.A.I. RTE. 74 SEC. 37-4HB
LOADING HL-93
STRUCTURE NO. 037-0015 (S.B.)

STATION 1422+16.80
RE-BUILT 20 BY
STATE OF ILLINOIS
F.A.I. RTE. 74 SEC. 37-4HB
LOADING HL-93
STRUCTURE NO. 037-0016 (N.B.)

NAME PLATE

See Std. 515001

Existing Name Plate shall be cleaned and relocated next to new Name Plate. Cost included with Name Plates.

LOADING HL 93

Allow 25#/sq. ft. for future wearing surface.

DESIGN SPECIFICATIONS

2007 AASHTO LRFD Bridge Design Specifications with 2008 Interims (Superstructure)

DESIGN STRESSES

FIELD UNITS NEW CONSTRUCTION	FIELD UNITS EXISTING STRUCTURE
$f'_c = 3,500$ psi	$f'_c = 1,400$ psi
$f_y = 60,000$ psi (reinforcement)	$f_s = 20,000$ psi (Reinforcement)

SEISMIC DATA

New Construction:
Seismic Performance Zone (SPZ) = 1
Design Spectral Acceleration at 1.0 sec. (S_{D1}) = 0.057g
Design Spectral Acceleration at 0.2 Sec. (S_{D5}) = 0.09g
Soil Site Class = D

Existing Piers:
Seismic Performance Category (SPC) = A
Bedrock Acceleration Coefficient (A) = 0.04
Site Coefficient (S) = 1.0

GENERAL PLAN & ELEVATION

I-74 OVER OPHIEM ROAD

F.A.I. RTE. 74 - SEC. 37-4HB

HENRY COUNTY

STA. 1422+16.80

STRUCTURE NO. 037-0015 (S.B.)

STRUCTURE NO. 037-0016 (N.B.)

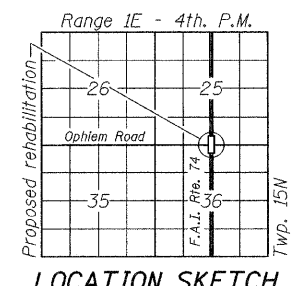
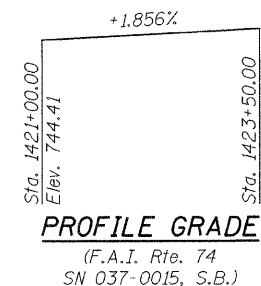
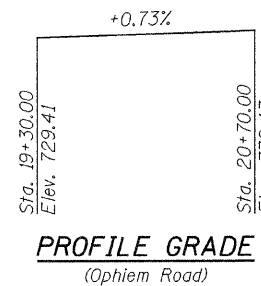
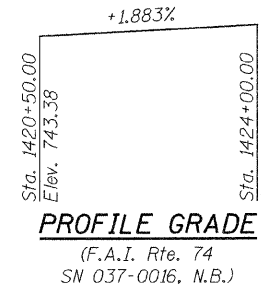
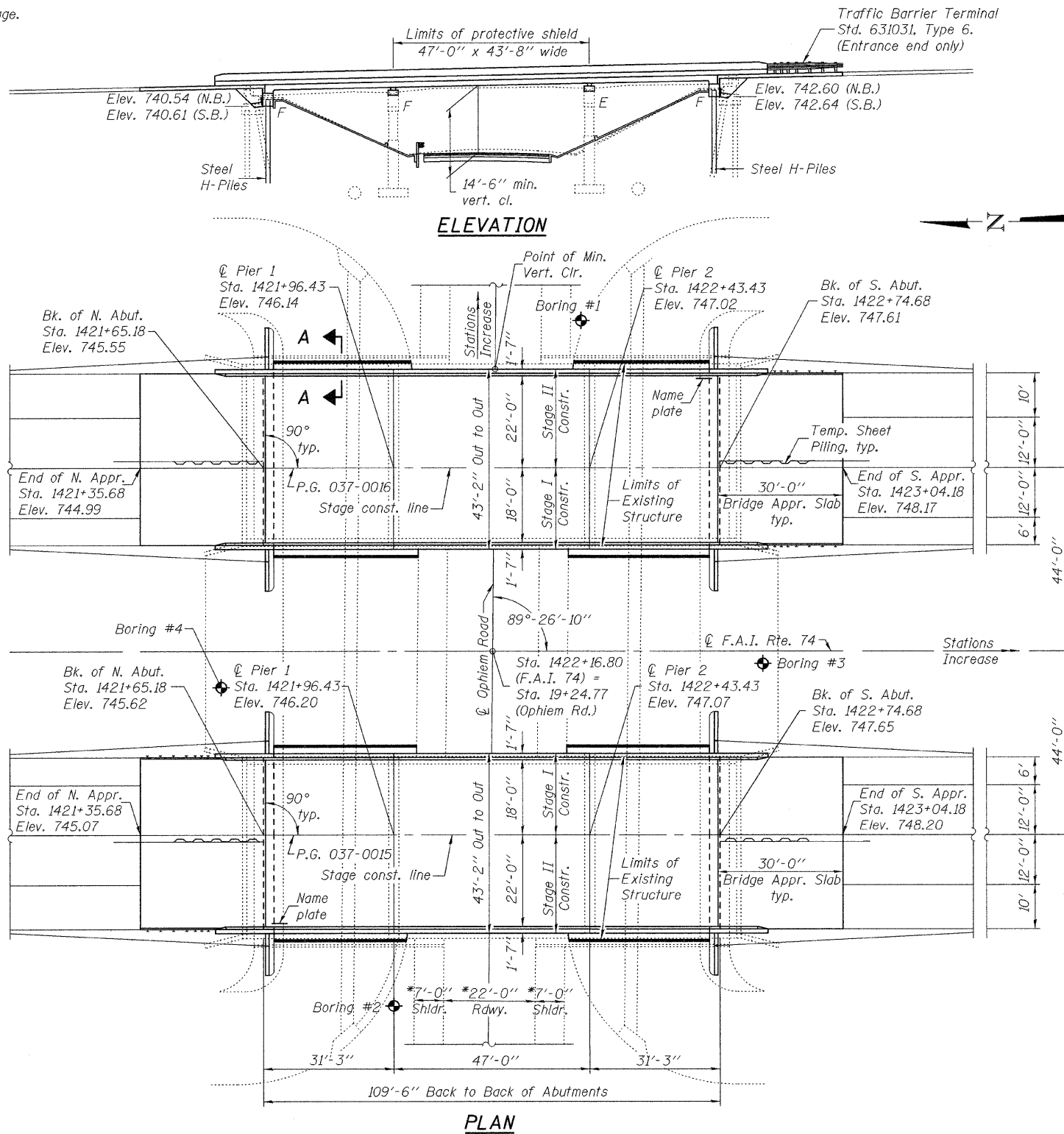

DESIGNED	<i>Allen R. B...</i>
CHECKED	<i>Richard D. Tolson</i>
DRAWN	<i>h.t. duong</i>
CHECKED	<i>NRB/MUR/LGA</i>

EXAMINED	<i>Thomas J. Anderson</i>	September 29, 2009
PASSED	<i>Barth J. Anderson</i>	

Note: For Section A-A see sheet 2 of 30.
* Dimensions are taken from existing plans. For proposed dimensions, see roadway plans.



EXPIRES 11-30-2010

SHEET NO. 1	F.A.I. RTE. 74	SECTION 37-4HB	COUNTY Henry	TOTAL SHEETS 148	SHEET NO. 37
30 SHEET					
CONTRACT NO. 64264					
FED. ROAD DIST. NO. ILLINOIS FED. AID PROJECT					