

STATE OF ILLINOIS
DEPARTMENT OF TRANSPORTATION

Notes: See sheet 25 of 30 for Sections C-C & D-D and View E-E.
a₁₀₀ (E), a₁₀₁ (E), and w₁₀₀ (E) bar spacings measured perpendicular to \varnothing Rdwy.

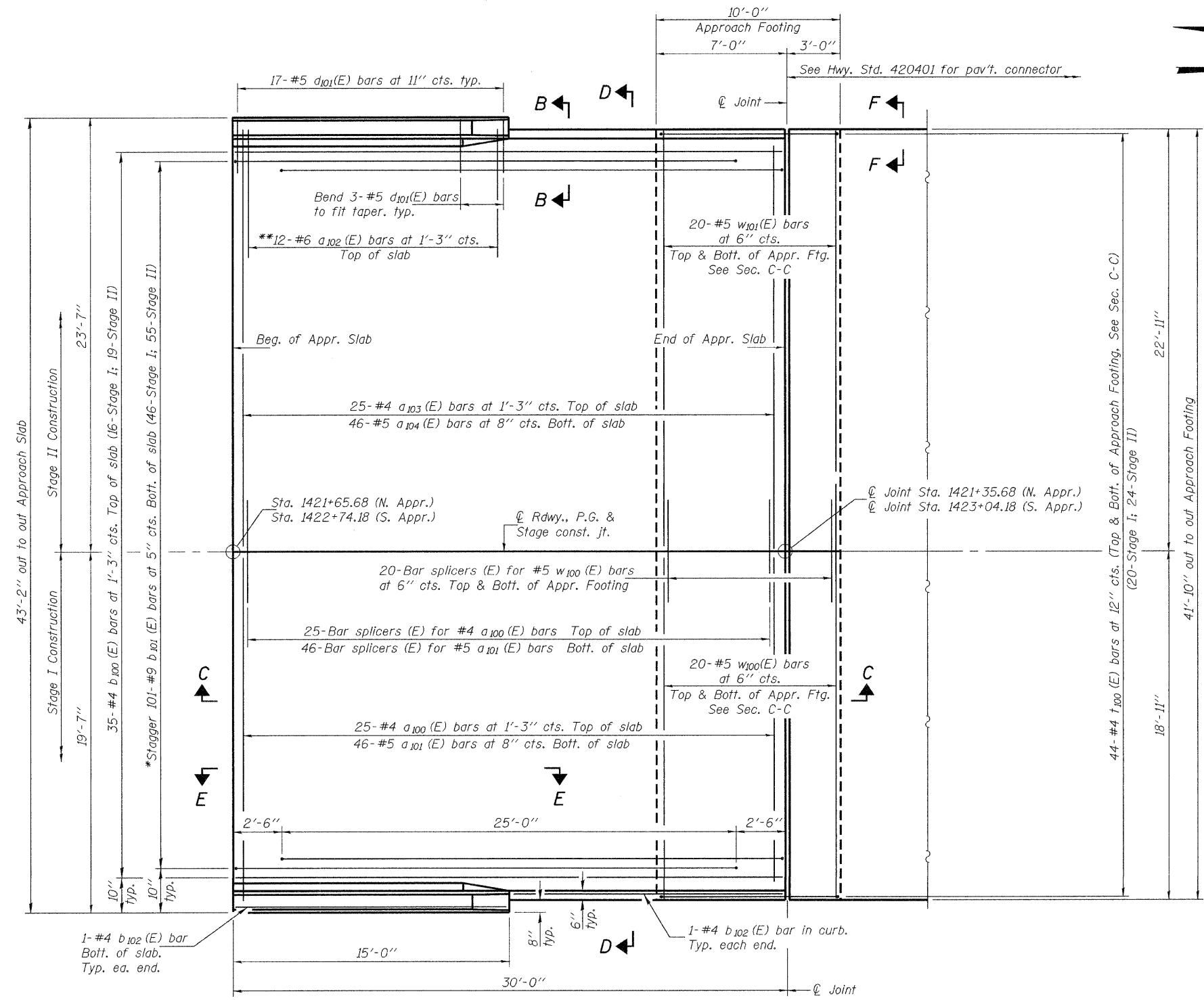

PLAN

(South Approach shown - North Approach similar by mirror image)

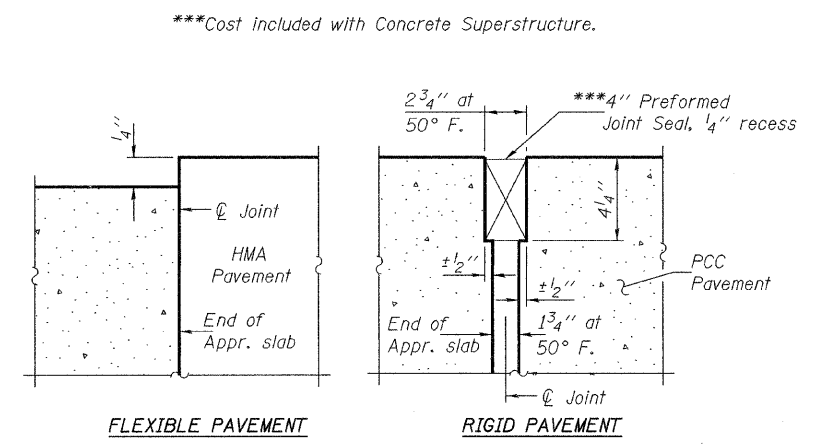
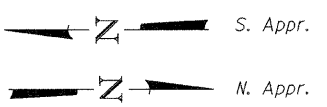

DETAIL A

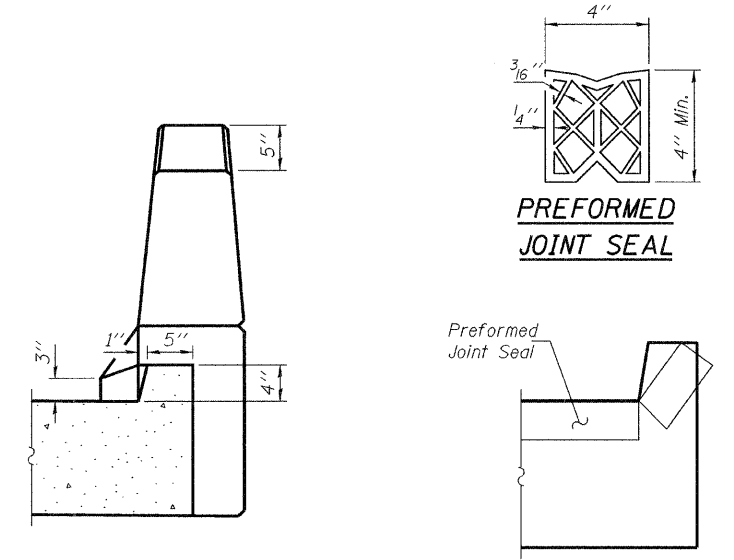

VIEW B-B

VIEW F-F

Angle Preformed Joint Seal at 45° at curbs when req'd for drainage.

DESIGNED	Nicholas R. Barnett
CHECKED	Michael D. Rolape
DRAWN	h.t. duong
CHECKED	NRB/MDR/GRA

September 29, 2009
 EXAMINED *Thomas J. Domagala*
 ENGINEER OF BRIDGE DESIGN
 PASSED *Ralph E. Anderson*
 ENGINEER OF BRIDGES AND STRUCTURES

*Tilt #9 b₁₀₁ (E) bars as required to maintain clearance.
 **Spaced between a₁₀₀ (E) and a₁₀₃ (E) bars, typ. ea. parapet.

BRIDGE APPROACH SLAB DETAILS (N.B.)
 STRUCTURE NO. 037-0015 (S.B.)
 STRUCTURE NO. 037-0016 (N.B.)

SHEET NO. 24 30 SHEETS	F.A.I. RTE.	SECTION	COUNTY	TOTAL SHEETS	SHEET NO.
	74	37-4HB	HENRY	148	60
FED. ROAD DIST. NO. _ ILLINOIS			FED. AID PROJECT		
CONTRACT NO. 64264					