



DATE	
BY	
NO.	
FILE NAME	
NO.	
NO.	
NO.	
NO.	

DATE	
BY	
NO.	
FILE NAME	
NO.	
NO.	
NO.	
NO.	

MATCH LINE STA 1348+00
SEE SHT. 8 FOR CONT.

MATCH LINE STA 1353+50
SEE SHT. 10 FOR CONT.

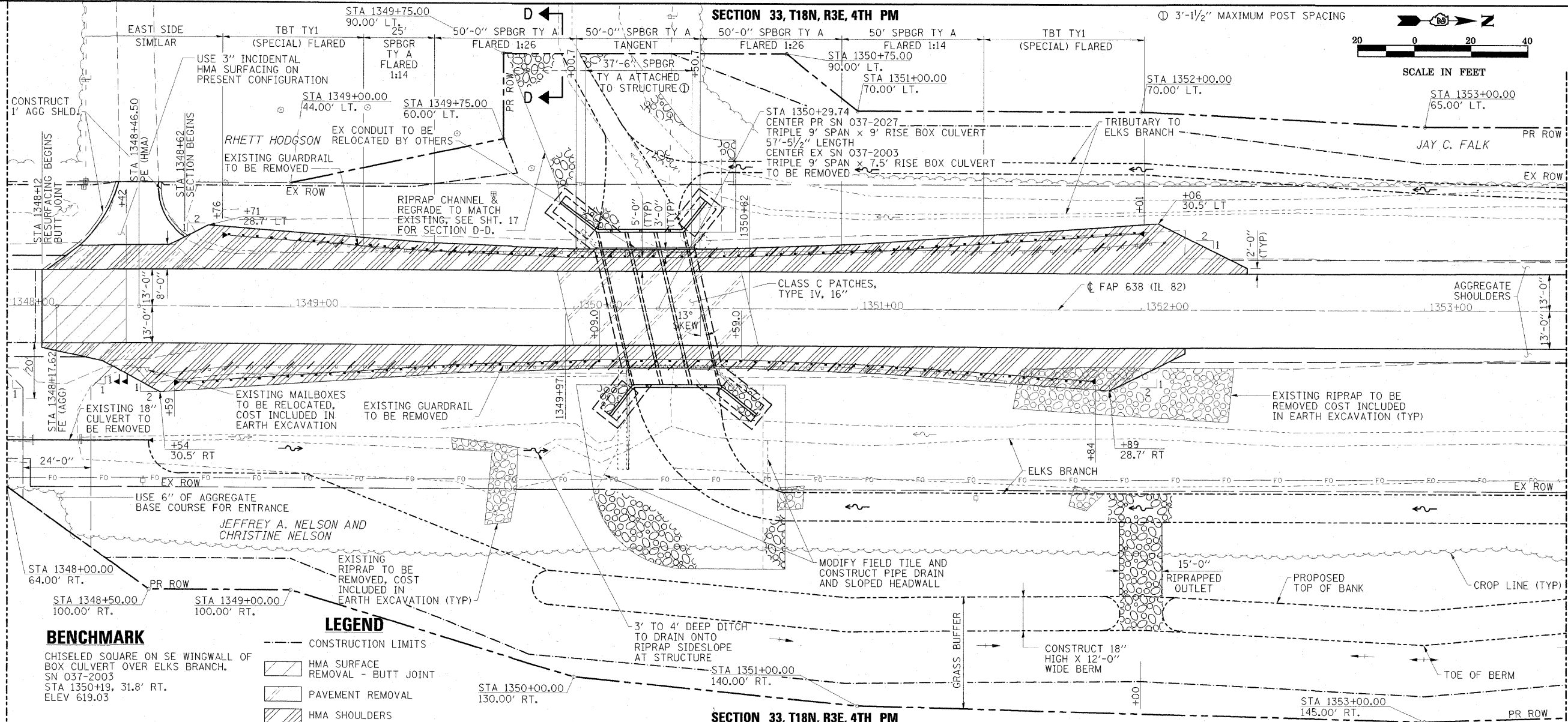

BENCHMARK
CHISELED SQUARE ON SE WINGWALL OF BOX CULVERT OVER ELKS BRANCH, SN 037-2003, STA 1350+19, 31.8' RT, ELEV 619.03

LEGEND
 - - - CONSTRUCTION LIMITS
 [Hatched] HMA SURFACE REMOVAL - BUTT JOINT
 [Dotted] PAVEMENT REMOVAL
 [Diagonal Lines] HMA SHOULDERS

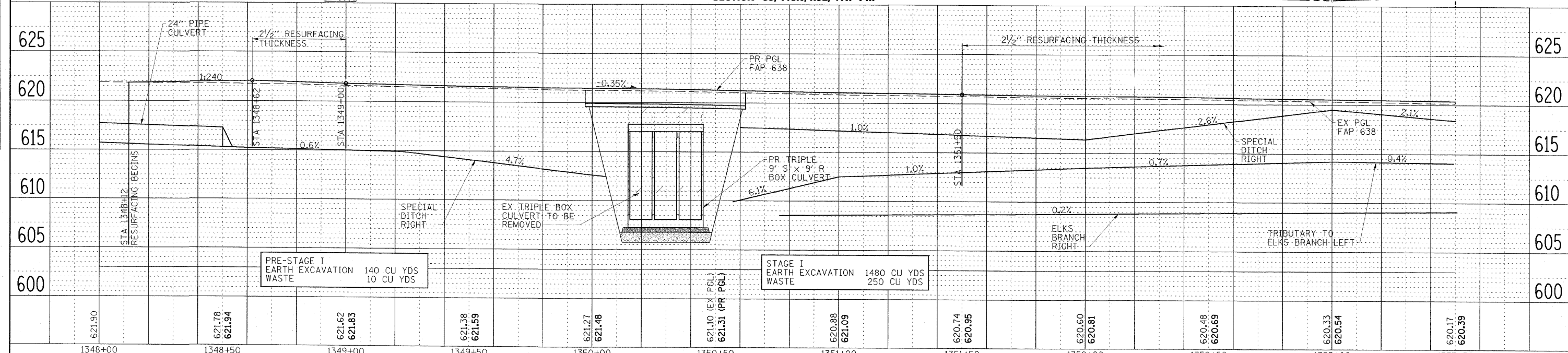

FILE NAME : 0264A04-sh1-d1nprf01.dgn	USER NAME : HAS	DESIGNED - JMS/ELH	REVISED -	STATE OF ILLINOIS DEPARTMENT OF TRANSPORTATION	FAP RTE 638 (IL 82) PLAN AND PROFILE STA 1348+00 TO STA 1353+50	F.A.P. RTE. 638	SECTION 129BR	COUNTY HENRY	TOTAL SHEETS 42	SHEET NO. 10		
SCALES: (HORIZ) 1"=20' (VERT) 1"=5'	PLOT SCALE = 20,0000' / IN.	DRAWN - HAS	REVISED -			SCALE: 1"=20'-0"	SHEET NO. 2 OF 4 SHEETS	STA. 1348+00	TO STA. 1353+50	CONTRACT NO. 64A04		
	PLOT DATE = 9/9/2009 9:39:51 AM	CHECKED - ELH	REVISED -			FED. ROAD DIST. NO. ILLINOIS FED. AID PROJECT						
		DATE - 09/08/09	REVISED -									