

HORIZONTAL CONTROL POINT NO. 104

Chain IL2 contains:  
10 11

Beginning chain IL2 description

Point 10 N 1,878,576.39 E 2,448,154.25 Sta 54+38.52

Course from 10 to 11 89° 39' 14.20" Dist 7,556.53

Point 11 N 1,878,622.03 E 2,455,710.65 Sta 129+95.05

Ending chain IL2 description

REFERENCE TIES						
POINT	CHAIN	STATION	OFFSET	DESCRIPTION		
501	IL2	93+86.01	198.77' RT	CONCRETE FOUNDATION		
502	IL2	69+72.47	61.53' LT	POWER POLE		
503	IL2	71+66.72	61.71' LT	POWER POLE		
504	IL2	69+23.39	23.86' LT	GUARDRAIL		
505	IL2	65+96.95	22.31' LT	GUARDRAIL		
506	IL2	65+86.77	61.19' LT	POWER POLE		
507	IL2	66+56.64	57.01' LT	SIGN		
508	IL2	114+58.01	22.28' LT	GUARDRAIL		
509	IL2	115+34.59	62.28' LT	POWER POLE		
510	IL2	114+71.61	24.75' RT	GUARDRAIL		

HORIZONTAL CONTROL POINTS							
POINT	NORTH	EAST	ELEVATION	CHAIN	STATION	OFFSET	DESCRIPTION
1	1878433.38	1452122.87	678.65	IL2	94+06.20	166.98' RT	GPS CONTROL POINT, 5/8" DIA. REBAR
2	1878631.03	2449762.23	665.88	IL2	70+46.80	44.93' LT	GPS CONTROL POINT, 5/8" DIA. REBAR
101	1878590.21	2454132.17	666.90	IL2	114+16.42	22.28' RT	TOPO SURVEY POINT, 5/8" DIA. REBAR
103	1878703.98	2454217.87	658.06	IL2	115+02.79	90.97' LT	TOPO SURVEY POINT, 5/8" DIA. REBAR
104	1878682.69	2449338.12	660.87	IL2	66+21.01	99.16' LT	TOPO SURVEY POINT, 5/8" DIA. REBAR

BENCHMARKS							
POINT	NORTH	EAST	ELEVATION	CHAIN	STATION	OFFSET	DESCRIPTION
401	1878606.60	2449349.90	667.26	IL2	66+34.33	22.99' LT	WINGWALL, CHISELED SQUARE
402	1878635.89	2454213.18	668.03	IL2	114+97.69	22.91' LT	WINGWALL, CHISELED SQUARE

SURVEY WORK POINTS							
POINT	NORTH	EAST	ELEVATION	CHAIN	STATION	OFFSET	DESCRIPTION
102	1878562.28	2454294.65	664.64	IL2	115+78.72	51.19' RT	5/8" DIA. REBAR
105	1878552.86	2449347.61	665.64	IL2	66+31.71	30.74' RT	5/8" DIA. REBAR
106	1878436.88	2450293.83	664.59	IL2	75+77.22	152.43' RT	IRON ROD
107	1878768.02	2453338.89	666.35	IL2	106+24.22	160.32' LT	NAIL
108	1878499.22	2454452.21	666.43	IL2	117+35.90	115.21' RT	NAIL

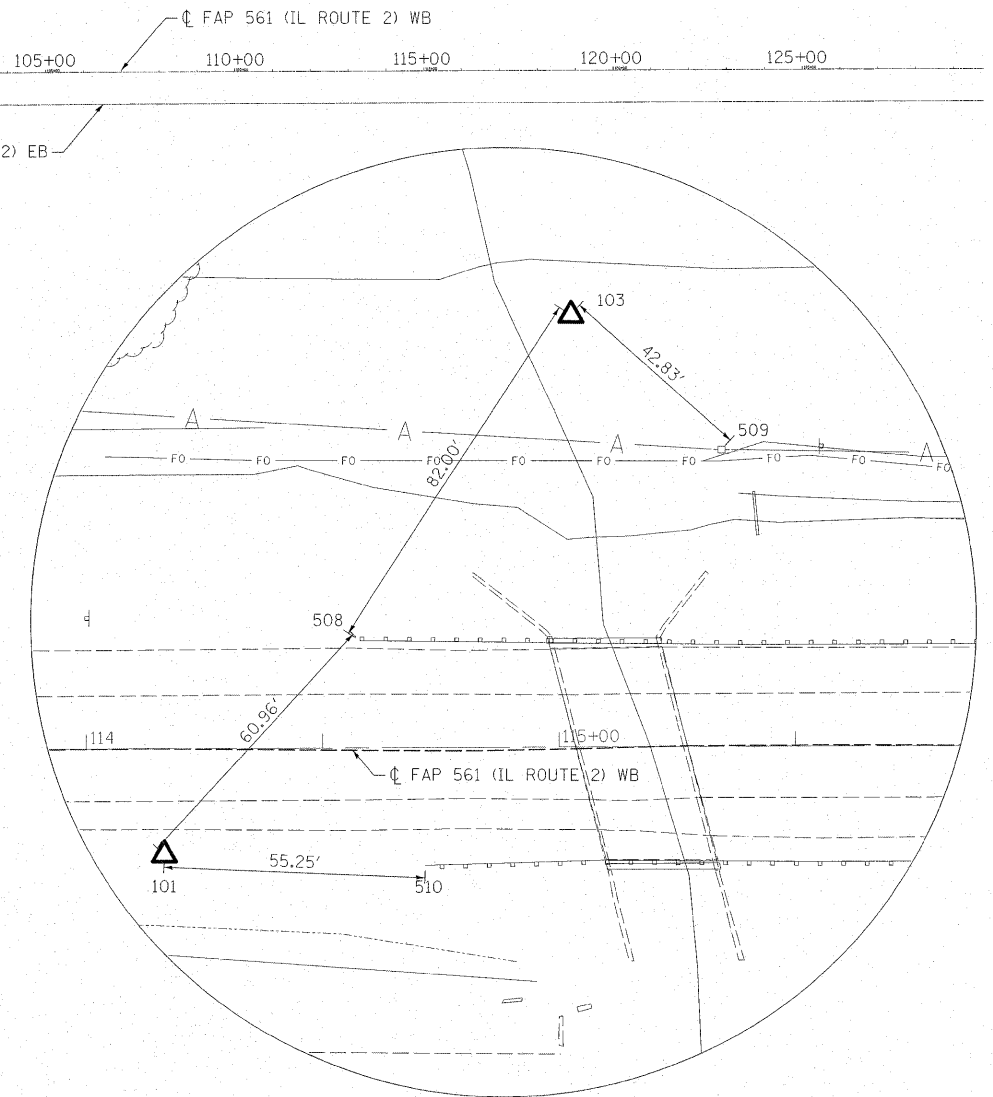

HORIZONTAL CONTROL POINTS NO. 101 AND 103

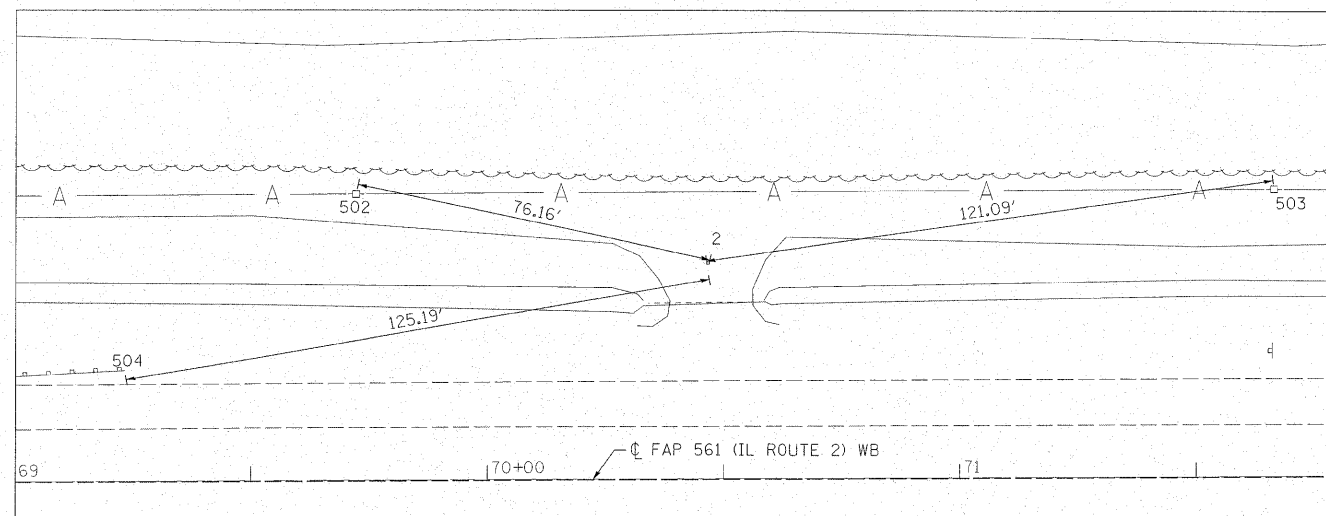

HORIZONTAL CONTROL POINT NO. 2

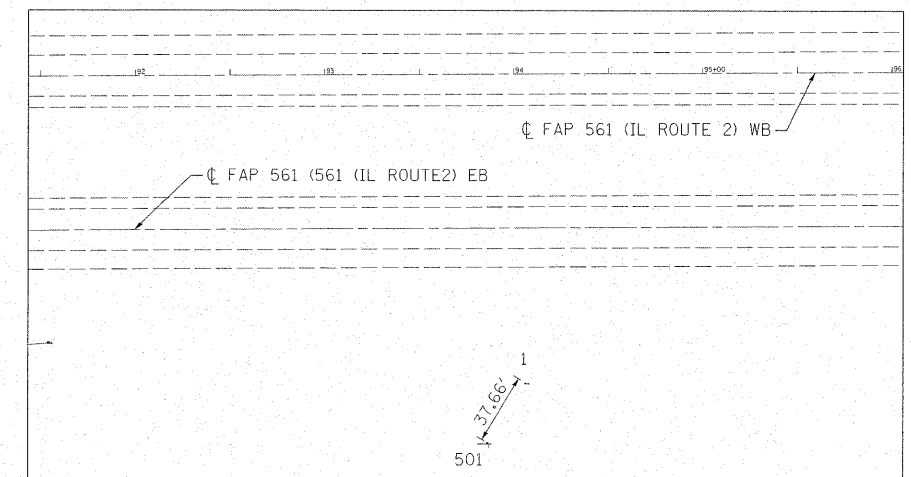

HORIZONTAL CONTROL POINTS NO. 1