

STATE OF ILLINOIS  
DEPARTMENT OF TRANSPORTATION

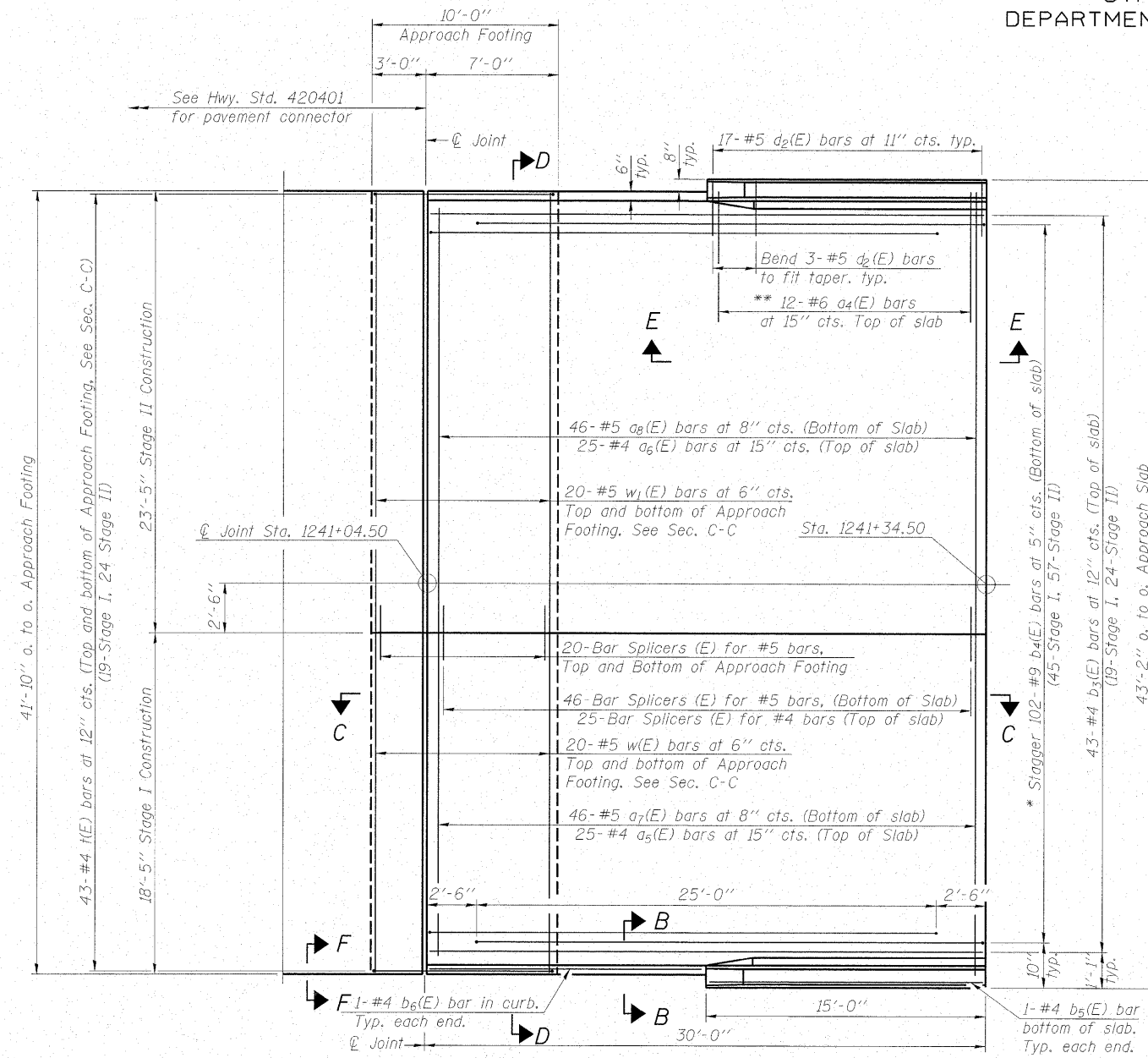

SOUTH APPROACH SLAB PLAN

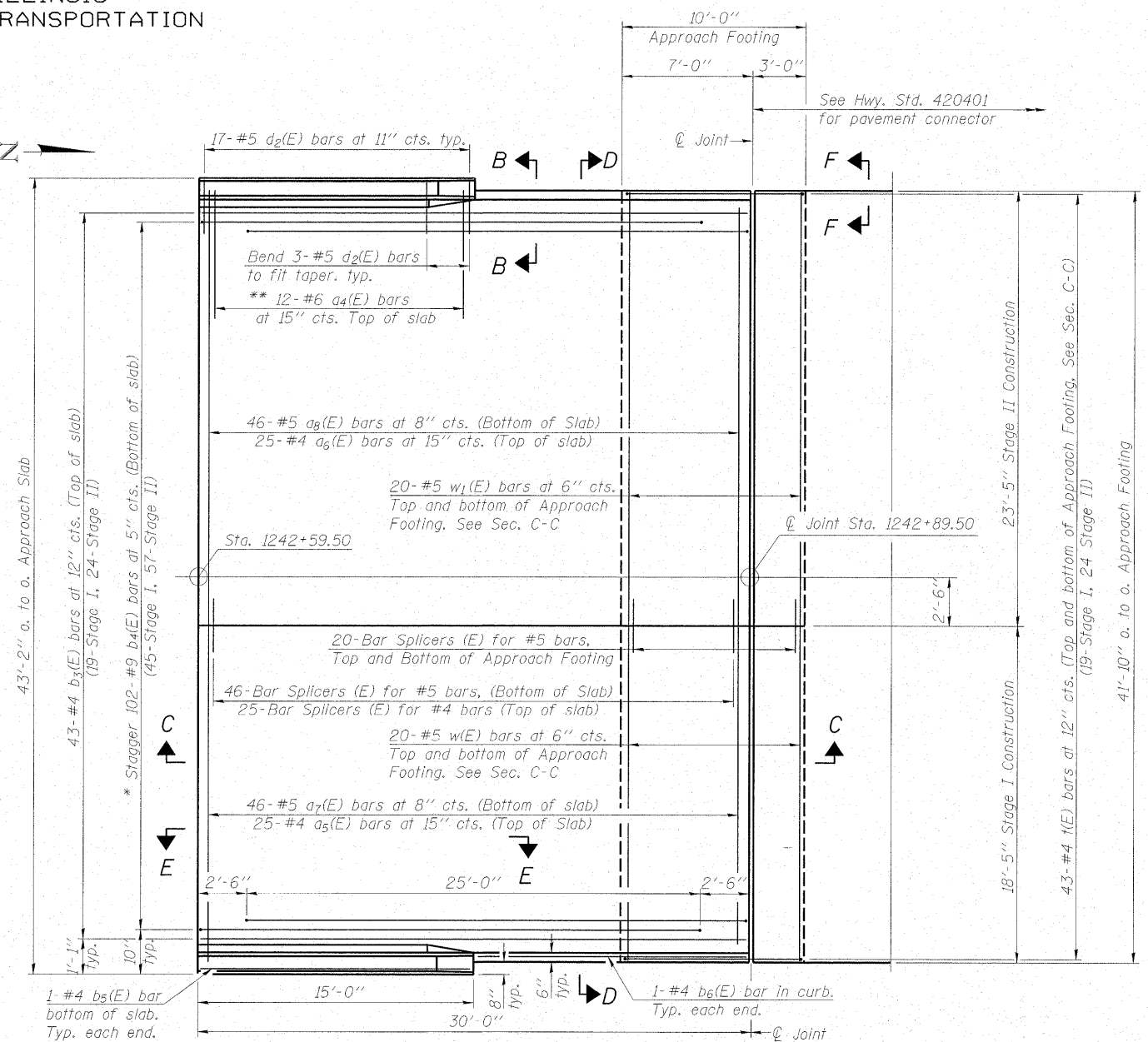

NORTH APPROACH SLAB PLAN

\* Tilt #9 b<sub>4</sub>(E) bars as required to maintain clearance.  
\*\* Alternate with a<sub>5</sub>(E) or a<sub>6</sub>(E) bars, typ. ea. parapet.

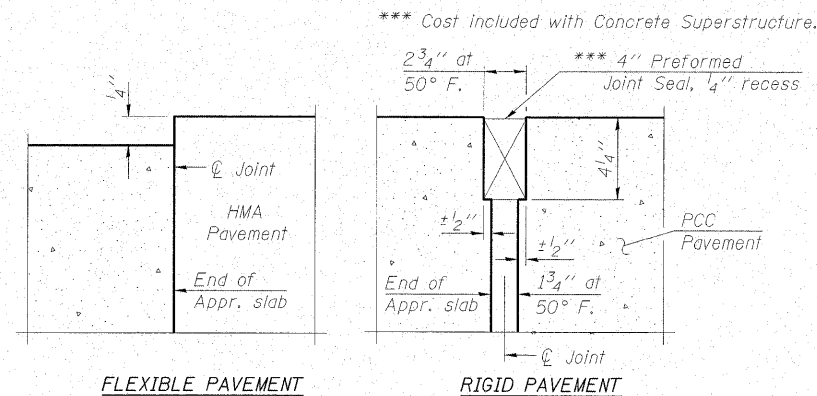

DETAIL A

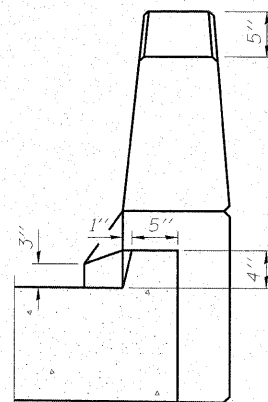

VIEW B-B

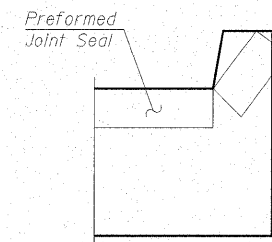

VIEW F-F

Angle Preformed Joint Seal at 45° at curbs when req'd for drainage.

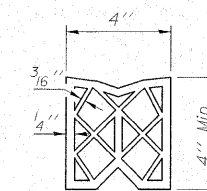

PREFORMED JOINT SEAL

Notes:  
See sheet 13 of 24 for Sections C-C & D-D, View E-E, and Bill of Materials.



DESIGNED - BAS
CHECKED - KEF
DRAWN - SGM
CHECKED - RJA/KEF

(Sheet 1 of 2)  
BRIDGE APPROACH SLAB DETAILS  
STRUCTURE NO. 037-0175

SHEET NO. 12 24 SHEETS	F.A.P. RTE. 638	SECTION 129 BR-3	COUNTY HENRY	TOTAL SHEETS 73	SHEET NO. 29
	CONTRACT NO. 64B08				
FED. ROAD DIST. NO. ILLINOIS FED. AID PROJECT					