

REMOVAL LEGEND

- PAVEMENT REMOVAL (HMA)
- HOT-MIX ASPHALT SURFACE REMOVAL-BUTT JOINT
- HOT-MIX ASPHALT SURFACE REMOVAL, 2 1/2"
- HMA SHOULDER REMOVAL (EARTH EX.)
- DRIVEWAY REMOVAL (EARTH EX.)
- BRIDGE WORK ZONE
- GUARDRAIL REMOVAL
- FENCE REMOVAL (INCIDENTAL TO CLEARING)
- TREE REMOVAL

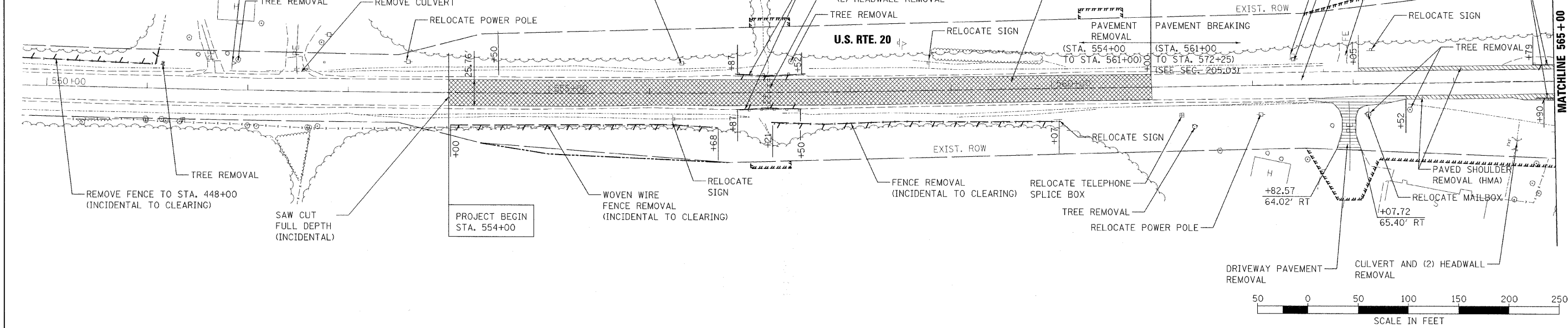

- NOTES:**
1. GUARDRAIL REMOVAL ON BRIDGE IS INCIDENTAL TO BRIDGE REMOVAL.
 2. RELOCATED POWER POLES AND UTILITIES SHALL BE PLACED OUTSIDE CLEAR ZONE WHICH IS 18' PAST THE EDGE OF TRAVEL LANE.
 3. ALL FENCE REMOVAL SHALL BE CONSIDERED INCIDENTAL TO CLEARING.
 4. RAISED PAVEMENT MARKING REMOVAL WILL BE INCIDENTAL TO EARTH EXCAVATION IN RECONSTRUCTION SECTION AND WILL BE PAID FOR SEPARATELY IN RESURFACING SECTION.
 5. HMA DRIVEWAY REMOVAL, HMA SHOULDER REMOVAL SHALL BE PAID FOR AS EARTH EXCAVATION.

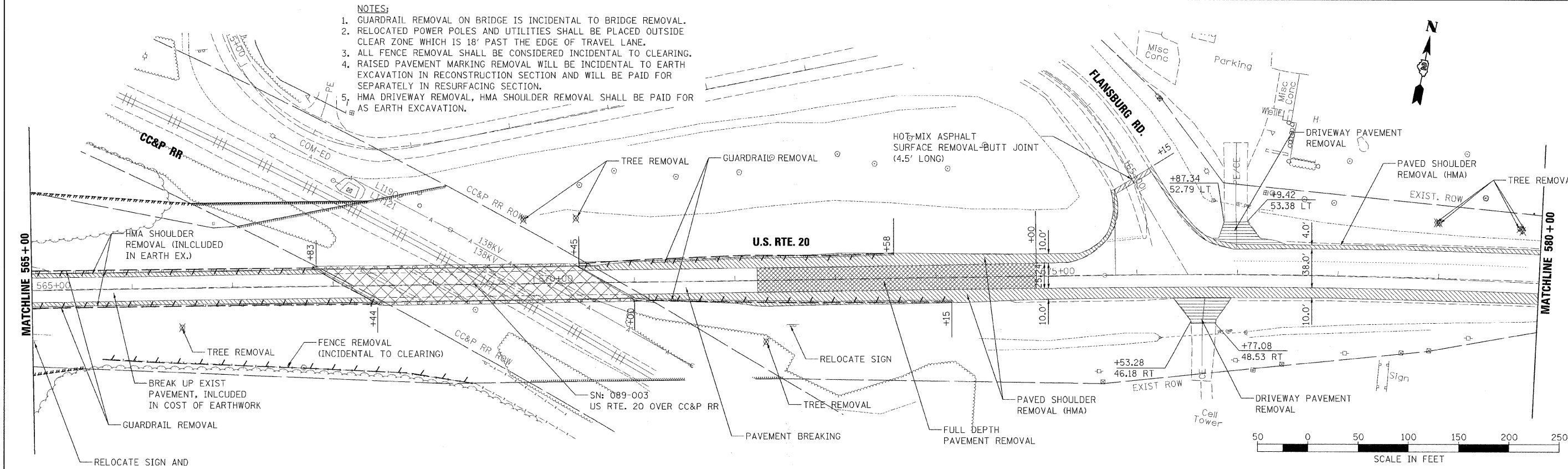

FILE NAME = H:\PROJECTS\2945\DNS\09205507\205507	USER NAME = #USER# EMI.dgn	DESIGNED -	REVISED -
PLOT SCALE = 50.0000' / IN.	PLOT DATE = 8/7/2009	DRAWN -	REVISED -
		CHECKED -	REVISED -
		DATE = 8/7/2009	REVISED -

**STATE OF ILLINOIS
DEPARTMENT OF TRANSPORTATION**

**US ROUTE 20
REMOVAL PLAN**

SCALE: 1"=50' SHEET NO. 1 OF 2 SHEETS STA. 553+00 TO STA. 580+00

HOH		<small>HARRY G. REFFER ASSOCIATES, INC. DESIGN AND CONSULTING ENGINEERS</small>		<small>55 East Jackson Blvd. Suite 500 Chicago, IL 60604 312-340-8131</small>	<small>PROJECT NUMBER 2945</small>
F.A.P. RTE. 301	SECTION 21 VBR	COUNTY STEPHENSON	TOTAL SHEETS 112	SHEET NO. 22	CONTRACT NO. 64D15
<small>FED. ROAD DIST. NO. ILLINOIS FED. AID PROJECT</small>					