



EROSION CONTROL LEGEND

-  INLET PROTECTION
-  TEMPORARY DITCH CHECK
-  SILT FENCE

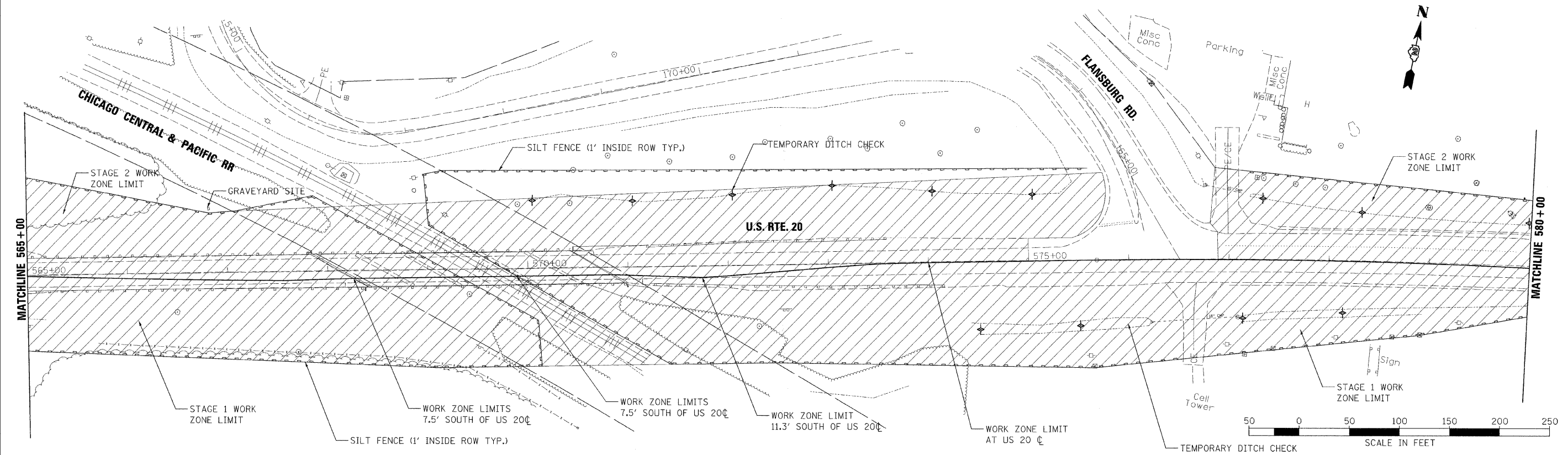
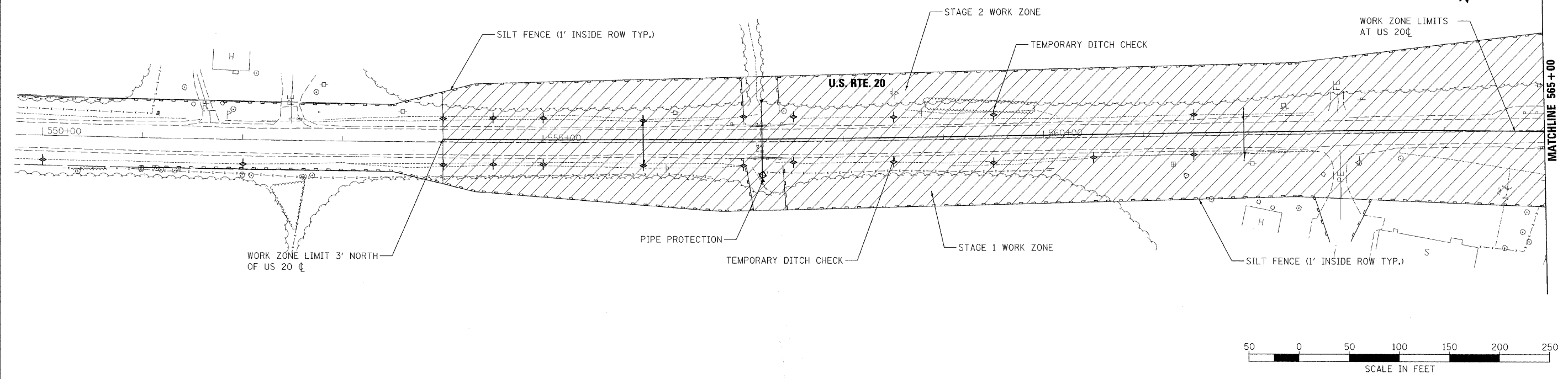

HOH		HARRY O. HEFFER ASSOCIATES, INC. DESIGN AND CONSULTING ENGINEERS		55 East Jackson Blvd. Suite 500 Chicago, IL 60604 312-588-8131	PROJECT NUMBER 2945
F.A.P. RTE. 301	SECTION 21 VBR	COUNTY STEPHENSON	TOTAL SHEETS 112	SHEET NO. 45	
FED. ROAD DIST. NO. [ILLINOIS] FED. AID PROJECT			CONTRACT NO. 64D15		

FILE NAME = H:\PROJECTS\2945\DGNS\0920507\205071.RL.dgn	USER NAME = #USER#	DESIGNED - AAF	REVISED -
PLOT SCALE = 50,0000' / IN.	CHECKED - BAP	DRAWN - AAF	REVISED -
PLOT DATE = 8/7/2009	DATE - 8/7/2009		REVISED -

**STATE OF ILLINOIS
DEPARTMENT OF TRANSPORTATION**

**US ROUTE 20
EROSION AND SEDIMENT CONTROL PLAN**

SCALE: 1"=50' SHEET NO. 1 OF 2 SHEETS STA. 553+00 TO STA. 580+00