

**LANDSCAPING LEGEND**

- SEEDING, (SEE NOTE 1)
- TOPSOIL FURNISH & PLACE, 4"
- EROSION CONTROL BLANKET
- NITROGEN FERTILIZER NUTRIENT
- PHOSPHORUS FERTILIZER NUTRIENT
- POTASSIUM FERTILIZER NUTRIENT

**NOTES:**

1. SEE GENERAL NOTES FOR SPECIFIC LOCATIONS OF SEEDING TYPES.

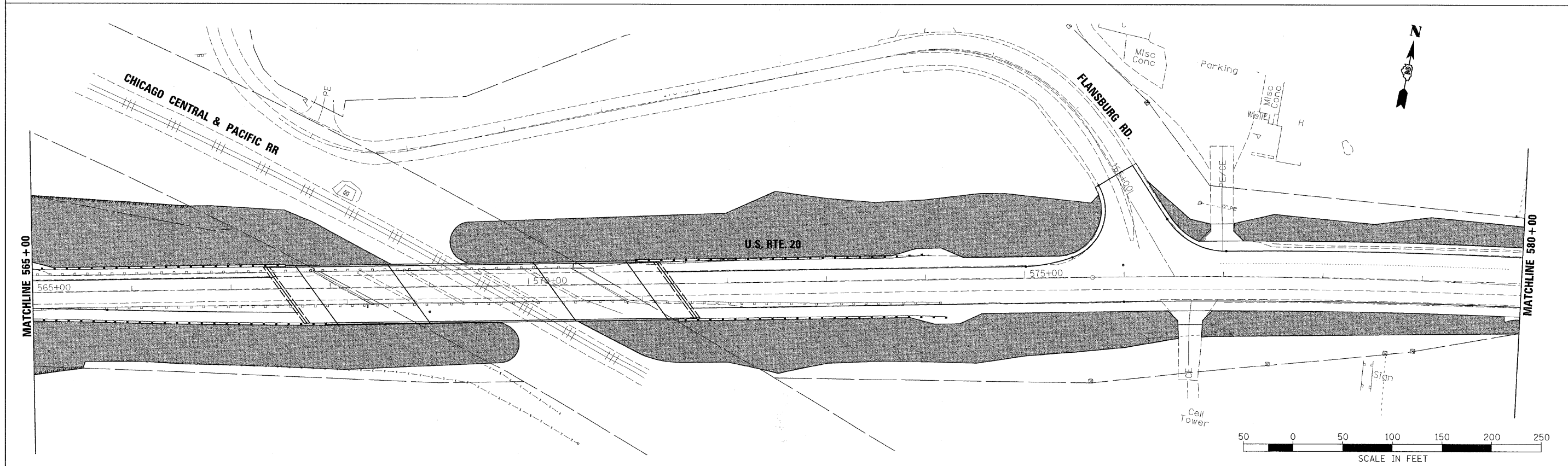

FILE NAME = H:\PROJECTS\2945\DGNS\09205507\205507.dgn	USER NAME = #USER#	DESIGNED - AAF	REVISED -	<b>STATE OF ILLINOIS DEPARTMENT OF TRANSPORTATION</b>	<b>US ROUTE 20 LANDSCAPING PLAN</b>	SCALE: 1"=50'	SHEET NO. 1 OF 2 SHEETS	STA. 553+00 TO STA. 580+00	<b>HOH</b>	<small>HARRY &amp; REYER-ASSOCIATES, INC. DESIGN AND CONSULTING ENGINEERS 55 East Jackson Blvd. Suite 808 Chicago, IL 60604 312-588-8131</small>	<small>PROJECT NUMBER <b>2945</b></small>		
		DRAWN - AAF	REVISED -						F.A.P. RTE. 301	SECTION 21 VBR	COUNTY STEPHENSON	TOTAL SHEETS <b>112</b>	SHEET NO. <b>47</b>
		CHECKED - BAP	REVISED -						CONTRACT NO. 64D15		FED. ROAD DIST. NO. [ILLINOIS] FED. AID PROJECT		
		DATE - 8/7/2009	REVISED -										