

8/19/11 AM
 8/16/2009
 H:\ProJects\2945\DWGS\Structural\CCPRR\US20 OVER ICR PREFINAL DWGS\010096-6450-004-STRUCTURAL\LAYOUT PLAN.dgn

STATE OF ILLINOIS
DEPARTMENT OF TRANSPORTATION

ROUTE NO.	SECTION	COUNTY	TOTAL SHEETS	SHEET NO.	SHEET NO. 4 32 SHEETS
F.A.P. 301	21-VBR 21RS-2	STEPHENSON	112	52	
FED. ROAD DIST. NO. 7	ILLINOIS	FED. AID PROJECT			

Contract #64D15

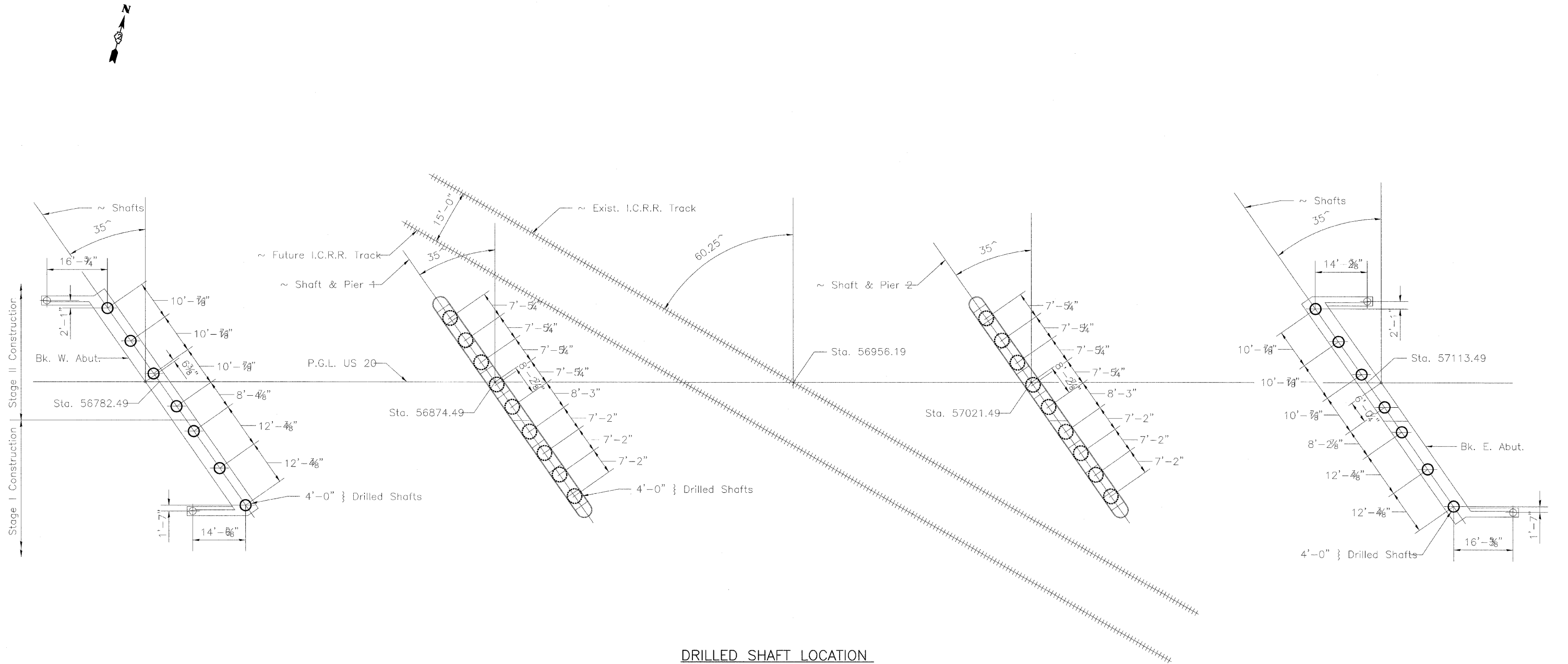

DRILLED SHAFT LOCATION

DESIGNED	MMH
CHECKED	CEN
DRAWN	R.VEJAR
CHECKED	CEN

SUBSTRUCTURE LAYOUT PLAN
US 20 OVER ILLINOIS CENTRAL RAILROAD
F.A.P. RTE. 301 - SEC. 21-VBR & 21RS-2
STEPHENSON COUNTY
STATION 569+56.19
STRUCTURE NO. 089-0077

HOH HARRY O. HETTER-ASSOCIATES, INC.
 DESIGN AND CONSULTING ENGINEERS
 65 East Jackson Blvd.
 Suite 600
 Chicago, IL 60604
 312-546-8131

PROJECT NUMBER
2945