

FINAL SURVEY	DATE
COPYRIGHTED	BY
PLOTTED	
TEMPLATE	
NOTE BOOK	
AREAS CHECKED	
NO.	

ORIGINAL SURVEY	DATE
COPYRIGHTED	BY
PLOTTED	
TEMPLATE	
NOTE BOOK	
AREAS CHECKED	
NO.	

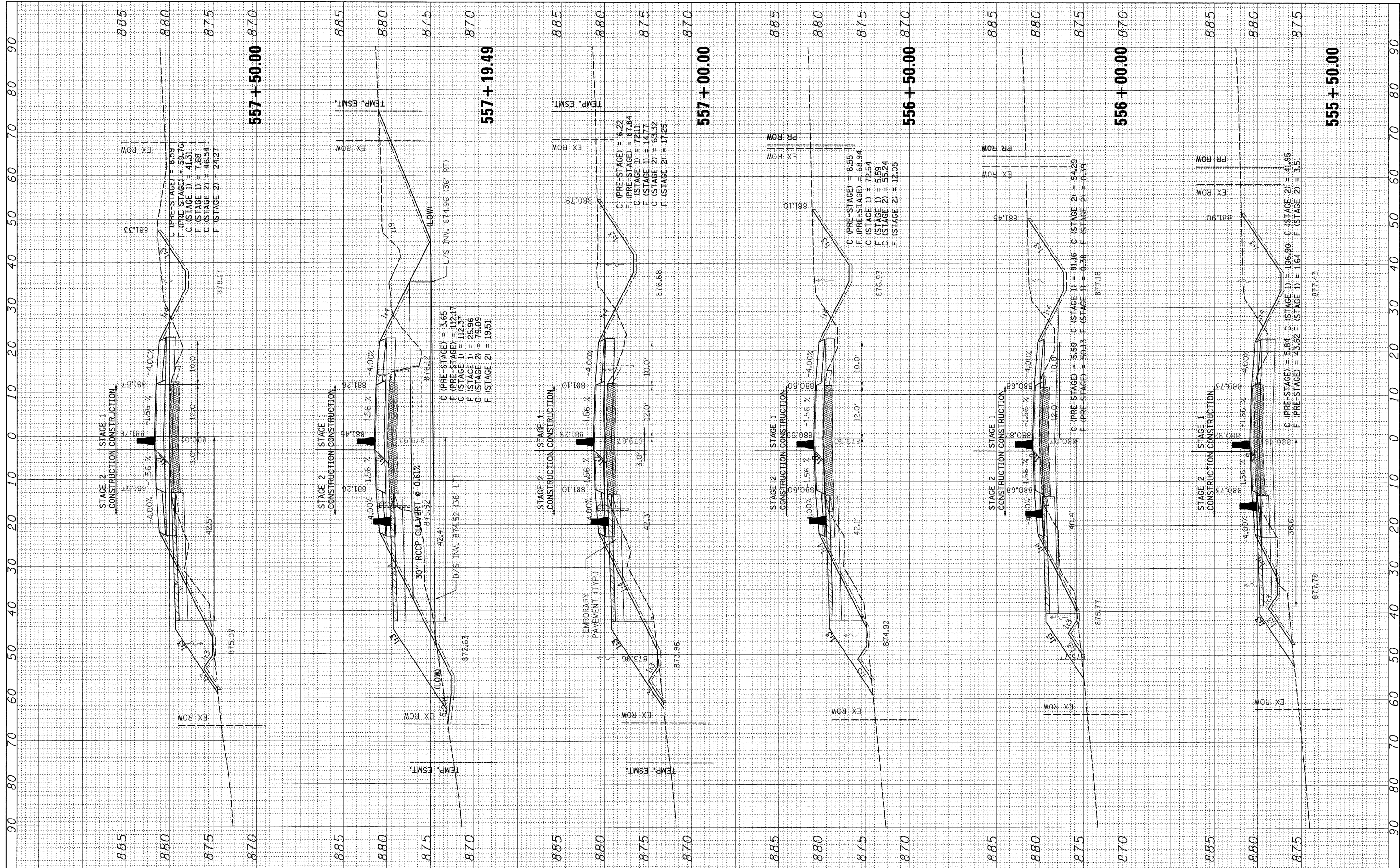

FILE NAME =	USER NAME = #USER#	DESIGNED -	REVISED -	<b>STATE OF ILLINOIS DEPARTMENT OF TRANSPORTATION</b>	<b>US ROUTE 20 CROSS SECTIONS</b>			F.A. RTE.	SECTION	COUNTY	TOTAL SHEETS	SHEET NO.
H:\Projects\2145\DGNS\09205507\Z05507\SSHEETS.dgn		DRAWN -	REVISED -		301	21 VBR	STEPHENSON	112	97			
PLOT SCALE = 1/8" = 1' IN.		CHECKED -	REVISED -		CONTRACT NO. 64D15							
PLOT DATE = 8/6/2009		DATE -	REVISED -		SCALE:	SHEET NO.	OF SHEETS	STA. 555+50.00 TO STA. 557+50.00	FED. ROAD DIST. NO.	ILLINOIS FED. AID PROJECT		