

FINAL SURVEY	CONVERTED	BY	DATE
NOTE BOOK	PLOTTED		
NO.	AREAS CHECKED		

ORIGINAL SURVEY	CONVERTED	BY	DATE
NOTE BOOK	PLOTTED		
NO.	AREAS CHECKED		

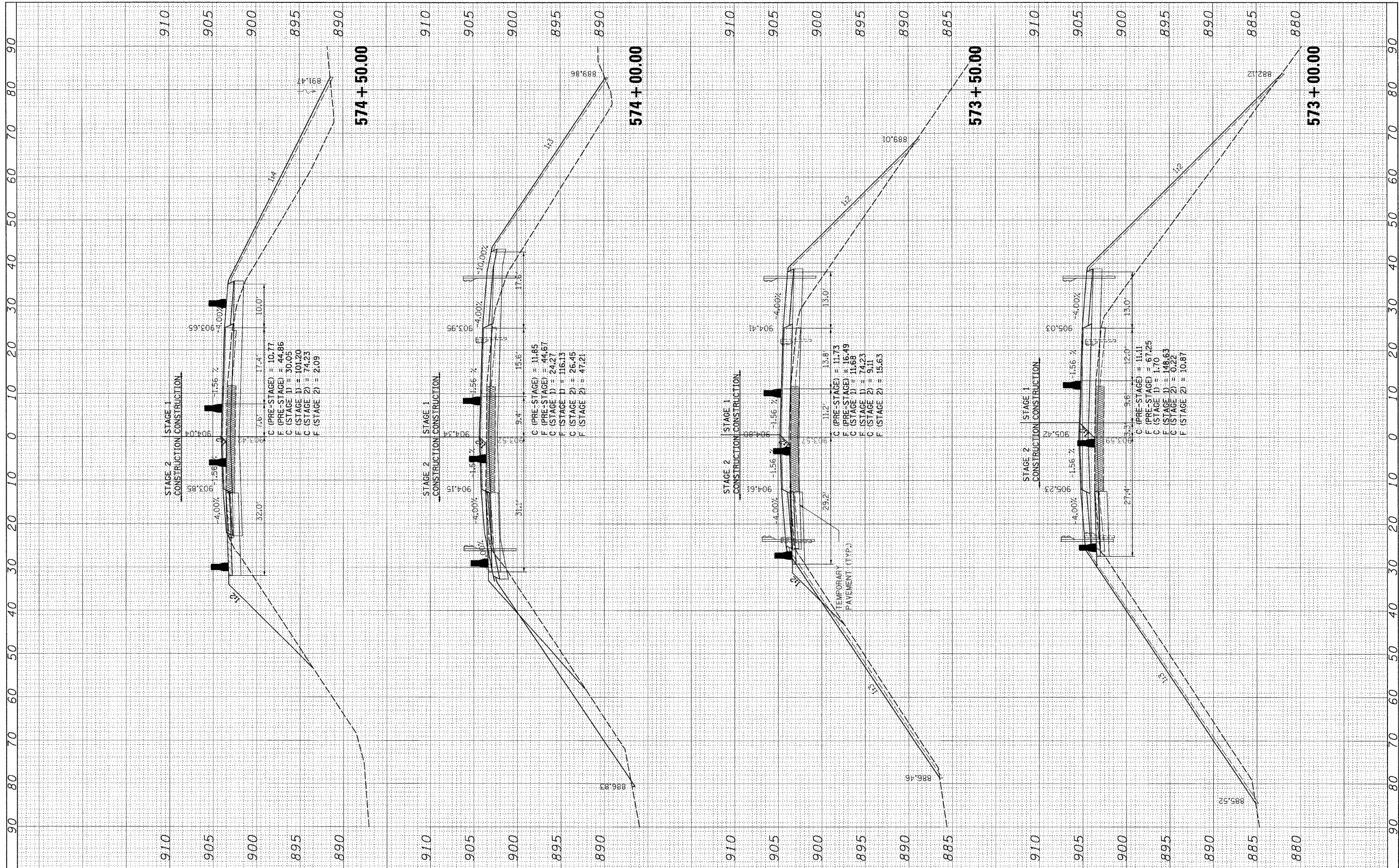

FILE NAME = H:\Projects\2945\DCNS\09225507\205507\SSHEETS.dgn	USER NAME = #USFR#	DESIGNED -	REVISED -	STATE OF ILLINOIS DEPARTMENT OF TRANSPORTATION	US ROUTE 20 CROSS SECTIONS			F.A. RTE. 301	SECTION 21 VBR	COUNTY STEPHENSON	TOTAL SHEETS 112	SHEET NO. 104
PLOT SCALE = 10.0000' / 1"	PLOT DATE = 8/6/2009	DRAWN -	REVISED -		SCALE:	SHEET NO.	OF SHEETS	STA. 573+00.00 TO STA. 574+50.00	FED. ROAD DIST. NO.	ILLINOIS	FED. AID PROJECT	CONTRACT NO. 64015
		CHECKED -	REVISED -									
		DATE -	REVISED -									