

Mary Ann Erickson

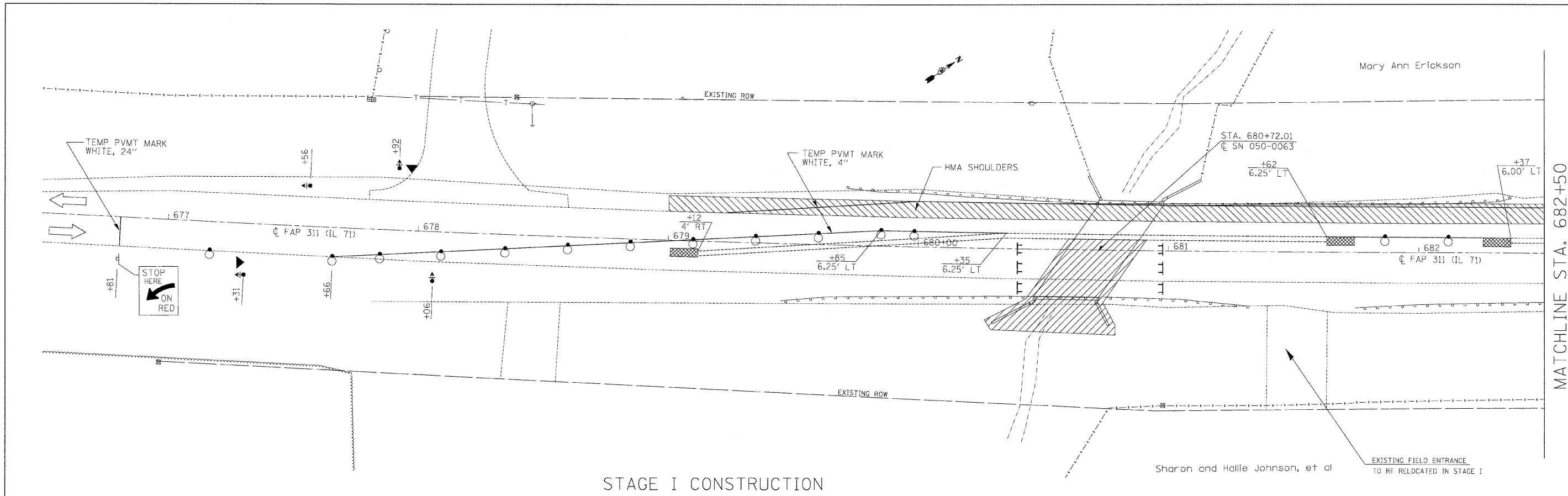

STAGE I CONSTRUCTION

MATCHLINE STA. 682+50

Sharon and Hallie Johnson, et al
EXISTING FIELD ENTRANCE TO BE RELOCATED IN STAGE I

SEQUENCE OF CONSTRUCTION

STAGE I PRECONSTRUCTION
CONSTRUCT HMA SHOULDERS ADJACENT TO SOUTHBOUND LANE TO BE USED FOR STAGE I TRAFFIC AND INCIDENTAL BITUMINOUS SURFACING FOR P.E. AT STA. 684+86 USING TRAFFIC CONTROL AND PROTECTION STANDARD 701326.

STAGE I CONSTRUCTION
CONSTRUCT PROPOSED HMA PAVEMENT, SHOULDERS PROPOSED GUARDRAIL, AND STAGE I PORTION OF THE PROPOSED CULVERT (SEE STRUCTURE PLANS) IN THE NORTHBOUND LANES USING TRAFFIC CONTROL AND PROTECTION STANDARD 701321.

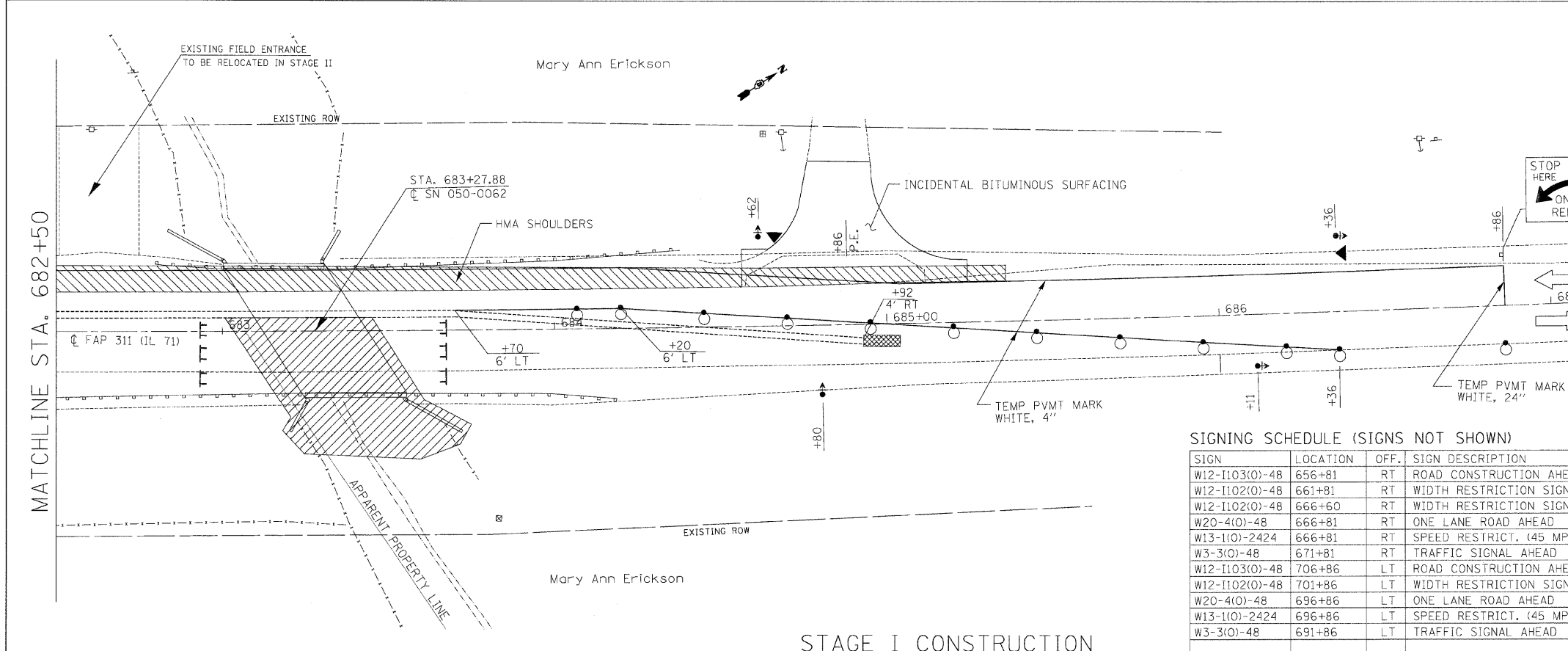

STAGE I CONSTRUCTION

MATCHLINE STA. 682+50

SIGNING SCHEDULE (SIGNS NOT SHOWN)

SIGN	LOCATION	OFF.	SIGN DESCRIPTION
W12-I103(0)-48	656+81	RT	ROAD CONSTRUCTION AHEAD
W12-I102(0)-48	661+81	RT	WIDTH RESTRICTION SIGN (SEE DETAILS SHEET)
W12-I102(0)-48	666+60	RT	WIDTH RESTRICTION SIGN (SEE DETAILS SHEET)
W20-4(0)-48	666+81	RT	ONE LANE ROAD AHEAD
W13-1(0)-2424	666+81	RT	SPEED RESTRICT. (45 MPH) ATTACHED TO W13-1(0)-2424
W3-3(0)-48	671+81	RT	TRAFFIC SIGNAL AHEAD
W12-I103(0)-48	706+86	LT	ROAD CONSTRUCTION AHEAD
W12-I102(0)-48	701+86	LT	WIDTH RESTRICTION SIGN (SEE DETAILS SHEET)
W20-4(0)-48	696+86	LT	ONE LANE ROAD AHEAD
W13-1(0)-2424	696+86	LT	SPEED RESTRICT. (45 MPH) ATTACHED TO W13-1(0)-2424
W3-3(0)-48	691+86	LT	TRAFFIC SIGNAL AHEAD

LEGEND

- WORK AREA
- SIGN
- TYPE III BARRICADE
- TRAFFIC SIGNAL WITH BACKPLATE
- MICROWAVE DETECTOR
- IMPACT ATTENUATOR
- DRUM WITH STEADY BURNING LIGHT
- TEMPORARY CONCRETE BARRIER

FILE NAME = ...ND366741-SHT-Stage Const Sheets.dgn	USER NAME = SAW	DESIGNED - RAC	REVISED -
		DRAWN - SAW	REVISED -
	PLOT SCALE = 20,0000' / IN.	CHECKED - RAC	REVISED -
	PLOT DATE = 7/14/2009	DATE - 07/17/09	REVISED -

**STATE OF ILLINOIS
DEPARTMENT OF TRANSPORTATION**

**ILLINOIS ROUTE 71
STAGE CONSTRUCTION TRAFFIC CONTROL**

F.A.P. RTE.	SECTION	COUNTY	TOTAL SHEETS	SHEET NO.
311	(3)BR- 1, 2, & (4)BR	LASALLE	66	17
FED. ROAD DIST. NO. ILLINOIS FED. AID PROJECT			CONTRACT NO. 66741	

SCALE: SHEET NO. OF SHEETS STA. 638+50 TO STA. 756+50