

STATE OF ILLINOIS
DEPARTMENT OF TRANSPORTATION

ROUTE NO.	SECTION	COUNTY	SHEETS	SHEET NO.
F.A.P. 311	*	LaSalle	66	29
FED. ROAD DIST. NO. 7	ILLINOIS	FED. AID PROJECT		

SHEET NO. 2

7 SHEETS

*(3)BR-1,2,3 & (4)BR Contract #66741

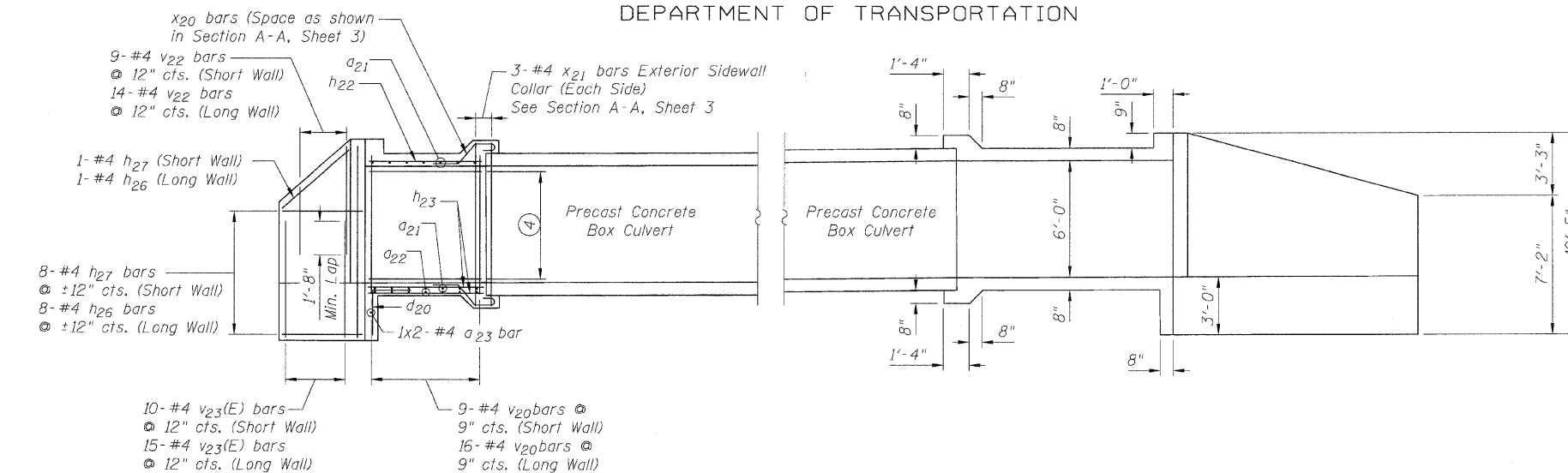

ELEVATION

NOTES

- ① 11- #7 a₂₁ bars @ 7" cts. (Bottom of Top Slab & Top of Bottom Slab)
4- #4 a₂₂ bars @ 2'-0" cts. (Bottom of Bottom Slab)
- ② **9- #7 a₂₁ bars @ 7" cts. (Bottom of Top Slab & Top of Bottom Slab)
**3- #4 a₂₂ bars @ 2'-0" cts. (Bottom of Bottom Slab)
- ③ *7- #6 h₂₂ bars @ 16" cts. (Bottom of Top Slab)
*9- #4 h₂₃ bars @ 12" cts. (Top of Bottom Slab & Bottom of Bottom Slab)
- ④ 6- #5 h₂₄ bars @ 12" cts. (Short Wall)
6- #5 h₂₅ bars @ 12" cts. (Long Wall)

* Cut bar, see Cut Diagrams on Sheet 3

** a bars in skew portion of slab shall be ordered full length & cut to fit. Balance of bar to be used in opposite end of culvert.

Bars indicated thus 1x2- #4 etc. indicates 1 line of bars with 2 lengths per line.

For Section A-A, see Sheet 3.

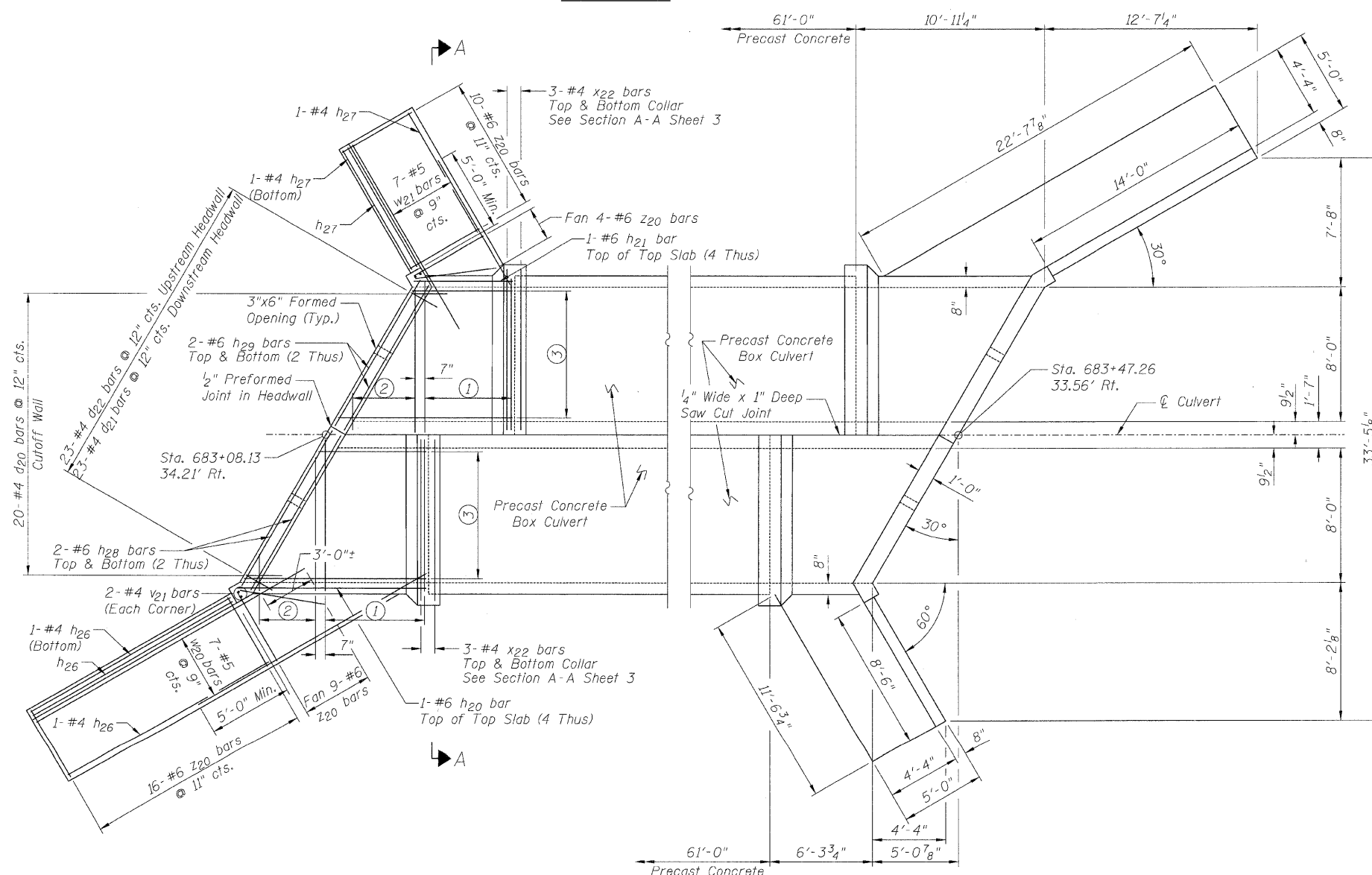

PLAN

DESIGNED	LAS
CHECKED	JLA
DRAWN	SAW
CHECKED	LAS

BOX CULVERT END SECTIONS
IL 71 OVER MISSION CREEK
FAP ROUTE 311
SECTION (3)BR-1,2,3 & (4)BR
LASALLE COUNTY
STA. 683+27.88
S.N. 050-2048