

STAGE I

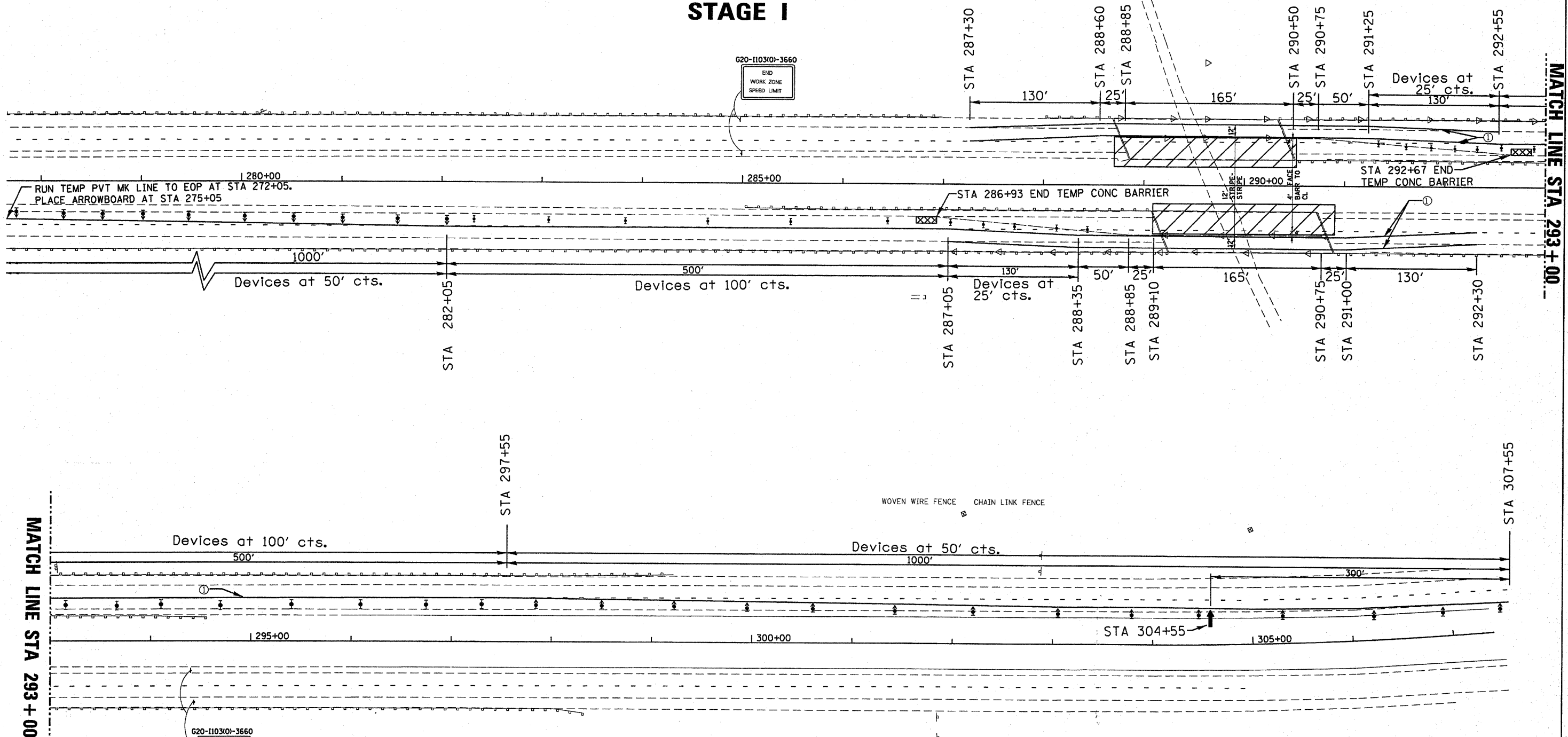

MATCH LINE STA 293+00

MATCH LINE STA 293+00

SYMBOLS

- ↑ Arrow board
- ⊥ Sign
- ▲ Direction indicator barricade with steady burn monodirectional light
- ◁ Monodirectional Barrier Wall/Guardrail Marker
- ⬇ Type II barricade, drum, or vertical barricade with steady burn monodirectional light
- ① Wet temporary pavement marking tape - TY III shall be placed throughout the taper and along-side the work area. The edge lines shall be white and the line near the barrier shall be yellow.
- Temporary Concrete Barrier
- ▨ Work area
- ▩ Impact Attenuator

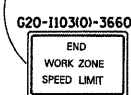

SEE STANDARD 701402 FOR DETAILS NOT SHOWN

STAGE CONSTRUCTION NOTES:

- PRESTAGE I CONSTRUCTION**
1. INSTALL STORM SEWER
 2. PLACE EMBANKMENT TO WITHIN 10' OF THE BOTTOM FACE OF THE I-BEAM OF THE BRIDGE
 3. USING TC&P STD 701401, PLACE HMA BASE COURSE, 9" (FOR STAGE CONSTRUCTION)
- STAGE I CONSTRUCTION:**
1. REMOVE MEDIAN PORTION OF THE EXISTING BRIDGES
 2. PLACE THE REMAINING EMBANKMENT IN MEDIAN ARE AND BUILD PAVEMENT AS SHOWN IN PLANS

| | | | | | | | | | | | |
|---|-----------------------------|------------|-----------|---|-----------------------------|---------------------------|-----------------------|--------|--------------|-----------|--|
| FILE NAME = | USER NAME = braboyppa | DESIGNED - | REVISED - | STATE OF ILLINOIS DEPARTMENT OF TRANSPORTATION | STAGE I CONSTRUCTION | F.A. RTE. = | SECTION | COUNTY | TOTAL SHEETS | SHEET NO. | |
| cat\pwwork\pwwid01\BRABOYPPA\dms64344\036862-SHT-PLNPRF.dgn | PLOT SCALE = 50.2690' / IN. | DRAWN - | REVISED - | | | 57 | [(27-1)VBR & VBR-13DM | FORD | 28 | 9 | |
| PLOT DATE = Aug 26, 2009 - 03:05:52 PM | DATE - | CHECKED - | REVISED - | | | CONTRACT NO. 66862 | | | | | |
| | | | | | | ILLINOIS FED. AID PROJECT | | | | | |