

NOTES:

1. MAINLINE RESURFACING, 1 3/4"
 - INCLUDES:
 - 1 3/4" POLYMERIZED HOT-MIX ASPHALT SURFACE COURSE, MIX "D", N105
2. POLYMERIZED LEVELING BINDER (MACHINE METHOD), N90 (3/4" MIN. VARIABLE DEPTH) (AS NECESSARY)
3. SHOULDER RESURFACING, 1 3/4"
 - INCLUDES:
 - 1 3/4" HOT-MIX ASPHALT SURFACE COURSE, MIX "C", N50
- 3A. SHOULDER RESURFACING, 1 3/4"
 - INCLUDES:
 - 1 3/4" POLYMERIZED HOT-MIX ASPHALT SURFACE COURSE, MIX "D", N105
4. FULL-DEPTH HOT-MIX ASPHALT SHOULDERS, 12"
 - INCLUDES:
 - 1 3/4" HOT-MIX ASPHALT SURFACE COURSE, MIX "C", N50
 - 10 1/4" HOT-MIX ASPHALT BINDER COURSE, IL-19.0, N50
 - 6" AGGREGATE BASE COURSE, TYPE A
- 4A. FULL-DEPTH HOT-MIX ASPHALT SHOULDERS, 12"
 - INCLUDES:
 - 1 3/4" POLYMERIZED HOT-MIX ASPHALT SURFACE COURSE, MIX "D", N105
 - 10 1/4" HOT-MIX ASPHALT BINDER COURSE, IL-19.0, N90
 - 6" AGGREGATE BASE COURSE, TYPE A
5. FULL-DEPTH HMA PAVEMENT, 21"
 - INCLUDES:
 - 1 3/4" POLYMERIZED HOT-MIX ASPHALT SURFACE COURSE, MIX "D", N105
 - 2 3/4" POLYMERIZED HOT-MIX ASPHALT BINDER COURSE, N105
 - 12 3/4" HOT-MIX ASPHALT BINDER COURSE, IL 19.0, N90
 - 4" HOT-MIX ASPHALT BINDER COURSE, N70
 - 12" AGGREGATE SUBGRADE

6. NO NOTE
7. SEE ROADWAY DETAILS SHEET FOR TABLE OF STATIONS/OFFSETS

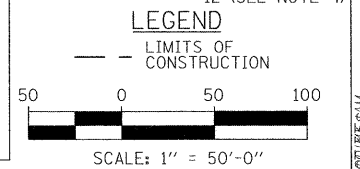
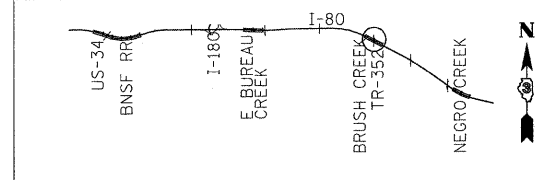
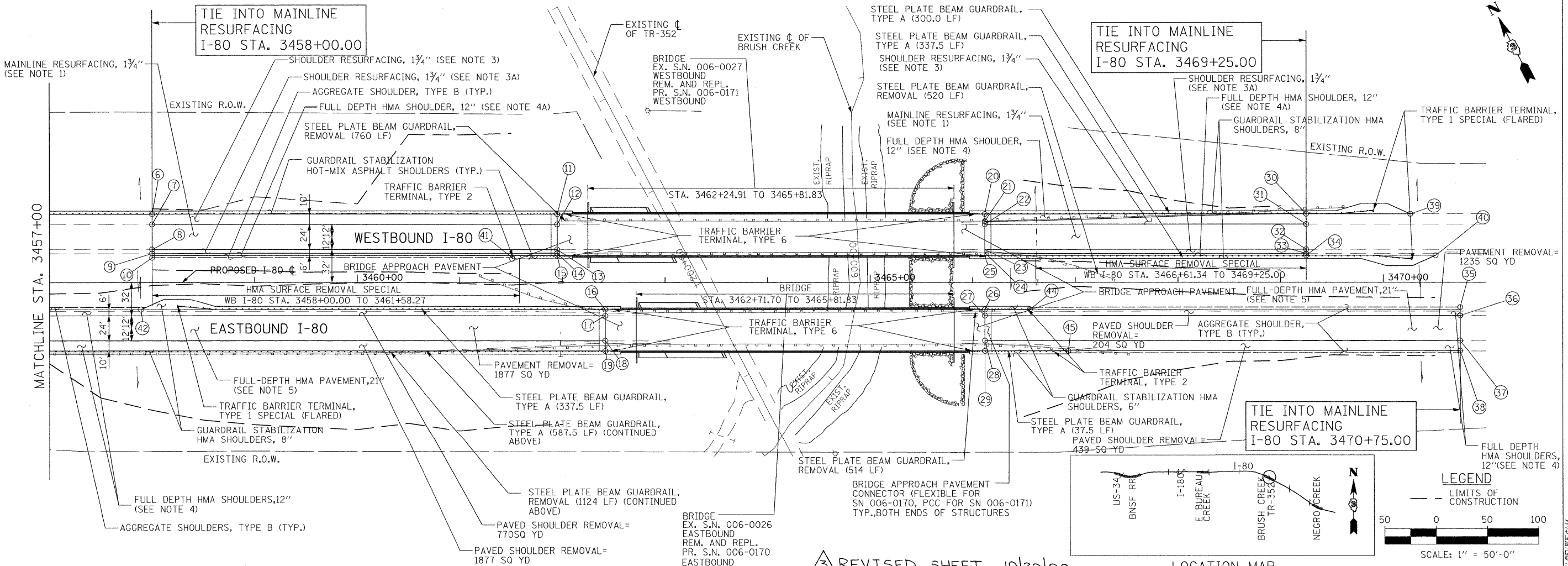
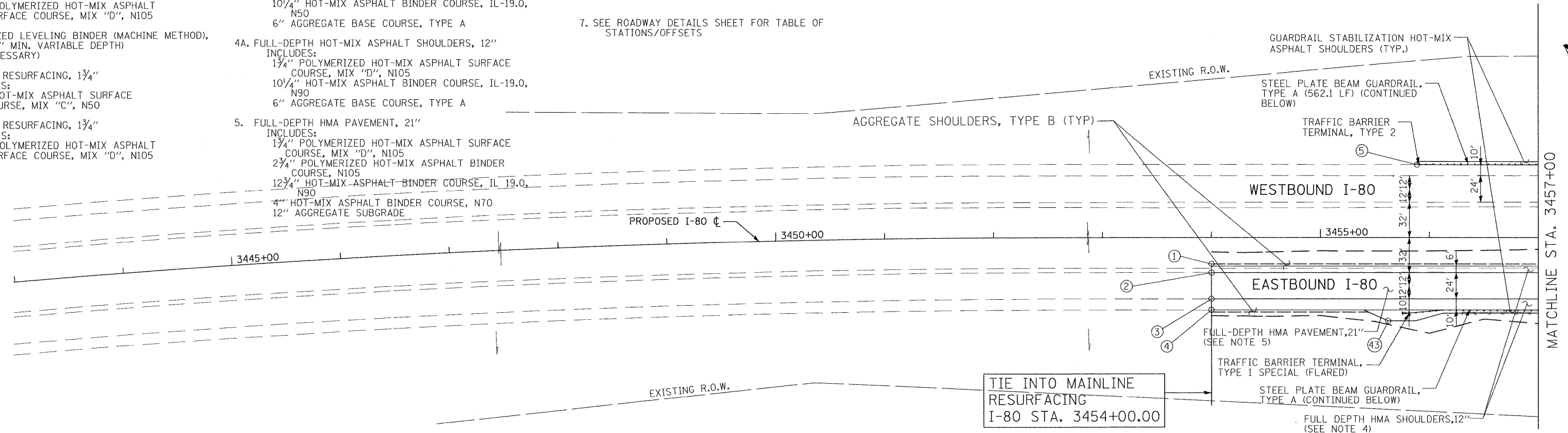

3 REVISED SHEET 10/20/09

TYLIN INTERNATIONAL

USER NAME = braboygc	DESIGNED - CAC	REVISED -
PLOT SCALE = 100.000' / IN.	DRAWN - CAC	REVISED -
PLOT DATE = Oct 19, 2009 - 11:00:33 AM	CHECKED - JDF	REVISED -
	DATE - 08/14/2009	REVISED -

STATE OF ILLINOIS
DEPARTMENT OF TRANSPORTATION

F.A.I. ROUTE 80 (I-80)

SCALE:	SHEET NO.	OF SHEETS	STA.	TO STA.
--------	-----------	-----------	------	---------

F.A.I. RTE. 80	SECTION	COUNTY	TOTAL SHEETS 344	SHEET NO. 49
FED. ROAD DIST. NO.	[ILLINOIS] FED. AID PROJECT	BUREAU		CONTRACT NO. 66908

* 06-(TBR & BR-1,7VB-M, 6BR & 6, 7 RS-1 & II)