

- NOTES:**
1. MAINLINE RESURFACING, 1 3/4"
 - INCLUDES:
 - 1 3/4" POLYMERIZED HOT-MIX ASPHALT SURFACE COURSE, MIX "D", N105
 2. POLYMERIZED LEVELING BINDER (MACHINE METHOD), N90 (3/4" MIN. VARIABLE DEPTH) (AS NECESSARY)
 3. SHOULDER RESURFACING, 1 3/4"
 - INCLUDES:
 - 1 3/4" HOT-MIX ASPHALT SURFACE COURSE, MIX "C", N50
 - 3A. SHOULDER RESURFACING, 1 3/4"
 - INCLUDES:
 - 1 3/4" POLYMERIZED HOT-MIX ASPHALT SURFACE COURSE, MIX "D", N105

4. FULL-DEPTH HOT-MIX ASPHALT SHOULDERS, 12"
 - INCLUDES:
 - 1 3/4" HOT-MIX ASPHALT SURFACE COURSE, MIX "C", N50
 - 10 1/4" HOT-MIX ASPHALT BINDER COURSE, IL-19.0, N50
 - 6" AGGREGATE BASE COURSE, TYPE A
- 4A. FULL-DEPTH HOT-MIX ASPHALT SHOULDERS, 12"
 - INCLUDES:
 - 1 3/4" POLYMERIZED HOT-MIX ASPHALT SURFACE COURSE, MIX "D", N105
 - 10 1/4" HOT-MIX ASPHALT BINDER COURSE, IL-19.0, N90
 - 6" AGGREGATE BASE COURSE, TYPE A
5. FULL-DEPTH CRC PAVEMENT
 - INCLUDES:
 - 10" CONTINUOUSLY REINFORCED PORTLAND CEMENT CONCRETE PAVEMENT
 - 4" STABILIZED SUB-BASE (HMA)
 - 12" AGGREGATE SUBGRADE

6. FULL-DEPTH CONCRETE SHOULDERS
 - INCLUDES:
 - 10" PORTLAND CEMENT CONCRETE SHOULDERS
 - 4" SUB-BASE GRANULAR MATERIAL, TYPE C
 - 12" AGGREGATE SUBGRADE
7. SEE ROADWAY DETAILS SHEET FOR TABLE OF STATIONS/OFFSETS

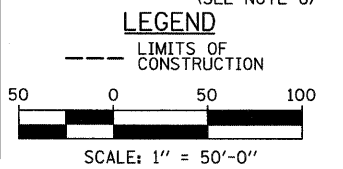
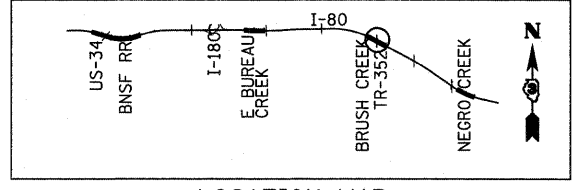
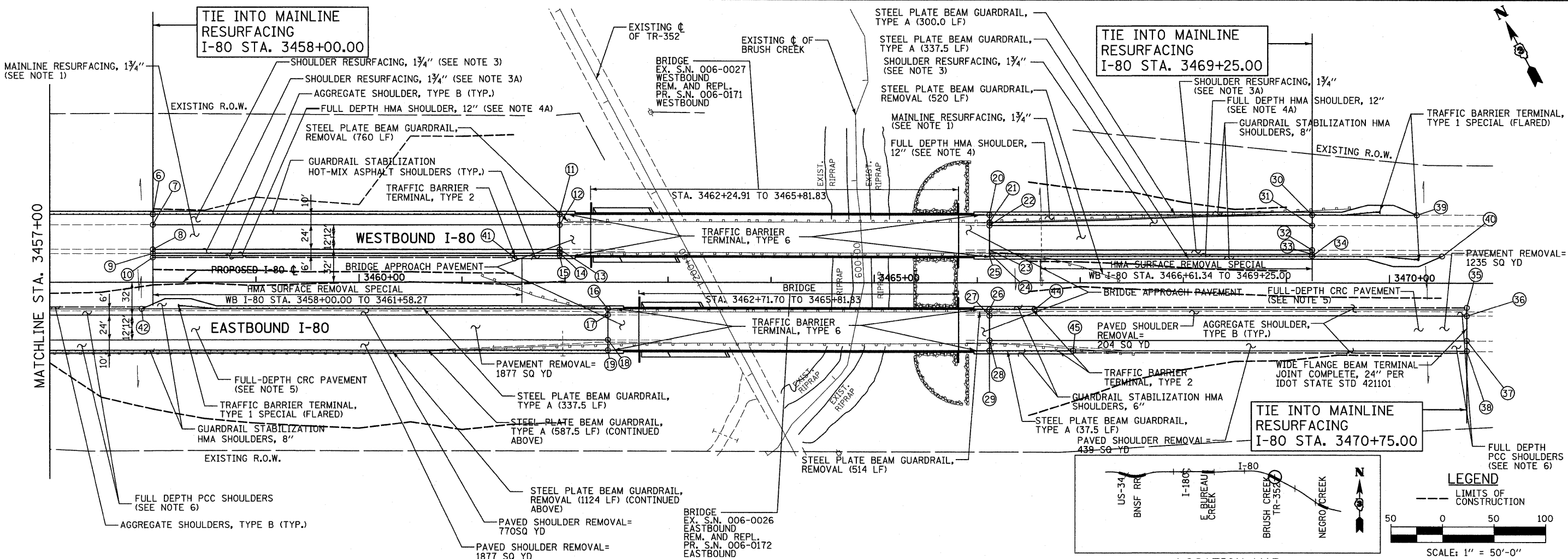
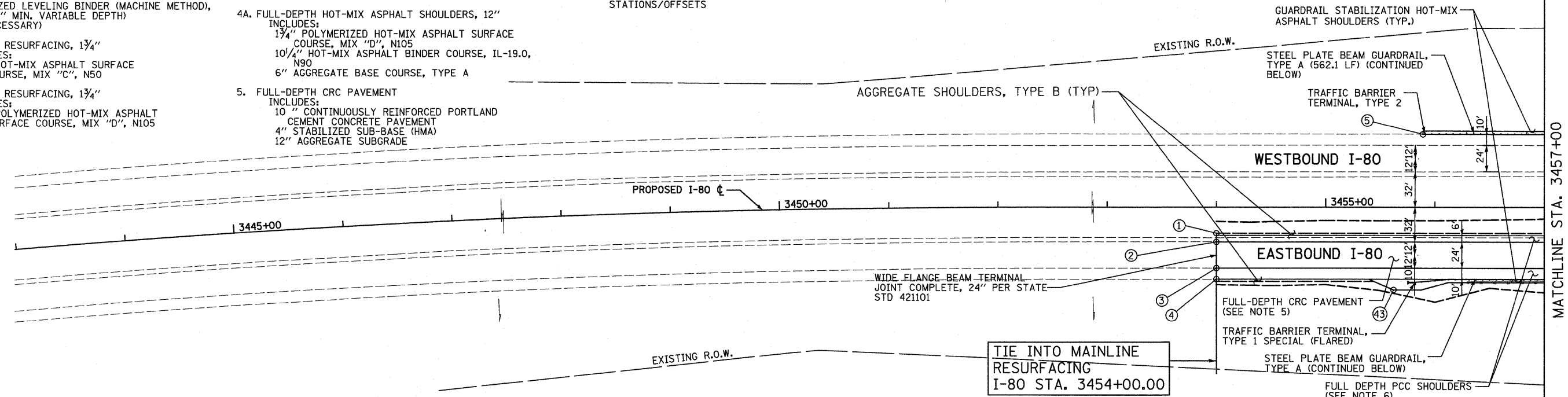

TYLIN INTERNATIONAL

USER NAME = #USER#	DESIGNED - CAC	REVISED -
PLOT SCALE = #SCALE#	DRAWN - CAC	REVISED -
PLOT DATE = 8/14/2009	CHECKED - JDF	REVISED -
	DATE - 08/14/2009	REVISED -

**STATE OF ILLINOIS
DEPARTMENT OF TRANSPORTATION**

F.A.I. ROUTE 80 (I-80)

SCALE:	SHEET NO.	OF SHEETS	STA.	TO STA.
--------	-----------	-----------	------	---------

F.A.I. RTE.	SECTION	COUNTY	TOTAL SHEETS	SHEET NO.
80		BUREAU	377	49
FED. ROAD DIST. NO.			ILLINOIS FED. AID PROJECT	
			CONTRACT NO. 66908	

* 06-17BR & BR-1,7VB-M, 6BR & 6, 7 RS-1 & IJ