

SYMBOLS

- ▨ Vertical Panel (back to back)
- ↑ Arrow board
- ⊥ Sign
- ⬇ Direction Indicator barricade with steady burn monodirectional light
- Drum with steady burn monodirectional light
- ⬇ Type II barricade, drum, or vertical barricade with steady burn monodirectional light
- ① Wet temporary pavement marking tape - TY III shall be placed throughout the taper and along-side the work area. The edge lines shall be white and the line near the barrier shall be yellow.

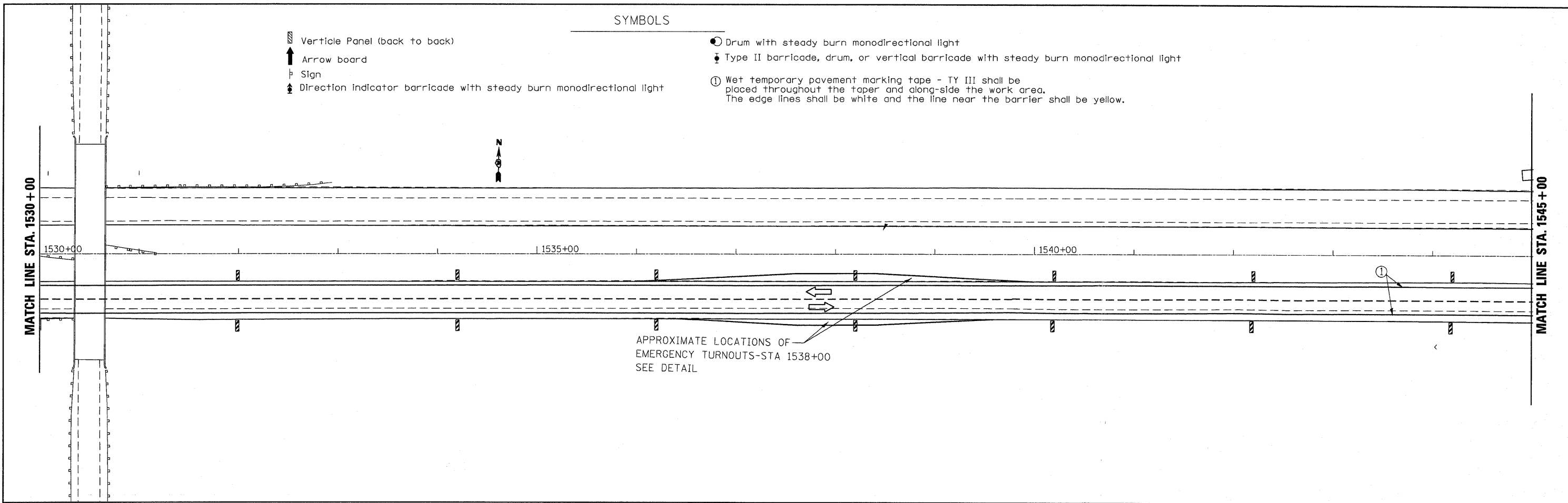

APPROXIMATE LOCATIONS OF
EMERGENCY TURNOUTS-STA 1538+00
SEE DETAIL

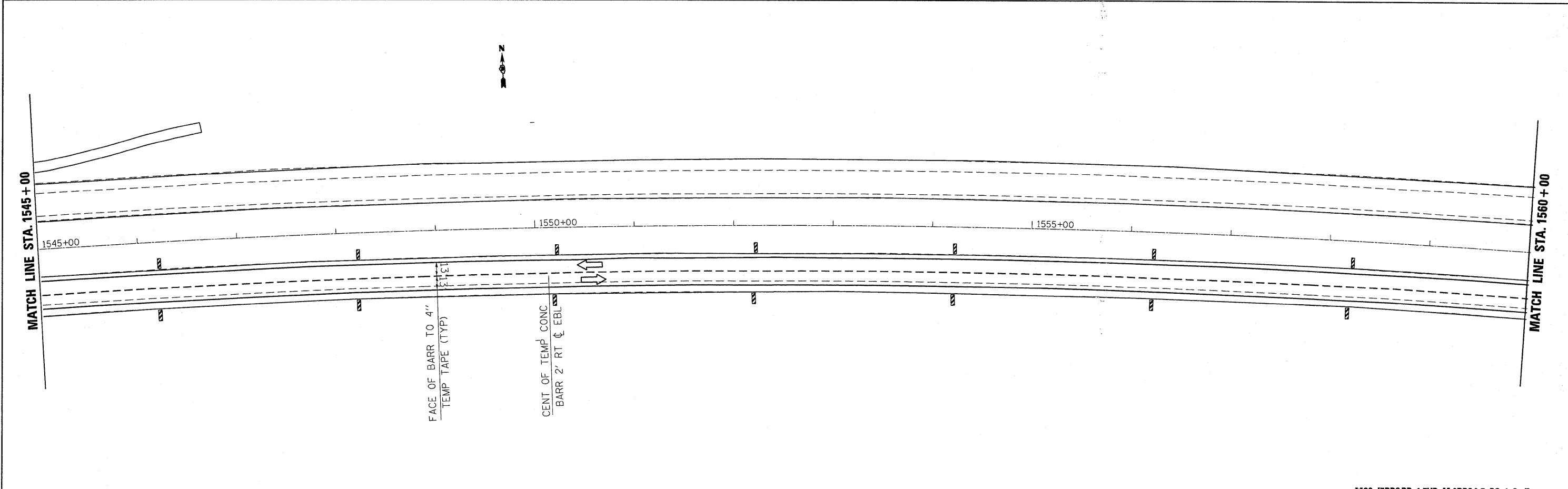

FILE NAME = c:\pwork\PWIDOT\BRABOYPC\d0112640\d365708-shr-staging.dgn USER NAME = braboypc PLOT SCALE = 50.0000' / IN. PLOT DATE = Sep 07, 2009 - 01:12:35 PM				DESIGNED - DRAWN - CHECKED - DATE -				REVISED - REVISED - REVISED - REVISED -				STATE OF ILLINOIS DEPARTMENT OF TRANSPORTATION				STAGE I CONSTRUCTION				F.A. RTE. I-80	SECTION **	COUNTY BUREAU	TOTAL SHEETS 344	SHEET NO. 64
SCALE: SHEET NO. OF SHEETS STA. TO STA.												ILLINOIS FED. AID PROJECT CONTRACT NO. 66908												

**06-(7BR&BR-1,7VB-M,6BR&6,7 RS-1 & I)