

**SYMBOLS**

- ▨ Vertical Panel (back to back)
- ↑ Arrow board
- ⊥ Sign
- ⬇ Direction indicator barricade with steady burn monodirectional light
- ⊙ Drum with steady burn monodirectional light
- ⊥ Type II barricade, drum, or vertical barricade with steady burn monodirectional light
- ① Wet temporary pavement marking tape - TY III shall be placed throughout the taper and along-side the work area. The edge lines shall be white and the line near the barrier shall be yellow.

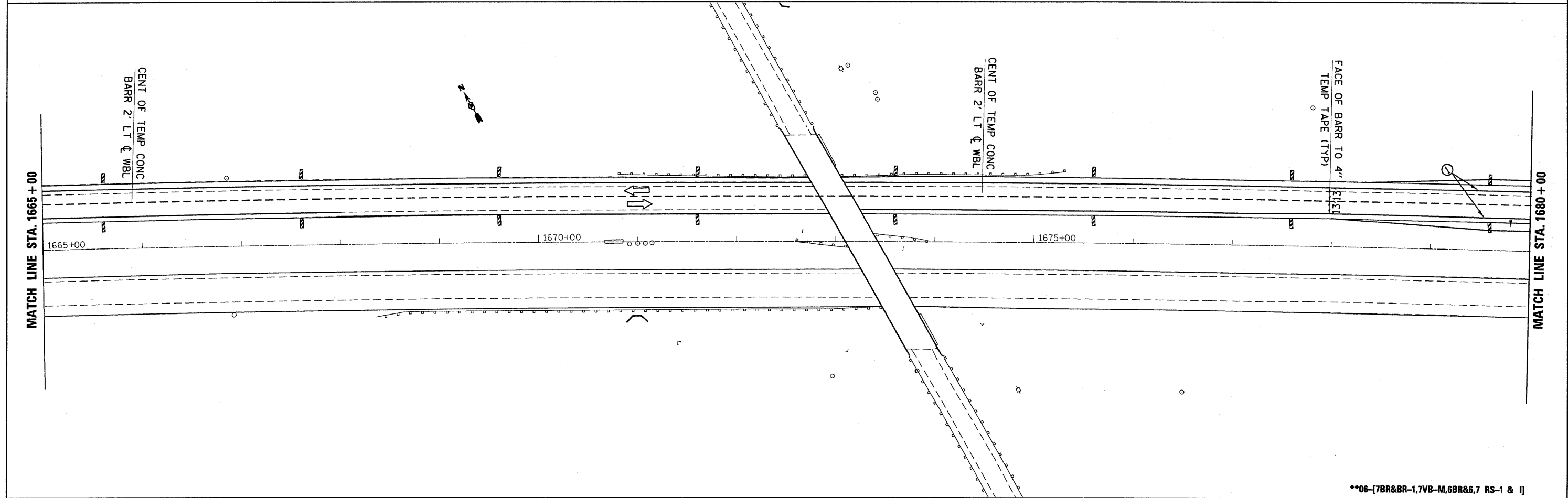

FILE NAME =		USER NAME = braboypc	DESIGNED -	REVISED -	<b>STATE OF ILLINOIS DEPARTMENT OF TRANSPORTATION</b>	<b>STAGE II CONSTRUCTION</b>				F.A. RTE. I-80	SECTION **	COUNTY BUREAU	TOTAL SHEETS 344	SHEET NO. 85
c:\pwwork\pwidot\BRABOYPC\d0112640\d365908-sht-staging.dgn		PLOT SCALE = 50.0000' / IN.	DRAWN -	REVISED -		SCALE:	SHEET NO.	OF	SHEETS	STA.	TO STA.	CONTRACT NO. 66908		
PLOT DATE = Sep 07, 2009 - 01:17:07 PM		CHECKED -	REVISED -	DATE -		ILLINOIS FED. AID PROJECT								
		DATE -	REVISED -											

\*\*06-[7BR&BR-1,7VB-M,6BR&6,7 RS-1 & I]