

Notes:
See sheet 23 of 43 for Sections C-C & D-D and View E-E.
a(E), a₁(E), and w(E) bar spacings measured perpendicular to ϕ Rdwy.

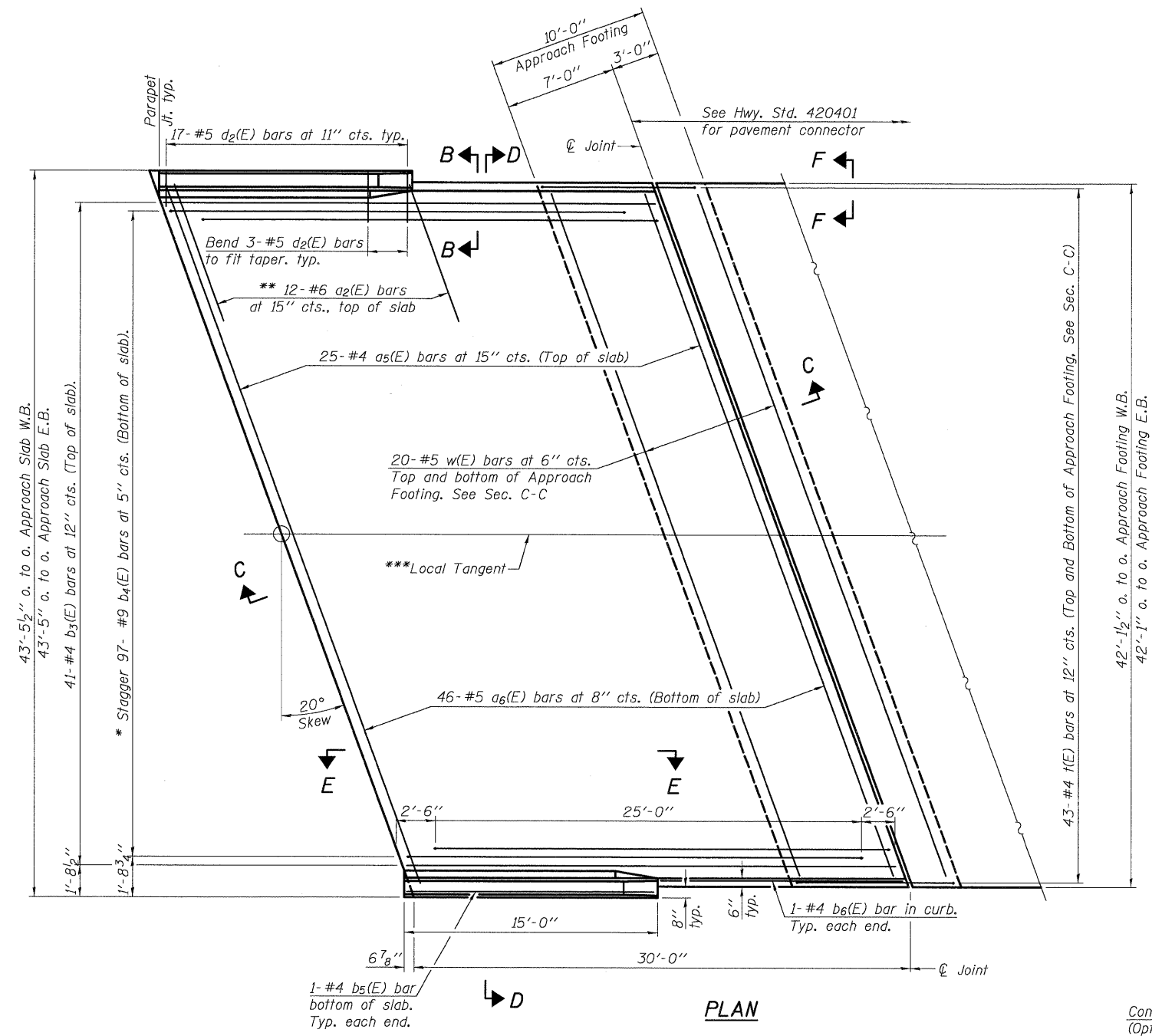

* Tilt #9 b₄(E) bars as required to maintain clearance.
** Alternate with a₅(E) bars, typ. each parapet.
*** See Sheets 8, 9, 14 & 15 of 45 for stations along Local Tangent.

*** Cost included with Concrete Superstructure.

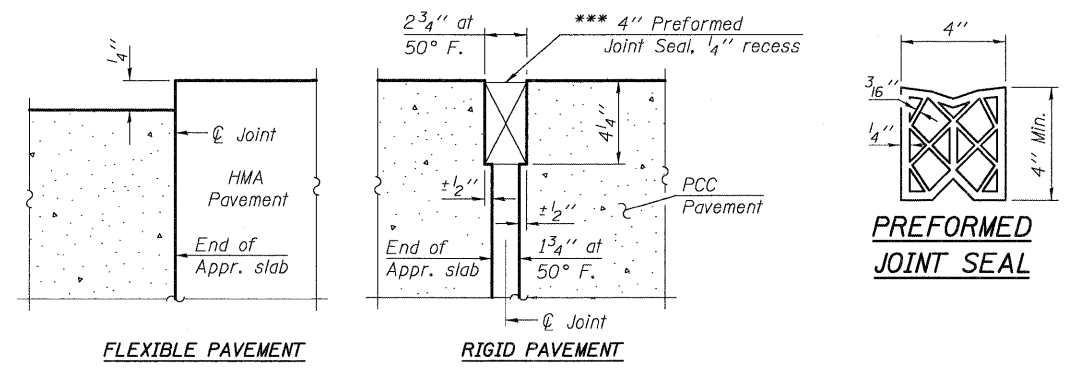

DETAIL A

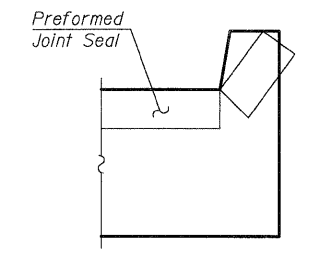

VIEW F-F

Angle Preformed Joint Seal at 45° at curbs when req'd for drainage.

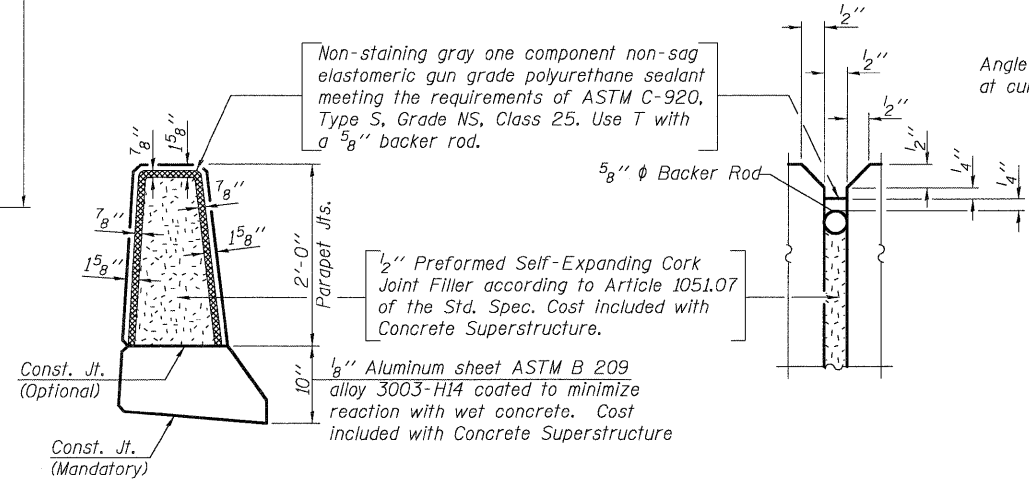

PARAPET JOINT DETAILS

(Sheet 1 of 2)

BRIDGE APPROACH SLAB DETAILS
SN 006-0172 (EB) & SN 006-0173 (WB)

PLOT DATE = 09/06/2009
FILE NAME = ...0060172-0173-66908-022-barr.dgn
USER NAME = ...0060172-0173-66908-022-barr.dgn

BA-R 10-31-08

CB Coombe-Bloxdorf P.C.
- CIVIL ENGINEERS -
- STRUCTURAL ENGINEERS -
- LAND SURVEYORS -
Design Firm License No. 184-002703

PROJECT NO.	05061
SCALE	
DATE	6/25/09
DESIGN BY	RM/MCB
DRAWN BY	TFG
CHECKED BY	MCR

SHEET NO. 22	F.A.I. RTE. 80	SECTION *	COUNTY BUREAU	TOTAL SHEETS 344	SHEET NO. 175
		CONTRACT NO. 66908			
FED. ROAD DIST. NO. 7 ILLINOIS FED. AID PROJECT					

*06-[7BR & BR-1, TVB-M, 6BR & 6, 7 RS-1 & I]