

STATE OF ILLINOIS  
DEPARTMENT OF TRANSPORTATION

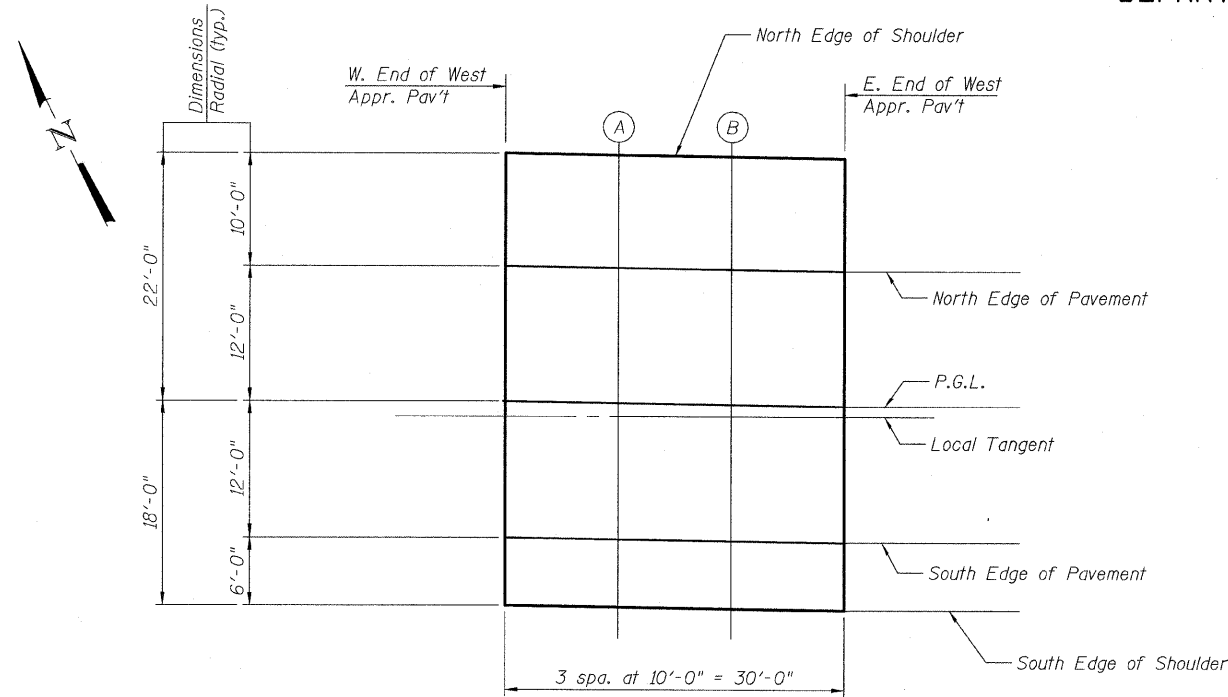

**PLAN**  
West Approach

**NORTH EDGE OF SHOULDER**

Location	Station	Offset	Theoretical Grade Elevations
W. End West Appr. Pav't	3607+65.33	-22.00'	646.73
A	3607+75.39	-22.00'	646.79
B	3607+85.44	-22.00'	646.85
E. End West. Appr. Pav't	3607+95.50	-22.00'	646.91

**NORTH EDGE OF PAVEMENT**

Location	Station	Offset	Theoretical Grade Elevations
W. End West Appr. Pav't	3607+65.45	-12.00'	646.88
A	3607+75.50	-12.00'	646.94
B	3607+85.55	-12.00'	647.00
E. End West. Appr. Pav't	3607+95.60	-12.00'	647.06

**P.G.L. WESTBOUND**

Location	Station	Offset	Theoretical Grade Elevations
W. End West Appr. Pav't	3607+65.56	0.00'	647.06
A	3607+75.64	0.00'	647.12
B	3607+85.68	0.00'	647.19
E. End West. Appr. Pav't	3607+95.71	0.00'	647.25

**SOUTH EDGE OF PAVEMENT**

Location	Station	Offset	Theoretical Grade Elevations
W. End West Appr. Pav't	3607+65.75	12.00'	647.24
A	3607+75.77	12.00'	647.31
B	3607+85.80	12.00'	647.37
E. End West. Appr. Pav't	3607+95.83	12.00'	647.43

**SOUTH EDGE OF SHOULDER**

Location	Station	Offset	Theoretical Grade Elevations
W. End West Appr. Pav't	3607+65.82	18.00'	647.33
A	3607+75.84	18.00'	647.40
B	3607+85.87	18.00'	647.46
E. End West. Appr. Pav't	3607+95.89	18.00'	647.52

**NORTH EDGE OF SHOULDER**

Location	Station	Offset	Theoretical Grade Elevations
W. End East Appr. Pav't	3610+17.78	-22.00'	647.89
A	3610+27.84	-22.00'	647.92
B	3610+37.90	-22.00'	647.95
E. End East Appr. Pav't	3610+47.95	-22.00'	647.97

**NORTH EDGE OF PAVEMENT**

Location	Station	Offset	Theoretical Grade Elevations
W. End East Appr. Pav't	3610+17.68	-12.00'	648.04
A	3610+27.73	-12.00'	648.07
B	3610+37.78	-12.00'	648.10
E. End East Appr. Pav't	3610+47.83	-12.00'	648.12

**P.G.L. WESTBOUND**

Location	Station	Offset	Theoretical Grade Elevations
W. End East Appr. Pav't	3610+17.56	0.00'	648.22
A	3610+27.61	0.00'	648.25
B	3610+37.64	0.00'	648.28
E. End East Appr. Pav't	3610+47.68	0.00'	648.30

**SOUTH EDGE OF PAVEMENT**

Location	Station	Offset	Theoretical Grade Elevations
W. End East Appr. Pav't	3610+17.45	12.00'	648.40
A	3610+27.48	12.00'	648.43
B	3610+37.51	12.00'	648.46
E. End East Appr. Pav't	3610+47.54	12.00'	648.48

**SOUTH EDGE OF SHOULDER**

Location	Station	Offset	Theoretical Grade Elevations
W. End East Appr. Pav't	3610+17.39	18.00'	648.49
A	3610+27.42	18.00'	648.52
B	3610+37.44	18.00'	648.55
E. End East Appr. Pav't	3610+47.46	18.00'	648.57

**TOP OF APPROACH SLAB  
ELEVATIONS  
STRUCTURE NO. 006-0175 (WB)**

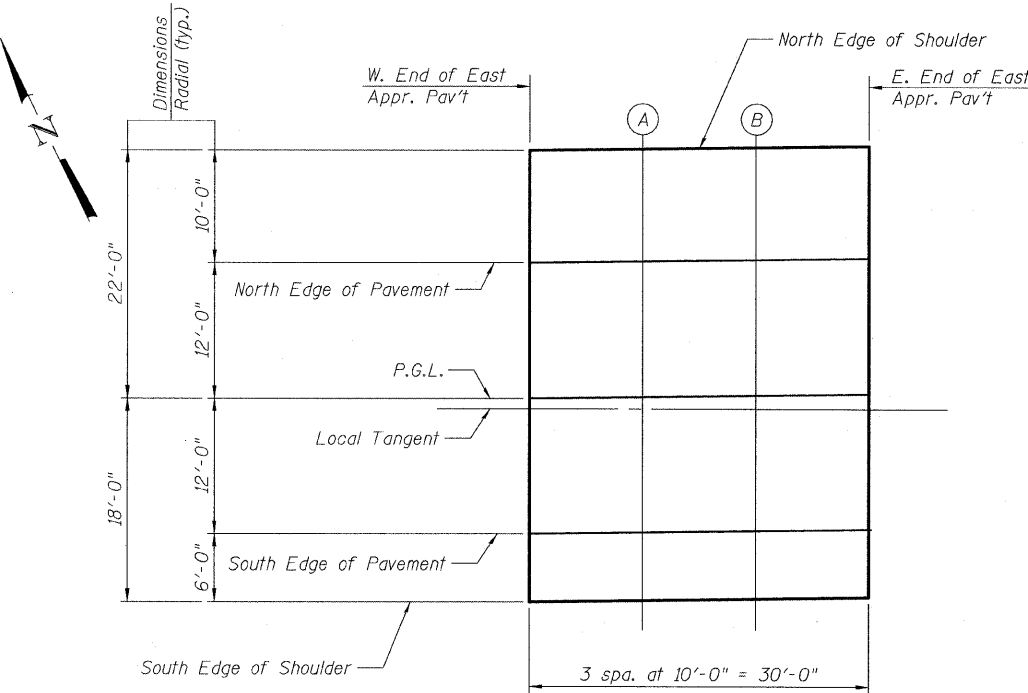

**PLAN**  
East Approach

DESIGNED	I.M.
CHECKED	PDF
DRAWN	I.M.
CHECKED	PDF

SHEET NO. 10 39 SHEETS	F.A. RTE. 80	SECTION *	COUNTY BUREAU	TOTAL SHEETS 394	SHEET NO. 208
	CONTRACT NO. 66908				
FED. ROAD DIST. NO.		ILLINOIS FED. AID PROJECT			

TYLIN INTERNATIONAL