

PLOTTED BY: \_\_\_\_\_  
 PLOT DATE: \_\_\_\_\_  
 AREAS CHECKED: \_\_\_\_\_  
 NO. \_\_\_\_\_  
 NOTE BOOK: \_\_\_\_\_  
 NO. \_\_\_\_\_

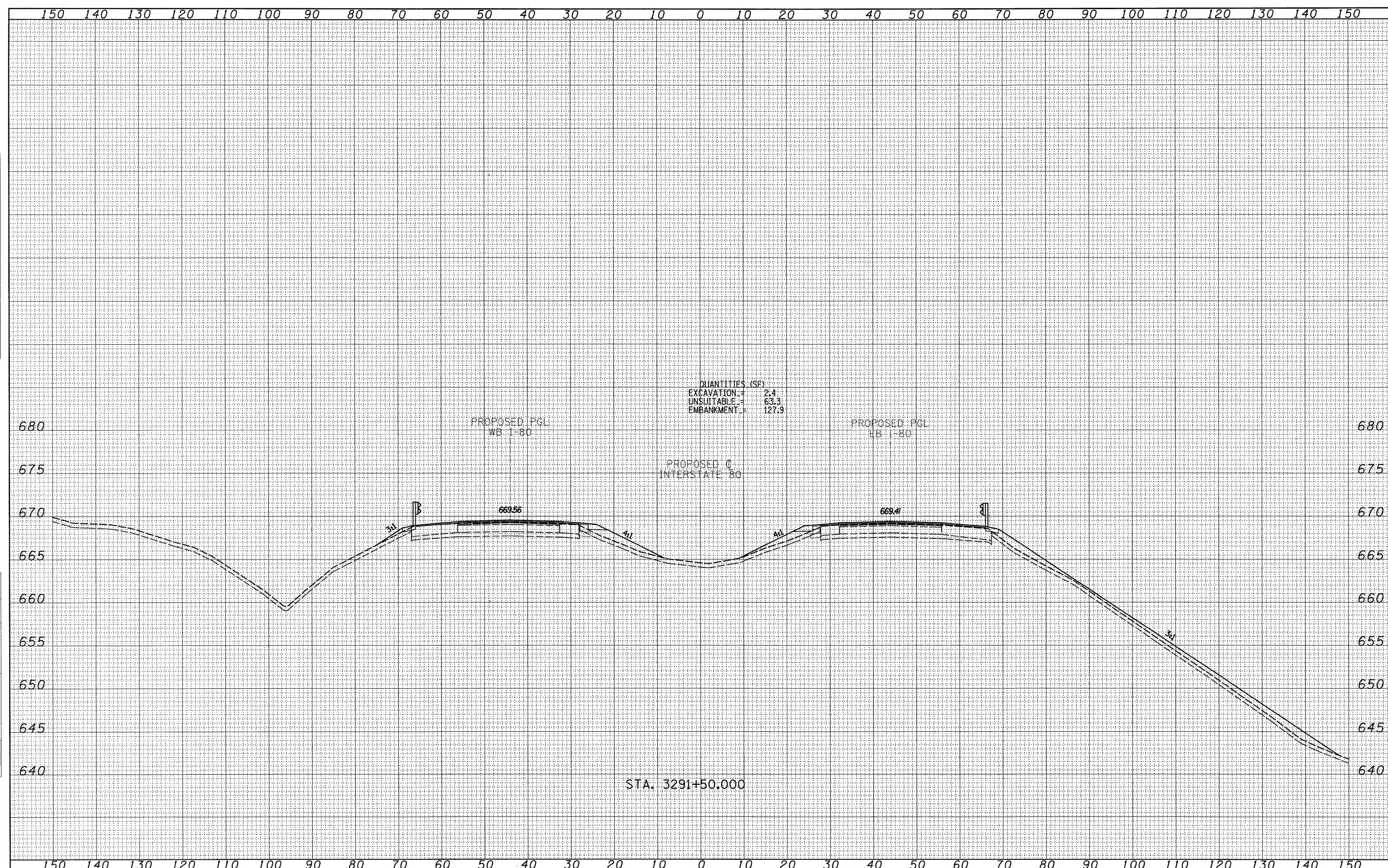

QUANTITIES (SF)

EXCAVATION	=	2.4
UNSUITABLE	=	63.3
EMBANKMENT	=	127.9

PROPOSED PGL  
WB 1-80

PROPOSED PGL  
EB 1-80

PROPOSED  
INTERSTATE 80

STA. 3291+50.000

FILE NAME = \_\_\_\_\_  
 \*FILEL\$ \_\_\_\_\_  
**TYLIN INTERNATIONAL**

USER NAME = #USER*	DESIGNED -	REVISED -
PLOT SCALE = #SCALE*	DRAWN -	REVISED -
PLOT DATE = 6/14/2009	CHECKED -	REVISED -
	DATE -	REVISED -

**STATE OF ILLINOIS**  
**DEPARTMENT OF TRANSPORTATION**

SCALE:	SHEET NO. OF SHEETS	STA. 3291+50.000 TO STA. 3291+50.000
--------	---------------------	--------------------------------------

F.A. RTE.	SECTION	COUNTY	TOTAL SHEETS	SHEET NO.
80	.	BUREAU	344	308
CONTRACT NO. 66908				

FED. ROAD DIST. NO. \_\_\_\_\_ ILLINOIS FED. AID PROJECT  
 • 06-17BR & BR-1, TVB-M, 6BR & 6, 7 RS-1 & 11

P:\602429\11-80\Road\602429\_20\_P\203703XSI.dgn 8/14/2009 4:43:07 PM