

150 140 130 120 110 100 90 80 70 60 50 40 30 20 10 0 10 20 30 40 50 60 70 80 90 100 110 120 130 140 150

QUANTITIES (SF)
 EXCAVATION = 23.8
 UNSUITABLE = 9.3
 EMBANKMENT = 8.1

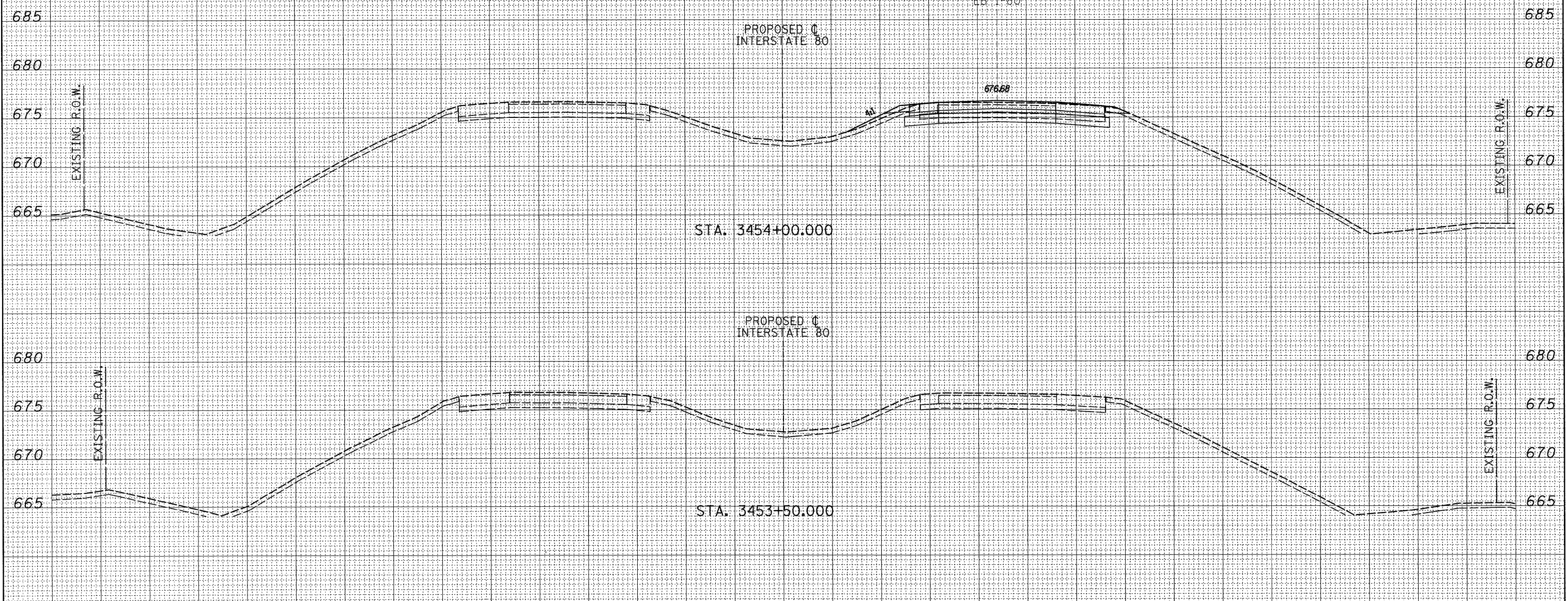

STA. 3454+00.00

STA. 3453+50.00

PROPOSED C
 INTERSTATE 80

PROPOSED C
 INTERSTATE 80

PROPOSED PGL
 EB 1:80

676.68

FILE NAME =
 #FILE#
TYLIN INTERNATIONAL

USER NAME = #USER#
 PLOT SCALE = #SCALE#
 PLOT DATE = 8/17/2009

DESIGNED -	REVISED -
DRAWN -	REVISED -
CHECKED -	REVISED -
DATE -	REVISED -

**STATE OF ILLINOIS
 DEPARTMENT OF TRANSPORTATION**

PROPOSED CROSS SECTIONS
 SCALE: SHEET NO. OF SHEETS STA. 3453+50.00 TO STA. 3454+00.00

F.A. RTE. 80	SECTION .	COUNTY	TOTAL SHEETS 344	SHEET NO. 311
BUREAU			CONTRACT NO. 66908	
FED. ROAD DIST. NO. ILLINOIS FED. AID PROJECT				

• 06-C7BR & BR-1, TVB-M, 6BR & 6, 7 RS-1 & 1J

P:\6024231\1-80\Road\602423-30_C_209931\501.dgn

8/17/2009 4:36:01 PM