

**STATE OF ILLINOIS  
DEPARTMENT OF TRANSPORTATION  
DIVISION OF HIGHWAYS**

CONTRACT NO. 70623				
F.A.P. R.T.E.	SECTION	COUNTY	TOTAL SHEETS	SHEET NO.
808	*	**	715	2
STA.	TO STA.			
FED. ROAD DIST. NO.	ILLINOIS	FED. AID PROJECT		
		• (205,57,105)RS-2		
		•• CHAMPAIGN & DOUGLAS		

**PROPOSED ACROSS ROAD CULVERT LOCATION MAP**

- A- STATION 1000+80.00  
CULVERT ADDITION  
24" RCCP PIPE CULVERT  
EXISTING S.N. = N/A  
PROPOSED S.N. = N/A
- B- STATION 1016+00.00  
CULVERT ADDITION  
24" RCCP PIPE CULVERT  
EXISTING S.N. = N/A  
PROPOSED S.N. = N/A
- C- STATION 1052+50.00  
CULVERT ADDITION  
24" RCCP PIPE CULVERT  
EXISTING S.N. = N/A  
PROPOSED S.N. = N/A
- D- STATION 1053+70.00  
CULVERT ADDITION  
24" RCCP PIPE CULVERT  
EXISTING S.N. = N/A  
PROPOSED S.N. = N/A
- E- STATION 1066+20.00  
CULVERT ADDITION  
24" RCCP PIPE CULVERT  
EXISTING S.N. = N/A  
PROPOSED S.N. = N/A
- F- STATION 1109+00.00  
CULVERT REPLACEMENT  
5' X 3' PRECAST CONC. BOX CULVERT  
EXISTING S.N. = N/A  
PROPOSED S.N. = N/A
- G- STATION 1114+71.00  
CULVERT REPLACEMENT  
5' X 3' PRECAST CONC. BOX CULVERT  
EXISTING S.N. = N/A  
PROPOSED S.N. = N/A
- H- STATION 1129+95.00  
CULVERT REPLACEMENT  
48" RCCP PIPE CULVERT  
EXISTING S.N. = N/A  
PROPOSED S.N. = N/A
- I- STATION 1145+38.00  
CULVERT REPLACEMENT  
2 - 10' X 4' PRECAST CONC. BOX CULVERT  
EXISTING S.N. = 010-8098  
PROPOSED S.N. = 010-2036
- J- STATION 2013+50.00  
CULVERT REPLACEMENT  
7' X 5' PRECAST CONC. BOX CULVERT  
EXISTING S.N. = 010-8097  
PROPOSED S.N. = 010-8145

SECTION (205,57,105)RS-2  
ENDS @ STATION 2309+00.00

BRIDGE OMISSION:  
S.N. 010-0113  
STATION 2076+00.00 TO  
STATION 2083+00.00

STATION EQUATION:  
STATION 1149+47.99 BK =  
STATION 1997+74.14 AH

STATION EQUATION:  
STATION 320+90.82 BK =  
STATION 1000+00.00 AH

SECTION (205,57,105)RS-2  
BEGINS @ STATION 297+50.00

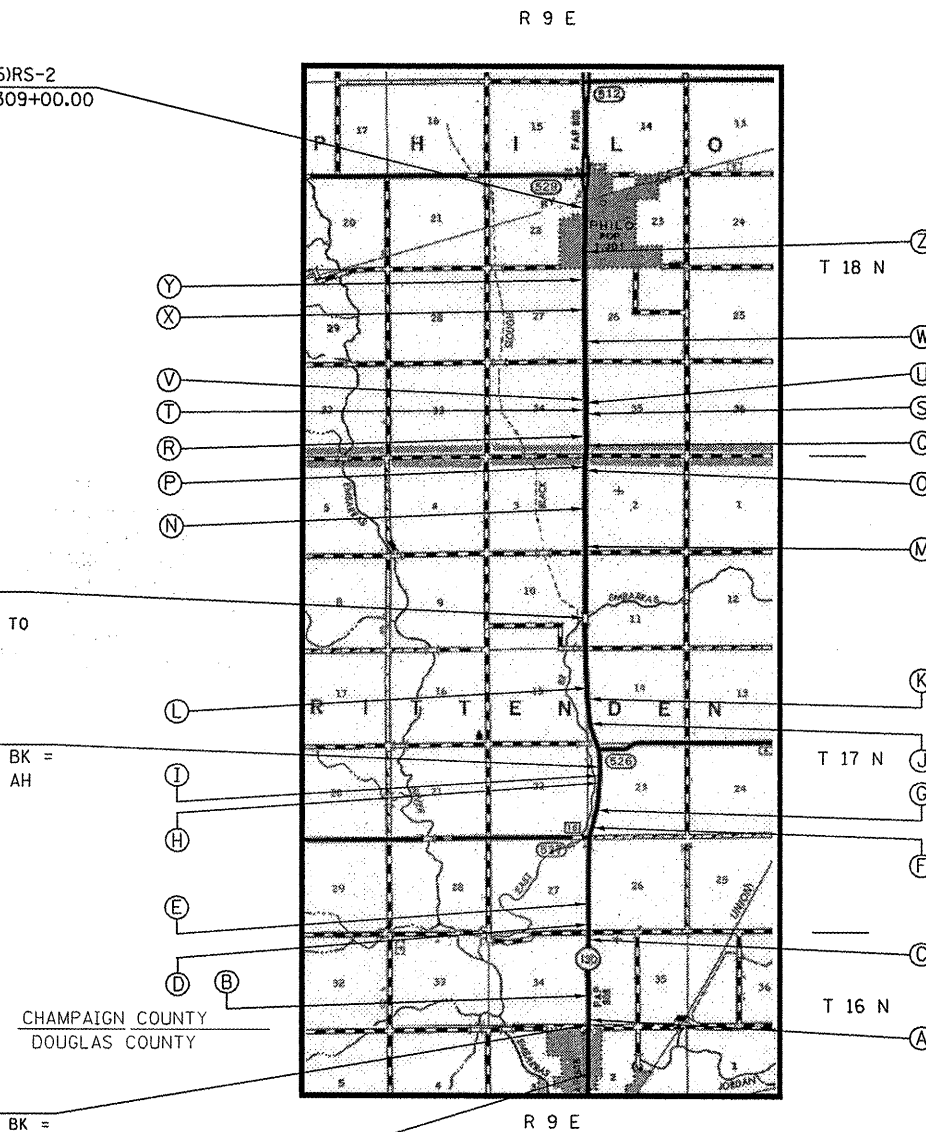

- K- STATION 2025+00.00  
CULVERT REPLACEMENT  
12' X 3' PRECAST CONC. BOX CULVERT  
EXISTING S.N. = N/A  
PROPOSED S.N. = 010-8144
- L- STATION 2030+82.00  
CULVERT REPLACEMENT  
12' X 3' PRECAST CONC. BOX CULVERT  
EXISTING S.N. = N/A  
PROPOSED S.N. = 010-8143
- M- STATION 2116+20.00  
CULVERT ADDITION  
12' X 2' PRECAST CONC. BOX CULVERT  
EXISTING S.N. = N/A  
PROPOSED S.N. = 010-8142
- N- STATION 2140+90.00  
CULVERT ADDITION  
2 - 6' X 2' PRECAST CONC. BOX CULVERT  
EXISTING S.N. = N/A  
PROPOSED S.N. = 010-8141
- O- STATION 2163+90.00  
CULVERT ADDITION  
24" EQRS CONC. PIPE CULVERT  
EXISTING S.N. = N/A  
PROPOSED S.N. = N/A
- P- STATION 2164+00.00  
CULVERT ADDITION  
24" EQRS CONC. PIPE CULVERT  
EXISTING S.N. = N/A  
PROPOSED S.N. = N/A
- Q- STATION 2169+55.00  
CULVERT ADDITION  
12' X 2' PRECAST CONC. BOX CULVERT  
EXISTING S.N. = N/A  
PROPOSED S.N. = 010-8140
- R- STATION 2171+00.00  
CULVERT ADDITION  
12' X 2' PRECAST CONC. BOX CULVERT  
EXISTING S.N. = N/A  
PROPOSED S.N. = 010-8139
- S- STATION 2189+85.00  
CULVERT ADDITION  
24" EQRS CONC. PIPE CULVERT  
EXISTING S.N. = N/A  
PROPOSED S.N. = N/A
- T- STATION 2190+00.00  
CULVERT ADDITION  
24" EQRS CONC. PIPE CULVERT  
EXISTING S.N. = N/A  
PROPOSED S.N. = N/A
- U- STATION 2194+75.00  
CULVERT ADDITION  
24" EQRS CONC. PIPE CULVERT  
EXISTING S.N. = N/A  
PROPOSED S.N. = N/A
- V- STATION 2194+90.00  
CULVERT ADDITION  
24" EQRS CONC. PIPE CULVERT  
EXISTING S.N. = N/A  
PROPOSED S.N. = N/A
- W- STATION 2224+84.00  
CULVERT REPLACEMENT  
2 - 10' X 2' PRECAST CONC. BOX CULVERT  
EXISTING S.N. = N/A  
PROPOSED S.N. = 010-2035
- X- STATION 2237+60.00  
CULVERT REPLACEMENT  
10' X 2' PRECAST CONC. BOX CULVERT  
EXISTING S.N. = 010-8096  
PROPOSED S.N. = 010-8138
- Y- STATION 2264+81.00  
CULVERT REPLACEMENT  
2 - 8' X 4' PRECAST CONC. BOX CULVERT  
EXISTING S.N. = 010-8095  
PROPOSED S.N. = 010-8137
- Z- STATION 2280+50.00  
CULVERT ADDITION  
8' X 2' PRECAST CONC. BOX CULVERT  
EXISTING S.N. = N/A  
PROPOSED S.N. = 010-8136

PLOT DATE = 8/12/2009  
 FILE NAME = c:\pwworkspace\pwwork\cearlock\10623\sh1-det01ils.dgn  
 PLOT SCALE = 42.3529 / IN.  
 USER NAME = cearlockjd

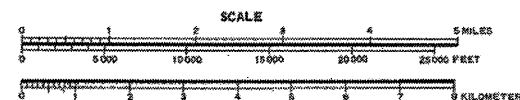

ILLINOIS DEPARTMENT OF TRANSPORTATION

**ACROSS ROAD CULVERT  
LOCATION MAP**

SCALE: N/A                      DRAWN BY: B.B.P.  
DATE: 07/29/09                      CHECKED BY: G.A.E.