

F.A.P. RTE.	SECTION	COUNTY	TOTAL SHEETS	SHEET NO.
808	.	..	715	84
STA. 2073+25.00		TO STA. 2088+50.00		
FED. ROAD DIST. NO.		ILLINOIS FED. AID PROJECT		



- INCIDENTAL HOT-MIX ASPHALT SURFACING
- AGGREGATE SURFACE COURSE, TYPE B
- HOT-MIX ASPHALT SURFACE REMOVAL - BUTT JOINT
- DRIVEWAY PAVEMENT REMOVAL

SEC. 10, T. 17 N., R. 9 E., 3rd P.M.

**JEFFERY W. WATSON AND
HELEN V. WATSON
5527020**

ANN MCCOMB

PIPE CULVERT, CLASS D, TYPE 1, 24"x40.0'
WITH END SECTIONS, 24" - 2.0 EACH
37.5' LT., STA. 2087+89.80, D.S.F.L. = 656.30
37.0' LT., STA. 2088+29.80, U.S.F.L. = 656.80

- (205,57,105)RS-2
- CHAMPAIGN & DOUGLAS

PLAN	SURVEYED	BY	DATE
	PLOTTED		
	CHECKED		
	DATE		

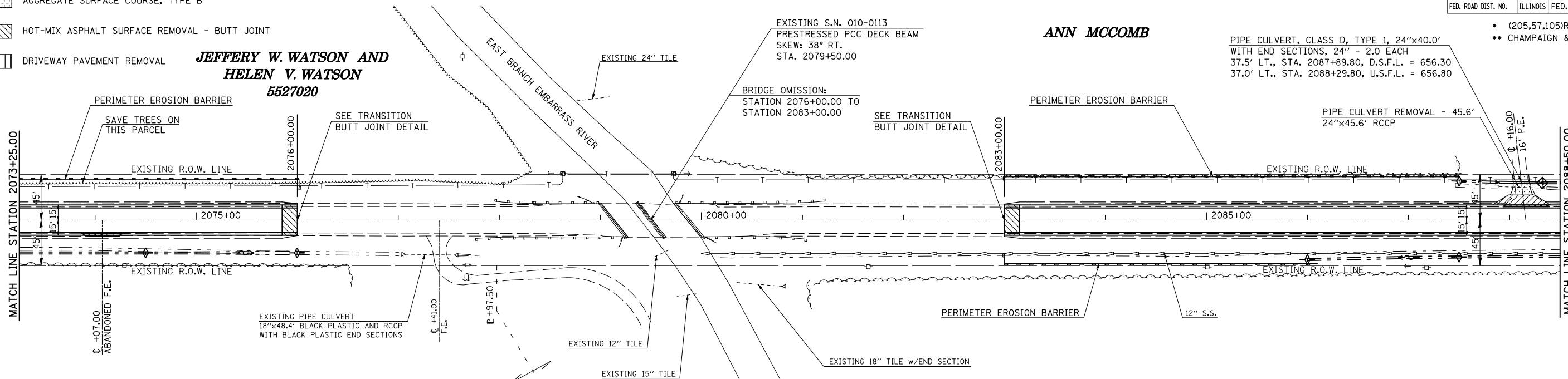

**LEO FRANKLIN MOORE AND
JANICE ROSE MOORE
5527021**

**LEO FRANKLIN MOORE AND
JANICE ROSE MOORE
5527021**

SEC. 11, T. 17 N., R. 9 E., 3rd P.M.

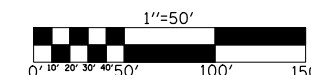

PROFILE	SURVEYED	BY	DATE
	PLOTTED		
	CHECKED		
	DATE		

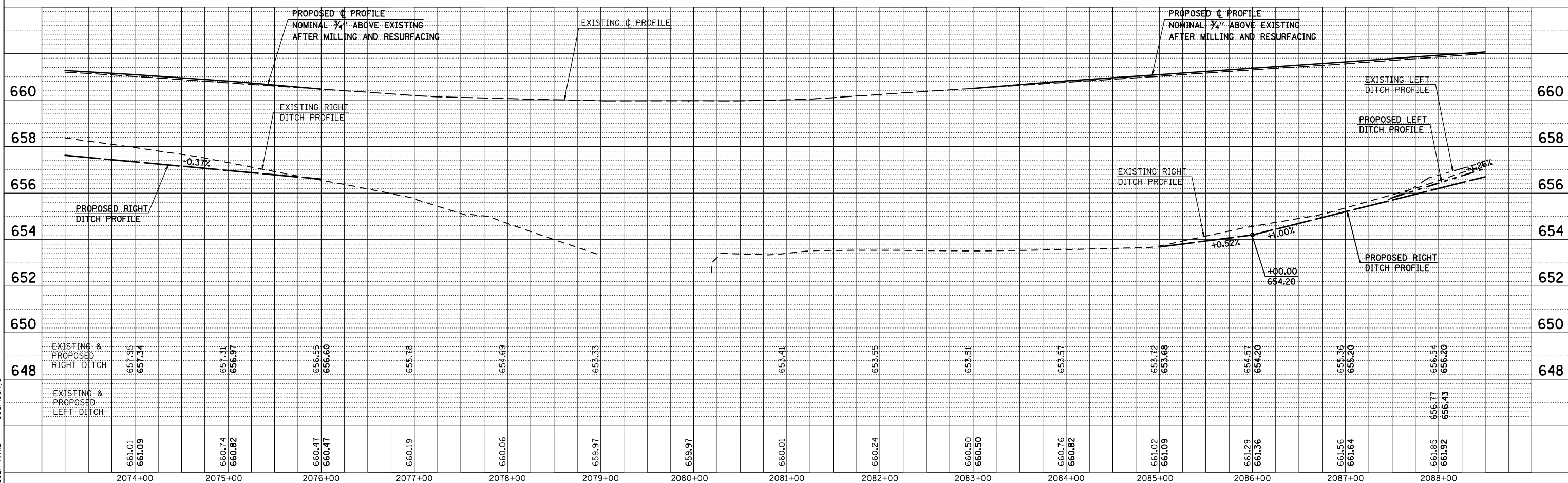

PLOT DATE = 8/13/2009
FILE NAME = c:\pwworkspace\pwworkspace\1058824\1058824.dwg
PLOT SCALE = 1/8"=1'-0"
USER NAME = geoglockj