

SEC. 34, T. 18 N., R. 9 E., 3rd P.M.

F.A.P. RTE.	SECTION	COUNTY	TOTAL SHEETS	SHEET NO.
808	*	**	715	91
STA. 2178+25.00 TO STA. 2193+25.00				
FED. ROAD DIST. NO.	ILLINOIS	FED. AID PROJECT		



WINIFRED M. MILLER, ET. AL.
5527039

A.R. STA. 2189+85.00
PIPE CULVERT, TYPE 1, REINF. CONC., EQRS, 24"x41'-0"
W/PRECAST REINF. CONC. FLARED END
SECTIONS, EQRS 24" - 2.0 EACH (SEE STD. 542306)
20.5' LT., STA. 2189+85.00, D.S.F.L. = 673.09
20.5' RT., STA. 2189+85.00, U.S.F.L. = 673.21

A.R. STA. 2190+00.00
PIPE CULVERT, TYPE 1, REINF. CONC., EQRS, 24"x41'-0"
W/PRECAST REINF. CONC. FLARED END
SECTIONS, EQRS 24" - 2.0 EACH (SEE STD. 542306)
20.5' LT., STA. 2190+00.00, D.S.F.L. = 673.10
20.5' RT., STA. 2190+00.00, U.S.F.L. = 673.22

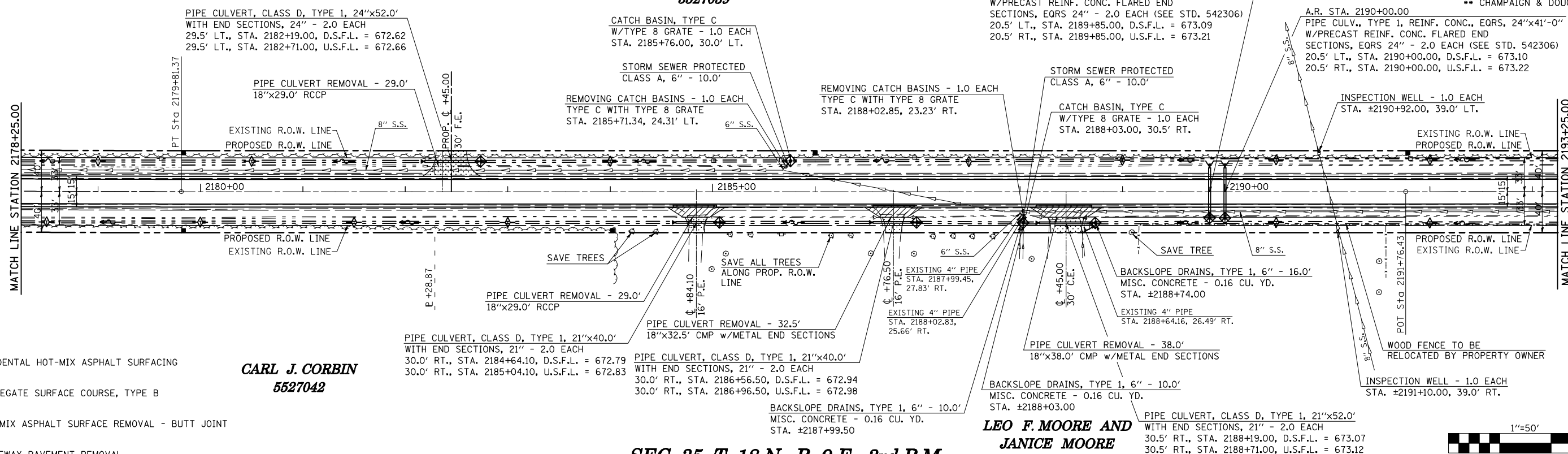

CARL J. CORBIN
5527042

LEO F. MOORE AND
JANICE MOORE
5527043

SEC. 35, T. 18 N., R. 9 E., 3rd P.M.

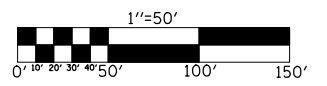

- INCIDENTAL HOT-MIX ASPHALT SURFACING
- AGGREGATE SURFACE COURSE, TYPE B
- HOT-MIX ASPHALT SURFACE REMOVAL - BUTT JOINT
- DRIVEWAY PAVEMENT REMOVAL

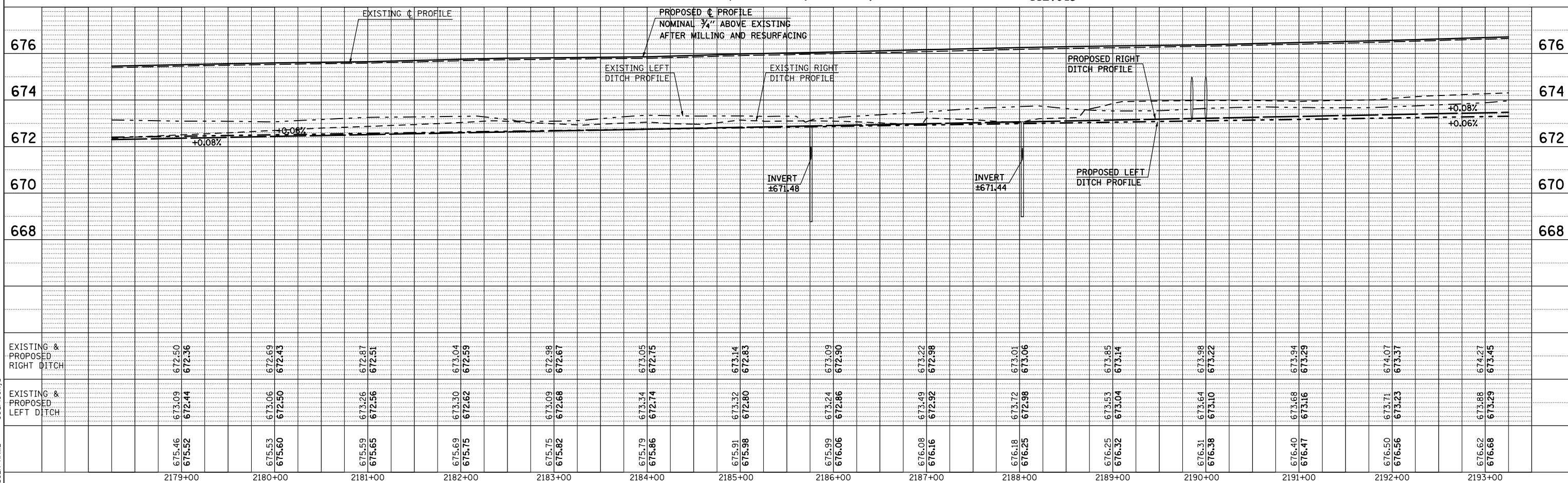

PLAN	SURVEYED	DATE
	PLOTTED	BY
	CHECKED	
	NO. OF WAY CHECKED	
	DATE FILE NAME	

PROFILE	SURVEYED	DATE
	PLOTTED	BY
	CHECKED	
	NO. OF STRUCTURE NOTATIONS CHKD	
	DATE	

PLOT DATE = 8/13/2009
FILE NAME = c:\pwworkspace\pwworkspace\1058824\1058824.dwg
PLOT SCALE = 1/8" = 1' / IN.
USER NAME = georlockj