

F.A.P. RTE.	SECTION	COUNTY	TOTAL SHEETS	SHEET NO.
808	*	**	715	165
STA.		TO STA.		
FED. ROAD DIST. NO.	ILLINOIS	FED. AID PROJECT		

- (205,57,105)RS-2
- \*\* CHAMPAIGN & DOUGLAS

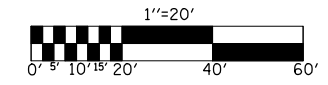

**MARYANN M. MAYHALL**  
5527019

**JEFFREY W. WATSON AND  
HELEN V. WATSON**  
5527020

**JANE ELIZABETH KEELER, ET AL.**  
5527018

**LEO FRANKLIN MOORE AND  
JANICE ROSE MOORE**  
5527021

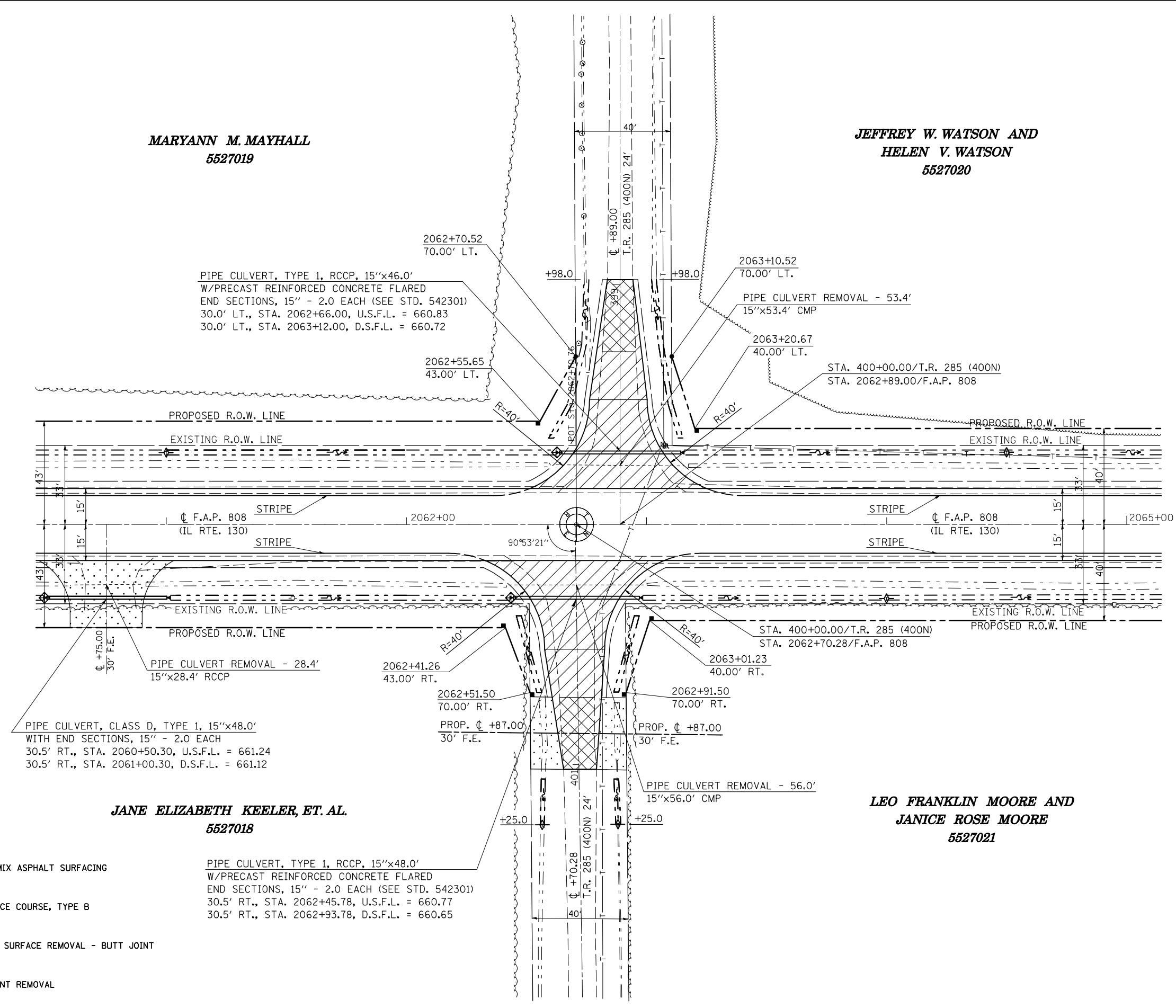

PIPE CULVERT, TYPE 1, RCCP, 15"x46.0'  
W/PRECAST REINFORCED CONCRETE FLARED  
END SECTIONS, 15" - 2.0 EACH (SEE STD. 542301)  
30.0' LT., STA. 2062+66.00, U.S.F.L. = 660.83  
30.0' LT., STA. 2063+12.00, D.S.F.L. = 660.72

PIPE CULVERT REMOVAL - 53.4'  
15"x53.4' CMP

PIPE CULVERT REMOVAL - 28.4'  
15"x28.4' RCCP

PIPE CULVERT, CLASS D, TYPE 1, 15"x48.0'  
WITH END SECTIONS, 15" - 2.0 EACH  
30.5' RT., STA. 2060+50.30, U.S.F.L. = 661.24  
30.5' RT., STA. 2061+00.30, D.S.F.L. = 661.12

PIPE CULVERT, TYPE 1, RCCP, 15"x48.0'  
W/PRECAST REINFORCED CONCRETE FLARED  
END SECTIONS, 15" - 2.0 EACH (SEE STD. 542301)  
30.5' RT., STA. 2062+45.78, U.S.F.L. = 660.77  
30.5' RT., STA. 2062+93.78, D.S.F.L. = 660.65

PIPE CULVERT REMOVAL - 56.0'  
15"x56.0' CMP

INCIDENTAL HOT-MIX ASPHALT SURFACING

AGGREGATE SURFACE COURSE, TYPE B

HOT-MIX ASPHALT SURFACE REMOVAL - BUTT JOINT

DRIVEWAY PAVEMENT REMOVAL

ILLINOIS DEPARTMENT OF TRANSPORTATION  
**INTERSECTION PLAN SHEET**  
**T.R. 285/400N & F.A.P. 808 (IL. RTE. 130)**  
F.A.P. 808 (IL. RTE. 130)  
SECTION (205,57,105)RS-2  
CHAMPAIGN & DOUGLAS COUNTIES  
SCALE: 1" = 20'  
DATE: 07/10/09  
DRAWN BY: B.B.P.  
CHECKED BY: G.A.E.

PLOT DATE = 8/12/2009  
FILE NAME = G:\DWG\WORK\K\PROJECTS\70623\sh1-intersec.dgn  
USER NAME = ceatrock/j