

F.A.P. RTE.	SECTION	COUNTY	TOTAL SHEETS	SHEET NO.
808		**	715	174
STA. 715		TO STA. 715		
FED. ROAD DIST. NO.		ILLINOIS FED. AID PROJECT		

(205,57,105)RS-2  
\*\* CHAMPAIGN & DOUGLAS

(A) A.R. STA. 2116+20.00, CULVERT #7  
PRECAST CONCRETE BOX CULVERT (M273)  
12'-0" x 2'-0" x 39.0'  
W/BOX CULVERT END SECTIONS - 2.0 EACH  
19.5' LT., STA. 2116+20.00, D.S.F.L. = 662.80  
19.5' RT., STA. 2116+20.00, U.S.F.L. = 663.00

(B) CONTROLLED LOW STRENGTH MATERIAL (CLSM) - 2.5 CU. YD.  
STA. 2115+83.00, 26.0' RT. TO 25.0' LT.  
(FILL 1 - 15" ACROSS ROAD PIPE CULVERT)

(C) REMOVING CATCH BASINS - 1.0 EACH  
TYPE C W/TYPE 8 GRATE  
STA. 2116+83.83, 24.34' LT.

(D) CATCH BASIN, TYPE C  
W/TYPE 8 GRATE - 1.0 EACH  
STA. 2116+88.00, 33.0' LT.

(E) STORM SEWER PROTECTED  
CLASS A, 6" - 12.0'

(F) STORM SEWER PROTECTED  
CLASS A, 8" - 42.0'

(G) INSPECTION WELL - 1.0 EACH  
STA. ±2116+12.00, 56.0' LT.

(H) PLUG EXISTING STORM SEWER - 1.0 EACH  
STA. ±2116+06.00, 21.0' LT.

(I) STORM SEWER PROTECTED  
CLASS A, 8" - 42.0'

(J) STORM SEWER REMOVAL, 8" - 30.0'

**JOHN P. HINTZ**  
5527027

**NORMA J. ELKINS**  
5527028

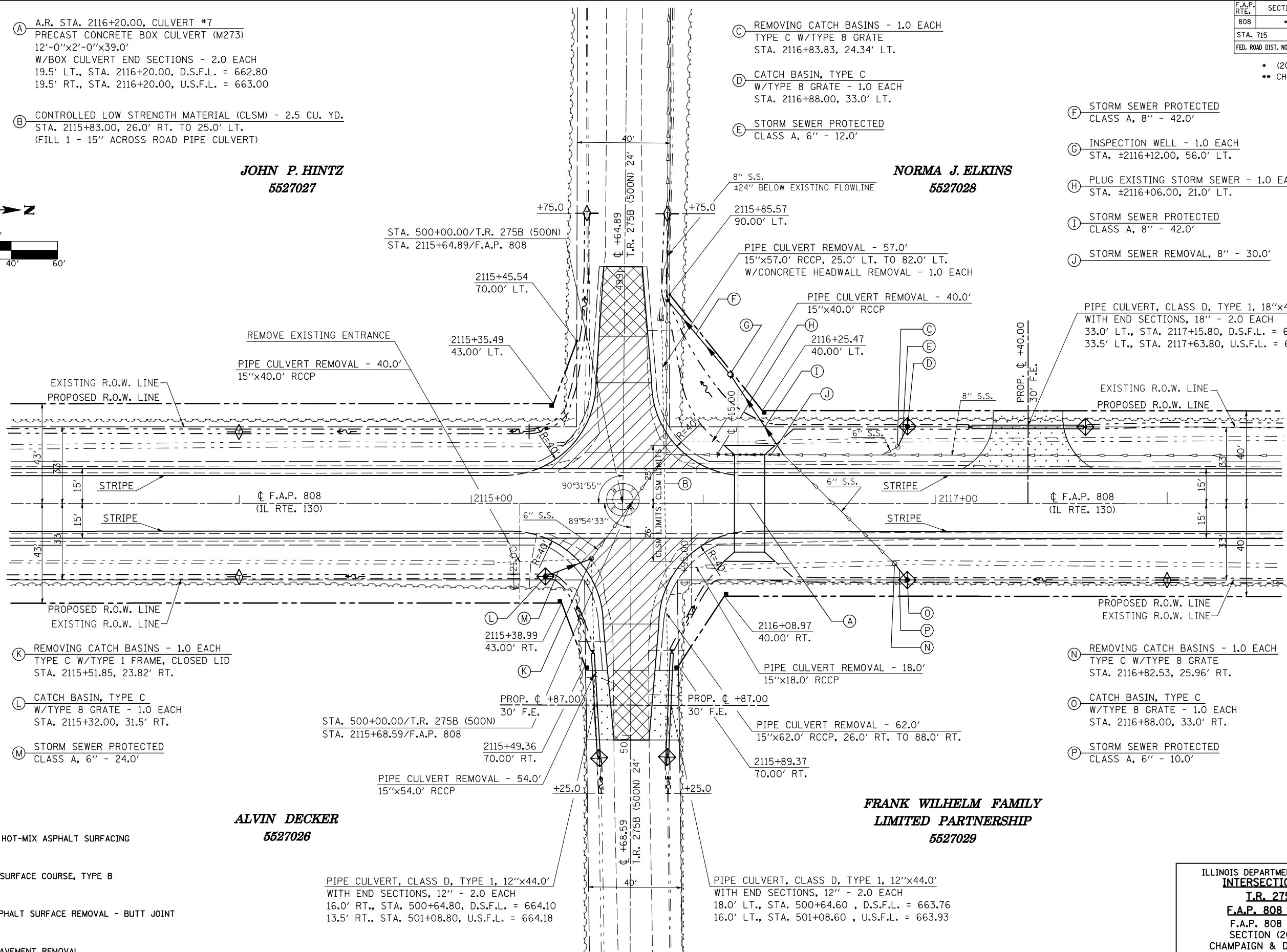
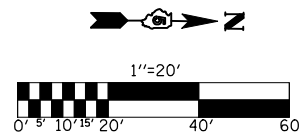

(K) REMOVING CATCH BASINS - 1.0 EACH  
TYPE C W/TYPE 1 FRAME, CLOSED LID  
STA. 2115+51.85, 23.82' RT.

(L) CATCH BASIN, TYPE C  
W/TYPE 8 GRATE - 1.0 EACH  
STA. 2115+32.00, 31.5' RT.

(M) STORM SEWER PROTECTED  
CLASS A, 6" - 24.0'

(L) 2115+38.99  
43.00' RT.

(A) 2116+08.97  
40.00' RT.

(N) REMOVING CATCH BASINS - 1.0 EACH  
TYPE C W/TYPE 8 GRATE  
STA. 2116+82.53, 25.96' RT.

(O) CATCH BASIN, TYPE C  
W/TYPE 8 GRATE - 1.0 EACH  
STA. 2116+88.00, 33.0' RT.

(P) STORM SEWER PROTECTED  
CLASS A, 6" - 10.0'

**ALVIN DECKER**  
5527026

**FRANK WILHELM FAMILY**  
**LIMITED PARTNERSHIP**  
5527029

INCIDENTAL HOT-MIX ASPHALT SURFACING

AGGREGATE SURFACE COURSE, TYPE B

HOT-MIX ASPHALT SURFACE REMOVAL - BUTT JOINT

DRIVEWAY PAVEMENT REMOVAL

PIPE CULVERT, CLASS D, TYPE 1, 12"x44.0'  
WITH END SECTIONS, 12" - 2.0 EACH  
16.0' RT., STA. 500+64.80, D.S.F.L. = 664.10  
13.5' RT., STA. 501+08.80, U.S.F.L. = 664.18

PIPE CULVERT, CLASS D, TYPE 1, 12"x44.0'  
WITH END SECTIONS, 12" - 2.0 EACH  
18.0' LT., STA. 500+64.60, D.S.F.L. = 663.76  
16.0' LT., STA. 501+08.60, U.S.F.L. = 663.93

PLOT DATE = 8/12/2009  
 FILE NAME = c:\pwworkspace\pwworkspace\10623-sht-int-sec.dgn  
 USER NAME = ceartocskj

ILLINOIS DEPARTMENT OF TRANSPORTATION  
**INTERSECTION PLAN SHEET**  
**T.R. 275B/500N &**  
**F.A.P. 808 (IL RTE. 130)**  
SECTION (205,57,105)RS-2  
CHAMPAIGN & DOUGLAS COUNTIES  
SCALE: 1" = 20'  
DATE: 07/20/09  
DRAWN BY: B.B.P.  
CHECKED BY: G.A.E.