

F.A.I. RTE.	SECTION	COUNTY	TOTAL SHEETS	SHEET NO.
55	*	MCLEAN	310	64
FED. ROAD DIST. NO. ILLINOIS		FED. AID PROJECT		
* (57-4)R, HBY, HBR, (57-4)BIDM		CONTRACT #70757		

I-55 SIGNS

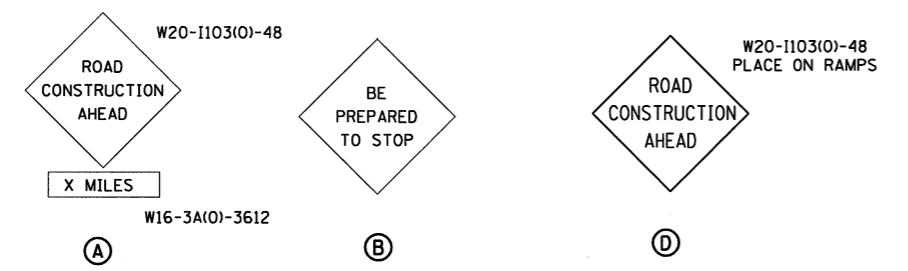

X : APPROPRIATE LENGTH TO BE DETERMINED BY THE ENGINEER

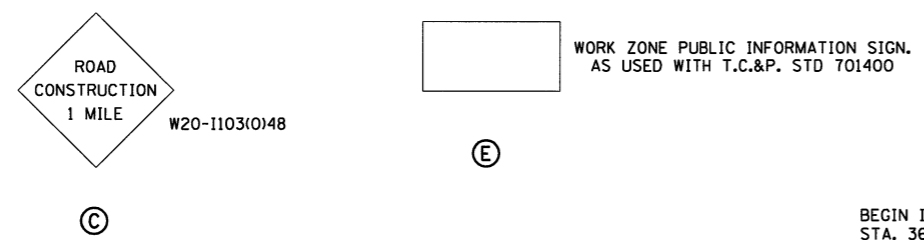

- MESSAGE #1
- MESSAGE #2
- MESSAGE #3

W20-100-48
CHANGEABLE
MESSAGE SIGN
#1, #2 & #3
MESSAGES
I-55 NORTHBOUND

F

THERE ARE 3 PERMANENT CHANGEABLE MESSAGE SIGNS LOCATED NEAR THIS PROJECT. THE LOCATIONS ARE:
ON I-74 WEST OF THE PROJECT LIMITS
ON I-39 NORTH OF THE PROJECT LIMITS
AND ON I-55 EAST OF THE PROJECT LIMITS
THE CONTRACTOR SHALL CONTACT DAVE BURKYBILE AT THE DISTRICT 5 OFFICE FOR PROGRAMMING THE MESSAGES AT THESE SIGNS THAT ARE REQUIRED 2 WEEKS PRIOR TO THE START OF THE PROJECT AND THROUGH COMPLETION OF THE PROJECT.

ONE CHANGEABLE MESSAGE SIGN TO BE FURNISHED, PLACED AND MAINTAINED BY THE CONTRACTOR SHALL BE PLACED ALONG I-74 NORTH OF MARKET STREET. THE CHANGEABLE MESSAGE SIGN IS REQUIRED TWO WEEKS PRIOR TO STARTING CONSTRUCTION AND SHALL REMAIN UNTIL CONSTRUCTION IS COMPLETE. SEE NOTE 1.

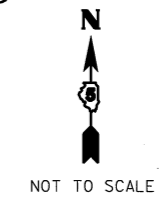
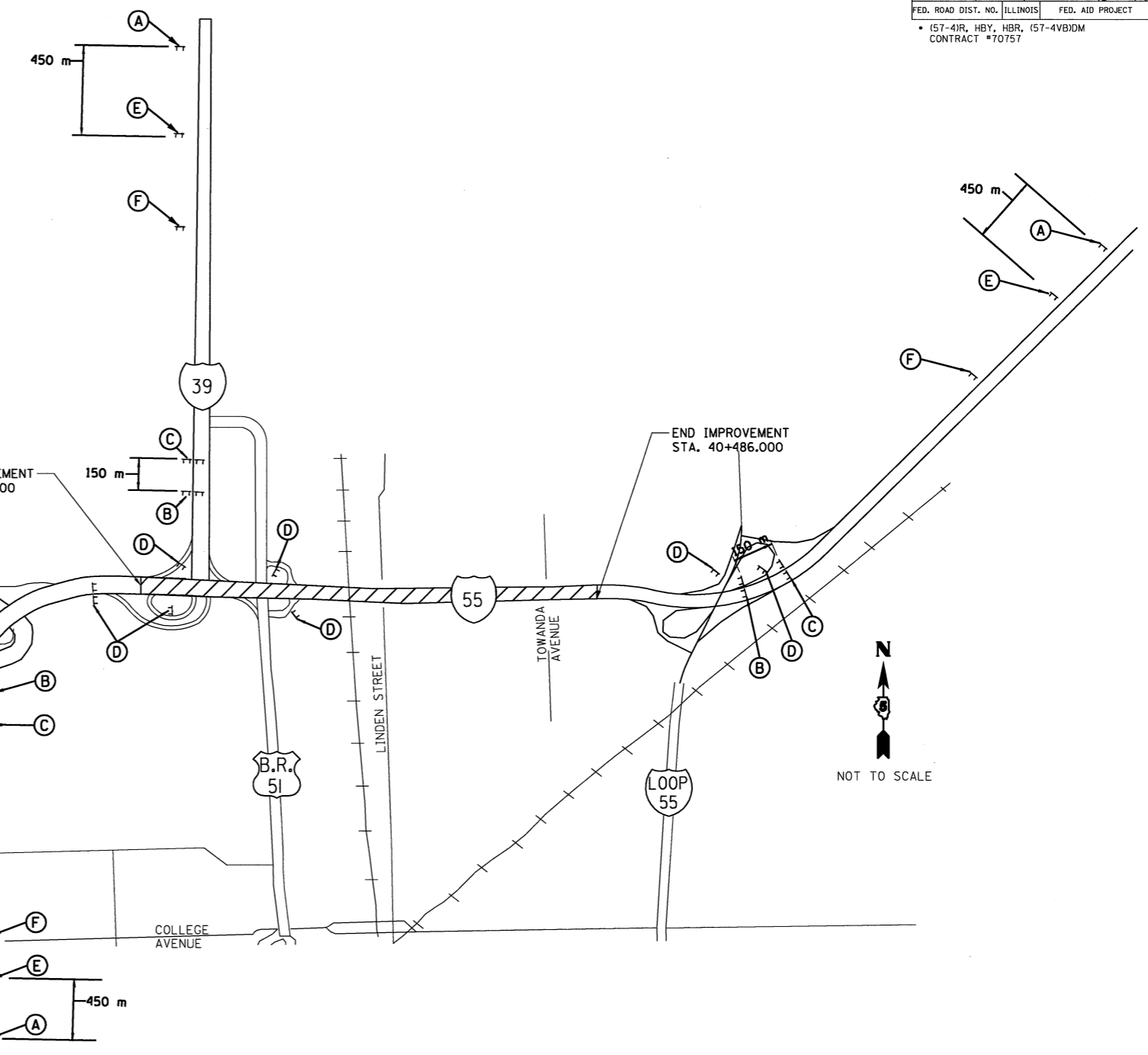
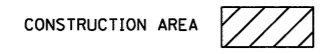

NOTE: 1. THE CONTRACTOR MAY NEED TO CONSTRUCT A PAD FOR MESSAGE SIGN OF AGGREGATE SURFACE COURSE TYPE B AS DIRECTED BY THE ENGINEER. THE PAD DIMENSIONS ARE 100 mm x 2.5 m x 1.5 m. INSTALLATION AND REMOVAL INCLUDED IN THE COST OF CHANGABLE MESSAGE SIGN.

ILLINOIS DEPARTMENT OF TRANSPORTATION
F.A.I. 55
SECTION (57-4)R, HBY, HBR, (57-4)BIDM
MCLEAN COUNTY
**MAINTENANCE OF TRAFFIC
ADVANCED SIGNING**

REVISIONS	
NAME	DATE

JOB NO. 94S2063
DATE 8/11/2009

LAYOUT	JJH	03/02/04
DRAWN	JJH	03/02/04
REVIEWED	DJH	03/02/04