

ENTRANCE RAMP - 1ST APPLICATION

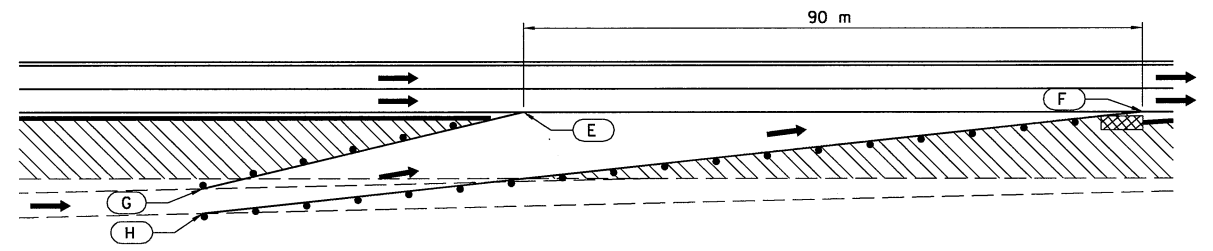

ENTRANCE RAMP - 2ND APPLICATION

ENTRANCE RAMP															
1ST APPLICATION								2ND APPLICATION							
A	B	C	D	E	F	G	H	E	F	G	H	E	F	G	H
STATION	OFFSET	STATION	OFFSET	STATION	OFFSET	STATION	OFFSET	STATION	OFFSET	STATION	OFFSET	STATION	OFFSET	STATION	OFFSET
36+612.530	7.873 RT	36+702.530	7.873 RT	36+570.630	18.356 RT	36+570.710	23.125 RT	36+762.375	7.873 RT	36+852.378	7.873 RT	36+725.883	17.004 RT	36+725.883	20.689 RT
37+134.654	7.873 LT	37+044.652	7.873 LT	37+198.269	23.774 LT	37+198.269	28.655 LT	36+966.083	7.873 LT	36+876.084	7.873 LT	37+015.004	20.100 LT	37+014.905	25.037 LT
38+073.618	7.873 RT	38+163.618	7.873 RT	38+032.262	18.232 RT	38+032.161	23.156 RT	38+213.565	7.873 RT	38+303.567	7.873 RT	38+178.617	16.604 RT	38+178.617	20.205 RT

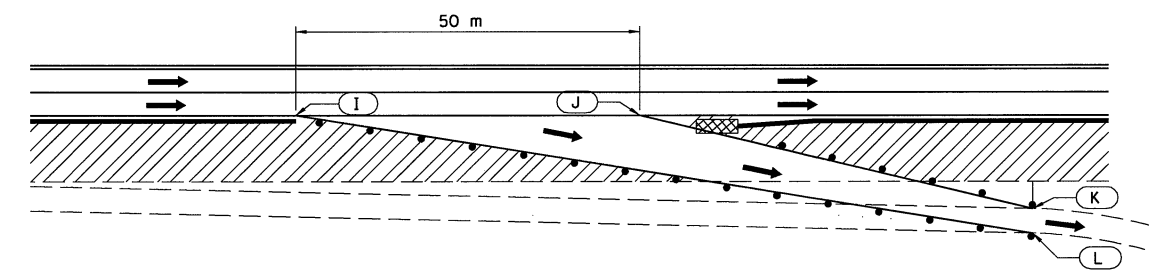

EXIT RAMP - 3RD APPLICATION

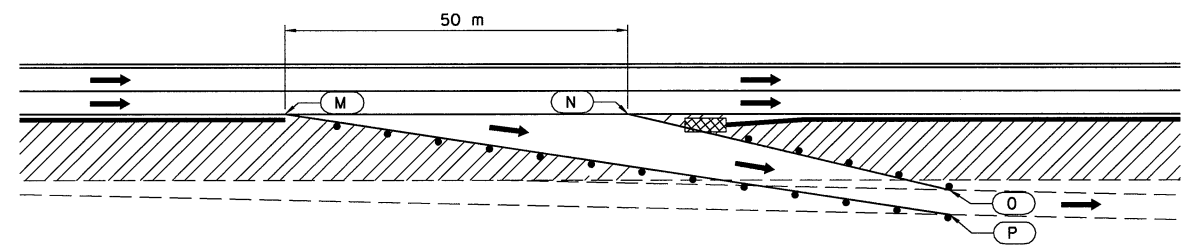

EXIT RAMP - 4TH APPLICATION

EXIT RAMP															
3RD APPLICATION								4TH APPLICATION							
I	J	K	L	M	N	O	P	M	N	O	P	M	N	O	P
STATION	OFFSET	STATION	OFFSET	STATION	OFFSET	STATION	OFFSET	STATION	OFFSET	STATION	OFFSET	STATION	OFFSET	STATION	OFFSET
37+055.208	7.873 RT	37+105.208	7.873 RT	37+158.188	21.093 RT	37+157.850	25.937 RT	36+952.933	7.873 RT	37+002.921	7.873 RT	37+039.563	17.016 RT	37+039.565	20.913 RT
37+484.738	7.873 RT	37+534.738	7.873 RT	37+593.840	22.635 RT	37+593.513	27.475 RT	37+382.595	7.873 RT	37+432.595	7.873 RT	37+469.437	17.075 RT	37+469.430	20.869 RT
38+236.702	8.045 LT	38+186.819	8.045 LT	38+107.394	25.026 LT	38+107.394	29.921 LT	38+336.702	8.045 LT	38+286.702	8.045 LT	38+236.702	20.703 LT	38+236.702	25.611 LT

NOTE:
 1ST & 3RD APPLICATION(S) SHOWN ON MAINTENANCE OF TRAFFIC PLAN SHEETS FOR THE LOCATIONS LISTED ABOVE.
 SEE STD. 701411 FOR PLACEMENT OF TRAFFIC CONTROL DEVICES
 SHIFTING DRUMS FROM APPLICATION 1 TO 2 AND 3 TO 4 DOES NOT GET PAID AS AN ADDITIONAL "EACH". THE "EACH" IS FOR AN EXIT/ENT. RAMP REGARDLESS OF NO. OF SHEETS.

ILLINOIS DEPARTMENT OF TRANSPORTATION
 F.A.I. 55
 SECTION (57-4)R, HBY, HBR, (57-4)BIDM
 MCLEAN COUNTY

MAINTENANCE OF TRAFFIC ENTRANCE & EXIT RAMP STAGING

JOB NO. 94S2063
 DATE 8/11/2009

REVISIONS	
NAME	DATE

8/11/2009
 #P/LES
 LAYOUT
 DRAWN
 REVIEWED
 03/03/04
 03/03/04
 03/18/04