

• LOCATION NUMBER REFERS TO LIGHTING CONTROLLER NUMBER

THE CONTRACTOR SHALL FURNISH AND INSTALL A LIGHT POLE IDENTIFICATION ON EACH NEW LIGHT POLE, AS SHOWN ABOVE, INCIDENTAL TO THE RESPECTIVE LIGHT POLE PAY ITEM. THE NUMERALS SHALL BE 75mm (3 IN.) SERIES "D", BLACK, SCREENED ON SILVER-WHITE TYPE B PRESSURE SENSITIVE REFLECTIVE SHEETING CONFORMING TO THE REQUIREMENTS OF SECTION T602.01 OF THE STANDARD SPECIFICATIONS FOR TRAFFIC CONTROL ITEMS. THE NUMERALS SHALL CONFORM TO THE FHWA "STANDARD ALPHABETS FOR HIGHWAY SIGNS".

THE LIGHT POLE IDENTIFICATION SHALL BE APPLIED TO SIGN BASE MATERIAL AS SPECIFIED IN SECTION 1069.06 OF THE STANDARD SPECIFICATIONS, APPROXIMATELY 2.1M (7') ABOVE THE ADJACENT PAVEMENT GRADE VISIBLE TO APPROACHING TRAFFIC IN ACCORDANCE WITH HIGHWAY STANDARD T20001.

**LIGHT POLE IDENTIFICATION**

PLACE SIGNS AT 30° TO ONCOMING TRAFFIC IN BOTH DIRECTIONS

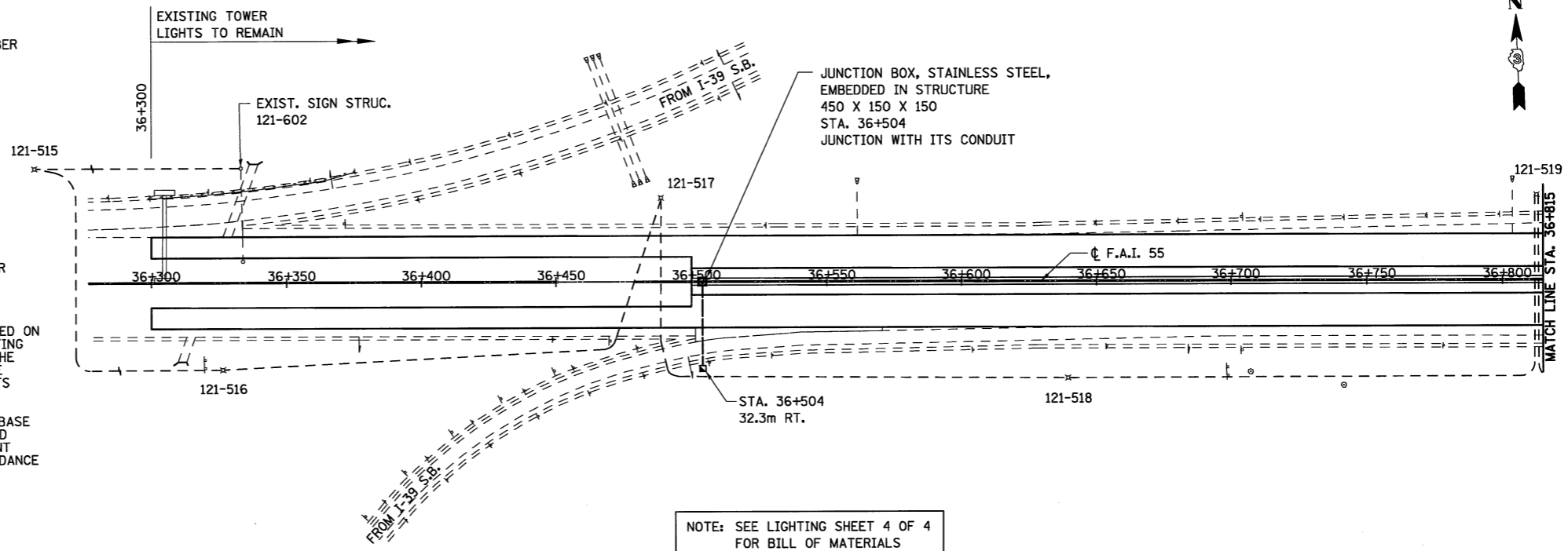

NOTE: SEE LIGHTING SHEET 4 OF 4 FOR BILL OF MATERIALS

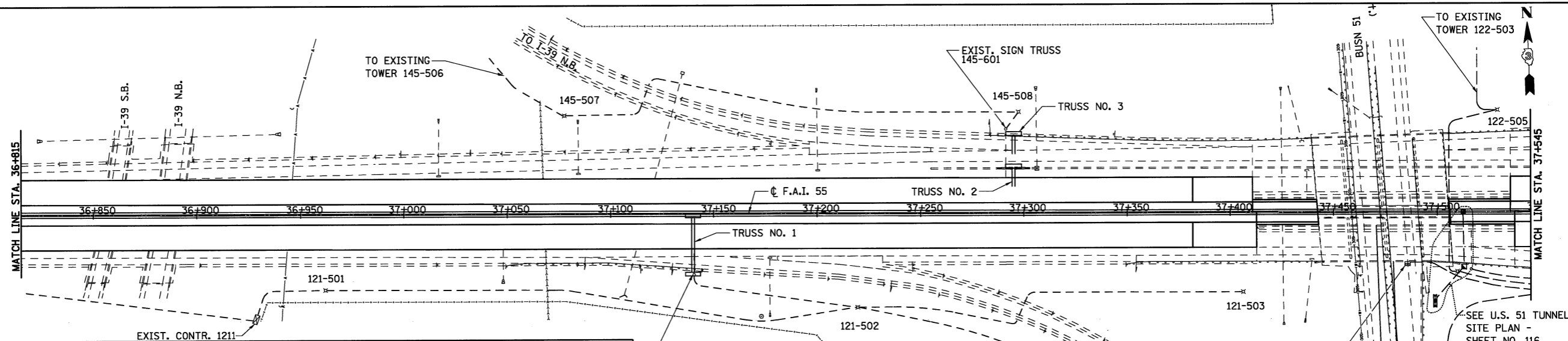

- 1 CONDUIT PUSHED, 50 mm, GALVANIZED STEEL
- 2 2 \*6XLP, 1 \*6XLP-G
- 3 UNIT DUCT, 2 \*6XLP, 1 \*6XLP-G, 25 P
- 4 CONDUIT ATTACHED TO STRUCTURE, 50 mm DIA, GALVANIZED STEEL
- 5 CONDUIT EMBEDDED IN STRUCTURE, 50 mm PVC
- 6 CONDUIT ATTACHED TO STRUCTURE 20 mm DIA., GALVANIZED STEEL
- 7 2 \*10XLP, 1 \*10XLP-G

- LEGEND**
- UNDERPASS LUMINAIRE, 150W HPS
  - JUNCTION BOX, EXISTING
  - JUNCTION BOX, PROPOSED, SIZE AS NOTED
  - LIGHTING CONTROLLER, PROPOSED
  - PROP. LIGHT POLE, TWIN DAVIT/LUMINAIRES
  - PROP. LIGHT POLE, TWIN DAVIT/LUMINAIRES INSTALLED ON EXISTING FOUNDATION
  - PROPOSED CONDUIT OR UNIT DUCT
  - EXISTING LIGHTPOLE AND FOUNDATION TO BE REMOVED
  - EXISTING LIGHTING UNIT

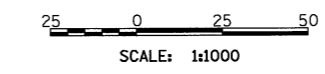

REVISIONS	
NAME	DATE

ILLINOIS DEPARTMENT OF TRANSPORTATION  
F.A.I. 55  
SECTION (57-4R, HBY, HBR, (57-4VB)DM  
MCLEAN COUNTY

**LIGHTING PLAN**  
I-55

JOB NO. 94S2063  
DATE 10/6/2009