

**TYPICAL FRONT ELEVATION**  
With lights and handrail omitted for clarity.

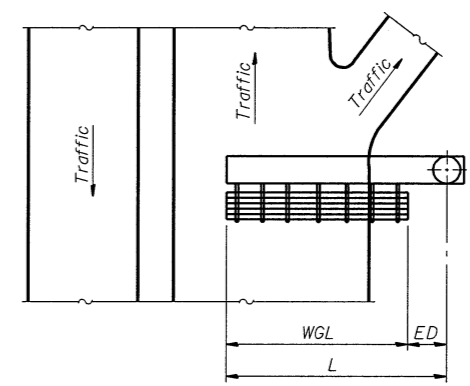

**PLAN**  
**WALKWAY AND HANDRAIL SKETCH**  
(Road plan beneath truss varies)

Walkway and truss grating dimensions are nominal and may vary (width ± 13 mm, depth ± 13 mm) based on available standard widths.

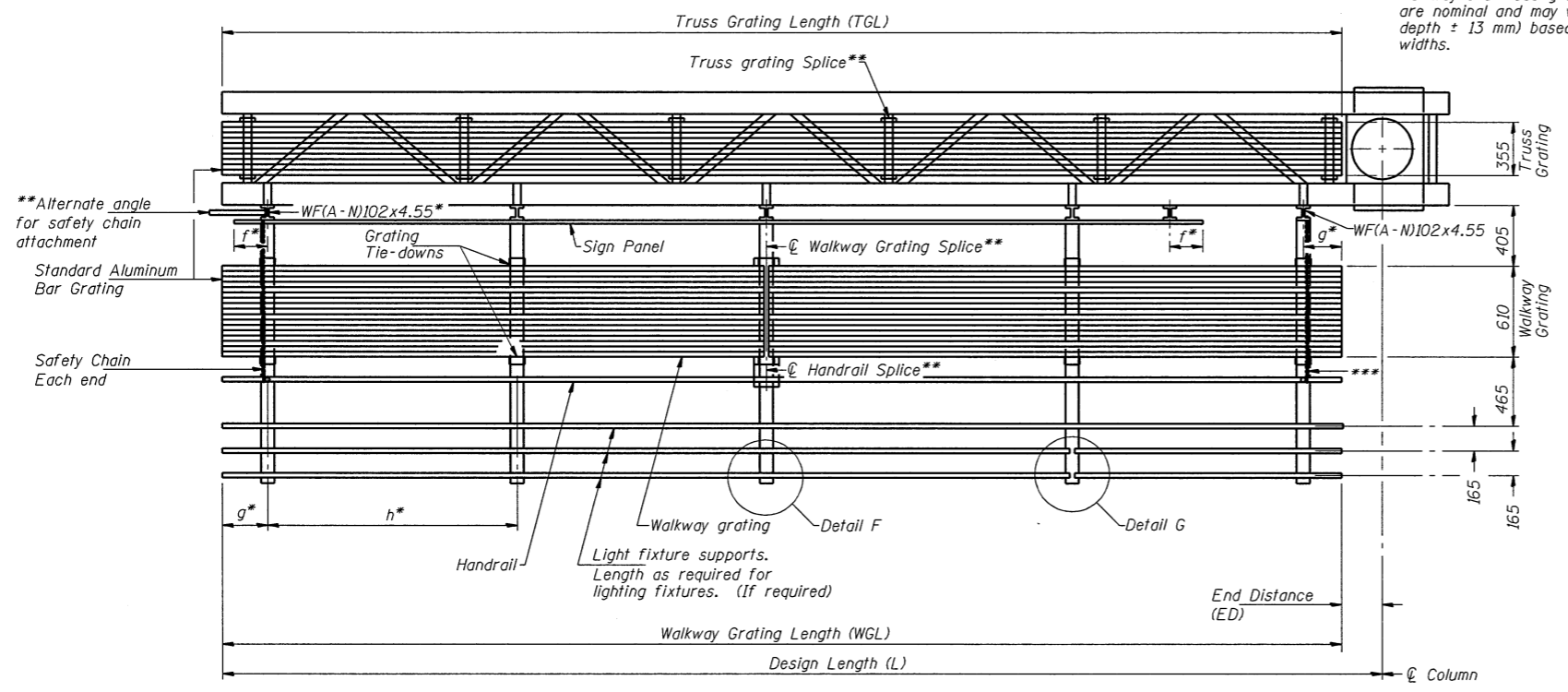

**SECTION A-A**

Truss grating to facilitate inspection shall run full length of cantilevers. Cost of truss grating is included in "Overhead Sign Structure Cantilever".

Handrail and walkway grating shall span a minimum of three brackets between splices.  
\*\*Use and location of handrail or grating splices are optional, based on lengths needed and material availability.

$$TGL = L - \left( \frac{\text{Post O.D.}}{2} + 150 \right)$$

NUMBER	REVISION	DATE

Structure Number	Station	WGL	ED	TGL
5C0571055L164.7	37+295	4,929	3,381	7,855
5C0571055L164.8	37+297	5,806	2,774	8,125
5C0571055L164.9	37+572.5	5,500	3,700	8,745

Notes: \*Space walkway brackets WF(A-N)102x4.55 and sign brackets WF(A-N)102x2.66 for efficiency and within limits shown:  
f = 300 maximum, 100 minimum (End of sign to  $\phi$  of nearest bracket)  
g = 300 maximum, 100 minimum (End of walkway to  $\phi$  of nearest bracket)  
h = 1.85 m maximum ( $\phi$  to  $\phi$  sign and/or walkway support brackets, WF(A-N)102x2.66 or WF(A-N)102x4.55)  
\*\*\*If walkway bracket at safety chain location is behind sign, add angle to bracket.  
For details of sign placement, sign/walkway brackets, truss and walkway gratings, grating splices and Section B-B, see Base Sheet OSC-A-7(M).  
For details of handrail, handrail splice, safety chain and Details F and G, see Base Sheet OSC-A-8(M).

**BRACKET TABLE**

WF(A-N)4xL79 or WF(A-N)4x3.06 ASTM B308, Alloy 6061-T6		
Sign Width		Number Brackets Required
Greater Than	Less Than or Equal To	
	2.45	2
2.45	4.3	3
4.3	6.15	4
6.15	8.0	5
8.0	9.85	6

SHEET TITLE <b>CANTILEVER SIGN STRUCTURES ALUMINUM WALKWAY DETAILS ALUMINUM TRUSS &amp; STEEL POST</b>		PROJECT NO. 9450
PROJECT F.A.I. 55 SECTION (57-4)R, HBY, HBR, (57-4VB)DM McLEAN COUNTY		SCALE DATE 10/08/04 DRAWN BY TFG CHECKED BY MCB DRAWING NO.
<b>COOMBE-BLOXDORF P.C.</b> Engineers/Land Surveyors Springfield, Illinois Design Firm License No.184-002703		19 OF 24 SHTS

7/8/2009 #112/ABBREV#