

F.A.I. RTE.	SECTION	COUNTY	TOTAL SHEETS	SHEET NO.
55		MCLEAN	310	161
FED. ROAD DIST. NO. ILLINOIS		FED. AID PROJECT		
* (57-4)R, HBY, HBR, (57-4)BIDM CONTRACT #70757				

STRUCTURE	L (m)
WEST END OF TOWANDA	30
I-39	24
EAST END OF TOWANDA	30.0

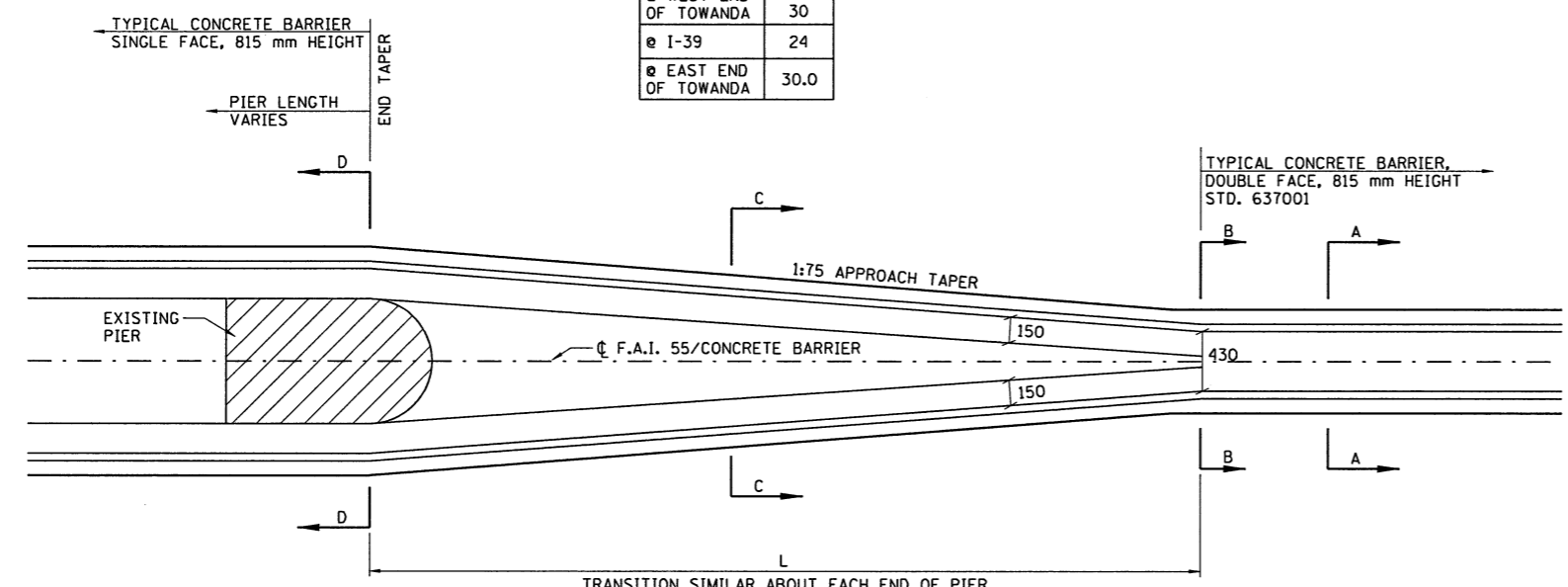

TRANSITION SIMILAR ABOUT EACH END OF PIER
(COST INCLUDED IN CONCRETE BARRIER SINGLE FACE, 815 mm HEIGHT)

MEDIAN BARRIER TRANSITION PLAN

NOTE: MODIFY TRANSITION IN ACCORDANCE WITH STD. 637001 TO INCORPORATE THE LIGHT POLE FOUNDATION AT STA. 40+240, COST OF MODIFICATIONS SHALL BE INCLUDED IN THE COST OF CONCRETE BARRIER SINGLE FACE, 815 mm HEIGHT. THE BARRIER MODIFICATIONS SHALL BE APPROVED BY THE ENGINEER PRIOR TO CONSTRUCTION.

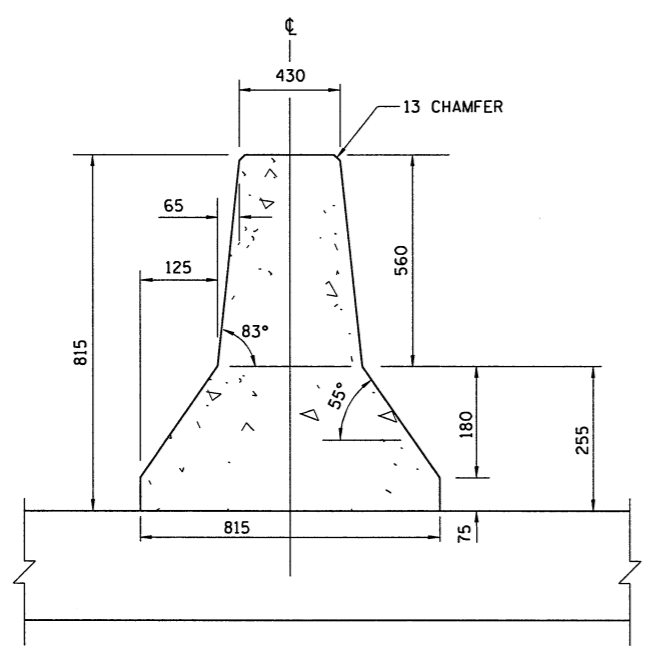

END SECTION
SECTION A-A
(TYPICAL CONCRETE BARRIER, DOUBLE FACE, 815 mm HEIGHT)
(I-39 AND WEST END TOWANDA AVE.)

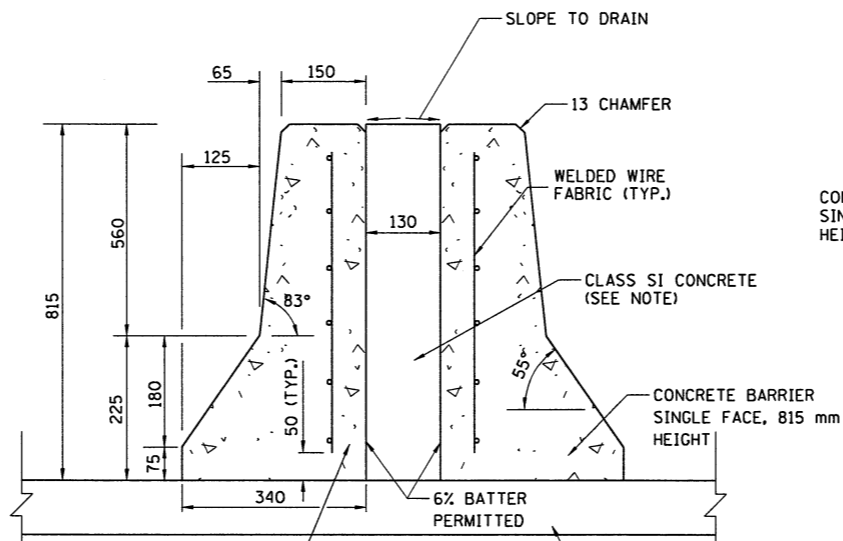

CONCRETE BARRIER SINGLE FACE
SECTION B-B

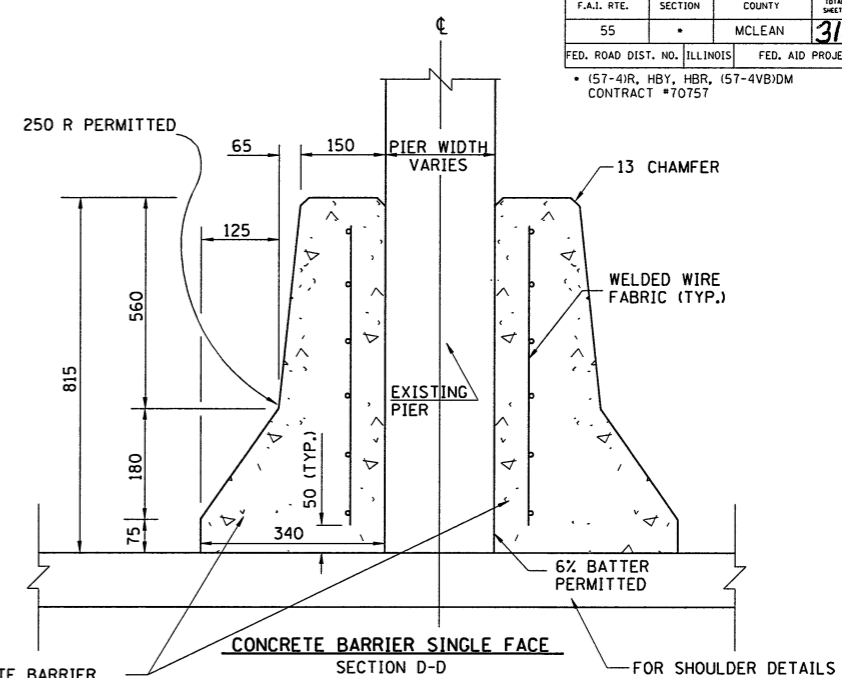

CONCRETE BARRIER SINGLE FACE
SECTION D-D

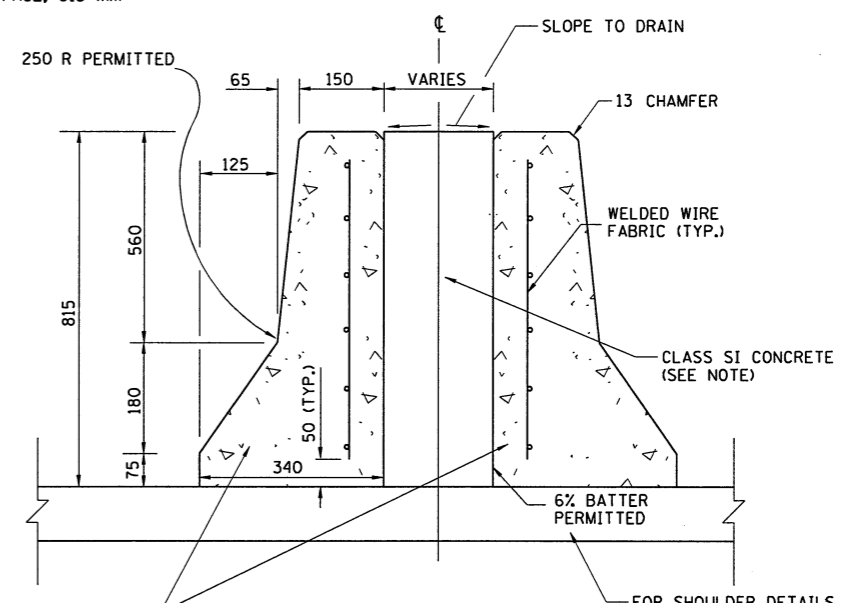

CONCRETE BARRIER SINGLE FACE
SECTION C-C

NOTE: COST OF CLASS SI CONCRETE WILL BE INCLUDED IN THE COST OF CONCRETE BARRIER SINGLE FACE, 815 mm HEIGHT.

WHERE CRASHWALL HEIGHT IS LESS THAN PROPOSED BARRIER FILL WITH CLASS SI CONCRETE AS SHOWN IN DETAIL C-C. COST INCLUDED IN CONCRETE BARRIER SINGLE FACE.

ALL DIMENSIONS ARE IN MILLIMETERS UNLESS OTHERWISE NOTED

ILLINOIS DEPARTMENT OF TRANSPORTATION
F.A.I. 55
SECTION (57-4)R, HBY, HBR, (57-4)BIDM
MCLEAN COUNTY

MEDIAN BARRIER TRANSITION AT PIERS DETAIL

REVISIONS	
NAME	DATE

HANSON

JOB NO. 9452063
DATE 6/25/2009

LAYOUT	JAR	04/09/02
DRAWN	JAR	03/05/04
REVIEWED	DLH	03/18/04

6/25/2009 #FILE*