

F.A.I. RTE.	SECTION	COUNTY	TOTAL SHEETS	SHEET NO.
55	•	McLEAN	310	183

FED. ROAD DIST. NO. 7 ILLINOIS FAP  
 \*(57-4)R, HBY, HBR, (57-4VB)DM  
 Contract No. 70757

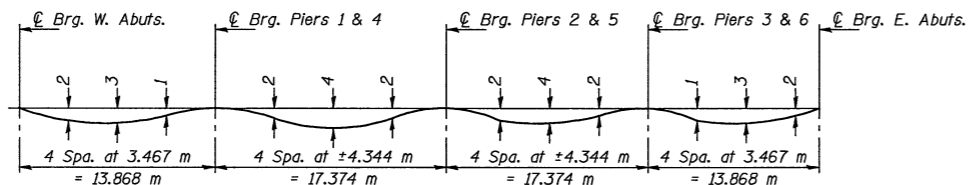

**DEAD LOAD DEFLECTION DIAGRAM**

(Includes weight of concrete only)

Notes: The above deflections are not to be used in the field if the engineer is working from the grade elevations adjusted for dead load deflections as shown on Sheet 8 of 24. All dimensions are in millimeters (mm) except as noted. All offsets are in meters.

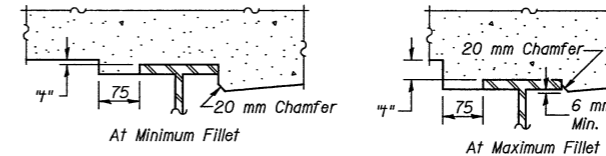

To determine "h": After all structural steel has been erected, elevations of the top flanges of the beams shall be taken at intervals shown below. These elevations subtracted from the "Theoretical Grade Elevations Adjusted for Dead Load Deflection" shown on Sheet 8 of 24, minus slab thickness, equals the fillet heights "h" above top flange of beams.

**FILLET HEIGHTS**

\*The Contractor shall verify in the field the elevations shown on Sheet 8 of 24 at the Stage Construction Joints. If the elevations vary the Contractor shall notify the Engineer before calculating the fillet heights at the beams.

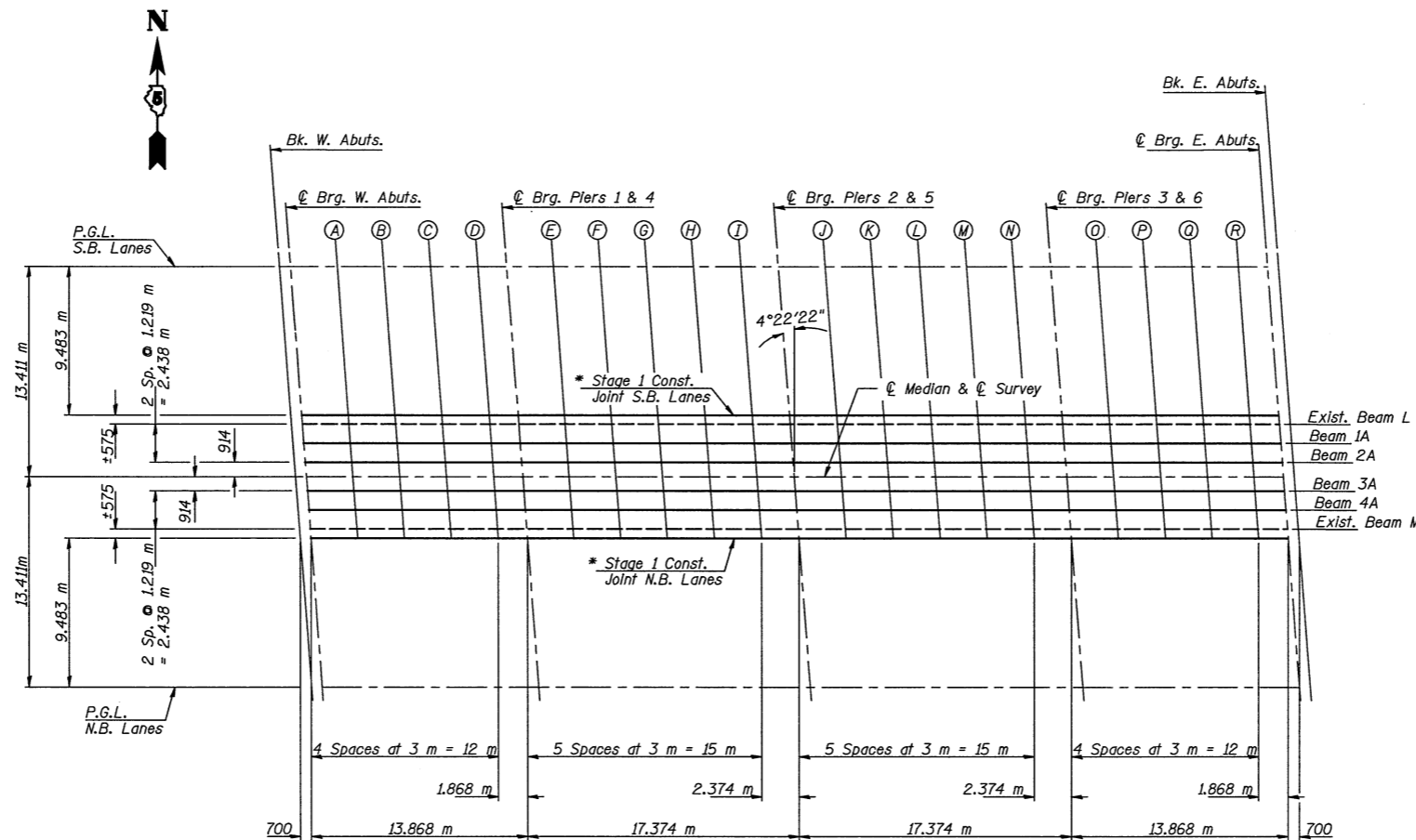

**PLAN**

ILLINOIS DEPARTMENT OF TRANSPORTATION			
SHEET TITLE TOP OF SLAB ELEVATIONS			
PROJECT F.A.I. 55 OVER BUSINESS U.S. 51 SECTION 57-4HBR-4 STATION 37+474.206 McLEAN COUNTY STRUCTURE NO. 057-0024 (N.B.) & STRUCTURE NO. 057-0025 (S.B.)	PROJECT NO. 08049-5	SCALE DATE 07/15/2009	DRAWN BY TFG/CFC
DESIGNED BY CME/MCB	CHECKED BY CME/MCB	DRAWING NO. 7	OF 24 SHTS
COOMBE-BLOXDORF P.C. Engineers / Land Surveyors Springfield, Illinois Design Firm License No. 184-002703			