

CONTRACT NO. 78757	ROUTE NO. I-55	SECTION (57-4HB-3)BR	COUNTY McLean	TOTAL SHEETS 310	SHEET NO. 213
	FED. ROAD DIST. NO. 7	ILLINOIS	PROJECT		

Sheet 13 of 31

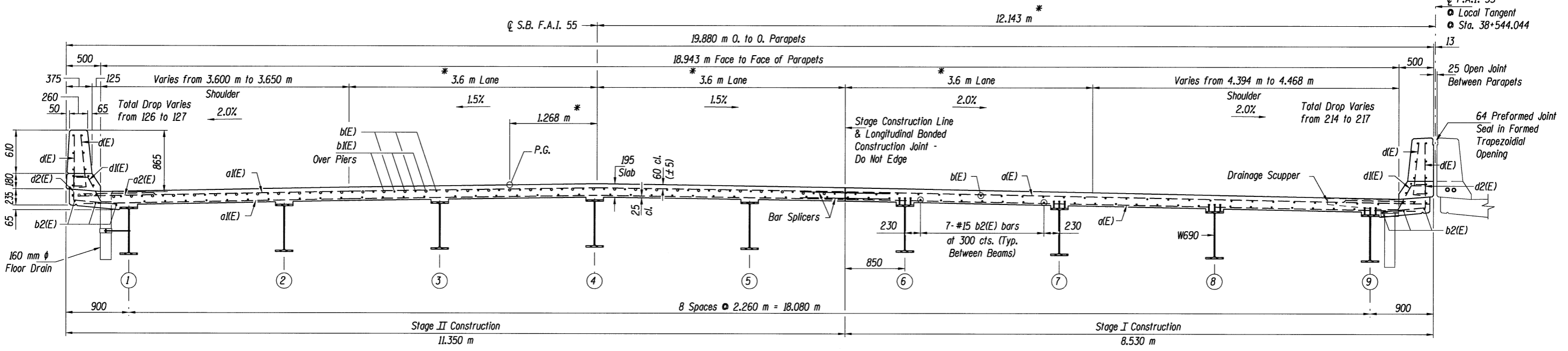

NEAR PIER

CROSS SECTION - SOUTHBOUND
(Looking Up-Station)

NEAR MIDSPAN



SECTION THRU MEDIAN PARAPET

50 mm ϕ Conduits shall only be placed in the curb portion of the parapet.

* Radial Dimensions

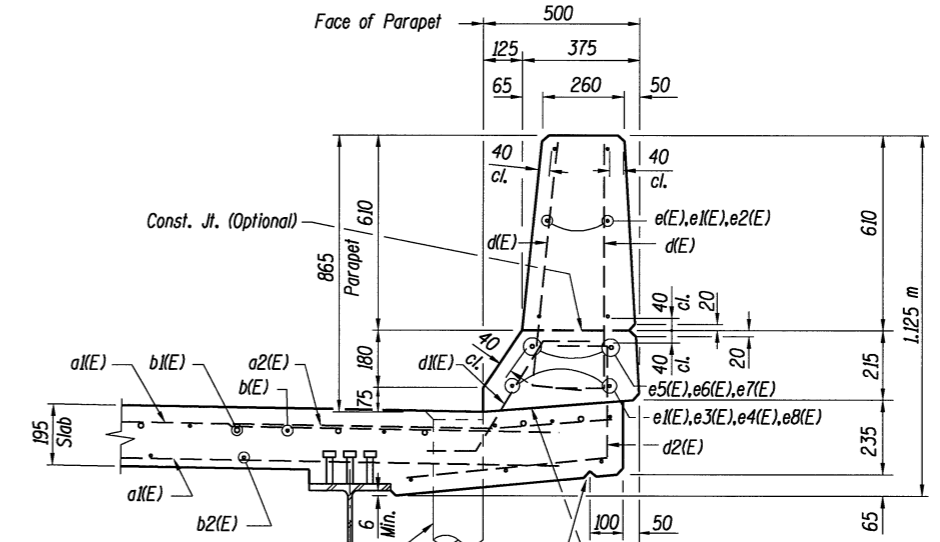

SECTION THRU FASCIA PARAPET

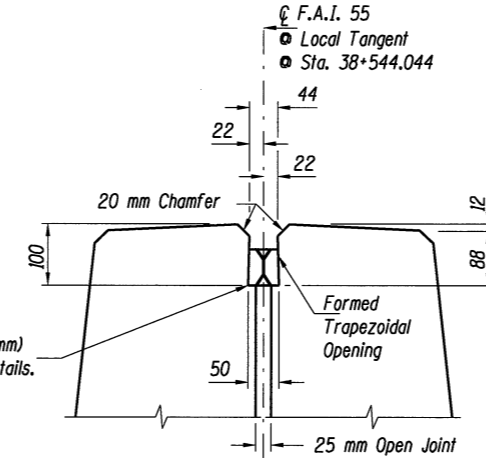

DETAIL A

SUPERSTRUCTURE DETAILS - SOUTHBOUND
F.A.I. 55 OVER LINDEN STREET
SECTION (57-4HB-3)BR
STRUCTURE NO. 057-0235 (N.B.) & 057-0236 (S.B.)
MCLEAN COUNTY
STATION 38+544.044

© Copyright Hanson Professional Services Inc. 2003

JOB NO. 94S2063
 DATE 03/26/04

STIME\$ 8/17/2009
 \$FILE\$

LAYOUT	G.L.C.	11/5/97
DRAWN	D.A.M.	11/5/97
REVIEWED		