

STATE OF ILLINOIS  
DEPARTMENT OF TRANSPORTATION

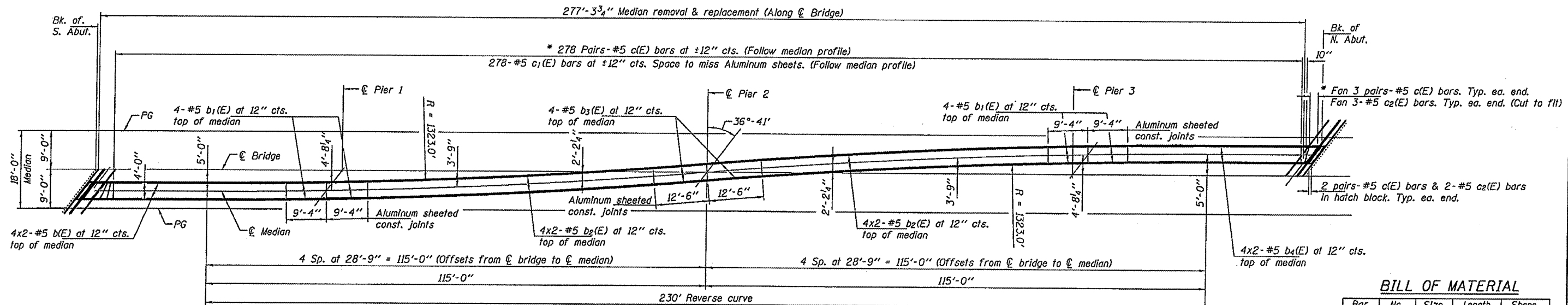
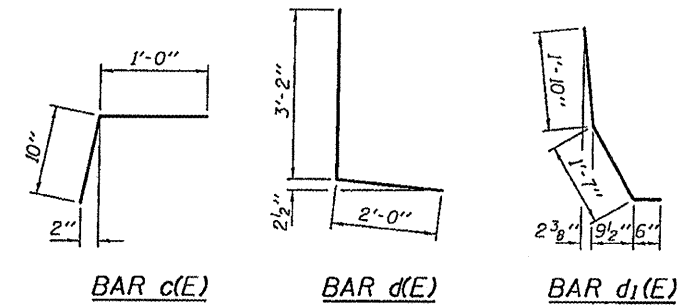

MEDIAN PLAN

\* Epoxy grout c(E) bars in 6" max. holes according to Article 584 of the Standard Specifications.  
Space between existing inserts.  
Space to miss Aluminum sheets.

BILL OF MATERIAL

Bar	No.	Size	Length	Shape
a(E)	32	#5	23'-3"	—
a <sub>1</sub> (E)	32	#5	33'-0"	—
b(E)	8	#5	26'-8"	—
b <sub>1</sub> (E)	16	#5	9'-0"	—
b <sub>2</sub> (E)	16	#5	32'-0"	—
b <sub>3</sub> (E)	8	#5	12'-2"	—
b <sub>4</sub> (E)	8	#5	24'-0"	—
c(E)	576	#5	1'-10"	┌
c <sub>1</sub> (E)	278	#5	3'-6"	—
c <sub>2</sub> (E)	10	#5	4'-4"	—
d(E)	14	#5	5'-2"	L
d <sub>1</sub> (E)	14	#5	3'-11"	┌
h(E)	16	#6	23'-3"	—
h <sub>1</sub> (E)	16	#6	33'-3"	—
Reinforcement Bars, Epoxy Coated		Pound	7430	
Concrete Superstructure		Cu. Yds.	51.8	
Concrete Removal		Cu. Yds.	51.8	

Bars indicated thus 4 x 2-#5 etc. indicates 4 lines of bars with 2 lengths per line.

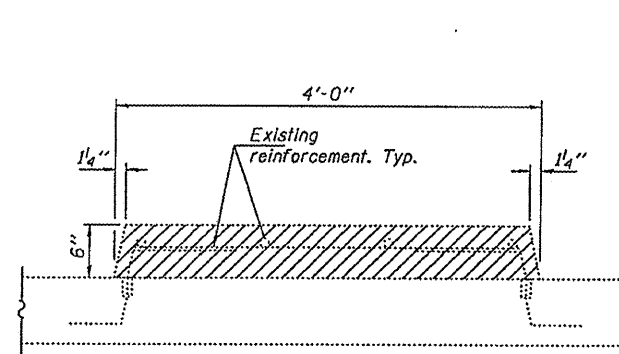

MEDIAN REMOVAL  
Hatched area indicates concrete removal

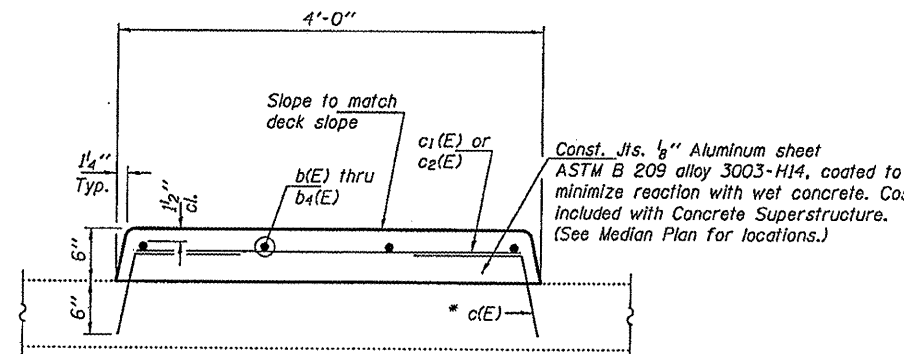

SECTION THRU MEDIAN

MINIMUM BAR LAPS  
#5 bar = 2'-2"

MEDIAN DETAILS  
US RTE 150 OVER I-74  
SN 057-0073

DESIGNED	GGE
CHECKED	AJB
DRAWN	baliva
CHECKED	GGE AJB

SEPTEMBER 16, 2009  
EXAMINED *Carl Perry*  
ENGINEER OF STRUCTURAL SERVICES  
PASSED *Ralph E. Anderson*  
ENGINEER OF BRIDGES AND STRUCTURES

SHEET NO. 4 7 SHEETS	F.A.S. RTE.	SECTION	COUNTY	TOTAL SHEETS	SHEET NO.
	2466	(57-18)BJR	Mc LEAN	17	14
FED. ROAD DIST. NO. ILLINOIS			FED. AID PROJECT		
CONTRACT NO. 70807					