

F.A.P. RTE.	SECTION	COUNTY	TOTAL SHEETS	SHEET NO.
510	120 (I-6)	HANCOCK	13	1

STATE CONTRACT NO. 72852

STATE OF ILLINOIS
DEPARTMENT OF TRANSPORTATION
DIVISION OF HIGHWAYS

**PROPOSED
HIGHWAY PLANS**

FAP ROUTE 510 (IL 96)
SECTION 120 (I-6)
PROJECT: *ACF-0510(035)*
HANCOCK COUNTY
C-96-124-10

TRAFFIC DATA
ADT (2002)
1,650 (6% MU + SU)

INDEX OF SHEETS

- 1 COVER SHEET
- 2 GENERAL NOTES, COMMITMENTS & MIX DESIGN
- 3 SUMMARY OF QUANTITIES
- 4 TYPICAL SECTION
- 5 SCHEDULE OF QUANTITIES
- 6 ROADWAY PLAN
- 7 TRAFFIC CONTROL DETAIL
- 8-10 PIN PILE DETAILS
- 11-13 SOIL BORINGS
HIGHWAY STANDARDS

IDOT HIGHWAY STANDARDS

000001-05	635006-03	701311-03
001001-02	635011-02	701321-10
001006	701001-02	701901-01
280001-04	701006-03	704001-05
482011-03	701011-02	780001-02
630001-08	701201-03	781001-03
635001-01	701301-03	

PROJECT BEGINS
STA. 809 + 94

PROJECT ENDS
STA. 811 + 81

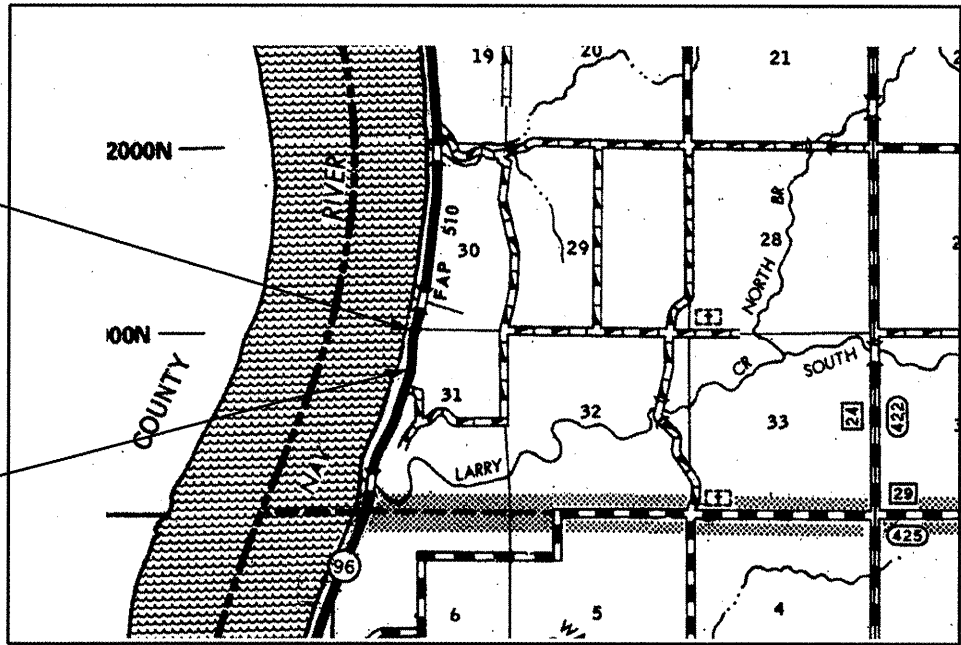

NET LENGTH OF PROJECT: 187 FT (0.035 MILES)
GROSS LENGTH OF PROJECT: 187 FT (0.035 MILES)

D-96-569-03

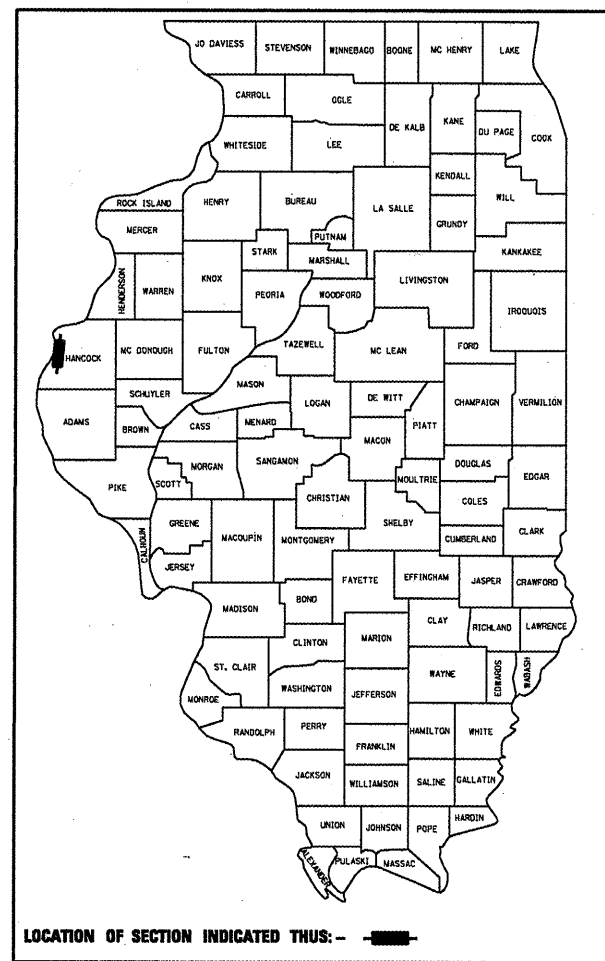

LOCATION OF SECTION INDICATED THUS: ———

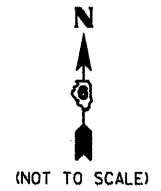

Project Engineer: John Negandard Phone: (217) 782-6990
Squad Leader: Vince Madonia Phone: (217) 785-9046

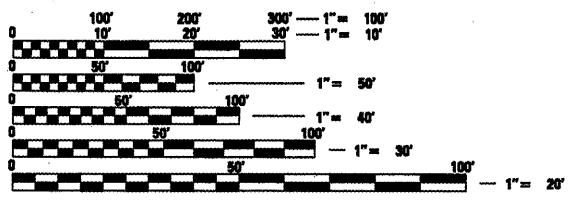

FULL SIZE PLANS HAVE BEEN PREPARED USING STANDARD ENGINEERING SCALES. REDUCED SIZED PLANS WILL NOT CONFORM TO STANDARD SCALES. IN MAKING MEASUREMENTS ON REDUCED PLANS, THE ABOVE SCALES MAY BE USED.

J.U.L.I.E.
JOINT UTILITY LOCATION INFORMATION FOR EXCAVATION
1-800-892-0123

PLANS PREPARED BY
HORNER & SHIFRIN, INC.
ENGINEERS ■ ARCHITECTS ■ PLANNERS

141 MARKET PLACE SUITE 208 ■ FAIRVIEW HEIGHTS, ILLINOIS 62208
5200 OAKLAND AVENUE ■ ST. LOUIS, MISSOURI 63110
www.hornershifrin.com

STATE OF ILLINOIS
DEPARTMENT OF TRANSPORTATION
DIVISION OF HIGHWAYS

SUBMITTED *August 13, 2009*
Reg. Z. Dink
DEPUTY DIRECTOR OF HIGHWAYS, REGION ENGINEER

October 2, 2009
Charles J. Driscoll
ENGINEER OF DESIGN AND ENVIRONMENT

October 2, 2009
Christine M. Reed
DIRECTOR OF HIGHWAYS, CHIEF ENGINEER

**PRINTED BY THE AUTHORITY
OF THE STATE OF ILLINOIS**

CONTRACT NO. 72852