

FULL S.E. (S.E.#5 = 2.25%)
STA 530+37.39 TO 541+26.04
S.E. TRANSITION:
STA 529+33.91 TO 530+37.39
STA 541+26.04 TO 542+29.52

EXIST. CURVE 8
 PI STA. = 535+83.44
 $\Delta = 10^\circ 57' 31''$ (RT)
 $D = 0^\circ 58' 11''$
 $R = 5,907.82'$
 $T = 566.71'$
 $L = 1,129.96'$
 $E = 27.12'$
 $e = \text{-----}$
 T.R. = -----
 S.E. RUN = -----
 P.C. STA. = 530+16.74
 P.T. STA. = 541+46.69

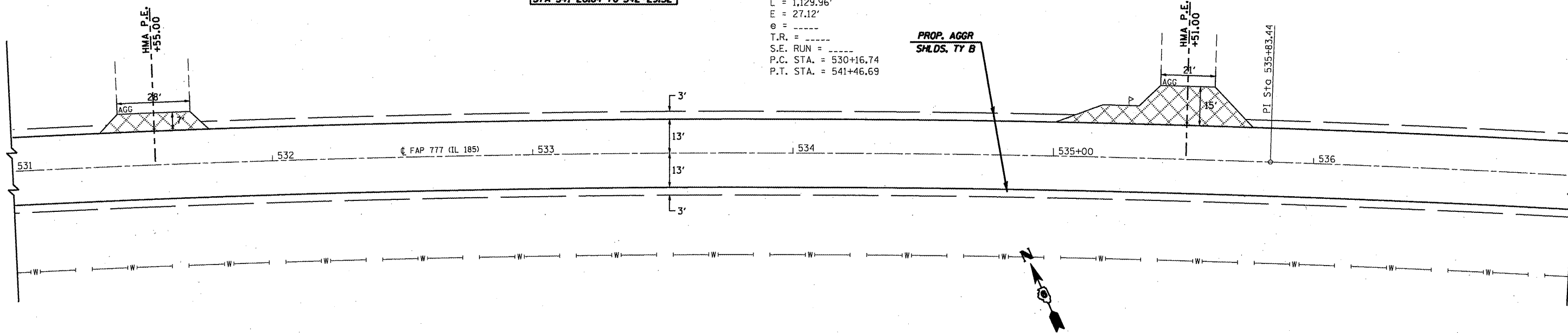

EXIST. CURVE 9
 PI STA. = 550+66.69
 $\Delta = 11^\circ 17' 36''$ (LT)
 $D = 1^\circ 02' 11''$
 $R = 5,528.15'$
 $T = 546.58'$
 $L = 1,089.63'$
 $E = 26.96'$
 $e = \text{-----}$
 T.R. = -----
 S.E. RUN = -----
 P.C. STA. = 545+20.10
 P.T. STA. = 556+09.73

FULL S.E. (S.E.#6 = 2.40%)
STA 545+42.15 TO 555+87.68
S.E. TRANSITION:
STA 544+34.47 TO 545+42.15
STA 555+87.68 TO 556+95.36

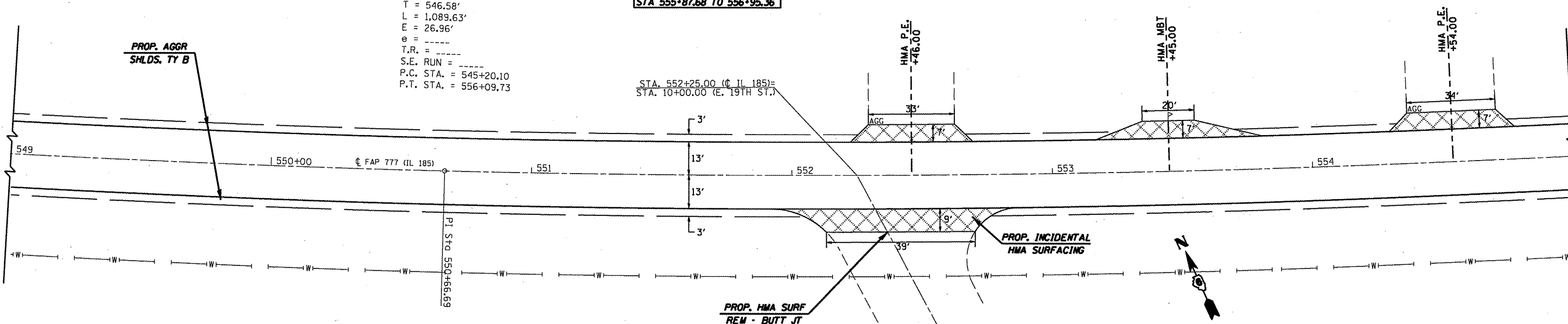

• 531+00.00 TO 537+00.00
 • 549+00.00 TO 555+00.00

FILE NAME =	USER NAME = coxjm	DESIGNED - JWC	REVISED -	STATE OF ILLINOIS DEPARTMENT OF TRANSPORTATION	PLAN SHEETS			F.A.P. RTE. 777	SECTION 10RS-5	COUNTY Montgomery	TOTAL SHEETS 54	SHEET NO. 30
ca:\pm_work\PWIDOT\COXJM\dms22861\0672888-sht-plan21.dgn	PLOT SCALE = 40.0000 / IN.	DRAWN - JWC	REVISED -		SCALE: 20	SHEET NO. 11 OF 27 SHEETS	STA. *	TO STA. **	CONTRACT NO. 72A68			
PLOT DATE = Aug-13-2009 10:31:22AM	DATE - 7/10/09	CHECKED - RSC	REVISED -		ILLINOIS FED. AID PROJECT							
		DATE - 7/10/09	REVISED -									