

PLAN	SURVEYED	BY	DATE
	PLOTTED		
	ALIGNED		
	CHECKED		
	FILED		
	NO.		

PROFILE	SURVEYED	BY	DATE
	PLOTTED		
	GRADES		
	CHECKED		
	STRUCTURE		
	NOTATIONS		
	NO.		

PR. STEEL PLATE BEAM GUARD RAIL, TYPE A
STA. 55+72.00 TO STA. 56+47.00 RT
STA. 56+22.00 TO STA. 56+47.00 LT

PR. STEEL PLATE BEAM GUARD RAIL,
ATTACHED TO STRUCTURES
STA. 56+47.00 TO STA. 56+72.00 LT & RT

PR. TRAFFIC BARRIER TERMINAL, TYPE 1
(SPECIAL) TANGENT (SEE NOTE 1)
STA. 55+22.00 TO STA. 55+72.00 RT
STA. 55+72.00 TO STA. 56+22.00 LT
STA. 56+72.00 TO STA. 57+22.00 LT & RT

NOTE:
1) THE GUARDRAIL IS 24' FACE TO FACE.
DO NOT CONSTRUCT A TAPER FOR SHOULDER
AS SHOWN IN HWY. STD. 630301.

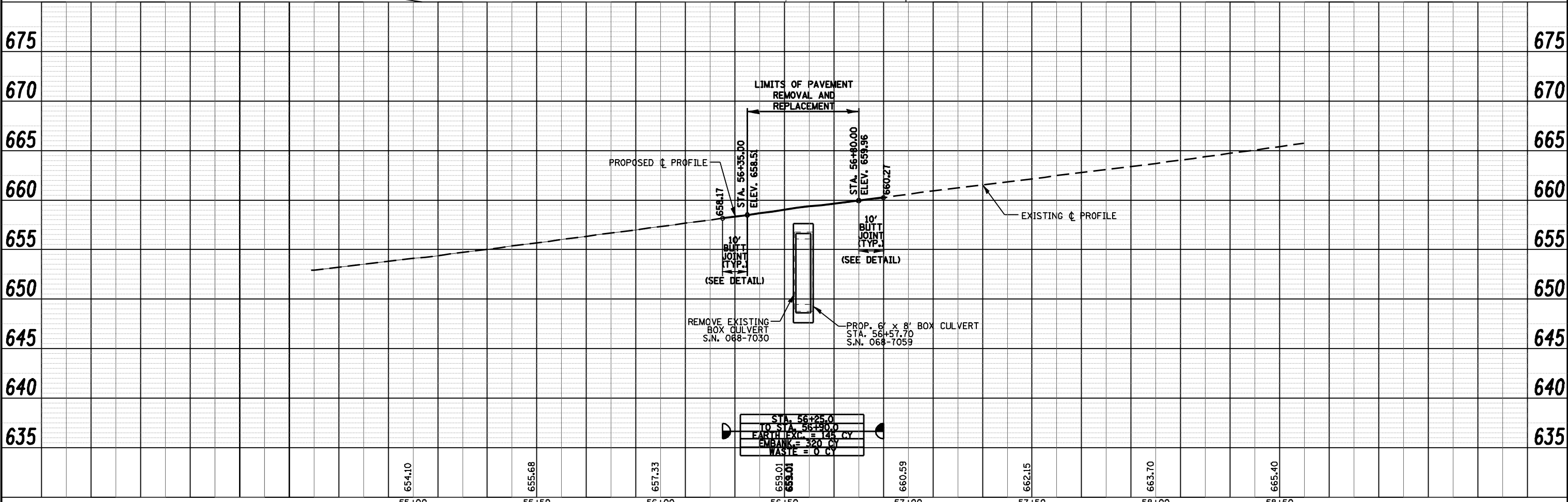

CL STA. 56+57.70, S.N. 068-7059 (PROP.)
PR. CONCRETE BOX CULVERT
6' W X 8' H X 39' LONG

CL STA. 56+57.70, S.N. 068-7030 (EXIST.)
EX. CONCRETE BOX CULVERT
6' W X 7.3' TO 8.3' H X 30' LONG

EXIST. CURVE C100
PI STA. = 60+72.20
Δ = 55° 02' 56" (LT)
D = 5° 30' 35"
R = 1,039.90'
T = 541.90'
L = 999.12'
E = 132.72'
e = -----
T.R. = -----
S.E. RUN = MATCH EXIST.
P.C. STA. = 55+30.30
P.T. STA. = 65+29.42

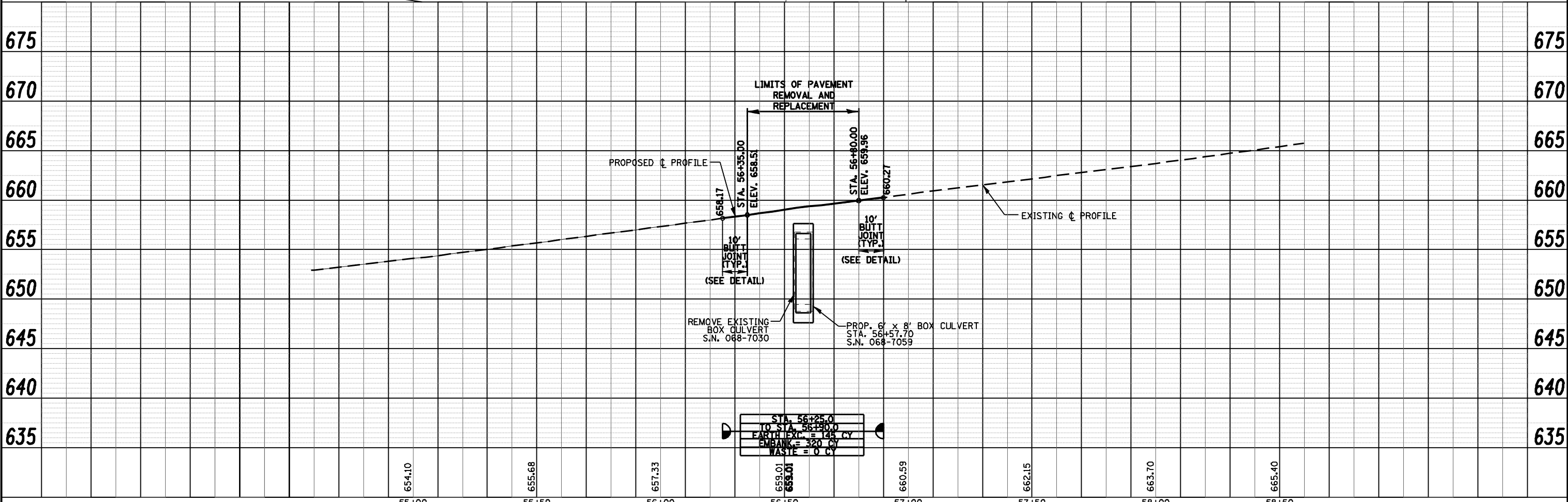
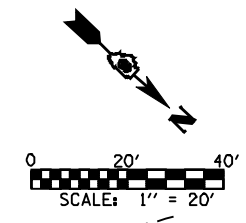

FILE NAME =	USER NAME = laughlinr1	DESIGNED - DMM	REVISED -	STATE OF ILLINOIS DEPARTMENT OF TRANSPORTATION	PLAN AND PROFILE SHEET ROUTE SBI 16A (CRESS CIRCLE)	F.A. RTE.	SECTION	COUNTY	TOTAL SHEETS	SHEET NO.
ca:\pwwork\pwwid001\LAUGHLINR1\d0156219\0672873-sht-plnprf.dgn	PLOT SCALE = 40.0000' / IN.	DRAWN - DMM	REVISED -			(21 FR*1)ACB	MONTGOMERY	20	10	
PLOT DATE = Jul-24-2009 10:33:15AM	DATE - 10/2008	CHECKED - FL	REVISED -			CONTRACT NO. 72B73				
		DATE - 10/2008	REVISED -			FED. ROAD DIST. NO.	ILLINOIS FED. AID PROJECT			