

EXIST. CURVE C100  
 PI STA. = 60+72.20  
 $\Delta = 55^\circ 02' 56''$  (LT)  
 $D = 5^\circ 30' 35''$   
 $R = 1,039.90'$   
 $T = 541.90'$   
 $L = 999.12'$   
 $E = 132.72'$   
 $e = \text{-----}$   
 $T.R. = \text{-----}$   
 S.E. RUN = MATCH EXIST.  
 P.C. STA. = 55+30.30  
 P.T. STA. = 65+29.42

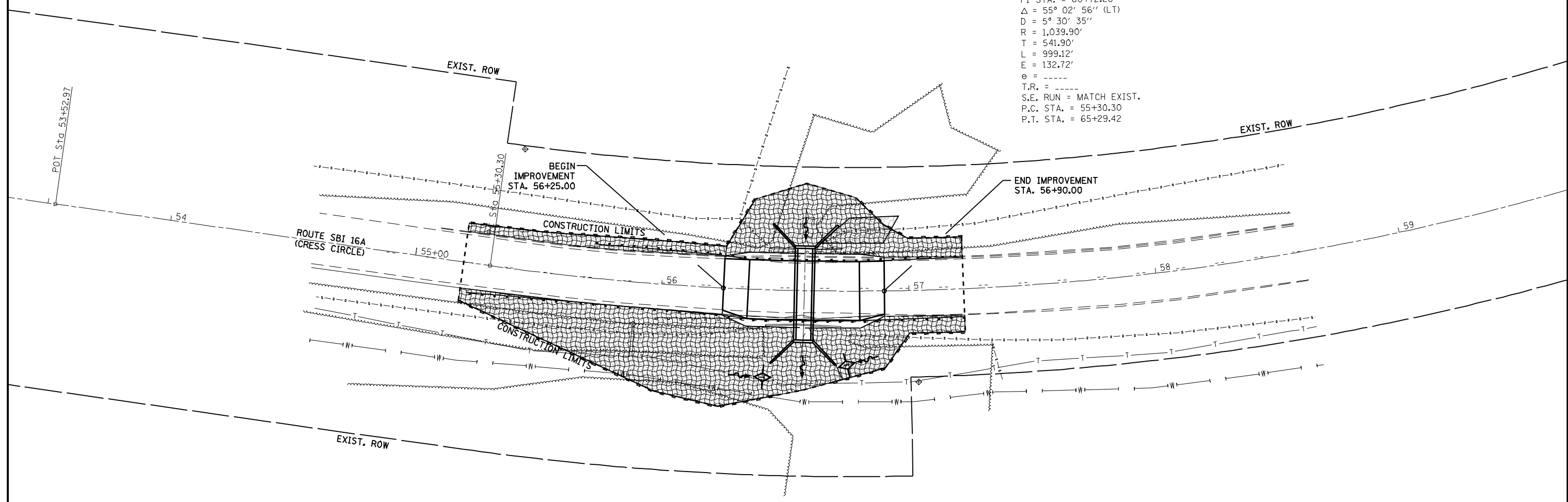

LEGEND	
	SEEDING, CLASS 2A
	EROSION CONTROL BLANKET
	PERIMETER EROSION BARRIER
	TEMPORARY DITCH CHECK

FILE NAME =	USER NAME = laughlinr1	DESIGNED - DMM	REVISED -
ca:\pwwork\pwwid001\LAUGHLINRL\0156219\0722673-sht-eros.dgn		DRAWN - DMM	REVISED -
PLOT SCALE = 40.0000' / IN.		CHECKED - FL	REVISED -
PLOT DATE = Jul-24-2009 10:39:19AM		DATE - 10/2008	REVISED -

**STATE OF ILLINOIS  
 DEPARTMENT OF TRANSPORTATION**

**EROSION CONTROL PLAN  
 ROUTE SBI 16A (CRESS CIRCLE)**

SCALE: 1"=20'      SHEET NO.    OF    SHEETS    STA. 56+25.00 TO STA. 56+90.00

F.A. RTE.	SECTION	COUNTY	TOTAL SHEETS	SHEET NO.
	(21[FR*1])ACB	MONTGOMERY	20	12
FED. ROAD DIST. NO.			ILLINOIS FED. AID PROJECT	
<b>CONTRACT NO. 72B73</b>				