

STATE OF ILLINOIS
DEPARTMENT OF TRANSPORTATION

WEST EDGE OF SHOULDER

Location	Station	Offset	Theoretical Grade Elevations
End S. Appr. Pav't.	324+77.21	18.00	535.17
A	324+87.21	18.00	535.11
B	324+97.21	18.00	535.06
Begin S. Appr. Pav't.	325+07.21	18.00	535.00

WEST EDGE OF PAVEMENT

Location	Station	Offset	Theoretical Grade Elevations
End S. Appr. Pav't.	324+77.21	-12.00	535.41
A	324+87.21	-12.00	535.32
B	324+97.21	-12.00	535.22
Begin S. Appr. Pav't.	325+07.21	-12.00	535.13

STAGE CONSTRUCTION JOINT

Location	Station	Offset	Theoretical Grade Elevations
End S. Appr. Pav't.	324+77.21	-1.50	535.57
A	324+87.21	-1.50	535.50
B	324+97.21	-1.50	535.42
Begin S. Appr. Pav't.	325+07.21	-1.50	535.35

☉ ROADWAY & PG

Location	Station	Offset	Theoretical Grade Elevations
End S. Appr. Pav't.	324+77.21	0.00	535.59
A	324+87.21	0.00	535.51
B	324+97.21	0.00	535.44
Begin S. Appr. Pav't.	325+07.21	0.00	535.38

EAST EDGE OF PAVEMENT

Location	Station	Offset	Theoretical Grade Elevations
End S. Appr. Pav't.	324+77.21	12.00	535.41
A	324+87.21	12.00	535.32
B	324+97.21	12.00	535.22
Begin S. Appr. Pav't.	325+07.21	12.00	535.13

EAST EDGE OF SHOULDER

Location	Station	Offset	Theoretical Grade Elevations
End S. Appr. Pav't.	324+77.21	18.00	535.17
A	324+87.21	18.00	535.11
B	324+97.21	18.00	535.06
Begin S. Appr. Pav't.	325+07.21	18.00	535.00

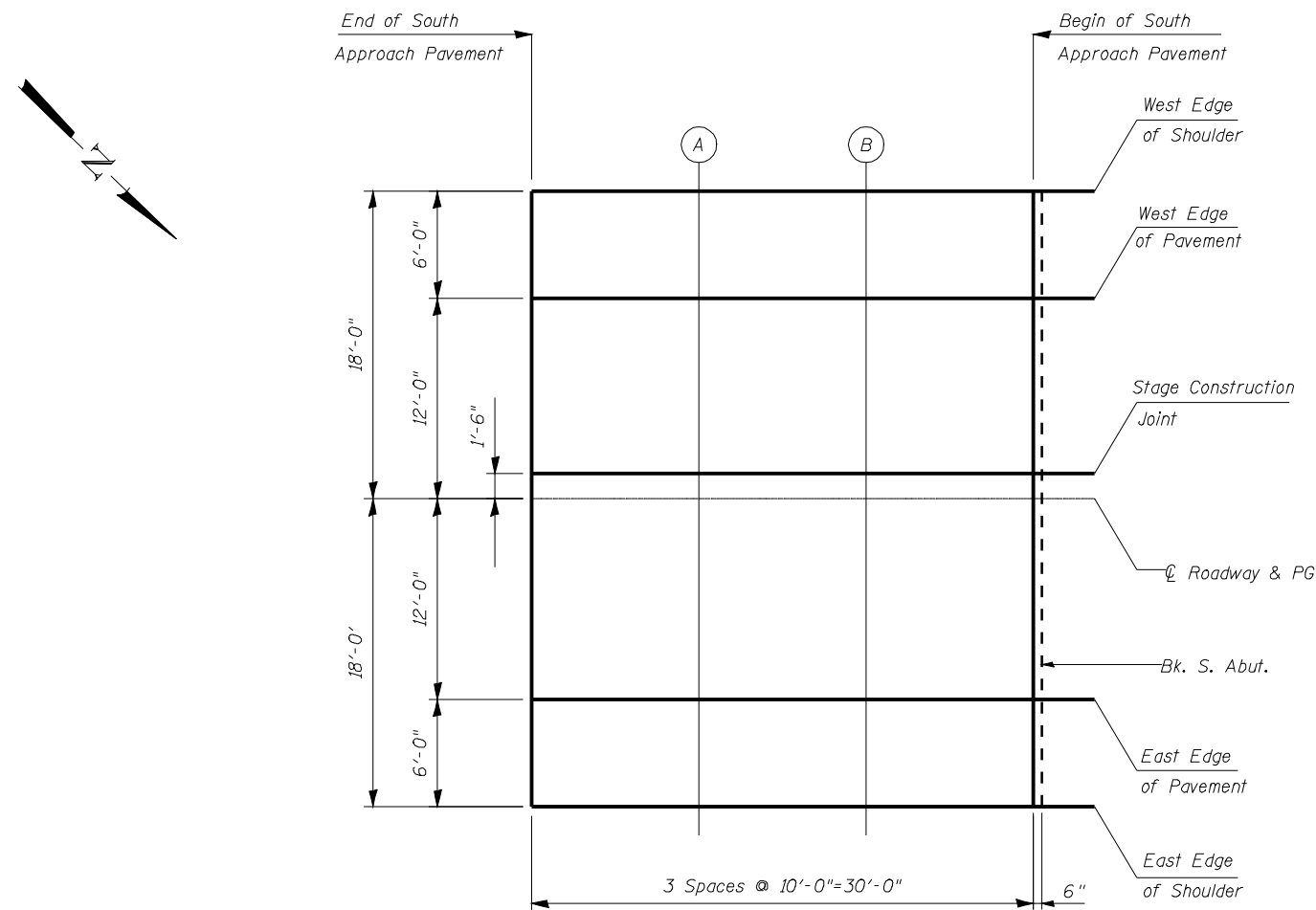

PLAN

**TOP OF SOUTH APPROACH SLAB ELEVATIONS
STRUCTURE NO.085-0001**

SHEET NO. 7 20 SHEETS	F.A. RTE. 310 (US 67)	SECTION (87B) BR	COUNTY SCHUYLER	TOTAL SHEETS 80	SHEET NO. 48
	CONTRACT NO. 72B95				
FED. ROAD DIST. NO.		ILLINOIS FED. AID PROJECT			

DESIGNED	CMW
CHECKED	JSA
DRAWN	TJW
CHECKED	CMW

HOELSCHER ENGINEERING

11 Executive Drive Suite 12
Fairview Heights, Illinois 62208
(618) 624-8610
(618) 624-8611 (fax)

2501 Chatham Road, Suite 120
Springfield, Illinois 62704
(217) 698-8610
(217) 698-8608 (fax)

115 North Nell Street, Suite 105
Champaign, Illinois 61820
(217) 351-8610
(217) 351-8611 (fax)