

| | | | | |
|---------------------|----------------|--------------------|--------------|-----------|
| F.A.S. RTE. | SECTION | COUNTY | TOTAL SHEETS | SHEET NO. |
| 1807 | (51-23HB-6)B-1 | LAWRENCE | 60 | 1 |
| FED. ROAD DIST. NO. | ILLINOIS | CONTRACT NO. 74115 | | |

FOR INDEX OF SHEETS & LIST OF STANDARDS SEE SHEET NO. 2

STATE OF ILLINOIS
DEPARTMENT OF TRANSPORTATION
DIVISION OF HIGHWAYS

**PROPOSED
HIGHWAY PLANS**

F.A.S. ROUTE 1807 (US BUS. 50 RAMP A)
SECTION (51-23HB-6)B-1
PROJECT BHM-1807(029)
LAWRENCE COUNTY
C-97-079-05

D-97-045-05

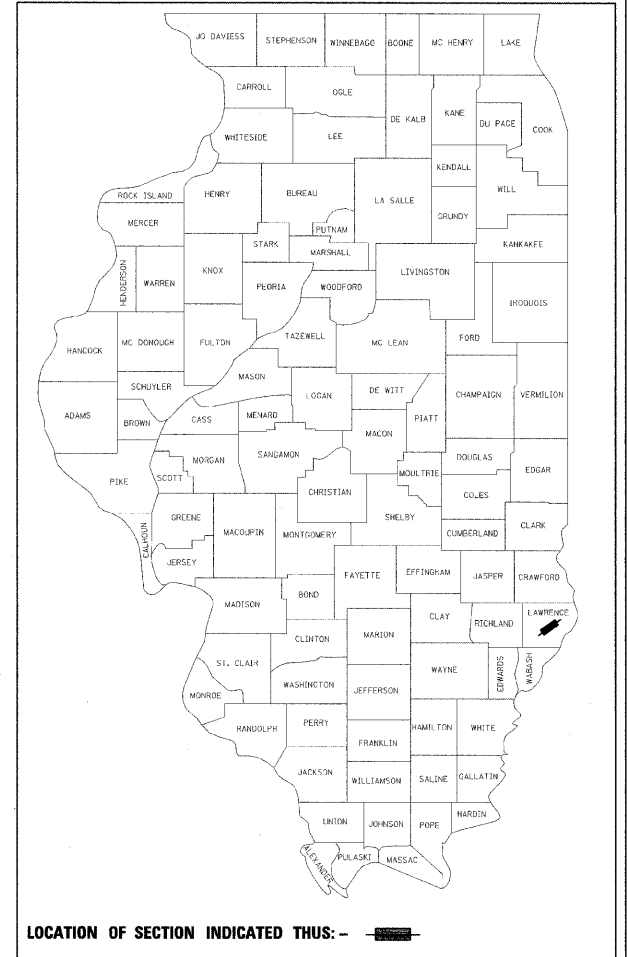

LOCATION OF SECTION INDICATED THUS: NOTE: WHEREVER IN THE PLANS SECTION (51-23HB-6)B-1 IS SHOWN IT SHOULD BE SECTION (51-23HB-6)B-1 INSTEAD,

CONSULTANT PROJECT MANAGER: KEITH BENTING PHONE: (217) 875-4800

MAJOR COLLECTOR
2007 ADT = 3200

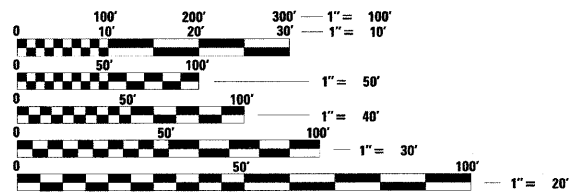

FULL SIZE PLANS HAVE BEEN PREPARED USING STANDARD ENGINEERING SCALES. REDUCED SIZED PLANS WILL NOT CONFORM TO STANDARD SCALES. IN MAKING MEASUREMENTS ON REDUCED PLANS, THE ABOVE SCALES MAY BE USED.

J.U.L.I.E.
JOINT UTILITY LOCATION INFORMATION FOR EXCAVATION
1-800-892-0123
OR 811

PROJECT ENGINEER: TOM RONAN (217) 342-8320
PROJECT MANAGER: JENNIFER WENTHE (217) 342-8361
CONTRACT NO. 74115



345 E. ASH AVE.
DECATUR, ILLINOIS 62526
PH. 217-875-4800



NET LENGTH OF IMPROVEMENT = 500 FT (0.095 MILES)
GROSS LENGTH OF IMPROVEMENT = 500 FT (0.095 MILES)

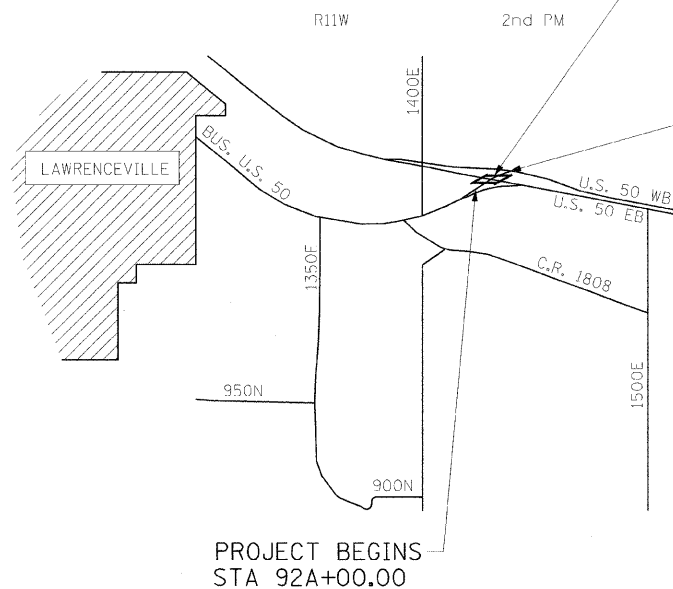

SECTION (51-23HB-6)B-1
PROPOSED STRUCTURE REHABILITATION
STA 94A+66.74 (RAMP A) =
STA 702+74.98 (U.S. 50 EB)
STRUCTURE NO 051-0031
THREE SPAN STEEL WF STRUCTURE WITH
NEW COMPOSITE CONCRETE DECK ON EXISTING
STEEL PILE ABUTMENTS & EXISTING
HAMMERHEAD PIERS
SPANS AT 61'-4", 78'-6" AND 56'-2"
BACK TO BACK ABUTMENTS = 201'-8"
0-0 DECK = 26'-2", SKEW = 46° R.F.

PROJECT ENDS
STA 97A+00.00

PROJECT BEGINS
STA 92A+00.00

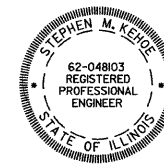

Steph M Kehoe
ILLINOIS PROFESSIONAL NO. 48103

3-18-09
DATE

EXPIRES: 11-30-09

STATE OF ILLINOIS
DEPARTMENT OF TRANSPORTATION
DIVISION OF HIGHWAYS

SUBMITTED *March 19* 20 *09*

Roger L. Scutella
DEPUTY DIRECTOR OF HIGHWAYS, REGION ENGINEER
October 2, 20 09

Charles G. Ingersoll
ENGINEER OF DESIGN AND ENVIRONMENT
October 2, 20 09

Christine M. Reed
DIRECTOR OF HIGHWAYS, CHIEF ENGINEER

PRINTED BY THE AUTHORITY
OF THE STATE OF ILLINOIS