

STATE OF ILLINOIS
DEPARTMENT OF TRANSPORTATION

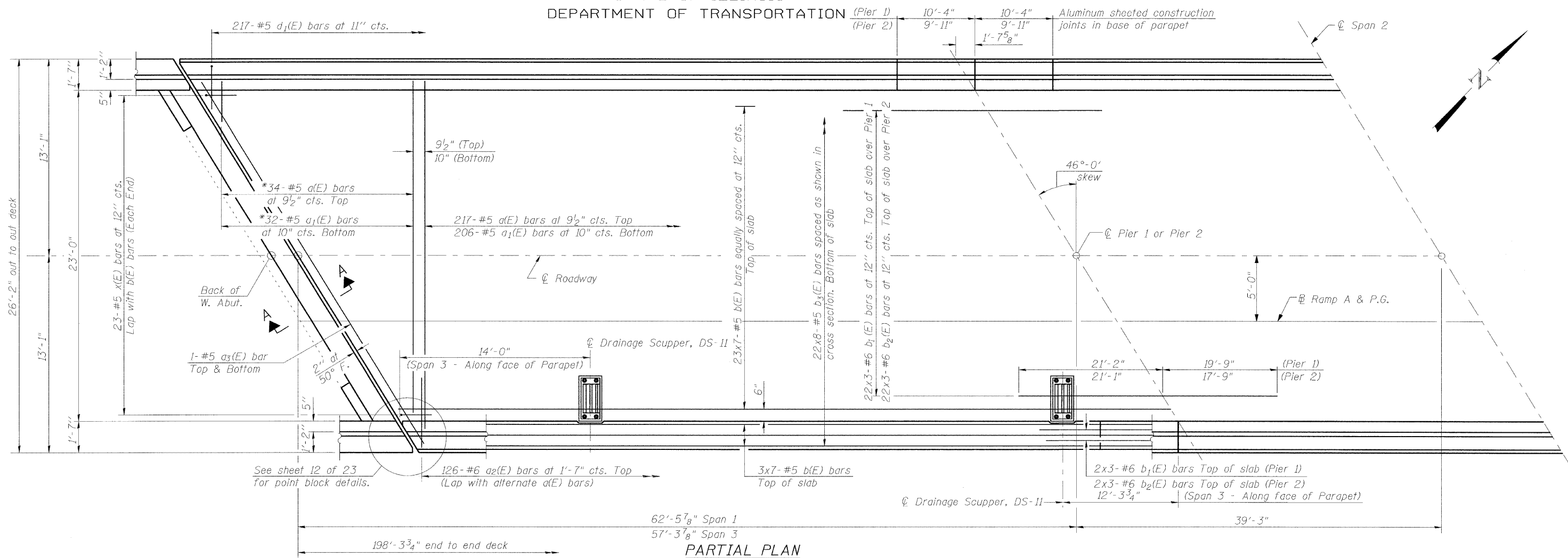

PARTIAL PLAN

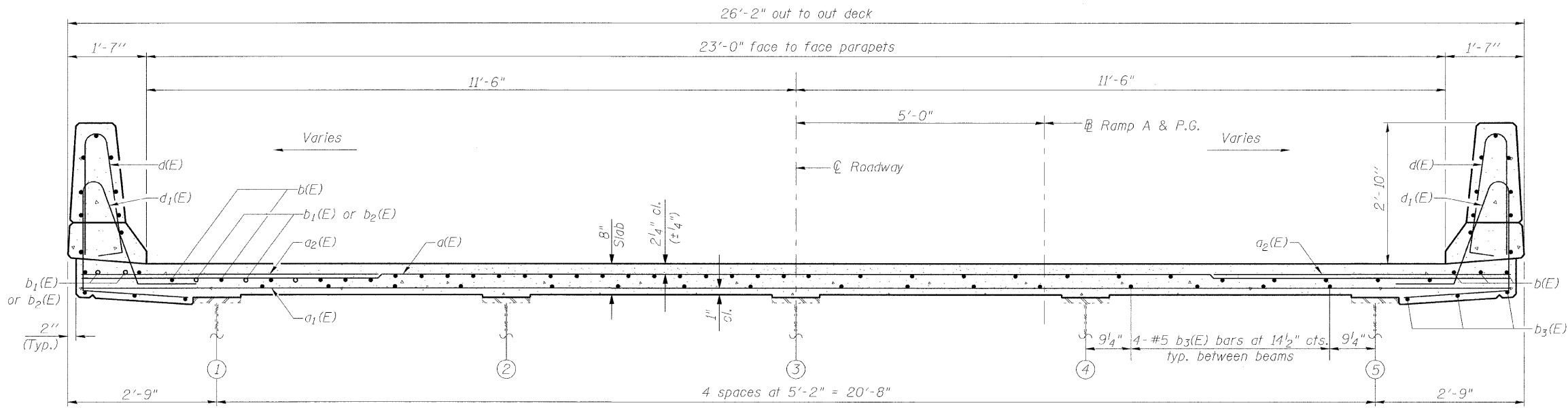

NEAR PIER

NEAR MIDSPAN

CROSS SECTION
(Looking East)

MINIMUM BAR LAP
#5 bar = 1'-8"
#6 bar = 2'-0"

*Order a(E) & a1(E) bars full length.
Cut to fit skew and use remainder
of bars in opposite end.

Notes:
See sheet 9 of 24 for superstructure details, parapet reinforcement, Section A-A and Bill of Material.
Bars indicated thus 22x8-#5 etc. indicates 22 lines of bars with 8 lengths per line.
Cut longitudinal reinforcement bars to clear drainage scuppers.
The joint opening and deck/parapet dimensions are based on a Rolled Rail Strip Seal Joint. If the Contractor elects to use Welded Rail Strip Seal joint, these dimensions may require adjustment to satisfy the detail on base sheet EJ-SSJ (See sheet 12 of 24).

SUPERSTRUCTURE
FAS ROUTE 1807 SECTION (51-23HB)-6B-1
LAWRENCE COUNTY
STATION 94A+66.74
STRUCTURE NO. 051-0031

| | |
|------------|-----|
| DESIGNED - | MJP |
| CHECKED - | KWB |
| DRAWN - | REZ |
| CHECKED - | TDN |

URS
345 E. ASH AVE., SUITE B
DECATUR, IL. 62526
TEL. 217-875-4800

| | | | | | |
|---|-------------|----------------|----------|--------------|-----------|
| SHEET NO. 8 24 SHEETS | F.A.S. RTE. | SECTION | COUNTY | TOTAL SHEETS | SHEET NO. |
| | 1807 | (51-23HB)-6B-1 | LAWRENCE | 60 | 24 |
| CONTRACT NO. 74115 | | | | | |
| FED. ROAD DIST. NO. ILLINOIS FED. AID PROJECT | | | | | |