

PLAN	SURVEYED	DATE
	PLOTTED	BY
	ALIGNED	
	CHECKED	
	FILED	
	CADD FILE NAME	
	NO.	

PROFILE	SURVEYED	DATE
	PLOTTED	BY
	GRADES CHECKED	
	STRUCTURE NOTATIONS CHKD	
	NO.	

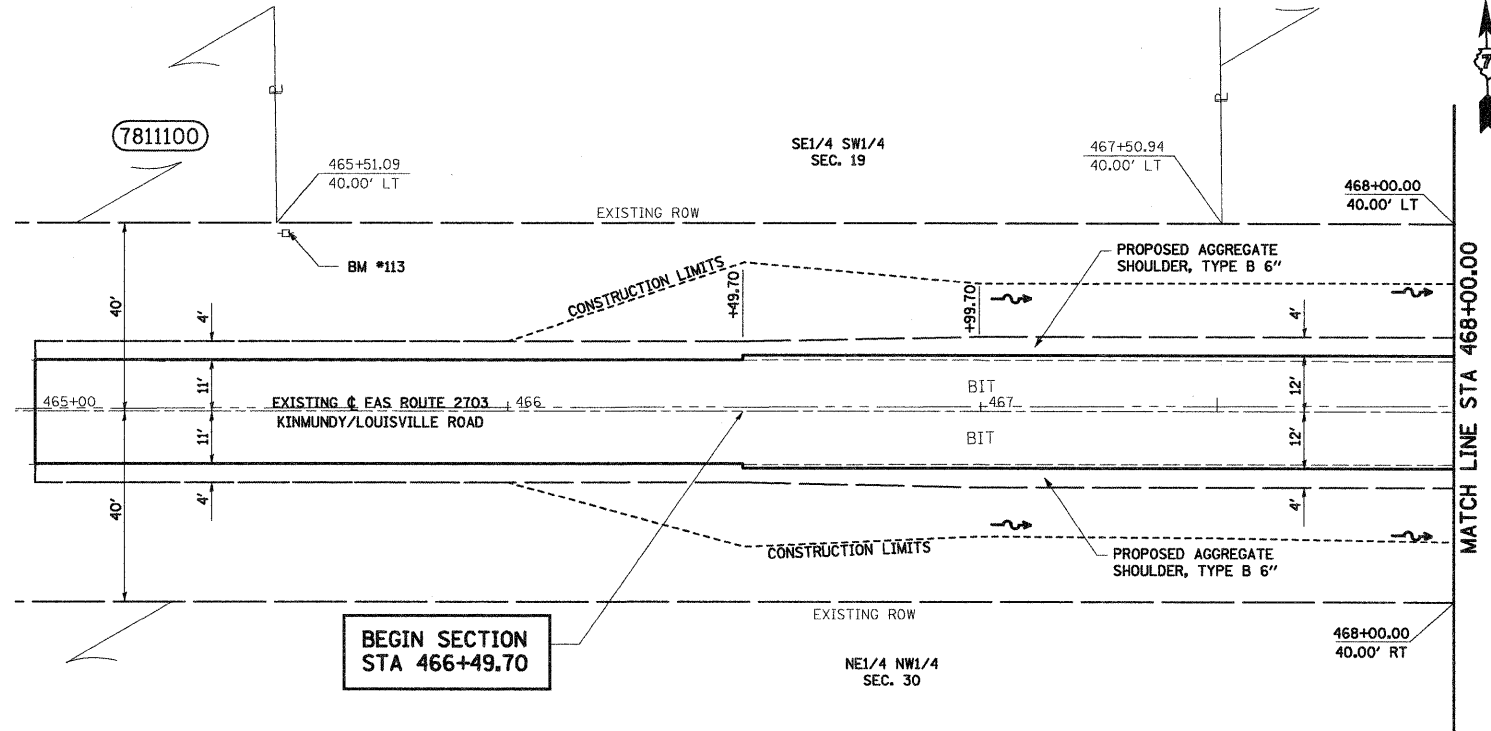

BENCHMARK #113:
 STA 465+53, 37.1' LT. RAILROAD SPIKE IN POWER POLE #D34-17-3-1-9
 ELEV. 563.105

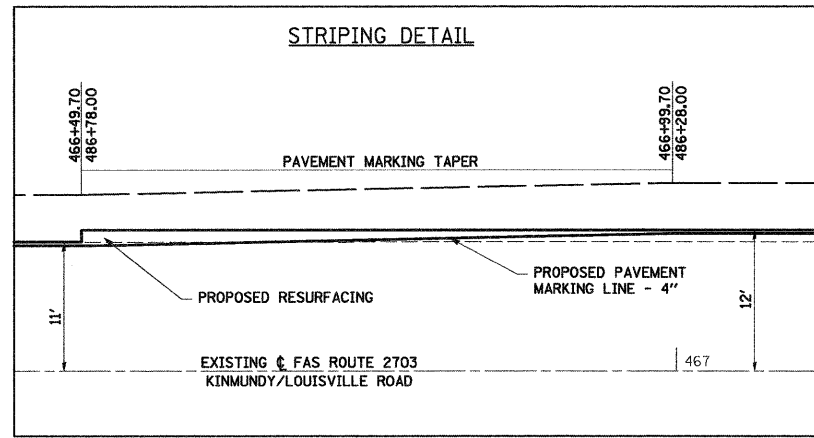
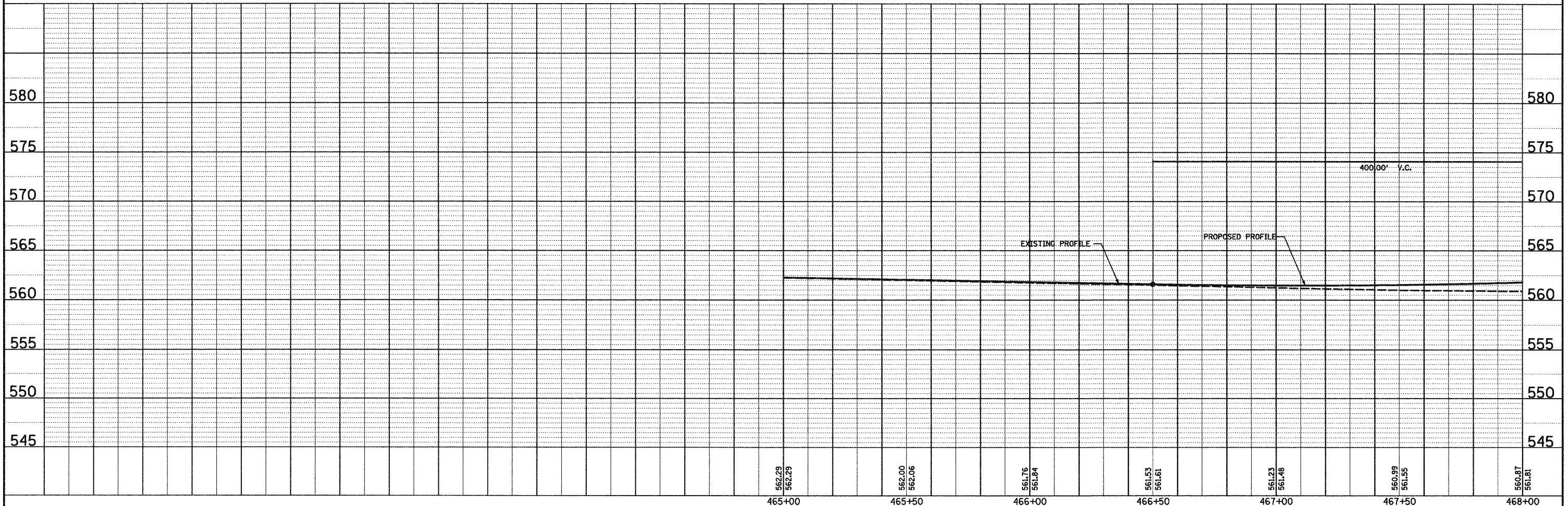

FILE NAME =	USER NAME = paul	DESIGNED - JLS	REVISED -	STATE OF ILLINOIS DEPARTMENT OF TRANSPORTATION	PLAN AND PROFILE, KINMUNDY/LOUISVILLE ROAD	F.A.S. RTE. 2703	SECTION (9-VBR)B	COUNTY CLAY	TOTAL SHEETS 65	SHEET NO. 10		
PLOT SCALE = 20.000' / IN.	CHECKED - BRM	REVISED -	SCALE: 1"=20'			SHEET NO. 1 OF 5 SHEETS	STA. 465+50.00 TO STA. 468+00.00	CONTRACT NO. 74136				
PLOT DATE = 12/5/2008	DATE - 4-08-08	REVISED -	FED. ROAD DIST. NO. ILLINOIS FED. AID PROJECT									