

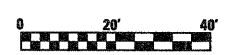

SE1/4 SE1/4
SEC. 19

NE1/4 NE1/4
SEC. 30

END SECTION
STA 486+78.00

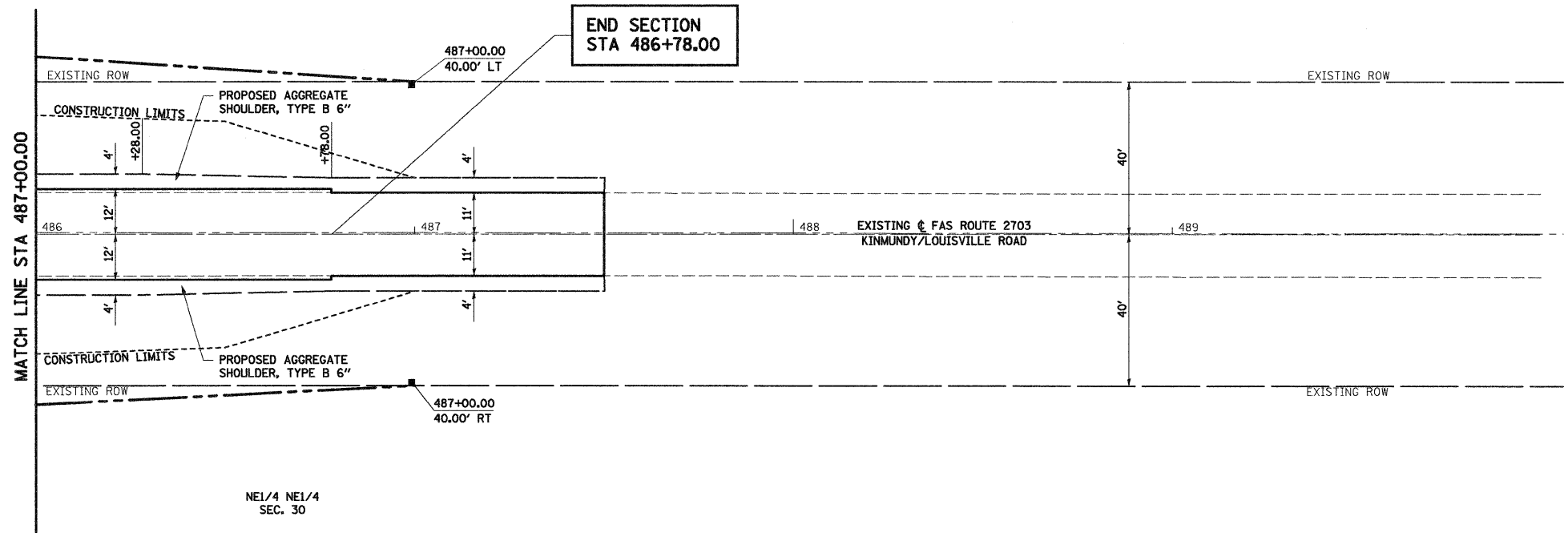

PLAN	REVISIONS	DATE
NOTE BOOK	BY	
NO.		

PROFILE	REVISIONS	DATE
NOTE BOOK	BY	
NO.		

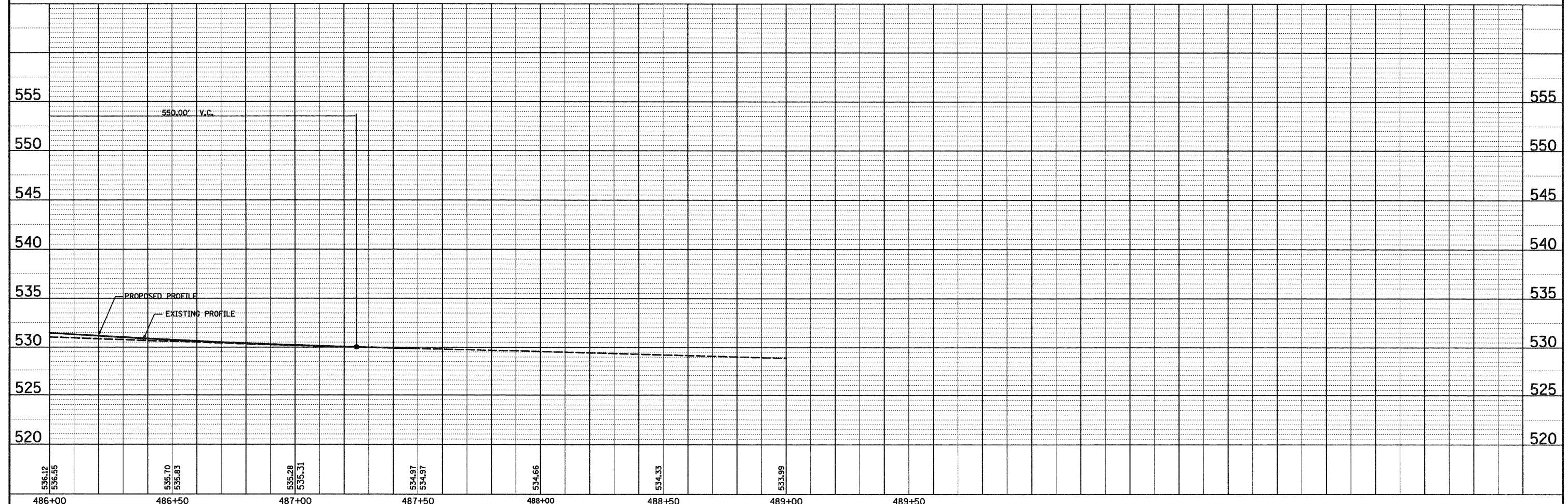

FILE NAME =	USER NAME = paul	DESIGNED - JLS	REVISED -	STATE OF ILLINOIS DEPARTMENT OF TRANSPORTATION	PLAN AND PROFILE, KINMUNDY/LOUISVILLE ROAD	F.A.S. RTE. 2703 SECTION (9-VBR)B COUNTY CLAY TOTAL SHEETS 65 SHEET NO. 14 CONTRACT NO. 74136
PLT SCALE = 20.000 ' / IN.	CHECKED - BRM	REVISED -	SCALE: 1"=20'			
PLT DATE = 12/3/2008	DATE - 4-08-08	REVISED -	SHEET NO. 5 OF 5 SHEETS			
			STA. 486+00.00 TO STA. 489+50.00			