

STATE OF ILLINOIS
DEPARTMENT OF TRANSPORTATION

ROUTE NO.	SECTION	COUNTY	TOTAL SHEETS	SHEET NO.	SHEET NO. 8 23 SHEETS
FAS 2801 IL 128	(102B) B-1	EFFINGHAM	51	30	
FED. ROAD DIST. NO. 7	ILLINOIS	FED. AID PROJECT			

Contract # 74232

EAST CURB LINE

Location	Station	Offset	Theoretical Grade Elevations
End of North Appr. Pavt.	973+50.50	-16.42	559.31
Q	973+60.50	-16.42	559.55
R	973+70.50	-16.42	559.80
Back of North Abut.	973+80.50	-16.42	560.06

EAST EDGE OF PAVEMENT

Location	Station	Offset	Theoretical Grade Elevations
End of North Appr. Pavt.	973+50.50	-12.00	559.40
Q	973+60.50	-12.00	559.64
R	973+70.50	-12.00	559.89
Back of North Abut.	973+80.50	-12.00	560.15

☉ ROADWAY & P.G.

Location	Station	Offset	Theoretical Grade Elevations
End of North Appr. Pavt.	973+50.50	0.00	559.59
Q	973+60.50	0.00	559.83
R	973+70.50	0.00	560.08
Back of North Abut.	973+80.50	0.00	560.34

WEST EDGE OF PAVEMENT

Location	Station	Offset	Theoretical Grade Elevations
End of North Appr. Pavt.	973+50.50	12.00	559.40
Q	973+60.50	12.00	559.64
R	973+70.50	12.00	559.89
Back of North Abut.	973+80.50	12.00	560.15

WEST CURB LINE

Location	Station	Offset	Theoretical Grade Elevations
End of North Appr. Pavt.	973+50.50	16.42	559.31
Q	973+60.50	16.42	559.55
R	973+70.50	16.42	559.80
Back of North Abut.	973+80.50	16.42	560.06

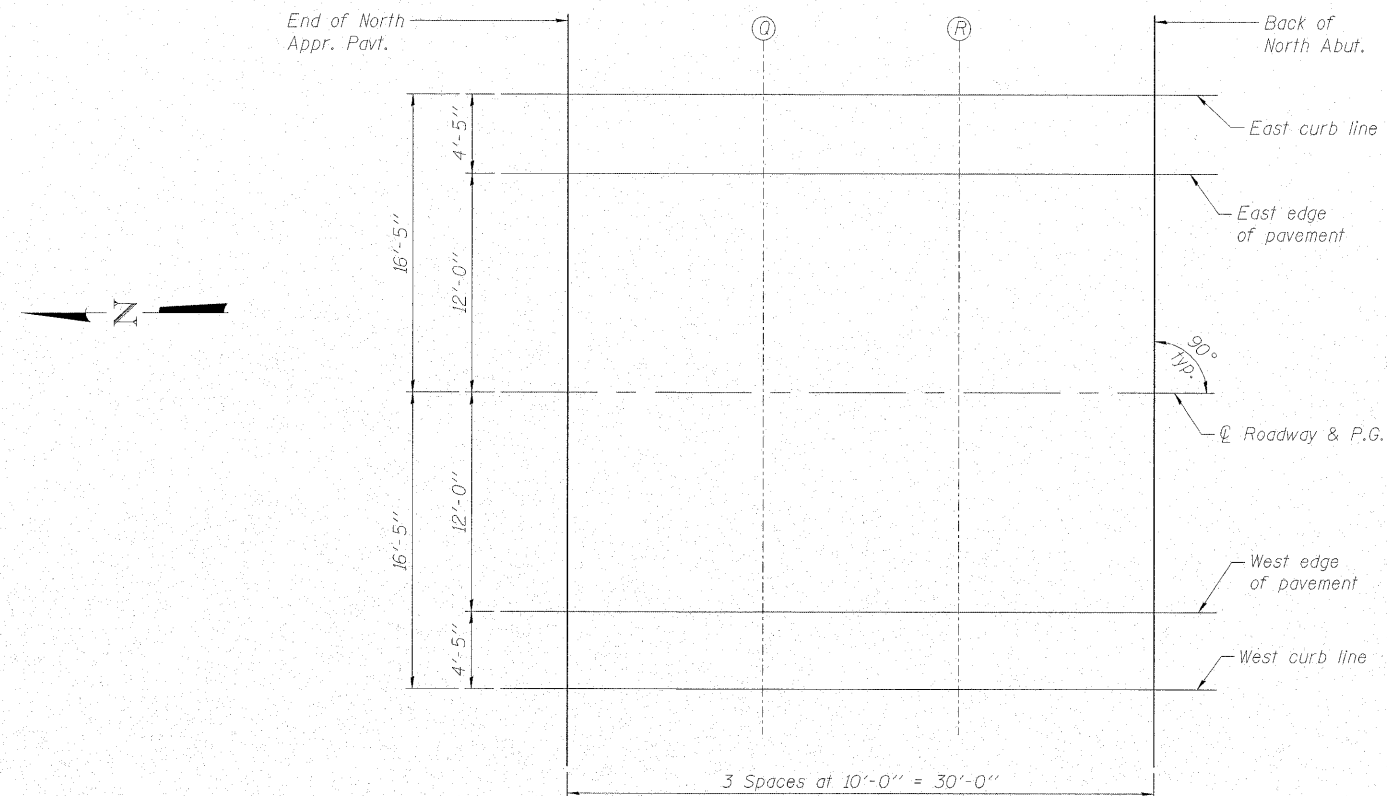

PLAN



DESIGNED -	BAS
CHECKED -	KEF
DRAWN -	LAD
CHECKED -	RJA

TOP OF NORTH APPROACH
SLAB ELEVATIONS
IL ROUTE 128 OVER WOLF CREEK
F.A.S. RTE. 2801 - SECTION (102B)B-1
EFFINGHAM COUNTY
STATION 974+76.00
STRUCTURE NO. 025-0105