

FINAL SURVEY	DATE
SURVEYED	BY
PLOTTED	
EMULATE	
AREAS CHECKED	
NO.	

ORIGINAL SURVEY	DATE
SURVEYED	BY
PLOTTED	
EMULATE	
AREAS CHECKED	
NO.	

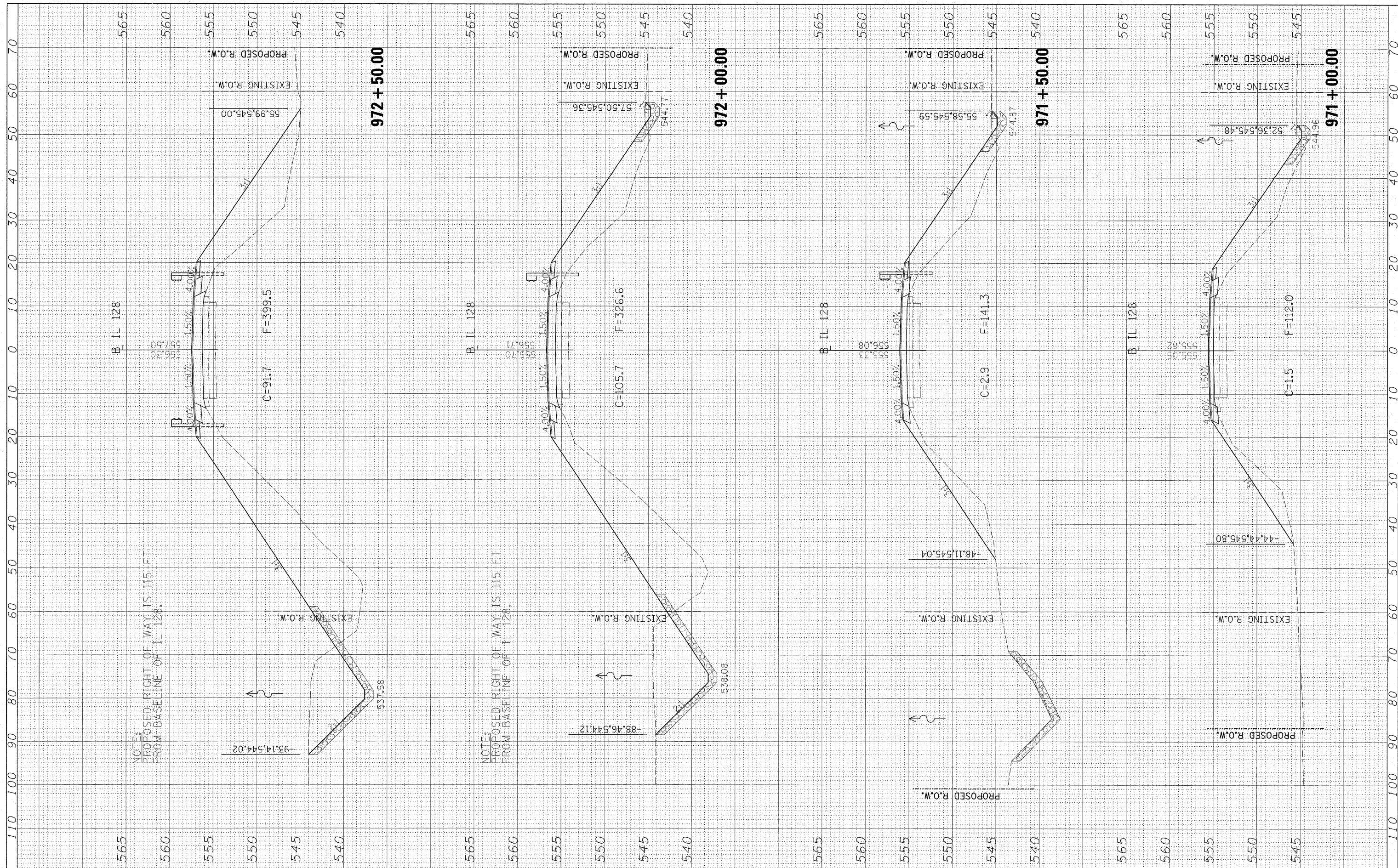

NOTE: PROPOSED RIGHT OF WAY IS 115 FT FROM BASELINE OF IL 128.

NOTE: PROPOSED RIGHT OF WAY IS 115 FT FROM BASELINE OF IL 128.

FILE NAME = #FILEL#

USER NAME = #USER#
 DESIGNED - JDS
 DRAWN - WLL 10/14/08
 CHECKED - GBM 10/14/08
 DATE - 10/15/08

REVISED -
 REVISED -
 REVISED -
 REVISED -

**STATE OF ILLINOIS
 DEPARTMENT OF TRANSPORTATION**

IL 128 OVER WOLF CREEK CROSS SECTIONS

SCALE: SHEET NO. OF SHEETS STA. 971+00.00 TO STA. 972+50.00

F.A.S. RTE. 2801	SECTION (102B)B-1	COUNTY EFFINGHAM	TOTAL SHEETS 51	SHEET NO. 47
FED. ROAD DIST. NO.		ILLINOIS FED. AID PROJECT		
CONTRACT NO. 74232				